

File No. **49,610** 15. Formation Code: Drainage Basin: County: Special Use: Stream:

16. Points of Diversion										
T	MOD	DEL	PDIV	Qualifier	S	T	R	ID	'N	'W
DEL			85197							

17. Rate and Quantity				
Authorized			Additional	
Rate	Quantity	Rate	Quantity	Overlap PD Files
gpm/cfs	af/mgy	gpm/cfs	af/mgy	

18. Storage: Rate _____ NF Quantity _____ ac/ft Additional Rate _____ NF Additional Quantity _____ ac/ft

19. Limitation: _____ af/yr at _____ gpm (_____ cfs) when combined with file number(s) _____
 Limitation: _____ af/yr at _____ gpm (_____ cfs) when combined with file number(s) _____

20. Meter Required? Yes No To be installed by _____ Date Acceptable Meter Installed _____

21. Place of Use										NE¼				NW¼				SW¼				SE¼				Total	Owner	Chg?	Overlap Files	
T	MOD	DEL	ENT	PUSE	S	T	R	ID		NE ¼	NW ¼	SW ¼	SE ¼	NE ¼	NW ¼	SW ¼	SE ¼	NE ¼	NW ¼	SW ¼	SE ¼	NE ¼	NW ¼	SW ¼	SE ¼					
DEL				67675																										

Comments: **Failure to return**

KANSAS DEPARTMENT OF AGRICULTURE
Division of Water Resources

M E M O R A N D U M

TO: Files

DATE:

November 10, 2016

FROM: Alex Whitesell

RE:

Application, File No. 49,610

Chris Speltz filed the above referenced file on April 7, 2016. The original application was returned to the applicant on April 20, 2016. The applicant was given the final deadline of October 22, 2016 to submit the information or request an extension of time. The applicant was reminded of the deadline on September 23, 2016. No correspondence was received from the applicant by the October 22, 2016 deadline. Therefore, the file should be dismissed.



Alex Whitesell
Environmental Scientist
Division of Water Resources

1320 Research Park Drive
Manhattan, Kansas 66502
(785) 564-6700



900 SW Jackson, Room 456
Topeka, Kansas 66612
(785) 296-3556

Jackie McClaskey, Secretary

Governor Sam Brownback

November 29, 2016

CRHIS SPELTZ
1417 PRAIRIE RD
CLAY CENTER KS 67432

FILE COPY

RE: Dismissal of Application
File No. 49,610

Dear Mr. Speltz;

The referenced application was returned to you for additional information on April 20, 2016. Enclosed is a Findings and Order by the Chief Engineer, Division of Water Resources, Kansas Department of Agriculture, dismissing Application, File No. 49,610, for failure to return the original application and provide the required information, prior to the final deadline of October 22, 2016.

This is a final agency action. If you choose to appeal this decision or any finding or part thereof, you must do so by filing a petition for review in the manner set forth in the enclosed order.

If you have any questions, please contact our office. If you wish to discuss a specific file, please have the file number ready so that we may help you more efficiently.

Sincerely,

Brent A. Turney, P.G.

Change Application Unit Supervisor
Water Appropriation Program

ajw:BAT
Enclosures
pc: Topeka Field Office



KANSAS DEPARTMENT OF AGRICULTURE
Jackie McClaskey, Secretary of Agriculture

DIVISION OF WATER RESOURCES
David W. Barfield, Chief Engineer

**FINDINGS AND ORDER
IN THE MATTER OF THE
DISMISSAL OF APPLICATION
FILE NO. 49,610**

After due consideration, the Chief Engineer, Division of Water Resources, Kansas Department of Agriculture (hereinafter referred to as the "Chief Engineer"), makes the following findings and order:

FINDINGS

1. That on April 7, 2016, the Chief Engineer received an application from Chris Speltz for permit to appropriate water for beneficial use, assigned File No. 49,610, proposing the appropriation of 237 acre-feet of groundwater, for irrigation use, at a maximum requested diversion rate of 800 gallons per minute, from a point of diversion located in the Southeast Quarter (SE $\frac{1}{4}$) of Section 20, Township 8 South, Range 4 East, Clay County, Kansas.
2. That in accordance with K.A.R. 5-3-1, the application was accepted for filing provided that the applicant submit a more specific location of the point of diversion within 60 days of receipt of the new application.
3. That in accordance with K.S.A. 82a-710 and K.A.R. 5-3-1b, the application was returned to the applicant on April 20, 2016, with a letter requesting additional information, including the specific location for the proposed point of diversion, in order to complete the application.
4. That on August 19, 2016, the applicant was provided a final deadline of October 22, 2016, in which to return the application with the required information and notified that the application would be dismissed if it was not returned within the time allowed or within any authorized extension of time thereof.
5. That the applicant was reminded of the deadline by letter dated September 23, 2016.
6. That no further correspondence was received from the applicant by the deadline of October 22, 2016.
7. That as required by K.S.A. 82a-710, the application, described in Paragraph No. 1, shall be denied and dismissed for failure to return the application with the requested information.

ORDER

NOW, THEREFORE, It is the decision and order of the Chief Engineer, Division of Water Resources, Kansas Department of Agriculture, that effective the date of this order, in accordance with the law, Application, File No. 49,610, is herewith dismissed and the priority assigned to it is considered to be forfeited.

This is a final agency action. If you choose to appeal this decision or any finding or part thereof, you must do so by filing a petition for review in the manner prescribed by the Kansas Act for Judicial Review and Civil Enforcement of Agency Actions (KJRA K.S.A. 77-601 et seq.) within 30 days of service of this order. Your appeal must be made with the appropriate district court for the district of Kansas.

The Chief Legal Counsel for the Kansas Department of Agriculture, 1320 Research Park Drive, Manhattan, Kansas 66502 the agency officer who will receive service of a petition for judicial review on behalf of the Kansas Department of Agriculture, Division of Water Resources. If you have questions or would like clarification concerning this order, you may contact the Chief Engineer.

Ordered this 28th day of November, 2016, in Topeka, Shawnee County, Kansas.

Lane P. Letourneau

Lane P. Letourneau, P.G.
Water Appropriation Program Manager
Division of Water Resources
Kansas Department of Agriculture

State of Kansas)
) SS
County of Riley)

The foregoing instrument was acknowledged before me this 28th day of November, 2016, by Lane P. Letourneau, P.G., Water Appropriation Program Manager, Division of Water Resources, Kansas Department of Agriculture.



Danielle Wilson
Notary Public

CERTIFICATE OF SERVICE

On this 29th day of November, 2016, I hereby certify that the foregoing Dismissal of Application, File No. 49,610, dated November 28, 2016, was mailed postage prepaid, first class, US mail to the following:

CHRIS SPELTZ
1417 PRAIRIE RD
CLAY CENTER KS 67432

With photocopies to:

Division of Water Resources Topeka Field Office

Danielle Wilson

Division of Water Resources



KANSAS DEPARTMENT OF AGRICULTURE
Jackie McClaskey, Secretary of Agriculture

DIVISION OF WATER RESOURCES
David W. Barfield, Chief Engineer

File Number 49,610
This item to be completed by the Division of Water Resources.

**APPLICATION FOR PERMIT TO
APPROPRIATE WATER FOR BENEFICIAL USE**

Filing Fee Must Accompany the Application
(Please refer to Fee Schedule attached to this application form.)

WATER RESOURCES
RECEIVED

APR 07 2016

3:59

KS DEPT OF AGRICULTURE

To the Chief Engineer of the Division of Water Resources, Kansas Department of Agriculture,
1320 Research Park Drive, Manhattan, KS 66502:

1. Name of Applicant (Please Print): Chris Speltz
Address: 1417 Prairie RD
City: Clay Center State KS Zip Code 67432
Telephone Number: (785) 632-0384

2. The source of water is: surface water in _____ (stream)
OR groundwater in Republican River Basin (drainage basin)

Certain streams in Kansas have minimum target flows established by law or may be subject to administration when water is released from storage for use by water assurance district members. If your application is subject to these regulations on the date we receive your application, you will be sent the appropriate form to complete and return to the Division of Water Resources.

3. The maximum quantity of water desired is 237 acre-feet OR _____ gallons per calendar year, to be diverted at a maximum rate of 800 gallons per minute OR _____ cubic feet per second.

Once your application has been assigned a priority, the requested maximum rate of diversion and maximum requested quantity of water under that priority number can **NOT** be increased. Please be certain your requested maximum rate of diversion and maximum quantity of water are appropriate and reasonable for your proposed project and are in agreement with the Division of Water Resources' requirements.

4. The water is intended to be appropriated for (Check use intended):
(a) Artificial Recharge (b) Irrigation (c) Recreational (d) Water Power
(e) Industrial (f) Municipal (g) Stockwatering (h) Sediment Control
(i) Domestic (j) Dewatering (k) Hydraulic Dredging (l) Fire Protection
(m) Thermal Exchange (n) Contamination Remediation

YOU **MUST** COMPLETE AND ATTACH ADDITIONAL DIVISION OF WATER RESOURCES FORM(S) PROVIDING INFORMATION TO SUBSTANTIATE YOUR REQUEST FOR THE AMOUNT OF WATER FOR THE INTENDED USE REFERENCED ABOVE.

For Office Use Only:
F.O. GMD Meets K.A.R. 5-3-1 (YES / NO) Use IRZ Source G/S County CY By AW Date 4/10/16
Code PER Fee \$ 300 TR # 16041252 Receipt Date 4/7/16 Check # 1628

SCANNED

4/18/2016 UM

60 Days to locate

File No. _____

5. The location of the proposed wells, pump sites or other works for diversion of water is:

Note: For the application to be accepted, the point of diversion location must be described to at least a 10 acre tract, unless you specifically request a 60 day period of time in which to locate the site within a specifically described, minimal legal quarter section of land.

(A) One in the _____ quarter of the _____ quarter of the SE quarter of Section 20, more particularly described as being near a point _____ feet North and _____ feet West of the Southeast corner of said section, in Township 08 South, Range 04 EAST, CLAY County, Kansas.

(B) One in the _____ quarter of the _____ quarter of the _____ quarter of Section _____, more particularly described as being near a point _____ feet North and _____ feet West of the Southeast corner of said section, in Township _____ South, Range _____ East/West (circle one), _____ County, Kansas.

(C) One in the _____ quarter of the _____ quarter of the _____ quarter of Section _____, more particularly described as being near a point _____ feet North and _____ feet West of the Southeast corner of said section, in Township _____ South, Range _____ East/West (circle one), _____ County, Kansas.

(D) One in the _____ quarter of the _____ quarter of the _____ quarter of Section _____, more particularly described as being near a point _____ feet North and _____ feet West of the Southeast corner of said section, in Township _____ South, Range _____ East/West (circle one), _____ County, Kansas.

If the source of supply is groundwater, a separate application shall be filed for each proposed well or battery of wells, except that a single application may include up to four wells within a circle with a quarter (1/4) mile radius in the same local source of supply which do not exceed a maximum diversion rate of 20 gallons per minute per well.

A battery of wells is defined as two or more wells connected to a common pump by a manifold; or not more than four wells in the same local source of supply within a 300 foot radius circle which are being operated by pumps not to exceed a total maximum diversion rate of 800 gallons per minute and which supply water to a common distribution system.

6. The owner of the point of diversion, if other than the applicant is (please print):

Allen Leidy 627 Prospect St Clay Center KS 67432
(name, address and telephone number)
785-447-3274
(name, address and telephone number)

You must provide evidence of legal access to, or control of, the point of diversion from the landowner or the landowner's authorized representative. Provide a copy of a recorded deed, lease, easement or other document with this application. In lieu thereof, you may sign the following sworn statement:

I have legal access to, or control of, the point of diversion described in this application from the landowner or the landowner's authorized representative. I declare under penalty of perjury that the foregoing is true and correct.

Executed on 4/7, 2016. Ch Leidy
Applicant's Signature

The applicant must provide the required information or signature irrespective of whether they are the landowner. Failure to complete this portion of the application will cause it to be unacceptable for filing and the application will be returned to the applicant.

7. The proposed project for diversion of water will consist of BATTERY OF 4 WELLS
(number of wells, pumps or dams, etc.)
and WILL BE completed (by) 2017
(Month/Day/Year - each was or will be completed)

8. The first actual application of water for the proposed beneficial use was or is estimated to be 2017
(Mo/Day/Year)

9. Will pesticide, fertilizer, or other foreign substance be injected into the water pumped from the diversion works?
 Yes No If "yes", a check valve shall be required.

All chemigation safety requirements must be met including a chemigation permit and reporting requirements.

10. If you are planning to impound water, please contact the Division of Water Resources for assistance, prior to submitting the application. Please attach a reservoir area capacity table and inform us of the total acres of surface drainage area above the reservoir.

Have you also made an application for a permit for construction of this dam and reservoir with the Division of Water Resources? Yes No

- If yes, show the Water Structures permit number here _____
- If no, explain here why a Water Structures permit is not required _____

11. The application must be supplemented by a U.S.G.S. topographic map, aerial photograph or a detailed plat showing the following information. On the topographic map, aerial photograph, or plat, identify the center of the section, the section lines or the section corners and show the appropriate section, township and range numbers. Also, please show the following information:

- (a) The location of the proposed point(s) of diversion (wells, stream-bank installations, dams, or other diversion works) should be plotted as described in Paragraph No. 5 of the application, showing the North-South distance and the East-West distance from a section line or southeast corner of section.
- (b) If the application is for groundwater, please show the location of any existing water wells of any kind within 1/2 mile of the proposed well or wells. Identify each existing well as to its use and furnish the name and mailing address of the property owner or owners. If there are no wells within 1/2 mile, please advise us.
- (c) If the application is for surface water, the names and addresses of the landowner(s) 1/2 mile downstream and 1/2 mile upstream from your property lines must be shown.
- (d) The location of the proposed place of use should be shown by crosshatching on the topographic map, aerial photograph or plat.
- (e) Show the location of the pipelines, canals, reservoirs or other facilities for conveying water from the point of diversion to the place of use.

A 7.5 minute U.S.G.S. topographic map may be obtained by providing the section, township and range numbers to: Kansas Geological Survey, 1930 Constant, Campus West, University of Kansas, Lawrence, Kansas 66047.

12. List any application, appropriation of water, water right, or vested right file number that covers the same diversion points or any of the same place of use described in this application. Also list any other recent modifications made to existing permits or water rights in conjunction with the filing of this application.

REQUEST 60 DAYS TO PROVIDE TEST HOLE LOG AND LOCATION. See map for designated area

WATER RESOURCES
RECEIVED

APR 07 2016

13. Furnish the following well information if the proposed appropriation is for the use of groundwater. If the well has not been completed, give information obtained from test holes, if available.

Information below is from: Test holes Well as completed Drillers log attached

Well location as shown in paragraph No.	(A)	(B)	(C)	(D)
Date Drilled	_____	_____	_____	_____
Total depth of well	_____	_____	_____	_____
Depth to water bearing formation	_____	_____	_____	_____
Depth to static water level	_____	_____	_____	_____
Depth to bottom of pump intake pipe	_____	_____	_____	_____

14. The relationship of the applicant to the proposed place where the water will be used is that of tenant
(owner, tenant, agent or otherwise)

15. The owner(s) of the property where the water is used, if other than the applicant, is (please print):
same as point of diversion
(name, address and telephone number)

(name, address and telephone number)

16. The undersigned states that the information set forth above is true to the best of his/her knowledge and that this application is submitted in good faith.

Dated at Manhattan, Kansas, this 7th day of April, 2016.
(month) (year)

Ch [Signature]
(Applicant Signature)

By _____
(Agent or Officer Signature)

(Agent or Officer - Please Print)

Assisted by _____ Date: _____
(office/title)

FEE SCHEDULE

1. The fee for an application for a permit to appropriate water for beneficial use, except for domestic use, shall be (see paragraph No. 2 below if requesting storage):

ACRE-FEET	FEE
0-100	\$200.00
101-320	\$300.00
More than 320	\$300.00 plus \$20.00 for each additional 100 acre-feet or any part thereof.

2. The fee for an application in which storage is requested, except for domestic use, shall be:

ACRE-FEET	FEE
0-250	\$200.00
More than 250	\$200.00 plus \$20.00 for each additional 250 acre-feet of storage or any part thereof.

Note: If an application requests both direct use *and* storage, the fee charged shall be as determined under No. 1 or No. 2 above, whichever is greater, but not both fees.

3. The fee for an application for a permit to appropriate water for water power or dewatering purposes shall be \$100.00 plus \$200.00 for each 100 cubic feet per second, or part thereof, of the diversion rate requested.

Note: The applicant shall notify the Chief Engineer and pay the statutorily required field inspection fee of \$400.00 when construction of the works for diversion has been completed, except that for applications filed on or after July 1, 2009, for works constructed for sediment control use and for evaporation from a groundwater pit for industrial use shall be accompanied by a field inspection fee of \$200.00.

MAKE CHECKS PAYABLE TO THE KANSAS DEPARTMENT OF AGRICULTURE

ATTENTION

A Water Conservation Plan may be required per K.S.A. 82a-733. A statement that your application for permit to appropriate water may be subject to the minimum desirable streamflow requirements per K.S.A. 82a-703a, b, and c may also be required from you. After the Division of Water Resources has had the opportunity to review your application, you will be notified whether or not you will need to submit a Water Conservation Plan. You also may be required to install a water flow meter or water stage measuring device on your diversion works prior to diverting water. There may be other special conditions or Groundwater Management District regulations that you will need to comply with if this application is approved.

CONVERSION FACTORS

1 acre-foot equals 325,851 gallons

1 million gallons equal 3.07 acre-feet

WATER RESOURCES
RECEIVED

APR 07 2016

SCANNED

KS DEPT OF AGRICULTURE

IRRIGATION USE SUPPLEMENTAL SHEET

File No. 49,610

Name of Applicant (Please Print): CHRIS SPELTZ

1. Please supply the name and address of each landowner, the legal description of the lands to be irrigated, and designate the actual number of acres to be irrigated in each forty acre tract or fractional portion thereof:

Landowner of Record NAME: _____

ADDRESS: _____

S	T	R	NE¼				NW¼				SW¼				SE¼				TOTAL		
			NE	NW	SW	SE	NE	NW	SW	SE	NE	NW	SW	SE	NE	NW	SW	SE			
20	08S	04E										10				28	40	40	40	40	198

Landowner of Record NAME: _____

ADDRESS: _____

S	T	R	NE¼				NW¼				SW¼				SE¼				TOTAL		
			NE	NW	SW	SE	NE	NW	SW	SE	NE	NW	SW	SE	NE	NW	SW	SE			

Landowner of Record NAME: _____

ADDRESS: _____

S	T	R	NE¼				NW¼				SW¼				SE¼				TOTAL		
			NE	NW	SW	SE	NE	NW	SW	SE	NE	NW	SW	SE	NE	NW	SW	SE			

2. Please complete the following information for the description of the operation for the irrigation project. Attach supplemental sheets as needed.

a. Indicate the soils in the field(s) and their intake rates:

Soil Name	Percent of field (%)	Intake Rate (in/hr)	Irrigation Design Group
_____	_____	_____	_____
_____	_____	_____	_____
_____	_____	_____	_____
_____	_____	_____	_____
Total:	100 %		

b. Estimate the average land slope in the field(s): _____%

Estimate the maximum land slope in the field(s): _____%

c. Type of irrigation system you propose to use (check one):

Center pivot _____ Center pivot - LEPA _____ "Big gun" sprinkler
 Gravity system (furrows) _____ Gravity system (borders) _____ Sideroll sprinkler

Other, please describe: _____

d. System design features:

i. Describe how you will control tailwater: TILLAGE PRACTICES

ii. For sprinkler systems:

(1) Estimate the operating pressure at the distribution system: 30 _____ psi

(2) What is the sprinkler package design rate? 800 _____ gpm

(3) What is the wetted diameter (twice the distance the sprinkler throws water) of a sprinkler on the outer 100 feet of the system? _____ feet

(4) Please include a copy of the sprinkler package design information.

e. Crop(s) you intend to irrigate. Please note any planned crop rotations:

f. Please describe how you will determine when to irrigate and how much water to apply (particularly important if you do not plan a full irrigation). SOIL MOISTURE

You may attach any additional information you believe will assist in informing the Division of the need for your request.

(Date)

Kansas Department of Agriculture
Division of Water Resources
David W. Barfield, Chief Engineer
1320 Research Park Drive
Manhattan, Kansas 66502

Re: Application
File No. 49,610

Minimum Desirable Streamflow

Dear Sir:

I understand that a Minimum Desirable Streamflow requirement has been established by the legislature for the source of supply to which the above referenced application applies.

I understand that diversion of water pursuant to this application will be subject to regulation any time Minimum Desirable Streamflow requirements are not being met.

I also understand that if this application is approved, there could be times, as determined by the Division of Water Resources, when I would not be allowed to divert water. I realize that this could affect the economics of my decision to appropriate water.

I am aware of the above factors, and with the knowledge thereof, request that the Division of Water Resources proceed with processing and approval, if possible, of the above referenced application.

Signature of Applicant



State of Kansas)

) ss (Print Applicant's Name)

County of)

Chris Speltz
Allen Heidig

WATER RESOURCES
RECEIVED

APR 07 2016

I hereby certify that the foregoing instrument was signed in my presence and sworn to before me this day of 47, 2016

KS DEPT OF AGRICULTURE

SCANNED

Dolores J. Burchett Notary Public

My Commission Expires: 3-5-2019



DWR 1-100.171 (Revised 06/16/2014)

**MINIMUM DESIRABLE STREAMFLOW FORM TO BE USED WHEN
APPLICABLE WHEN FILING AN APPLICATION FOR PERMIT
TO APPROPRIATE WATER FOR BENEFICIAL USE**

The Kansas Legislature has established minimum desirable streamflows for the streams listed below. If your proposed diversion of water is going to be from one of these watercourses or adjacent alluvial aquifers, please complete the back side of this page and submit it along with your application for permit to appropriate water.

- | | |
|---------------------------------|----------------------------|
| Arkansas River | Ninnescah River |
| Big Blue River | North Fork Ninnescah River |
| Chapman Creek | Rattlesnake Creek |
| Chikaskia River | Republican River |
| Cottonwood River | Saline River |
| Delaware River | Smoky Hill River |
| Little Arkansas River | Solomon River |
| Little Blue River | South Fork Ninnescah |
| Marais des Cygnes River | Spring River |
| Medicine Lodge River | Walnut River |
| Mill Creek (Wabaunsee Co. area) | Whitewater River |
| Neosho River | |

DWR 1-100.171 (Revised 06/16/2014)

WATER RESOURCES
RECEIVED

APR 07 2016

KS DEPT OF AGRICULTURE
SCANNED

New Application
Chris Speltz 20-08S-04E

49,610

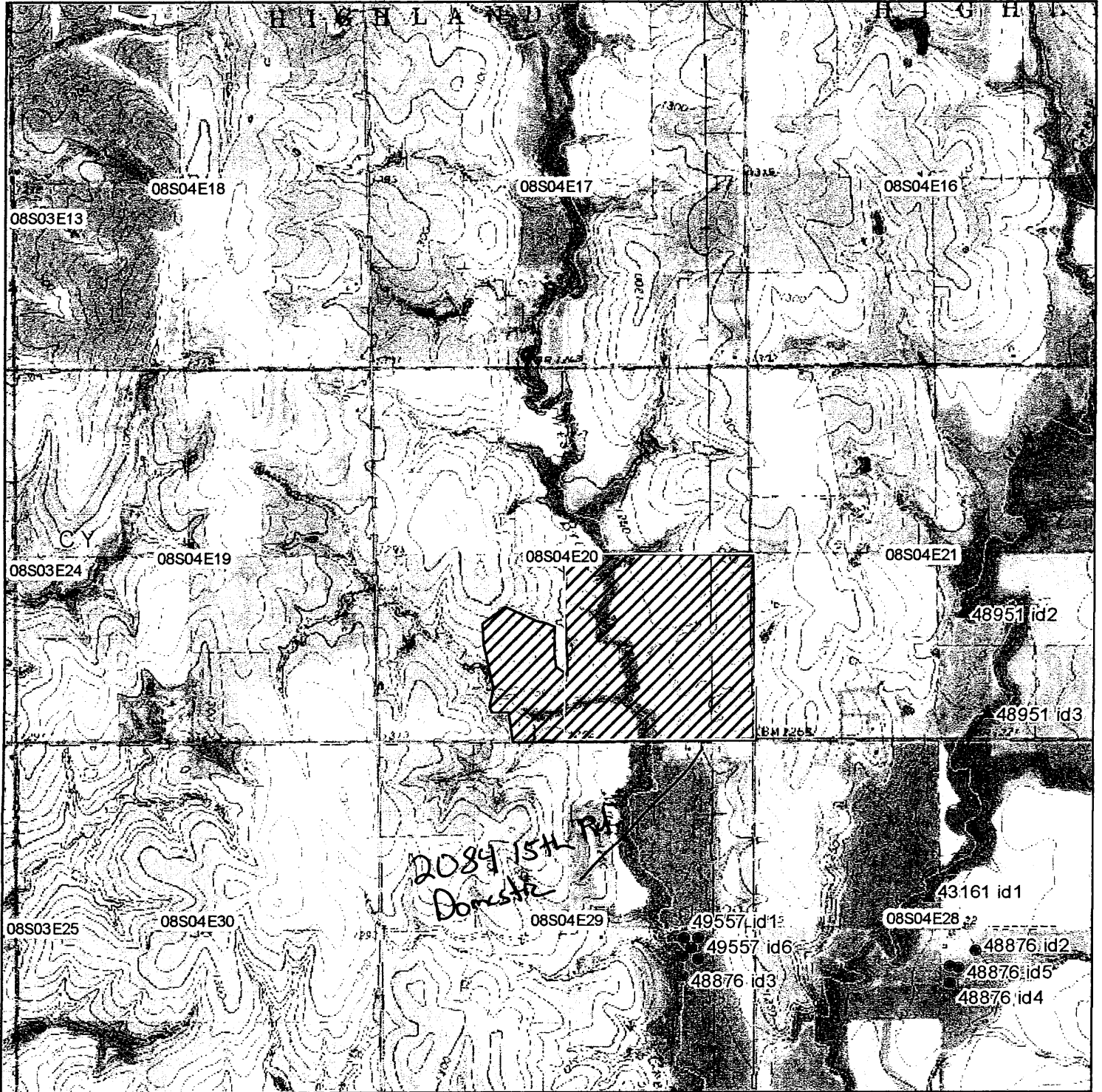

Proposed Place of Use

▲ Surface Water Point of Diversion

● Groundwater Point of Diversion

+ WWC-5 Records

1:24,000

Chris Speltz

All wells within 1/2 mile of proposed well location are identified on the map.

160 acre tract for WATER RESOURCES RECEIVED test hole exploration



APR 07 2016 SCANNED

1320 Research Park Drive
Manhattan, Kansas 66502
(785) 564-6700



900 SW Jackson, Room 456
Topeka, Kansas 66612
(785) 296-3556

Jackie McClaskey, Secretary

Governor Sam Brownback

September 23, 2016

FILE COPY

CHRIS SPELTZ
1417 PRAIRIE RD
CLAY CENTER KS 67432

Re: Pending Applications,
File Nos. 49,610

Dear Sir or Madam:

The Division of Water Resources returned the above referenced applications to you for additional information on April 20, 2016, and the current deadline for your response is October 22, 2016. The purpose of this letter is to provide a reminder that in order for you to retain your priority of filing, the original applications and requested information needs to be returned to this office on or before **October 22, 2016**, or within any authorized extension of time thereof. According to law, default in refiling of the completed applications and attachments within the time allowed shall constitute forfeiture of priority date and dismissal of the applications.

If an extension of time is necessary to supply the requested information, please request the extension of time in writing before **October 22, 2016**. Provide information as to why the additional time is needed and how much additional time is requested. Please note that since there are instances when the Chief Engineer may deny your request for an extension of time, there is no guarantee that future requests for more time will be granted.

If you have any questions, please contact me at (785) 564-6631 or by email at alex.whitesell@ks.gov. If you wish to discuss a specific file, please have the file number ready so that I may help you more efficiently.

Sincerely,

Alex Whitesell
Environmental Scientist
Water Appropriation Program

pc: Topeka Field Office
Stockton Field Office

SCANNED

1320 Research Park Drive
Manhattan, Kansas 66502
(785) 564-6700



900 SW Jackson, Room 456
Topeka, Kansas 66612
(785) 296-3556

Jackie McClaskey, Secretary

Governor Sam Brownback

August 19, 2016

FILE COPY

CHRIS SPELTZ
1417 PRAIRIE RD
CLAY CENTER KS 67432

Re: Pending Applications,
File Nos. 49,610

Dear Sir or Madam:

In response to your written request received in this office on August 17, 2016, the Chief Engineer is allowing an extension of time for sixty (60) days, in which to supply further information concerning the above referenced file. The original applications were returned to you on April 20, 2016, and with this extension of time, the revised deadline will be **October 22, 2016**.

Extension requests are evaluated on a case by case basis. Since it appears that no pending application would be adversely affected by granting this extension, you are being allowed an additional 60 days. If you determine that additional time will be needed, you may submit another request for an extension prior to the deadline given above. Please note that since there are instances when the Chief Engineer may deny your request for an extension of time, there is no guarantee that future requests for more time will be granted.

In order to retain their priority of filing, the original applications and attachments must be returned to this office with the requested information on or before **October 22, 2016**, or within any authorized extension of time thereof. According to law, default in refiling of the completed applications and attachments within the time allowed shall constitute forfeiture of priority date and dismissal of the applications.

If you have any questions, please contact me at (785) 564-6631 or by email at alex.whitesell@kda.ks.gov. If you wish to discuss a specific file, please have the file number ready so that I may help you more efficiently.

Sincerely,

Alex Whitesell
Environmental Scientist
Water Appropriation Program

pc: Topeka Field Office
Stockton Field Office

SCANNED

8-17-14

Would like to hire a
different test drill later
this year.

Gene Ludwig

File No. 49,610

WATER RESOURCES
RECEIVED

AUG 17 2016

KS DEPT OF AGRICULTURE

SCANNED

1320 Research Park Drive
Manhattan, Kansas 66502
(785) 564-6700



900 SW Jackson, Room 456
Topeka, Kansas 66612
(785) 296-3556

Jackie McClaskey, Secretary

Governor Sam Brownback

July 25, 2016

CHRIS SPELTZ
1417 PRAIRIE RD
CLAY CENTER KS 67432

FILE COPY

Re: Pending Applications,
File Nos. 49,609, 49,610 and 49,611

Dear Sir or Madam:

The Division of Water Resources returned the above referenced applications to you for additional information on April 20, 2016, and the current deadline for your response is August 22, 2016. The purpose of this letter is to provide a reminder that in order for you to retain your priority of filing, the original applications and requested information needs to be returned to this office on or before **August 22, 2016**, or within any authorized extension of time thereof. According to law, default in refiling of the completed applications and attachments within the time allowed shall constitute forfeiture of priority date and dismissal of the applications.

If an extension of time is necessary to supply the requested information, please request the extension of time in writing before **August 22, 2016**. Provide information as to why the additional time is needed and how much additional time is requested. Please note that since there are instances when the Chief Engineer may deny your request for an extension of time, there is no guarantee that future requests for more time will be granted.

If you have any questions, please contact me at (785) 564-6631 or by email at alex.whitesell@ks.gov. If you wish to discuss a specific file, please have the file number ready so that I may help you more efficiently.

Sincerely,

Alex Whitesell
Environmental Scientist
Water Appropriation Program

pc: Topeka Field Office
Stockton Field Office

SCANNED

1320 Research Park Drive
Manhattan, Kansas 66502
(785) 564-6700



900 SW Jackson, Room 456
Topeka, Kansas 66612
(785) 296-3556

Jackie McClaskey, Secretary

Governor Sam Brownback

May 24, 2016

CHRIS SPELTZ
1417 PRAIRIE RD
CLAY CENTER KS 67432

Re: Pending Applications,
File Nos. 49,609, 49,610 and 49,611

Dear Sir or Madam:

The Division of Water Resources returned the above referenced applications to you for additional information on April 20, 2016, and the current deadline for your response is June 20, 2016. The purpose of this letter is to provide a reminder that in order for you to retain your priority of filing, the original applications and requested information needs to be returned to this office on or before **June 20, 2016**, or within any authorized extension of time thereof. According to law, default in refiling of the completed applications and attachments within the time allowed shall constitute forfeiture of priority date and dismissal of the applications.

If an extension of time is necessary to supply the requested information, please request the extension of time in writing before **June 20, 2016**. Provide information as to why the additional time is needed and how much additional time is requested. Please note that since there are instances when the Chief Engineer may deny your request for an extension of time, there is no guarantee that future requests for more time will be granted.

If you have any questions, please contact me at (785) 564-6631 or by email at alex.whitesell@kda.ks.gov. If you wish to discuss a specific file, please have the file number ready so that I may help you more efficiently.

Sincerely,

Alex Whitesell
Environmental Scientist
Water Appropriation Program

pc: Topeka Field Office

1320 Research Park Drive
Manhattan, Kansas 66502
(785) 564-6700



900 SW Jackson, Room 456
Topeka, Kansas 66612
(785) 296-3556

Jackie McClaskey, Secretary

Governor Sam Brownback

April 20, 2016

CHRIS SPELTZ
1417 PRAIRIE RD
CLAY CENTER KS 67432

Re: Pending Applications,
File Nos. 49,609, 49,610 and 49,611

Dear Mr. Speltz:

After a preliminary review of your above referenced applications for permits to appropriate water received in this office on April 7, 2016, they are being returned to you for additional information. In your original applications, you requested a 60-day period of time in which to determine the precise locations for your points of diversion within specified quarter section tracts of land described as:

- the Southwest Quarter (SW¹/₄) of Section 27, in Township 9 South, Range 3 West, Ottawa County, Kansas
- the Southeast Quarter (SE¹/₄) of Section 20, in Township 8 South, Range 4 East, Clay County, Kansas
- the Northwest Quarter (NW¹/₄) of Section 9, in Township 11 South, Range 3 West, Ottawa County, Kansas

Once you've determined the precise locations for your points of diversion, complete the rest of Paragraph No. 5 for each of your applications by providing the description for the 10-acre tract location of the point of diversion as well as the feet distances North and West of the Southeast corner of the Section. The locations of the points of diversion must also be plotted on the topographical map(s) included. In the case of a battery of wells, please provide the description of the location of the proposed geographic center of the well battery, as well as **the location for each of the individual wells comprising the battery of wells**.

The locations of all other water wells of every kind within one-half mile (¹/₂) of the points of diversion must be plotted on the topographical map(s) as well. Each well should be identified as to its use (e.g. domestic, irrigation, industrial, etc.) and must **include the name and mailing address of the well owner**. A signed statement should be included on the map(s) declaring that all wells within one-half mile (¹/₂) of the points of diversion have been plotted, or it should declare that none exist. Your applications currently include this information; please verify the information is correct once you have established your points of diversion.

Paragraph No. 13 of the application requests well information so the source of supply of the proposed wells may be determined. Pursuant to K.A.R. 5-3-4d, this office requires a stratigraphic log of wells or test holes within 300 feet of the proposed points of diversion. Please supply the indicated information and test hole logs or driller's logs with the returned applications.

(over)

SCANNED

Chris Speltz
April 20, 2016
Page 2 of 2

In order to retain their priority of filing, the original applications and attachments must be returned to this office with the requested information on or before **June 20, 2016**, or within any authorized extension of time thereof. According to law, default in refiling of the completed applications and attachments within the time allowed shall constitute forfeiture of priority date and dismissal of the applications.

If you have any questions, please contact me at (785) 564-6631 or by email at alex.whitesell@kda.ks.gov. If you wish to discuss a specific file, please have the file number ready so that I may help you more efficiently.

Sincerely,



Alex Whitesell
Environmental Scientist
Water Appropriation Program

enclosures

pc: Topeka Field Office
Stockton Field Office



1320 Research Park Drive
Manhattan, Kansas 66502
Jackie McClaskey, Secretary

Phone: (785) 564-6700
Fax: (785) 564-6777
Email: ksag@kda.ks.gov
www.agriculture.ks.gov
Sam Brownback, Governor

April 13, 2016

CHRIS SPELTZ
1417 PRAIRIE RD
CLAY CENTER KS 67432

RE: Application
File No. 49610

Dear Sir or Madam:

Your application for permit to appropriate water in 20-8S-4E in Clay County, was received and has been assigned the file number noted above.

As a matter of record, the Division of Water Resources has on hand a large number of applications awaiting processing. Therefore to be fair to all concerned, and so that we can process those applications on hand in the order they were received, we intend to concentrate on the backlog of applications until the issue is resolved. Once review of your application has begun, we will contact you, if additional information is required.

In accordance with the provisions of the Kansas Water Appropriation Act, a portion of which is included below, the use of water as proposed prior to approval of the application is unlawful. Once approved, compliance with the terms, conditions and limitations of the permit is necessary. Conservation of the water resources of Kansas is required.

Section 82a-728 of the Kansas Water Appropriation Act, provides (a) except for the appropriation of water for the purpose of domestic use, . . . it shall be unlawful for any person to appropriate or threaten to appropriate water from any source without first applying for and obtaining a permit to appropriate water in accordance with the provisions of the Water Appropriation Act or for any person to violate any condition of a vested right, appropriation right or an approved application for a permit to appropriate water for beneficial use.

(b) (1) The violation of any provision of this section by any person is a class C misdemeanor . . .

A class C misdemeanor is punishable by a fine not to exceed \$500 and/or a term of confinement not to exceed one month in the county jail. Each day that the violation occurs constitutes a separate offense.

If you have any questions, please contact me at (785) 564-6645. If you wish to discuss a specific file, please have the file number ready so that we may help you more efficiently.

Sincerely,

A handwritten signature in cursive script that reads "Brent A. Turney".

Brent A Turney, L.G.
New Application Unit Supervisor
Water Appropriation Program

KAK: DLW
pc: TOPEKAField Office
GMD

SCANNED