

**Kansas Department of Agriculture  
Division of Water Resources  
PERMIT OF NEW APPLICATION WORKSHEET**

1. File Number: <b>49,638</b>		2. Status Change Date: <b>11/1/2016</b>		3. Field Office: <b>01</b>		4. GMD: <b>0</b>	
5. Status: <input checked="" type="checkbox"/> Approved <input type="checkbox"/> Denied by DWR/GMD <input type="checkbox"/> Dismiss by Request/Failure to Return							
6. Enclosures: <input checked="" type="checkbox"/> Check Valve <input checked="" type="checkbox"/> N of C Form <input checked="" type="checkbox"/> Water Tube <input checked="" type="checkbox"/> Driller Copy <input checked="" type="checkbox"/> Meter							
7a. Applicant(s) New to system <input type="checkbox"/> Person ID <b>8979</b> Add Seq# _____				7c. Landowner(s) New to system <input type="checkbox"/> Person ID _____ Add Seq# _____			
CITY OF JUNCTION CITY ENGINEERING DEPT PO BOX 287 JUNCTION CITY KS 66441-0287							
7b. Landowner(s) New to system <input type="checkbox"/> Person ID _____ Add Seq# _____				7d. Misc. New to system <input type="checkbox"/> Person ID _____ Add Seq# _____			
7a.				KANSAS RIVER WATER ASSURANCE DISTRICT NO 1 % GALEN BIERY 212 SW 7 <sup>TH</sup> STREET TOPEKA KS 66603-3717			
8. WUR Correspondent New to system <input type="checkbox"/> Person ID _____ Add Seq# _____ Overlap File (s) WUC Agree <input type="checkbox"/> Yes <input type="checkbox"/> No                   Notarized WUC Form <input type="checkbox"/>				9. Use of Water:   Changing? <input type="checkbox"/> Yes <input checked="" type="checkbox"/> No <input checked="" type="checkbox"/> Groundwater <input type="checkbox"/> Surface Water <input type="checkbox"/> IRR <input type="checkbox"/> REC <input type="checkbox"/> DEW <input checked="" type="checkbox"/> MUN <input type="checkbox"/> STK <input type="checkbox"/> SED <input type="checkbox"/> DOM <input type="checkbox"/> CON <input type="checkbox"/> HYD DRG <input type="checkbox"/> WTR PWR <input type="checkbox"/> ART RECHRG <input type="checkbox"/> IND SIC: _____ <input type="checkbox"/> OTHER: _____			
10. Completion Date: <b>12/31/2017</b>		11. Perfection Date: <b>12/31/2036</b>		12. Exp Date: _____			
13. Conservation Plan Required? <input type="checkbox"/> Yes <input checked="" type="checkbox"/> No Date Required: _____ Date Approved: _____ Date to Comply: _____							
14. Water Level Measuring Device? <input type="checkbox"/> Yes <input checked="" type="checkbox"/> No Date to Comply: _____ Date WLMD Installed: _____							
Date Prepared: <b>10/25/2016</b> By: <b>DWS</b> Date Entered: <b>11/3/2016</b> By: <b>UM</b>							

File No. <b>49,638</b>	15. Formation Code: 113	Drainage Basin: <b>REPUBLICAN River</b>	County: <b>GE</b>	Special Use:	Stream:																				
16. Points of Diversion			17. Rate and Quantity <b>MOD ADDL QTY</b>																						
T MOD DEL ENT	PDIV	Qualifier	S	T	R	ID	'N	'W	Rate gpm	Quantity mgy	Rate gpm	Quantity mgy	Overlap PD Files												
√	<b>85314</b>	<b>NW SE SE</b>	<b>35</b>	<b>11</b>	<b>5E</b>	<b>13</b>	<b>860</b>	<b>1280</b>	<b>1500</b>	<b>430.123</b>	<b>1500</b>	<b>32.2</b>	<b>NONE</b>												
(add to Comment Line: <b>Special Section 12) #20</b>																									
18. Storage: Rate _____ NF Quantity _____ ac/ft Additional Rate _____ NF Additional Quantity _____ ac/ft																									
19. Limitation: <b>2090.8</b> mg/yr at _____ gpm (_____ cfs) when combined with file number(s) <b>GE-2; 9,658; 23,804; 49,126; 49,127; 49,128; 49,129; and 49,130</b> Limitation: _____ af/yr at _____ gpm (_____ cfs) when combined with file number(s) _____																									
20. Meter Required? <input checked="" type="checkbox"/> Yes <input type="checkbox"/> No To be installed by <b>12/31/2017</b> Date Acceptable Meter Installed _____																									
21. Place of Use		NE¼				NW¼				SW¼				SE¼				Total	Owner	Chg?	NO	Overlap Files			
T MOD DEL ENT	PUSE	S	T	R	ID	NE ¼	NW ¼	SW ¼	SE ¼	NE ¼	NW ¼	SW ¼	SE ¼	NE ¼	NW ¼	SW ¼	SE ¼								
√	<b>3003</b>	<b>1</b>	<b>12</b>	<b>5E</b>	<b>1</b>	CITY OF JUNCTION CITY & IMMEDIATE VICINITY																	<b>7a.</b>	<b>No</b>	<b>*see below</b>
√	<b>6040</b>	<b>1</b>	<b>12</b>	<b>5E</b>	<b>2</b>	WITHIN BOUNDARIES OF GEARY RWD 01																	<b>7a.</b>	<b>No</b>	<b>*see below</b>
√	<b>20276</b>	<b>16</b>	<b>12</b>	<b>5E</b>	<b>2</b>	ROADSIDE PARK ALONG I-70																	<b>7a.</b>	<b>No</b>	<b>*see below</b>
√	<b>36996</b>	<b>21</b>	<b>12</b>	<b>5E</b>	<b>1</b>	ROADSIDE PARK ALONG I-70																	<b>7a.</b>	<b>No</b>	<b>*see below</b>
√	<b>33085</b>	<b>22</b>	<b>12</b>	<b>5E</b>	<b>1</b>	INDUSTRIAL PARK (NE)																	<b>7a.</b>	<b>No</b>	<b>*see below</b>
ENT	<b>504</b>	<b>5</b>	<b>12</b>	<b>6E</b>	<b>2</b>	CITY OF GRANDVIEW PLAZA & IMMEDIATE VICINITY																	<b>7a.</b>	<b>No</b>	<b>*see below</b>
DEL	<b>604</b>																								
Comments: <b>Water Right File Nos. GE-2; 9,658; 23,804; 49,126; 49,127; 49,128; 49,129; and 49,130 all overlap in Place of Use.</b> <b>*The City is an eligible member of the Kansas River WAD.</b>																									

Kansas Department of Agriculture  
 Division of Water Resources  
**WAIVER REQUEST & WAIVER RULE WORKSHEET**

File Number: **49,638**

FO: 1 GMD: 0       

**WAIVER REQUEST:**

UMW	Date Requested	Rule ID	Applies	Rule Type	Rule Subtype
<b>MUN</b>	<b>10/25/2016</b>	<b>53</b>	<b>Statewide</b>	<b>Safe Yield</b>	<b>Yield of Unconfined Groundwater Exceeded</b>
Rule Number	Date Granted	Date Denied	Justification:	The applicant is a member of the Kansas River Water Assurance District No. 1 and storage water is available. The Kansas Water Office supports the application, and the proposed use of water is in the public interest. This waiver is consistent with similar applications that rely on assurance district support.	
<b>K.A.R. 5-3-11</b>	<b>11/1/2016</b>				

**WAIVER RULE:**

Rule ID	Applicability	Type	Subtype	Rule Number	Date Active	Date Inactive

Date Prepared **10/25/2016** By **dws**

Date Entered **11/1/2016** By **UM**

THE STATE OF KANSAS



**KANSAS DEPARTMENT OF AGRICULTURE**  
Jackie McClaskey, Secretary of Agriculture

**DIVISION OF WATER RESOURCES**  
David W. Barfield, Chief Engineer

**WAIVER OF REGULATION**  
**K.A.R. 5-3-11 Safe Yield**

Date: Nov 11, 2016.

Re: Appropriation of Water, File No. 49,638

1. That this application is proposing to install a new well immediately adjacent to an existing municipal water supply well field authorized under Vested Water Right, File No. GE 002; and Water Right, File Nos. 9,658 and 23,804. The source of water is the Republican River alluvium.
2. That the application does not meet safe yield criteria as set forth in K.A.R. 5-3-11.
3. That the applicant is a member of the Kansas River Water Assurance District No. 1 as determined by the Chief Engineer, with the current well field authorized under Vested Water Right, File No. GE 002; and Water Right, File Nos. 9,658 and 23,804, determined to benefit from releases made by the District.
4. That the Kansas River Water Assurance District No. 1 has not indicated any concern regarding this pending application, and will be able to support this application with releases of assurance storage water from Milford Reservoir.
5. That the Kansas Water Office has determined that there is sufficient storage that can be yielded from this assurance reservoir to benefit the City of Junction City.
6. That a waiver of safe yield when supported by assurance district releases is consistent with how the Division of Water Resources has previously processed similar applications.
7. That the waiver will not prejudicially or unreasonably affect the public interest because the requested water is supported by the Kansas River Water Assurance District No. 1, and senior rights will not be impaired by the proposed use.

Comments:

A handwritten signature in black ink, reading "David W. Barfield", written over a horizontal line.

David W. Barfield, P.E.  
Chief Engineer  
Division of Water Resources  
Kansas Department of Agriculture

**KANSAS DEPARTMENT OF AGRICULTURE**  
**Division of Water Resources**  
**M E M O R A N D U M**

**TO:** Files

**DATE:** October 25, 2016

**FROM:** Doug Schemm

**RE:** New Application, File No. 49,638;  
Change Applications, Vested Water Right, File No. GE-002;  
and Water Right, File Nos. 9,658 and 23,804

The City of Junction City has filed the referenced new application (File No. 49,638) to appropriate 430.123 million gallons (1,320 acre-feet) of groundwater from a proposed new well for municipal use. There are no overlapping files on the proposed point of diversion (which will be designated as City Well No. 20). However, the applicant has multiple water rights that overlap the place of use, including Vested Water Right, File No. GE-02, Water Right, File Nos. 9,658 and 23,804, and Appropriation of Water, File Nos. 49,126; 49,127; 49,128; 49,129; and 49,130. In addition, the City is redrilling one of their municipal supply wells (Well #16) due to a collapsed screen, and has submitted change applications under File Nos. GE-02, 9,658 and 23,804 to change the point of diversion (which will be designated as City Well #19).

The applicant's engineering consultant, (HDR) has provided significant information in support of both the increase in overall quantity of water under the new application, and the change in point of diversion of 125 feet from the existing well.

Vested Water Right, File No. GE-02 is authorized 575 million gallons, and Water Right, File No. 9,658 is authorized 819.019 million gallons limited to 819.019 million gallons when combined with the senior file. Water Right, File No. 23,804 has 10 authorized wells, with a "blanket" rate of diversion and quantity of water, both limited when combined with the senior water rights to 6,925 gpm and 1,529.87 million gallons (4,695 acre-feet) per year. File Nos. 49,126; 49,127; 49,128; 49,129; and 49,130 combined provided an additional 528.73 million gallons for a current authorized total of **2,058.6 million gallons** (6,317.6 acre-feet) per year. Pending Application, File No. 49,638 is requesting 430.123 million gallons at a diversion rate of 1,500 gallons per minute. However, only 32.2 million gallons is additional water, which will increase the City's overall quantity of water from 2,058.6 million gallons to **2,090.8 million gallons** when combined with the senior files. As noted above, this is the City's projected water need in 2056 (see Table 2-4 in supporting data). Their revised engineering report shows that water demands will reach 2,090.8 million gallons by 2056 and population will be 31,718.

The applicant also provided significant supporting information during the processing of senior files, File Nos. 49,126; 49,127; 49,128; 49,129; and 49,130, including an engineering analysis report, to justify the requested increase in both quantity of water and rate of diversion. The information on the municipal use supplemental sheets for these senior files indicated that the City had experienced a significant population growth in the last 20 years from 21,000 to 25,817 in 2013. In both 2011 and 2012, the applicant exceeded both their authorized quantity of water and their authorized rate of diversion under their senior files.

The Kansas Water Office (KWO) has also projected a similar significant expansion with population growth for the City from 21,711 in 2000 to 24,841 in 2040, with a related water demand in 2040 of 1,278 million gallons. The other entities served by the City increases water demand in 2040 to over 1,337 million gallons. The City is likely to surpass the KWO 2040 population estimate in calendar year 2016. The applicant indicates that current water usage is equivalent to 137.9 gallons per capita per day (GPCD). The 2011 Kansas Municipal Water Use publication indicates that the City used an average of 150 GPCD, while the regional average for large public water suppliers in Region 7 was 132 GPCD. Using the City's average value of 150 gpcd, and based on their population projection of 31,718 by 2056 (included in the engineering report), the following estimate for water usage can be determined:  $31,718 \times 150 \text{ gallons} \times 365 \text{ days} = 1,736 \text{ million gallons}$ . Water sold to other public water suppliers and bulk customers (273.5 million gallons), is also likely to increase substantially. Adding the water sold quantity on to the population projection provides for a projected total of 2,010 million gallons per year. Therefore, based on the City's current usage and projections, the requested quantity of 2,090.8 million gallons per year when all rights are combined appears reasonable.

Based on well information contained in the engineering report, and information from the KGS well completion database, the subsurface lithology is comprised of alternating sand and gravel to depths ranging from 53 feet to 74 feet below ground surface where shale or limestone bedrock is encountered. Static water levels range from 25 feet to 40 feet below ground surface. The engineering report notes that well pumping rates are limited by the relatively thin saturated thickness of the aquifer. The physical location of the wells and the subsurface lithology, indicate that the source of water is the Republican River alluvium.

The area of consideration for the pending new application was based on information from File Nos. 49,126; 49,127; 49,128; 49,129; and 49,130, in order to maintain consistency. This provided a delineation of the extent of the alluvial aquifer (area of consideration) of 6,847 acres, a recharge of 3.2 inches, and with 75% available, a safe yield quantity of 1,369 acre-feet. There are multiple existing water rights in the local area that have appropriated over 7,228 acre-feet (the majority of this quantity is the applicant's senior files). For this pending application, there is no quantity of water available for appropriation. However, per a determination by the Chief Engineer, the applicant's senior water rights are eligible water rights within the Kansas River Water Assurance District No. 1 and they benefit from releases of assurance water. This new well is part of this same well field adjacent to the river. The City has requested a waiver of safe yield. Therefore, because the water requested by this pending application would be supported by Kansas River Water Assurance District No. 1, a **waiver** of safe yield (K.A.R. 5-3-11) is recommended. Releases of storage water from Milford Reservoir will provide adequate recharge to the alluvial source for these wells. A waiver of safe yield for new applications supported by water assurance district releases is consistent with other member applications throughout the state.

As noted above, the proposed point of diversion is a new well, but is part of an existing well field currently authorized under senior water rights (File Nos. GE-02, 9,658 and 23,804). The individual wells were installed to operate as a well field in conjunction with each other, and the individual wells do not meet minimum well spacing criteria to each other per the requirements in K.A.R. 5-4-4, which suggest 1,320 feet well spacing for "all other aquifers". Spacing averages about 500 feet apart for the existing wells. However, K.A.R. 5-4-4 also provides that the spacing guidelines are not applicable if the required minimum well spacing criteria are not necessary to prevent direct impairment. There are several unique circumstances that should be considered in this specific instance.

- The wells in a municipal well field are operated as a system, and are not likely to be separated or divided in any way in the future.
- The wells have historically been operated without evidence of impairing each other.
- In addition, as noted above, these wells are primarily dependent on capturing surface water that infiltrates from the Republican River, especially when water is released by the KRWAD No. 1. The reduced well spacing is a key component to this "hydraulic capture" concept. Typically, well spacing is necessary to prevent overlapping cones of influence, which can lead to impairment concerns. However, based on similar well field designs, these wells are intentionally spaced close together to cause overlapping cones of depression and ultimately create a groundwater trough or sink adjacent to the river. This trough greatly increases the ability to capture surface water. Increasing surface water infiltration to the wells is obviously a benefit to the alluvial aquifer because it will minimize the amount of groundwater directly withdrawn from the aquifer.

Based on the specific design of this well field, the well spacing guidelines in K.A.R. 5-4-4, are clearly not relevant in this instance in regards to the City's municipal well field. The minimum well spacing criteria for the applicant's wells is not necessary to prevent direct impairment since direct interference between well drawdown is the desired outcome of pumping these wells to increase surface water infiltration. The proposed new well and the change in point of diversion complies with well spacing from all other existing wells, which will protect the public interest.

As stated above, the City is redrilling one of their municipal supply wells (Well #16) due to a collapsed screen, and has submitted change applications under File Nos. GE-02, 9,658 and 23,804 to change the point of diversion (the new well will be designated as City Well #19). Both the existing well #16 and the proposed well #19 are located within Special Section 12. The proposed well will be located approximately 125 feet Southeast of the currently authorized well based on the submitted map and information from the applicant. The well location appears to meet spacing requirements of K.A.R. 5-4-4(d)(2) *Well spacing* in that a move of 125 feet will not decrease the distance to other wells or authorized well locations by more than 300 feet.

The same local source of supply will not change, which has been previously determined to be Main Stem Alluvium (113). The referenced water rights do not appear abandoned as per K.S.A. 82a-718. A Certificate of Appropriation was recently issued for Water Right, File No. 23,804 (June 16, 2014).

The Kansas River Water Assurance District No. 1 was notified of the pending new and change applications on August 9, 2016 via electronic mail. No response was received from the KRWAD. In addition, a copy of the applications was sent to the Kansas Water Office for their review and comment. In a letter dated September 28, 2016, the KWO stated that the results of the OASIS model run indicate that there is sufficient assurance reservoir storage to support the requested additional water. DWR Water Management Services staff also recommended approval of the new application in conjunction with the determination by the KWO.

The applicant has submitted a signed Kansas River Assurance District form for the pending new application, which has been properly notarized. By completing this statement, the applicant affirms his/her knowledge that there could be times when the diversion of water may not be allowed under this permit.

Names and addresses of nearby well owners were provided by the applicant, which complies with K.A.R. 5-3-4. One domestic well was located within one-half mile, and a notification letter was sent on October 11, 2016, regarding both the new and change applications. No response of any kind was received. As noted the proposed new well is part of an existing well field that has been in place for many years. Any adjacent well owners would certainly be aware of the City's municipal well field.

The applications were filed indicating that the place of use is the City of Junction City, Kansas and immediate vicinity, an industrial park in the Northeast Quarter (NE $\frac{1}{4}$ ) of Section 22, a roadside park on Interstate-70 in Sections 16 and 21, Rural Water District No. 1, Geary County, all in Township 12 South, Range 5 East, Geary County, and the City of Grandview Plaza and immediate vicinity, in Township 12 South, Range 6 East, Geary County, Kansas. This place of use is consistent with senior water rights.

In accordance with K.S.A. 82a-706c, the Chief Engineer retains full authority to require any water user to install meters, gages, or other measuring devices, which devices he or she or his or her agents may read at any time. Water flowmeter requirements are further described in K.A.R. 5-1-4 through K.A.R. 5-1-12. If any chemical or foreign substance is injected into the water pumped under this permit, a check valve will also need to be installed.

Based on the above discussion, that the changes are reasonable, that impairment to existing vested rights is unlikely, and that no change in the local source of supply will occur, it is recommended that the referenced change applications be approved.

City of Junction City - Memorandum  
File Nos. 49,638; GE-002; 9,658; and 23,804  
Page 4 of 4

Katie Tietsort, Water Commissioner of the Topeka Field Office, recommended approval of the referenced new and change applications in an October 24, 2016 discussion. Based on the above discussion, the applications are supported by the Kansas River Water Assurance District No. 1, the additional quantity of water under File No. 49,638 will help the city meet future water demands and address recent over-pumping, there is sufficient assurance water storage in place for the new application, and approval of the applications will not impair senior water rights nor prejudicially or unreasonably affect the public interest, it is recommended that the referenced new and changes applications be approved. The new application will be approved with a waiver of safe yield and appropriate quantity limitations.

Douglas W. Schemm  
Environmental Scientist  
Topeka Field Office



1320 Research Park Drive  
Manhattan, Kansas 66502  
(785) 564-6700



900 SW Jackson, Room 456  
Topeka, Kansas 66612  
(785) 296-3556

Jackie McClaskey, Secretary

Governor Sam Brownback

November 4, 2016

CITY OF JUNCTION CITY  
ENGINEERING DEPT  
PO BOX 287  
JUNCTION CITY KS 66441-0287

**FILE COPY**

Re: Appropriation of Water, File No. 49,638; Vested Water Right, File No. GE 002; and Water Right, File Nos. 9,658 and 23,804

Dear Sir or Madam:

There is enclosed a permit (File No. 49,638) to appropriate water authorizing you to proceed with construction of the proposed diversion works (except those dams and stream obstructions regulated by K.S.A. 82a-301 through 305a), to divert such unappropriated water as may be available from the source and at the location specified in the permit, and to use it for the purpose and at the location described in the permit.

Your attention is directed to the enclosures and to the terms, conditions, and limitations specified in this permit. A water meter is required and you must install it prior to water being put to beneficial use in order for you to maintain accurate records of water use. The meter should be used to provide the information required on the annual water use report. Failure to notify the Chief Engineer of the Division of Water Resources of the completion of the diversion works within the time allowed, or within any authorized extension of time thereof, will result in the dismissal of this permit. Enclosed is a form which may be used to notify the Chief Engineer that the proposed diversion works have been completed.

All requests for extensions of time to complete diversion works, or to perfect appropriations, must be submitted to the Chief Engineer before the expiration of time originally set forth in the permit to complete diversion works or to perfect an appropriation. If for any reason, you require an extension of time, you must request it before the expiration of time set forth in this permit. Failure to comply with this regulation will result in the dismissal of your permit or your water right. Any request for an extension of time shall be accompanied by the required statutory fee, which is currently \$100.00. There is also enclosed an information sheet setting forth the procedure to obtain a Certificate of Appropriation which will establish the extent of your water right.

In addition, enclosed are Orders executed by the Chief Engineer, Division of Water Resources, Kansas Department of Agriculture, approving the Applications for Change in the Point of Diversion under Vested Water Right, File No. GE 002, and Water Right, File Nos. 9,658 and 23,804. Your attention is directed to the enclosures and to the terms, conditions, and limitations specified in these approvals for change.

City of Junction City

File Nos. 49,638; GE-002; 9,658; and 23,804

Page 2

Since these orders modify the original documents referred to above, the approval documents for File Nos. GE 002; 9,658; and 23,804 should be recorded with the Register of Deeds as other instruments affecting real estate. The abandoned well must be plugged in accordance with the requirements of Article 30 of the Rules and Regulations as adopted by the Kansas Department of Health and Environment.

These Orders are final agency actions. If you choose to appeal this decision or any finding or part thereof, you must do so by filing a petition for review in the manner prescribed by the Kansas Act for Judicial Review and Civil Enforcement of Agency Actions (KJRA K.S.A. 77-601 et seq.) within 30 days of service of these Orders. Your appeal must be made with the appropriate district court for the district of Kansas.

The Chief Legal Counsel for the Kansas Department of Agriculture, 1320 Research Park Drive, Manhattan, Kansas 66502, is the agency officer who will receive service of a petition for judicial review on behalf of the Kansas Department of Agriculture, Division of Water Resources. If you have questions or would like clarification concerning these orders, you may contact the Chief Engineer.

If you have any questions, please contact our office. If you wish to discuss a specific file, please have the file number ready so that we may help you more efficiently.

Sincerely,

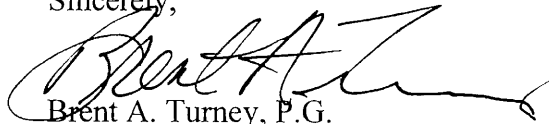

Brent A. Turney, P.G.

Change Application Unit Supervisor  
Water Appropriation Program

BAT:dws

Enclosures

pc: Kansas River Water Assurance District No. 1  
Kansas Water Office  
Topeka Field Office



KANSAS DEPARTMENT OF AGRICULTURE  
Jackie McClaskey, Secretary of Agriculture

DIVISION OF WATER RESOURCES  
David W. Barfield, Chief Engineer

**APPROVAL OF APPLICATION  
and  
PERMIT TO PROCEED**

(This Is Not a Certificate of Appropriation)

**FILE COPY**

This is to certify that I have examined Application, **File No. 49,638** of the applicant

**CITY OF JUNCTION CITY  
700 NORTH JEFFERSON  
PO BOX 287  
JUNCTION CITY KS 66441-0287**

for a permit to appropriate water for beneficial use, together with the maps, plans and other submitted data, and that the application is hereby approved and the applicant is hereby authorized, subject to vested rights and prior appropriations, to proceed with the construction of the proposed diversion works (except those dams and stream obstructions regulated by K.S.A. 82a-301 through 305a, as amended), and to proceed with all steps necessary for the application of the water to the approved and proposed beneficial use and otherwise perfect the proposed appropriation subject to the following terms, conditions and limitations:

1. That the priority date assigned to such application is **May 18, 2016**.
2. That the water sought to be appropriated shall be used for municipal use within the City of Junction City, Kansas and immediate vicinity, an industrial park in the Northeast Quarter (NE $\frac{1}{4}$ ) of Section 22, a roadside park on Interstate-70 in Sections 16 and 21, within the boundaries of Rural Water District No. 1, Geary County, all in Township 12 South, Range 5 East, and the City of Grandview Plaza and immediate vicinity, in Township 12 South, Range 6 East, all in Geary County, Kansas.
3. That the authorized source from which the appropriation shall be made is groundwater from main stem alluvium, to be withdrawn by means of one (1) well identified by the City of Junction City as Well No. 20, located in Special Section 12, more particularly described as being near a point 860 feet North and 1,280 feet West of the Southeast corner of Section 35, Township 11 South, Range 5 East, Geary County, Kansas, located substantially as shown on the topographic map accompanying the application.
4. That the appropriation sought shall be limited to a maximum diversion rate not in excess of **1,500 gallons per minute (3.34 c.f.s.)** and to a quantity not to exceed **430.123 million gallons (1,320 acre-feet)** of water for any calendar year.
5. That installation of works for diversion of water shall be completed on or before **December 31, 2017** or within any authorized extension thereof. The applicant shall notify the Chief Engineer and pay the statutorily required field inspection fee of \$400.00 when construction of the works has been completed. Failure to timely submit the notice and the fee will result in revocation of the permit. Any request for an extension of time shall be submitted prior to the expiration of the deadline and shall be accompanied by the required statutory fee of \$100.00.
6. That the proposed appropriation shall be perfected by the actual application of water to the proposed beneficial use on or before **December 31, 2036** or any authorized extension thereof. Any request for an extension of time shall be submitted prior to the expiration of the deadline and shall be accompanied by the required statutory fee of \$100.00.

7. That the applicant shall not be deemed to have acquired a water appropriation for a quantity in excess of the amount approved herein nor in excess of the amount found by the Chief Engineer to have been actually used for the approved purpose during one calendar year subsequent to approval of the application and within the time specified for perfection or any authorized extension thereof.

8. That the use of water herein authorized shall not be made so as to impair any use under existing water rights nor prejudicially and unreasonably affect the public interest.

9. That the right of the appropriator shall relate to a specific quantity of water and such right must allow for a reasonable raising or lowering of the static water level and for the reasonable increase or decrease of the streamflow at the appropriator's point of diversion.

10. That this permit does not constitute authority under K.S.A. 82a-301 through 305a to construct any dam or other obstruction; nor does it grant any right-of-way, or authorize entry upon or injury to, public or private property.

11. That all diversion works constructed under the authority of this permit into which any type of chemical or other foreign substance will be injected into the water pumped from the diversion works shall be equipped with an in-line, automatic quick-closing, check valve capable of preventing pollution of the source of the water supply. The type of valve installed shall meet specifications adopted by the Chief Engineer and shall be maintained in an operating condition satisfactory to the Chief Engineer.

12. That an acceptable water flow meter shall be installed and maintained on the diversion works authorized by this permit in accordance with Kansas Administrative Regulations 5-1-4 through 5-1-12 adopted by the Chief Engineer. This water flow meter shall be used to provide an accurate quantity of water diverted as required for the annual water use report (including the meter reading at the beginning and end of the report year).

13. That the applicant shall maintain accurate and complete records from which the quantity of water diverted during each calendar year may be readily determined and the applicant shall file an annual water use report with the Chief Engineer by March 1 following the end of each calendar year. Failure to file the annual water use report by the due date shall cause the applicant to be subject to a civil penalty.

14. That no water user shall engage in nor allow the waste of any water diverted under the authority of this permit.

15. That failure without cause to comply with provisions of the permit and its terms, conditions and limitations will result in the forfeiture of the priority date, revocation of the permit and dismissal of the application.

16. That the right to appropriate water under authority of this permit is subject to any minimum desirable streamflow requirements identified and established pursuant to K.S.A. 82a-703c for the source of supply to which this water right applies.

17. That the permit holder shall submit a progress report to the office of the Chief Engineer by March 1, following the tenth full calendar year after the permit was issued. The progress report must be submitted on a form prescribed by the Chief Engineer, and shall compare annual water use projected in the original application with the actual annual water use for the prior 10 years. The progress report must document compliance with the approved conservation plan, contain sufficient details to determine the extent of perfection of the water right during the previous ten years, and demonstrate how the water right, in association with other water rights, meets the municipal use need.

18. That the quantity of water approved under this permit is further limited to the quantity which when combined with Vested Water Right, File No. GE-02; Water Right, File Nos. 9,658 and 23,804; and Appropriation of Water, File Nos. 49,126; 49,127; 49,128; 49,129; and 49,130, will provide a total quantity not to exceed **2,090.8 million gallons** (6,416.43 acre-feet) of water per calendar year for municipal use as described herein.

This Order shall become a final agency action, as defined by K.S.A. 77-607(b), without further notice to the parties, if a request for hearing or a petition for administrative review is not filed as set forth below.

Request for Hearing. According to K.A.R. 5-14-3(c), any party who desires a hearing must submit a request within 15 days after the date shown on the Certificate of Service attached to this Order. Filing a request for a hearing will give you the opportunity to submit additional facts for consideration, contest any findings made by the Chief Engineer, or present any other information you believe should be considered in this matter. A timely-filed request for hearing will stay the deadline for requesting administrative review of this Order pending the outcome of the hearing.

Petition for Review. The applicant, if aggrieved by this Order, may petition for administrative review, pursuant to K.S.A. 82a-711(c) and K.S.A. 82a-1901(a). The petition must be filed within 30 days after the date shown on the Certificate of Service attached to this Order and must set forth the basis for the review, unless stayed by the timely filing of a request for hearing.

Any request for hearing or petition for administrative review shall be in writing and shall be submitted to the attention of: Chief Legal Counsel, Kansas Department of Agriculture, 1320 Research Park Drive, Manhattan, Kansas 66502, Fax: (785) 564-6777.

Ordered this 1<sup>st</sup> day of November, 2016, in Topeka, Shawnee County, Kansas.

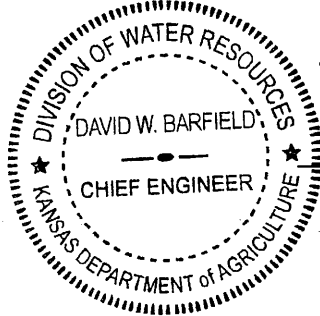

*David W. Barfield*

David W. Barfield, P.E.  
Chief Engineer  
Division of Water Resources  
Kansas Department of Agriculture

State of Kansas                    )  
  ) SS  
County of Riley                    )

The foregoing instrument was acknowledged before me this 1<sup>st</sup> day of November, 2016, by David W. Barfield, P.E., Chief Engineer, Division of Water Resources, Kansas Department of Agriculture.



*Karen Hunter*

Notary Public

### CERTIFICATE OF SERVICE

On this *4<sup>th</sup>* day of *November*, 2016, I hereby certify that the foregoing Approval of Application and Permit to Proceed, File No. 49,638, dated *November 1, 2016* was mailed postage prepaid, first class, US mail to the following:

CITY OF JUNCTION CITY  
700 NORTH JEFFERSON  
PO BOX 287  
JUNCTION CITY KS 66441-0287

With photocopies to:

KANSAS RIVER WATER ASSURANCE DISTRICT NO 1  
% GALEN BIERY  
212 SW 7<sup>TH</sup> STREET  
TOPEKA KS 66603-3717

KANSAS WATER OFFICE  
900 SW JACKSON ST STE 404  
TOPEKA KS 66612

Topeka Field Office

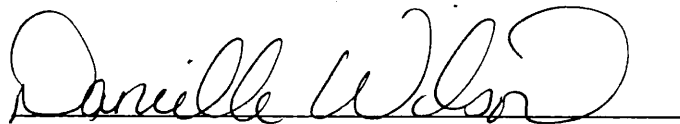

Division of Water Resources

APPLICATION COMPLETE

10/26/2016

Reviewer DWS

THE STATE OF KANSAS



KANSAS DEPARTMENT OF AGRICULTURE  
Jackie McClaskey, Secretary of Agriculture

DIVISION OF WATER RESOURCES  
David W. Barfield, Chief Engineer

File Number 49,638

This item to be completed by the Division of Water Resources.

WATER RESOURCES RECEIVED

MAY 18 2016

11:36  
KS DEPT OF AGRICULTURE

APPLICATION FOR PERMIT TO APPROPRIATE WATER FOR BENEFICIAL USE

Filing Fee Must Accompany the Application  
(Please refer to Fee Schedule attached to this application form.)

RECEIVED

JUN 21 2016

Topeka Field Office  
DIVISION OF WATER RESOURCES

To the Chief Engineer of the Division of Water Resources, Kansas Department of Agriculture,  
1320 Research Park Drive, Manhattan, Kansas 66502:

1. Name of Applicant (Please Print): City of Junction City, Kansas  
Address: 700 N. Jefferson, P.O. Box 287  
City: Junction City State KS Zip Code 66441  
Telephone Number: (785) 238-3103

2. The source of water is:  surface water in \_\_\_\_\_ (stream)  
OR  groundwater in Republican River (drainage basin)

Certain streams in Kansas have minimum target flows established by law or may be subject to administration when water is released from storage for use by water assurance district members. If your application is subject to these regulations on the date we receive your application, you will be sent the appropriate form to complete and return to the Division of Water Resources.

3. The maximum quantity of water desired is 1320 acre-feet OR 430.123 million gallons per calendar year, to be diverted at a maximum rate of 1500 gallons per minute OR \_\_\_\_\_ cubic feet per second.

Once your application has been assigned a priority, the requested maximum rate of diversion and maximum requested quantity of water under that priority number can **NOT** be increased. Please be certain your requested maximum rate of diversion and maximum quantity of water are appropriate and reasonable for your proposed project and are in agreement with the Division of Water Resources' requirements.

4. The water is intended to be appropriated for (Check use intended):  
(a)  Artificial Recharge (b)  Irrigation (c)  Recreational (d)  Water Power  
(e)  Industrial (f)  Municipal (g)  Stockwatering (h)  Sediment Control  
(i)  Domestic (j)  Dewatering (k)  Hydraulic Dredging (l)  Fire Protection  
(m)  Thermal Exchange (n)  Contamination Remediation

YOU **MUST** COMPLETE AND ATTACH ADDITIONAL DIVISION OF WATER RESOURCES FORM(S) PROVIDING INFORMATION TO SUBSTANTIATE YOUR REQUEST FOR THE AMOUNT OF WATER FOR THE INTENDED USE REFERENCED ABOVE.

For Office Use Only:

F.O. 1 GMD 0 Meets K.A.R. 5-3-1 (YES/NO) Use MUN Source G/S County GE By ASW Date 5/18/16  
Code 12E3 Fee \$ 500 TR # \_\_\_\_\_ Receipt Date 5/18/16 Check # 10690

5. The location of the proposed wells, pump sites or other works for diversion of water is:

**Note:** For the application to be accepted, the point of diversion location must be described to at least a 10 acre tract, unless you specifically request a 60 day period of time in which to locate the site within a specifically described, minimal legal quarter section of land.

- (A) One in the NW quarter of the SE quarter of the SE quarter of Section 35, more particularly described as being near a point 860 feet North and 1280 feet West of the Southeast corner of said section, in Township 11 South, Range 5 East West (circle one), Geary County, Kansas.
- (B) One in the \_\_\_\_\_ quarter of the \_\_\_\_\_ quarter of the \_\_\_\_\_ quarter of Section \_\_\_\_\_, more particularly described as being near a point \_\_\_\_\_ feet North and \_\_\_\_\_ feet West of the Southeast corner of said section, in Township \_\_\_\_\_ South, Range \_\_\_\_\_ East/West (circle one), \_\_\_\_\_ County, Kansas.
- (C) One in the \_\_\_\_\_ quarter of the \_\_\_\_\_ quarter of the \_\_\_\_\_ quarter of Section \_\_\_\_\_, more particularly described as being near a point \_\_\_\_\_ feet North and \_\_\_\_\_ feet West of the Southeast corner of said section, in Township \_\_\_\_\_ South, Range \_\_\_\_\_ East/West (circle one), \_\_\_\_\_ County, Kansas.
- (D) One in the \_\_\_\_\_ quarter of the \_\_\_\_\_ quarter of the \_\_\_\_\_ quarter of Section \_\_\_\_\_, more particularly described as being near a point \_\_\_\_\_ feet North and \_\_\_\_\_ feet West of the Southeast corner of said section, in Township \_\_\_\_\_ South, Range \_\_\_\_\_ East/West (circle one), \_\_\_\_\_ County, Kansas.

If the source of supply is groundwater, a separate application shall be filed for each proposed well or battery of wells, except that a single application may include up to four wells within a circle with a quarter (1/4) mile radius in the same local source of supply which do not exceed a maximum diversion rate of 20 gallons per minute per well.

A battery of wells is defined as two or more wells connected to a common pump by a manifold; or not more than four wells in the same local source of supply within a 300 foot radius circle which are being operated by pumps not to exceed a total maximum diversion rate of 800 gallons per minute and which supply water to a common distribution system.

6. The owner of the point of diversion, if other than the applicant is (please print):

\_\_\_\_\_  
(name, address and telephone number)

\_\_\_\_\_  
(name, address and telephone number)

You must provide evidence of legal access to, or control of, the point of diversion from the landowner or the landowner's authorized representative. Provide a copy of a recorded deed, lease, easement or other document with this application. In lieu thereof, you may sign the following sworn statement:

I have legal access to, or control of, the point of diversion described in this application from the landowner or the landowner's authorized representative. I declare under penalty of perjury that the foregoing is true and correct.

Executed on May 4, 2016

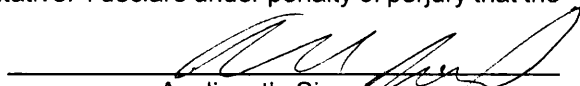
  
Applicant's Signature

The applicant must provide the required information or signature irrespective of whether they are the landowner. Failure to complete this portion of the application will cause it to be unacceptable for filing and the application will be returned to the applicant.

7. The proposed project for diversion of water will consist of one well (City Well #20)  
(number of wells, pumps or dams, etc.)

and (was) (will be) completed (by) 12 / 31 / 2017  
(Month/Day/Year - each was or will be completed)

8. The first actual application of water for the proposed beneficial use was or is estimated to be 12 / 31 / 2017  
(Mo/Day/Year)

WATER RESOURCES  
RECEIVED

MAY 18 2016

SCANNED



- 9. Will pesticide, fertilizer, or other foreign substance be injected into the water pumped from the diversion works?  
 Yes  No If "yes", a check valve shall be required.

All chemigation safety requirements must be met including a chemigation permit and reporting requirements.

- 10. If you are planning to impound water, please contact the Division of Water Resources for assistance, prior to submitting the application. Please attach a reservoir area capacity table and inform us of the total acres of surface drainage area above the reservoir.

Have you also made an application for a permit for construction of this dam and reservoir with the Division of Water Resources?  Yes  No

- If yes, show the Water Structures permit number here \_\_\_\_\_
- If no, explain here why a Water Structures permit is not required \_\_\_\_\_

- 11. The application must be supplemented by a U.S.G.S. topographic map, aerial photograph or a detailed plat showing the following information. On the topographic map, aerial photograph, or plat, identify the center of the section, the section lines or the section corners and show the appropriate section, township and range numbers. Also, please show the following information:

- (a) The location of the proposed point(s) of diversion (wells, stream-bank installations, dams, or other diversion works) should be plotted as described in Paragraph No. 5 of the application, showing the North-South distance and the East-West distance from a section line or southeast corner of section.
- (b) If the application is for groundwater, please show the location of any existing water wells of any kind within 1/2 mile of the proposed well or wells. Identify each existing well as to its use and furnish the name and mailing address of the property owner or owners. If there are no wells within 1/2 mile, please advise us.
- (c) If the application is for surface water, the names and addresses of the landowner(s) 1/2 mile downstream and 1/2 mile upstream from your property lines must be shown.
- (d) The location of the proposed place of use should be shown by crosshatching on the topographic map, aerial photograph or plat.
- (e) Show the location of the pipelines, canals, reservoirs or other facilities for conveying water from the point of diversion to the place of use.

A 7.5 minute U.S.G.S. topographic map may be obtained by providing the section, township and range numbers to: Kansas Geological Survey, 1930 Constant, Campus West, University of Kansas, Lawrence, Kansas 66047.

- 12. List any application, appropriation of water, water right, or vested right file number that covers the same diversion points or any of the same place of use described in this application. Also list any other recent modifications made to existing permits or water rights in conjunction with the filing of this application.

#GE 002, #9658, #23804, #49126, #49127, #49128, #49129, #49130. At the same time this application for a new appropriation is being filed, change applications are being submitted for Files #GE 002, #9658, and #23804 to change the point of diversion for existing Well #16 to redrill it 125 feet south-east of its current location as new Well #19.

WATER RESOURCES  
RECEIVED

MAY 18 2016

KS DEPT OF AGRICULTURE

SCANNED

13. Furnish the following well information if the proposed appropriation is for the use of groundwater. If the well has not been completed, give information obtained from test holes, if available.

Information below is from:  Test holes  Well as completed  Drillers log attached  
From Well #16 - 325 feet to the southeast

Well location as shown in paragraph No.	(A)	(B)	(C)	(D)
Date Drilled	<u>8 / 10 / 1990</u>	_____	_____	_____
Total depth of well	<u>60.5 feet</u>	_____	_____	_____
Depth to water bearing formation	<u>7 feet</u>	_____	_____	_____
Depth to static water level	<u>20 feet</u>	_____	_____	_____
Depth to bottom of pump intake pipe	_____	_____	_____	_____

14. The relationship of the applicant to the proposed place where the water will be used is that of owner  
(owner, tenant, agent or otherwise)

15. The owner(s) of the property where the water is used, if other than the applicant, is (please print):  
\_\_\_\_\_  
(name, address and telephone number)

\_\_\_\_\_  
(name, address and telephone number)

16. The undersigned states that the information set forth above is true to the best of his/her knowledge and that this application is submitted in good faith.

Dated at Junction City, Kansas, this 4th day of May, 2016.  
(month) (year)

\_\_\_\_\_  
(Applicant Signature)

By Allen L. Dickel, City Manager  
(Agent or Officer Signature)

\_\_\_\_\_  
(Agent or Officer - Please Print)

Assisted by Trina Sattles City Clerk Date: 5/4/16  
(office/title)

WATER RESOURCES RECEIVED

MAY 18 2016

**SECTION 3: PROJECTED FUTURE WATER NEEDS**

PLEASE COMPLETE THE FOLLOWING TABLE SHOWING YOUR FUTURE WATER REQUIREMENTS FOR THE NEXT 20 YEARS:

	Column 1 Raw Water Diverted Under Your Rights	Column 2 Water Purchased From All Sources	Column 3 Water Sold to Other Public Water Suppliers	Column 4 Water Sold to Your Industrial, Stock, and Bulk Customers	Column 5 Water Sold to Your Residential and Commercial Customers	Column 6 Other Metered Water	Column 7 Remaining Water Used (See Explanation on other side)
Year 5	1,715,100,000	0	53,700,000	255,500,000	942,000,000	168,700,000	295,200,000
Year 10	1,768,700,000	0	54,100,000	261,500,000	973,600,000	174,400,000	305,100,000
Year 15	1,822,400,000	0	54,600,000	267,500,000	1,005,300,000	180,000,000	315,100,000
Year 20	1,876,100,000	0	55,000,000	273,500,000	1,036,900,000	185,700,000	325,000,000
<b>TOTAL WATER = Columns 1 + 2</b>			<b>ACCOUNTED FOR WATER = Columns 3 + 4 + 5 + 6</b>				<b>UNACCOUNTED FOR WATER</b>

**SECTION 4: POPULATION AND SERVICE CONNECTIONS**

ESTIMATE THE NUMBER OF PERSONS DIRECTLY SERVED BY YOUR WATER DISTRIBUTION SYSTEM

PAST POPULATION - PROVIDE INFORMATION BELOW:  
(CENSUS BUREAU INFORMATION)

KS DEPT OF AGRICULTURE

MAY 18 2016

WATER RESOURCES RECEIVED

LAST 20 YEARS	POPULATION
20 years ago	20,380
15 years ago	18,889
10 years ago	19,500
5 years ago	23,353
Last Year	23,500

PROJECTED FUTURE POPULATION

ESTIMATE FUTURE POPULATION AND SUBSTANTIATE NUMBERS ON SEPARATE ATTACHMENTS

NEXT 20 YEARS	POPULATION
Year 5	25,679
Year 10	26,542
Year 15	27,404
Year 20	28,267

Provide number of current active service connections:

9,267 Residential                      1 Industrial                      78 Other (specify) Yard Meters  
 785 Commercial                      0 Pasture/ Stockwater/ Feedlot                      10,131 Total

**SECTION 5: PRESENT GALLONS PER PERSON PER DAY**

CALCULATE YOUR GALLONS PER PERSON PER DAY

SCANNED

Water in Columns 5, 6, and 7 ÷ Population ÷ 365 Days/Year = Gallons per Person per Day

$$\frac{1,182,856,000}{\text{Amount of water in Columns 5, 6, and 7 of Section 1}} \div \frac{23,500}{\text{Population from Last Year of Section 4}} \div 365 \text{ Days/Year} = \underline{137.9} \text{ GALLONS PER PERSON PER DAY.}$$

**SECTION 6: AREA TO BE SERVED**

Describe the area to be served or provide the legal description of the location where the water is to be used including any other city of water supply system (i.e. Rural Water District): Sec 1, T12, R5E (City of Junction City & immediate vicinity); Sec 5, T12, R6E (City of Grandview Plaza & immediate vicinity); Sec 1, T12, R5E (Within boundaries of Geary RWD1); Sec 22, T12, R5E (Industrial park); Sec 16, T12, R5E (Roadside park along I-70); and Sec 21, T12, R5E ((Roadside park along I-70)

You may attach additional information you believe will assist in informing the Division of the need for your request.

Applicant's Name City of Junction City, KS  
(Please Print)

## MUNICIPAL (PUBLIC WATER SUPPLY) APPLICATION SUPPLEMENTAL INFORMATION SHEET

Application File Number  
491638  
(assigned by DWR)

**SECTION 1: PRESENT WATER USE SUMMARY (IF NO PREVIOUS MUNICIPAL WATER USE HAS BEEN UTILIZED, PROCEED TO SECTION 3)  
NOTE: WORKSHEET FOR WATER PUMPED, PURCHASED, AND SOLD BY YOUR WATER DISTRIBUTION SYSTEM.**

Column 1	Column 2	Column 3	Column 4	Column 5	Column 6	Column 7
Raw Water Diverted Under Your Rights	Water Purchased From All Sources	Water Sold to Other Public Water Suppliers	Water Sold to Your Industrial, Stock, and Bulk Customers	Water Sold to Your Residential and Commercial Customers	Other Metered Water	Remaining Water Used (See Below Explanation)
1,508,581,000	0	38,305,000	287,420,000	723,239,000	84,515,000	375,102,000
<b>TOTAL WATER = Columns 1 + 2</b>		<b>ACCOUNTED FOR WATER = Columns 3 + 4 + 5 + 6</b>			<b>UNACCOUNTED FOR WATER</b>	

**UNACCOUNTED FOR WATER = TOTAL WATER - ACCOUNTED FOR WATER**

- Column 1: The amount of raw water diverted from all of your points of diversion.
- Column 2: The amount of water purchased wholesale from all other public water supply systems or the Kansas Water Office.
- Column 3: The amount of water sold wholesale to all other public water supply systems.
- Column 4: The amount of water sold retail to all industrial, pasture, stockwater, feedlot, and bulk water service connections. Include the amount of water sold to all farmsteads using at least 200,000 gallons of water per year.
- Column 5: The amount of water sold retail to your residential and commercial customers and to industries and farmsteads using less than 200,000 gallons of water per year.
- Column 6: The amount of water used that is metered at individual service connections and supplied free, such as for public service, treatment processes, and connections receiving free water.
- Column 7: The amount of remaining water used. The gallons reported in this column are found by adding the numbers in Columns 1 and 2 and subtracting the numbers in Columns 3, 4, 5, and 6.

**UNACCOUNTED FOR WATER**

Use the following to calculate your distribution system's Unaccounted For Water:

Start with the amount in Column 1 and add the amount in Column 2, then subtract the amounts in Columns 3, 4, 5, and 6 leaving an amount of water representing your unaccounted for water to enter in Column 7.

Use the following to calculate the percent Unaccounted For Water versus the Total Water of your system:

$$\text{Percent Unaccounted For Water} = \frac{\text{Unaccounted For Water}}{\text{Total Water (Columns 1,2)}} \times 100$$

If this number exceeds 20%, please explain the large amount of unaccounted for water and describe any steps being taken to reduce it.

**SECTION 2: PAST WATER USE**

**COMPLETE THE FOLLOWING TABLE FROM YOUR PAST WATER USE RECORDS.**

	Column 1	Column 2	Column 3	Column 4	Column 5	Column 6	Column 7
	Raw Water Diverted Under Your Rights	Water Purchased From All Sources	Water Sold to Other Public Water Suppliers	Water Sold to Your Industrial, Stock, and Bulk Customers	Water Sold to Your Residential and Commercial Customers	Other Metered Water	Remaining Water Used (See Above Explanation)
10 years ago	1,042,199,000	0	48,578,000	22,377,000	727,733,000	76,425,000	167,086,000
15 years ago	1,331,884,000	0	51,815,000	224,663,000	686,078,000	188,996,000	180,322,000
10 years ago	1,430,287,000	0	50,978,000	260,987,000	605,894,000	69,807,000	242,621,000
5 years ago	1,644,257,000	0	50,692,000	263,992,000	782,355,000	166,542,000	380,676,000
	<b>TOTAL WATER = Columns 1 + 2</b>		<b>ACCOUNTED FOR WATER = Columns 3 + 4 + 5 + 6</b>			<b>UNACCOUNTED FOR WATER</b>	

KS DEPT. OF AGRICULTURE  
 MAY 18 2016  
 WATER RESOURCES RECEIVED  
 SPANNED

## Schemm, Doug

---

**From:** Schemm, Doug  
**Sent:** Tuesday, August 23, 2016 4:27 PM  
**To:** Cara.Hendricks@kwo.ks.gov  
**Cc:** Westrup, Nathan (Nathan.Westrup@kwo.ks.gov)  
**Subject:** City of Junction City New App and Changes  
**Attachments:** Scan - Inbox \_018.pdf; Scan - Inbox \_014 (1).pdf

Good Afternoon,

The City of Junction City has a pending new application, File No. 49,638 to drill a new well near their current well field. This new application is requesting 32.2 million gallons **additional water** when combined with their senior water rights. In addition, the City is redrilling current well 16 due to a collapsed screen. Applications to change the point of diversion are attached for the 3 files that cover this well, GE002; 9,658; and 23,804.

I have attached copies of the applications.

NOTE: I have to send in 2 e-mails, because too big!

I have also provided the KS River Water Assurance District with copies of these applications for their review.

Thanks,

Doug

05-04-2016

(Date)

Kansas Department of Agriculture  
Division of Water Resources  
David W. Barfield, Chief Engineer  
1320 Research Park Drive  
Manhattan, Kansas 66502

Re: Application File No. 49,638

Minimum Desirable Streamflow  
Kansas River Assurance District  
Water Reservation Rights

Dear Sir:

I understand that a Minimum Desirable Streamflow requirement has been established, an Assurance District has been formed and established or a Water Reservation Right is held by the Kansas Water Office (**circle the appropriate item**) for the source of supply to which the above referenced application applies, namely the Republican River Alluvium downstream of Milford Reservoir.

I understand that diversion of water pursuant to this application will be subject to regulation any time Minimum Desirable Streamflow requirements are not being met, Assurance District or Water Marketing releases are being made from storage in Federal Reservoirs or when a Reservation Right upstream of a Federal Reservoir is being administered.

I also understand that if this application is approved, there could be times, as determined by the Division of Water Resources, when I would not be allowed to divert water. I realize that this could affect the economics of my decision to appropriate water.

I am aware of the above factors, and with the knowledge thereof, request that the Division of Water Resources proceed with processing and approval, if possible, of the above referenced application.

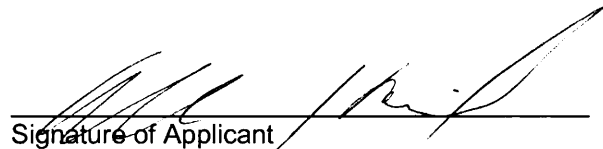
  
\_\_\_\_\_  
Signature of Applicant

Allen J. Dinkel, City manager  
\_\_\_\_\_  
Print Applicant Name

State of Kansas )  
County of geary ) SS

I hereby certify that the foregoing instrument was signed in my presence and sworn to before me this 4th day of May, 20 16.



  
\_\_\_\_\_  
Notary Public

My Commission Expires: 9/11/2019

WATER RESOURCES  
RECEIVED

MAY 18 2016

Known Wells Located Within 1/2 Mile Radius  
New Water Appropriation Application for Well #20

WELL DESIGNATION	WELL USE	TWN	RNG	SEC	SPOT	LONGITUDE	LATITUDE	OWNER NAME	OWNER ADDRESS	CITY	STATE	ZIP
Lisle	Domestic	12S	5E	1	NW NW NW	-96.831292	39.043805	Frank Lisle	1830 N Jefferson St	Junction City	KS	66441
Junction City OW1	Obs Well	11S	5E	35	NW SE SE	-96.836721	39.049168	City of Junction City	P.O. Box 287	Junction City	KS	66441
Junction City OW2	Obs Well	11S	5E	35	SW SE SE	-96.838168	39.048687	City of Junction City	P.O. Box 287	Junction City	KS	66441
Junction City OW3	Test Well	11S	5E	35	SE NE SW	-96.842656	39.051399	City of Junction City	P.O. Box 287	Junction City	KS	66441
Junction City OW4	Test Well	11S	5E	35	NE SW SE	-96.838168	39.048687	City of Junction City	P.O. Box 287	Junction City	KS	66441
Junction City OW 150 P 15	Obs Well	11S	5E	35	SW NE SE	-96.836079	39.048358	City of Junction City	P.O. Box 287	Junction City	KS	66441
Junction City OW 95 R 15	Obs Well	11S	5E	35	SW NE SE	-96.836581	39.0484574	City of Junction City	P.O. Box 287	Junction City	KS	66441
Junction City OW 95 P 15	Obs Well	11S	5E	35	SW NE SE	-96.836145	39.048467	City of Junction City	P.O. Box 287	Junction City	KS	66441
Junction City Well #11	Municipal	11S	5E	35	SE SE SE	-96.83284	39.047376	City of Junction City	P.O. Box 287	Junction City	KS	66441
Junction City Well #12	Municipal	11S	5E	35	SE SE SE	-96.834249	39.046946	City of Junction City	P.O. Box 287	Junction City	KS	66441
Junction City Well #13	Municipal	11S	5E	35	NE SE SE	-96.834509	39.04833	City of Junction City	P.O. Box 287	Junction City	KS	66441
Junction City Well #14	Municipal	11S	5E	35	NW SE SE	-96.835702	39.04935	City of Junction City	P.O. Box 287	Junction City	KS	66441
Junction City Well #15	Municipal	11S	5E	35	SW NE SE	-96.836346	39.050549	City of Junction City	P.O. Box 287	Junction City	KS	66441
Junction City Well #16	Municipal	11S	5E	35	SW SE SE	-96.836343	39.047983	City of Junction City	P.O. Box 287	Junction City	KS	66441
Junction City Well #17	Municipal	11S	5E	36	SW SW SW	-96.831483	39.046293	City of Junction City	P.O. Box 287	Junction City	KS	66441
Junction City Well #18	Municipal	12S	5E	1	NE NW NW	-96.831729	39.045604	City of Junction City	P.O. Box 287	Junction City	KS	66441
Junction City Well #6	Municipal	12S	5E	1	NE NW NW	-96.83241	39.045147	City of Junction City	P.O. Box 287	Junction City	KS	66441
Junction City Well #8	Municipal	12S	5E	1	NW NW NW	-96.833893	39.0458	City of Junction City	P.O. Box 287	Junction City	KS	66441

Note: In the Aug 2014 applications submittals for Files Nos. 49126 though 49130, an industrial well had been located from KGS WW5 records as being located within the 1/2 mile radius. However, this 2007 well for Midwest Concrete Materials was later found to be a driller locating error as this well is actually a DWR point of diversion for File No. 46435 and is located a mile northwest of the Junction City well field.

KS DEPT OF AGRICULTURE

MAY 18 2016

WATER RESOURCES  
RECEIVED

SCANNED

491038

**FORM TO BE USED WHEN APPLICABLE  
WHEN FILING AN APPLICATION FOR PERMIT  
TO APPROPRIATE WATER FOR BENEFICIAL USE**

The Kansas Legislature has established minimum desirable streamflows for the streams listed below. If your proposed diversion of water is going to be from one of these watercourses or adjacent alluvial aquifers, please complete the back side of this page and submit it along with your application for permit to appropriate water.

Arkansas River  
Big Blue River  
Chapman Creek  
Chikaskia River  
Cottonwood River  
Delaware River  
Little Arkansas River  
Little Blue River  
Marais des Cygnes River  
Medicine Lodge River  
Mill Creek (Wabaunsee Co. area)  
Neosho River

Ninnescah River  
North Fork Ninnescah River  
Rattlesnake Creek  
Republican River  
Saline River  
Smoky Hill River  
Solomon River  
South Fork Ninnescah  
Spring River  
Walnut River  
Whitewater River

Assurance Districts have been formed on the following rivers:

Kansas River                      Marias des Cygnes River                      Neosho River

The Kansas Water Office has Water Reservation Rights for the following reservoirs:

Big Hill	Marion
Clinton	Melvorn
Council Grove	Milford
Elk City	Perry
Hillsdale	Pomona
John Redmond	Tuttle Creek

**WATER RESOURCES  
RECEIVED**

**MAY 18 2016**



49638

960642 M

WATER WELL RECORD Form WWC-5 KSA 82a-1212

1 LOCATION OF WATER WELL: County: Geary Fraction: SW 1/4 SE 1/4 SE 1/4 Section Number: 35 Township Number: T 11 S Range Number: R 5 E/W

Distance and direction from nearest town or city street address of well if located within city?  
NEAR JUNCTION CITY WATER TREATMENT PLANT Well # 16

2 WATER WELL OWNER: City Water Department  
 RR#, St. Address, Box #: P.O. Box 287  
 City, State, ZIP Code: Junction City, Kansas 66441  
 Board of Agriculture, Division of Water Resources  
 Application Number:

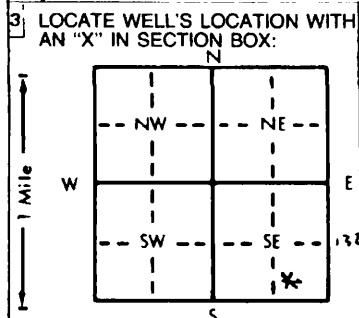

4 DEPTH OF COMPLETED WELL: 60.5 ft. ELEVATION: BGL

Depth(s) Groundwater Encountered 1. 20 ft. 2. \_\_\_\_\_ ft. 3. \_\_\_\_\_ ft.

WELL'S STATIC WATER LEVEL: 20 ft. below land surface measured on mo/day/yr

Pump test data: Well water was \_\_\_\_\_ ft. after \_\_\_\_\_ hours pumping \_\_\_\_\_ gpm

Est. Yield 1000 gpm: Well water was 35 ft. after 6 hours pumping 1000 gpm

Bore Hole Diameter: 36 in. to \_\_\_\_\_ ft., and \_\_\_\_\_ in. to \_\_\_\_\_ ft.

WELL WATER TO BE USED AS:  Public water supply  Air conditioning  Injection well

1 Domestic  3 Feedlot  6 Oil field water supply  9 Dewatering  12 Other (Specify below)

2 Irrigation  4 Industrial  7 Lawn and garden only  10 Monitoring well

Was a chemical/bacteriological sample submitted to Department? Yes \_\_\_\_\_ No \_\_\_\_\_ If yes, mo/day/yr sample was submitted \_\_\_\_\_

Water Well Disinfected? Yes \_\_\_\_\_ No \_\_\_\_\_

5 TYPE OF BLANK CASING USED:

1 Steel 2 PVC 3 RMP (SR) 4 ABS 5 Wrought iron 6 Asbestos-Cement 7 Fiberglass 8 Concrete tile 9 Other (specify below)

CASING JOINTS: Glued \_\_\_\_\_ Clamped \_\_\_\_\_ Welded \_\_\_\_\_ Threaded \_\_\_\_\_

Blank casing diameter: 16 in. to \_\_\_\_\_ ft., Dia \_\_\_\_\_ in. to \_\_\_\_\_ ft., Dia \_\_\_\_\_ in. to \_\_\_\_\_ ft.

Casing height above land surface: 144 in., weight \_\_\_\_\_ lbs./ft. Wall thickness or gauge No. \_\_\_\_\_

TYPE OF SCREEN OR PERFORATION MATERIAL:

1 Steel 2 Brass 3 Stainless steel 4 Galvanized steel 5 Fiberglass 6 Concrete tile 7 PVC 8 RMP (SR) 9 ABS 10 Asbestos-cement 11 Other (specify) 12 None used (open hole)

SCREEN OR PERFORATION OPENINGS ARE:

1 Continuous slot 2 Louvered shutter 3 Mill slot 4 Key punched 5 Gauzed wrapped 6 Wire wrapped 7 Torch cut 8 Saw cut 9 Drilled holes 10 Other (specify) 11 None (open hole)

SCREEN-PERFORATED INTERVALS: From 40 ft. to 60 ft., From \_\_\_\_\_ ft. to \_\_\_\_\_ ft.

GRAVEL PACK INTERVALS: From 20 ft. to 60 ft., From \_\_\_\_\_ ft. to \_\_\_\_\_ ft.

6 GROUT MATERIAL: 1 Neat cement 2 Cement grout 3 Bentonite 4 Other

Grout Intervals: From 0 ft. to 20 ft., From \_\_\_\_\_ ft. to \_\_\_\_\_ ft.

What is the nearest source of possible contamination:

1 Septic tank 2 Sewer lines 3 Watertight sewer lines 4 Lateral lines 5 Cess pool 6 Seepage pit 7 Pit privy 8 Sewage lagoon 9 Feedyard 10 Livestock pens 11 Fuel storage 12 Fertilizer storage 13 Insecticide storage 14 Abandoned water well 15 Oil well/Gas well 16 Other (specify below)

Direction from well? E How many feet? 700'

FROM	TO	LITHOLOGIC LOG	FROM	TO	PLUGGING INTERVALS
0	2	top soil			
2	7	brown clay			
7	17	fine to coarse sand w/layers flat rock			
17	44	fine to coarse sand w/tan clay layers of flat rock			
44	58	med to coarse sand			
58		limestone shale			

WATER RESOURCES RECEIVED

MAY 18 2016

KS DEPT OF AGRICULTURE

7 CONTRACTOR'S OR LANDOWNER'S CERTIFICATION: This water well was (1) constructed, (2) reconstructed, or (3) plugged under my jurisdiction and was completed on (mo/day/year) 8/16/90 and this record is true to the best of my knowledge and belief. Kansas Water Well Contractor's License No. 102 W This Water Well Record was completed on (mo/day/yr) 8/14/90 under the business name of Layne Western Co., Wichita, Ks. by (signature) [Signature] B. Meier

INSTRUCTIONS: Use typewriter or ball point pen. PLEASE PRESS FIRMLY and PRINT clearly. Please fill in blanks, underline or circle the correct answers. Send for three copies to Kansas Department of Health and Environment, Bureau of Water Protection, Topeka, Kansas 66620-7320. Telephone: 913-296-5514. Send one to WATER WELL OWNER and retain one for your records.

660802068-

## FEE SCHEDULE

1. The fee for an application for a permit to appropriate water for beneficial use, except for domestic use, shall be (see paragraph No. 2 below if requesting storage):

ACRE-FEET	FEE
0-100	\$200.00
101-320	\$300.00
More than 320	\$300.00 plus \$20.00 for each additional 100 acre-feet or any part thereof.

2. The fee for an application in which storage is requested, except for domestic use, shall be:

ACRE-FEET	FEE
0-250	\$200.00
More than 250	\$200.00 plus \$20.00 for each additional 250 acre-feet of storage or any part thereof.

Note: If an application requests both direct use *and* storage, the fee charged shall be as determined under No. 1 or No. 2 above, whichever is greater, but not both fees.

3. The fee for an application for a permit to appropriate water for water power or dewatering purposes shall be \$100.00 plus \$200.00 for each 100 cubic feet per second, or part thereof, of the diversion rate requested.

Note: The applicant shall notify the Chief Engineer and pay the statutorily required field inspection fee of \$400.00 when construction of the works for diversion has been completed, except that for applications filed on or after July 1, 2009, for works constructed for sediment control use and for evaporation from a groundwater pit for industrial use shall be accompanied by a field inspection fee of \$200.00.

### MAKE CHECKS PAYABLE TO THE KANSAS DEPARTMENT OF AGRICULTURE

#### ATTENTION

A Water Conservation Plan may be required per K.S.A. 82a-733. A statement that your application for permit to appropriate water may be subject to the minimum desirable streamflow requirements per K.S.A. 82a-703a, b, and c may also be required from you. After the Division of Water Resources has had the opportunity to review your application, you will be notified whether or not you will need to submit a Water Conservation Plan. You also may be required to install a water flow meter or water stage measuring device on your diversion works prior to diverting water. There may be other special conditions or Groundwater Management District regulations that you will need to comply with if this application is approved.

#### CONVERSION FACTORS

1 acre-foot equals 325,851 gallons

1 million gallons equal 3.07 acre-feet

WATER RESOURCES  
RECEIVED

MAY 18 2016

KS DEPT OF AGRICULTURE

SCANNED

#49,638

Fails SAFE

YIELD

**Analysis Results**

The selected PD is in an area to new appropriations.  
The safe yield, based on the variables listed below is 1,369.40 AF.  
Total prior appropriation in the circle is 8,548.10 AF. -1320 AF = 7,228.1 AF  
Total quantity of water available for appropriation is 0.00 AF.

**Safe Yield Variables**

The area used for the analysis is set at 6847 acres.  
Potential annual recharge of the area is estimated to be 3.2 inches.  
The percent of recharge available for appropriation is 75%.

Authorized Quantity values are as of 21-JUN-2016 and are based on Appropriated and Vested ground water right and possible stream nodes for GMD #2. Domestic, Term and Temporary water rights have been excluded.

There are 24 water right(s) and 22 point(s) of diversion within the circle.

File Number	Use	ST	SR	Q4	Q3	Q2	Q1	FeetN	FeetW	Sec	Twp	Rng	ID	Qind	Auth_Quant	Add_Quant	Tacres	Nacres
A	4429 00	IRR	NK	G				1560	1400	32	11	06E	2	WR	200.00	200.00	247.00	247.00
A	5620 00	IRR	NK	G				1560	1400	32	11	06E	2	WR	100.00	100.00	247.00	0.00
A	8997 00	IRR	NK	G				3366	3943	06	12	06E	4	WR	24.20	24.20	225.00	225.00
A	9658 00	MUN	NK	G				615	1036	35	11	05E	9	WR	2,513.48	748.87		
Same		MUN	NK	G				4873	4564	01	12	05E	1	WR				
Same		MUN	NK	G	SW	SW	SW	88	5024	36	11	05E	2	WR				
Same		MUN	NK	G				5010	4310	01	12	05E	6	WR				
Same		MUN	NK	G				5102	4992	01	12	05E	7	WR				
A	23804 00	MUN	NK	G				615	1036	35	11	05E	9	WR	4,480.58	2,181.52		
Same		MUN	NK	G				4873	4564	01	12	05E	1	WR				
Same		MUN	NK	G				229	465	35	11	05E	3	WR				
Same		MUN	NK	G				750	528	35	11	05E	4	WR				
Same		MUN	NK	G				1551	1065	35	11	05E	6	WR				
Same		MUN	NK	G	SW	SW	SW	88	5024	36	11	05E	2	WR				
Same		MUN	NK	G				484	88	35	11	05E	2	WR				
Same		MUN	NK	G				1128	857	35	11	05E	5	WR				
Same		MUN	NK	G				5010	4310	01	12	05E	6	WR				
Same		MUN	NK	G				5102	4992	01	12	05E	7	WR				
A	32550 00	IND	NK	G				1600	3900	35	11	05E	1	WR	0.25	0.25		
A	33823 00	IRR	NK	G				3375	4640	35	11	05E	11	WR	45.00	45.00	82.00	82.00
A	33860 00	IRR	NK	G				800	3700	27	11	05E	2	WR	12.00	12.00	24.00	24.00

Safe Yield Report Sheet  
Water Right- A4963800  
Point of Diversion in SESENW 35-11S-5E 13 (85314)

---

---

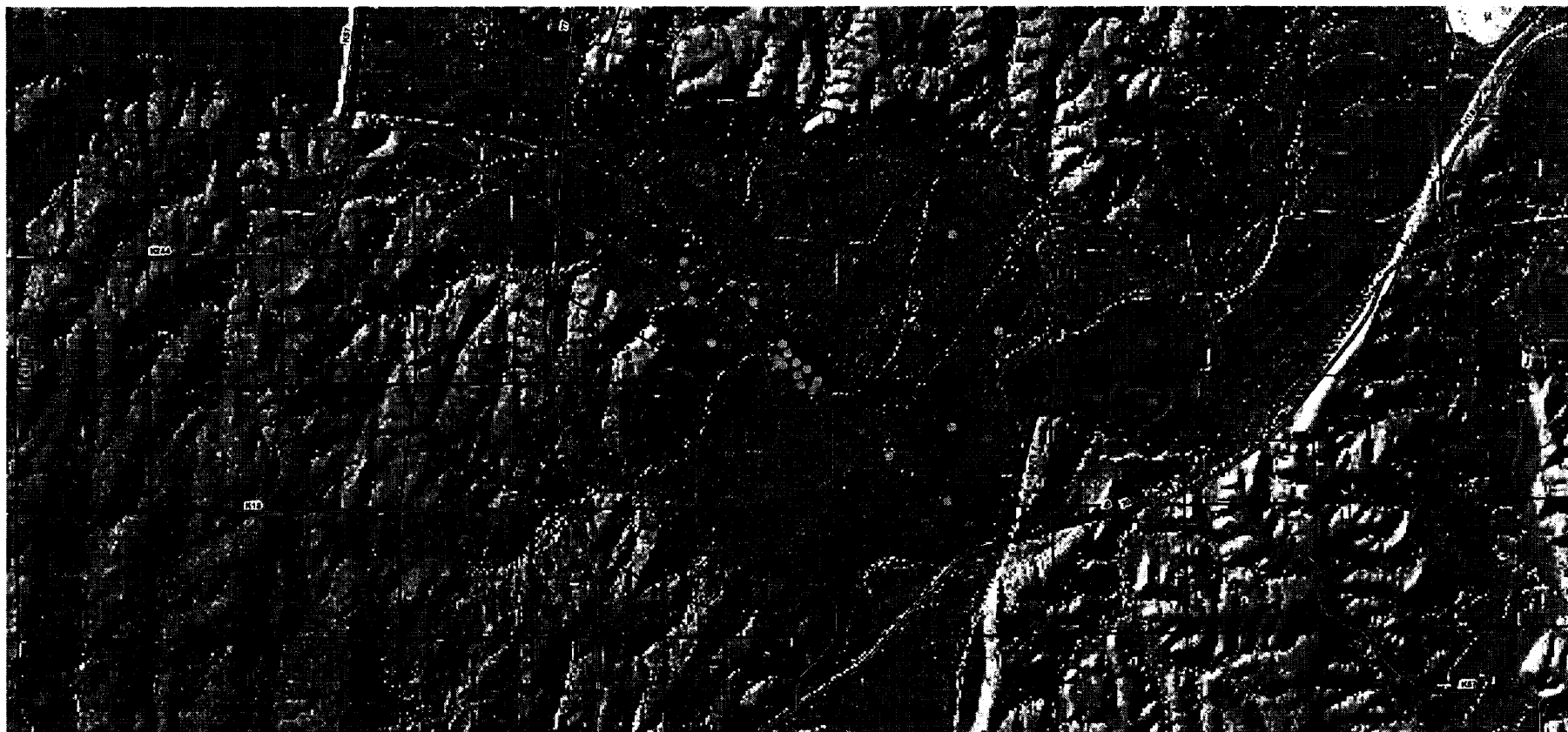

# 49,638

A	39119	00	IRR	NK	G		835	3835	30	11	06E	2	WR	120.00	120.00	166.50	166.50
A	40756	00	IRR	NK	G		1560	1400	32	11	06E	2	WR	157.00	0.00	247.00	0.00
A	40960	00	IND	NK	G	N2	0300	4200	13	11	05E	2	WR	50.02	50.02		
A	41384	00	IRR	NK	G		800	3700	27	11	05E	2	WR	22.00	10.00	24.00	0.00
A	43414	00	IRR	NK	G	SE SW SW	237	4177	06	12	06E	3	WR	97.00	97.00	100.00	100.00
A	45621	00	IRR	LR	G		3366	3943	06	12	06E	4	WR	238.00	213.80	225.00	0.00
A	46397	00	IND	KK	G	NE NW SE	2100	1500	01	12	05E	5	WR	7.67	7.67		
A	46435	00	IND	NK	G		4024	4950	35	11	05E	12	WR	15.00	15.00		
A	46736	00	IND	NK	G		8585	1431	02	12	05E	4	WR	15.00	15.00		
A	49126	00	MUN	GY	G		750	528	35	11	05E	4	WR	540.87	540.87		
A	49127	00	MUN	GY	G		484	88	35	11	05E	2	WR	540.87	540.87		
A	49128	00	MUN	GY	G		1128	857	35	11	05E	5	WR	540.87	541.42		
A	49129	00	MUN	GY	G		1551	1065	35	11	05E	6	WR	540.87	0.00		
A	49130	00	MUN	GY	G		229	465	35	11	05E	3	WR	540.87	0.00		
A	49638	00	MUN	AY	G	NW SE SE	860	1280	35	11	05E	13	WR	<del>1,320.00</del>	<del>1,320.00</del>		
V GE	2	00	MUN	AA	G		615	1036	35	11	05E	9	WR	1,764.61	1,764.61		
Same			MUN	AA	G		4873	4564	01	12	05E	1	WR				
Same			MUN	AA	G	SW SW SW	88	5024	36	11	05E	2	WR				
Same			MUN	AA	G		5010	4310	01	12	05E	6	WR				

=====

## Tietsort, Katie

---

**From:** Tietsort, Katie  
**Sent:** Thursday, May 14, 2015 12:30 PM  
**To:** 'Haney, Dwight'  
**Subject:** RE: Update on HDR's upcoming Junction City collector well investigation  
**Attachments:** 20150514111913473.tif

Hi Doug,

I had a chance to visit with Chief Legal counsel for KDA, Robert Large, yesterday about this. Robert says that we would have pointed you to the Assessors site for ownership determination and to the Register of Deeds office. We would require the applicant to show that they have the proper access, based on that regulation that was put in place, and that no private ownership showing on the assessors site may indicate public ownership, but that you will need to provide something to us when applying to show whether or not it is public or private.

I have attached the description of the modeling we require for collector wells. I am presuming it is results of this you wish to discuss, right?

49126, 49127 & 49128 don't have additional limitations (permit conditions). The justification with the recent batch of approvals identified an overall reasonable projected need quantity of 2058.6 mgy. I made some changes to your table below in red but they relate to rounding items. The J.C. rights don't add up based on the way the Division has approached rounding conventions through all these years. File No. ~~49129 and 49130~~ limit back to all previous files:  
49129- Limited to 2058.6 mgy w/ GE02, 9658, 23804, 49126, 49127, & 49128  
49130- Limited to 2058.6 mgy w/ GE02, 9658, 23804, 49126, 49127, 49128 & 49129

Unless you have something significant and new, any quantities applied for will be limited to the overall quantity of ~~20528.6~~ mgy. **2058.6 mgy**

I will move forward with requesting availability for a meeting regarding this topic. The meeting will need to be held in Manhattan in HQ and I will plan to participate telephonically. The group for DWR will need to include: Lane Letourneau, Ken Kopp, Jim Bagley, me, Chris Beightel and Janelle Phillips (Structures). I can use this email chain to do the request.

Katie

Katie Tietsort, Water Commissioner

Kansas Department of Agriculture  
Division of Water Resources, Topeka Field Office  
6531 SE Forbes Ave., Suite B  
Topeka, KS 66619  
(785) 296-5733  
FAX (785) 296-8298

Katie.Tietsort@kda.ks.gov  
<http://agriculture.ks.gov/>

---

**From:** Haney, Dwight [mailto:Dwight.Haney@hdrinc.com]  
**Sent:** Wednesday, May 06, 2015 1:14 PM

AMOUNT STATISTICS REPORT FOR POINTS OF DIVERSION UNDER A 49638 00

#####

*Meets spacing*

AMOUNT STATISTICS REPORT FOR POINTS OF DIVERSION UNDER A 49638 00 MUN

Water Right and Points of Diversion Within 2.00 miles of point defined as:

*to other NON-municipal wells.*

860 Feet North and 1280 Feet West of the Southeast Corner of Section 35 T 11S R 5E

GROUNDWATER ONLY

File Number	Use	ST	SR	Dist	(ft)	Q4	Q3	Q2	Q1	FeetN	FeetW	Sec	Twp	Rng	ID	Batt	Auth_Quan	Add_Quan	Unit	
A__	8997	00	IRR	NK	G*	<u>7501</u>	--	--	--	3366	3943	6	12	6E	4		24.20	24.20	AF	
A__	9658	00	MUN	NK	G*	346	--	--	--	615	1036	35	11	5E	9		2513.48	748.87	AF	
Same						1815	--	SW	SW	SW	88	5024	36	11	5E	2				
Same						1870	--	--	--	4873	4564	1	12	5E	1					
Same						1979	--	--	--	5010	4310	1	12	5E	6					
Same						1409	--	--	--	5102	4992	1	12	5E	7					
A__	23804	00	MUN	NK	G*	1250	--	--	--	484	88	35	11	5E	2		4480.58	2181.52	AF	
Same						1031	--	--	--	229	465	35	11	5E	3					
Same						760	--	--	--	750	528	35	11	5E	4					
Same						501	--	--	--	1128	857	35	11	5E	5					
Same						724	--	--	--	1551	1065	35	11	5E	6					
Same						346	--	--	--	615	1036	35	11	5E	9					
Same						1815	--	SW	SW	SW	88	5024	36	11	5E	2				
Same						1870	--	--	--	4873	4564	1	12	5E	1					
Same						1979	--	--	--	5010	4310	1	12	5E	6					
Same						1409	--	--	--	5102	4992	1	12	5E	7					
A__	32550	00	IND	NK	G	<u>2722</u>	--	--	--	1600	3900	35	11	5E	1		.25	.25	AF	
A__	33823	00	IRR	NK	G	<u>4197</u>	--	--	--	3375	4640	35	11	5E	11		45.00	45.00	AF	
A__	33860	00	IRR	NK	G	7699	--	--	--	800	3700	27	11	5E	2		12.00	12.00	AF	
A__	39119	00	IRR	NK	G	9653	--	--	--	835	3835	30	11	6E	2		120.00	120.00	AF	
A__	40960	00	IND	NK	G	5542	--	--	N2	10300	4200	13	11	5E	2		50.02	50.02	AF	
A__	41384	00	IRR	NK	G	7699	--	--	--	800	3700	27	11	5E	2		22.00	10.00	AF	
A__	43414	00	IRR	NK	G	8981	--	SE	SW	SW	237	4177	6	12	6E	3		97.00	97.00	AF
A__	45621	00	IRR	LR	G*	7501	--	--	--	3366	3943	6	12	6E	4		238.00	213.80	AF	
A__	46397	00	IND	KK	G	6002	--	NE	NW	SE	2100	1500	1	12	5E	5*		7.67	7.67	AF
A__	46435	00	IND	NK	G	4846	--	--	--	4024	4950	35	11	5E	12*		15.00	15.00	AF	
A__	46736	00	IND	NK	G	<u>2599</u>	--	--	--	8585	1431	2	12	5E	4*		15.00	15.00	AF	
A__	49126	00	MUN	GY	G	760	--	--	--	750	528	35	11	5E	4		540.87	540.87	AF	
A__	49127	00	MUN	GY	G	1250	--	--	--	484	88	35	11	5E	2		540.87	540.87	AF	
A__	49128	00	MUN	GY	G	501	--	--	--	1128	857	35	11	5E	5		540.87	541.42	AF	
A__	49129	00	MUN	GY	G	724	--	--	--	1551	1065	35	11	5E	6		540.87	.00	AF	
A__	49130	00	MUN	GY	G	1031	--	--	--	229	465	35	11	5E	3		540.87	.00	AF	
A__	49638	00	MUN	AY	G	0	--	NW	SE	SE	860	1280	35	11	5E	13		1320.00	1320.00	AF
T__	20149080	SU	IND	GY	G	7950	--	--	N2	11500	6400	13	11	5E	6		375.00	375.00	AF	
VGE	2	00	MUN	AA	G*	346	--	--	--	615	1036	35	11	5E	9		1764.61	1764.61	AF	
Same						1815	--	SW	SW	SW	88	5024	36	11	5E	2				
Same						1870	--	--	--	4873	4564	1	12	5E	1					
Same						1979	--	--	--	5010	4310	1	12	5E	6					

Total Net Quantities Authorized:	Direct	Storage
Total Requested Amount (AF) =	1320.00	.00
Total Permitted Amount (AF) =	2005.83	.00
Total Inspected Amount (AF) =	213.80	.00
Total Pro_Cert Amount (AF) =	.00	.00

  
**Kansas**  
Department of Agriculture  
*Division of Water Resources*

Topeka Field Office  
6531 SE Forbes Ave., Suite B  
Topeka, Kansas 66619

Jackie McClaskey, Secretary  
David W. Barfield, Chief Engineer  
Katherine A. Tietsort, Water Commissioner

Phone: (785) 296-5733  
Fax: (785) 862-2460  
[www.agriculture.ks.gov](http://www.agriculture.ks.gov)  
Sam Brownback, Governor

October 11, 2016

FRANK LISLE  
1830 N JEFFERSON STREET  
JUNCTION CITY KS 66441

Re: New Application, File No. 49,638

Dear Sir or Madam:

This is to advise you that the City of Junction City has filed the new application referred to above for a permit to appropriate 430.123 million gallons of groundwater per calendar year for municipal use to be diverted at a maximum rate of 1,500 gallons per minute from a proposed new well (Well #20).

The proposed point of diversion for the new application is one (1) well located in the Northwest Quarter of the Southeast Quarter of the Southeast Quarter of Section 35, more particularly described as being near a point 860 feet North and 1,280 feet West of the Southeast corner of said section, in Township 11 South, Range 5 East, Geary County, Kansas.

A map is enclosed indicating the location of the proposed point of diversion. Records in this office indicate that you may have a well or wells in this vicinity and you are notified of receipt of this new application in order that you may be fully informed of the proposed location of the applicant's point of diversion and proposed use of water. Consideration will be given to comments or other information which you desire to submit to this office **within 15 days** from the date of this letter. If you have any questions or comments, you may also contact me at (785) 296-3495. If you call, please reference the file number so I can help you more efficiently.

Sincerely,



Douglas W. Schemm  
Environmental Scientist  
Topeka Field Office

Enclosure

pc: City of Junction City



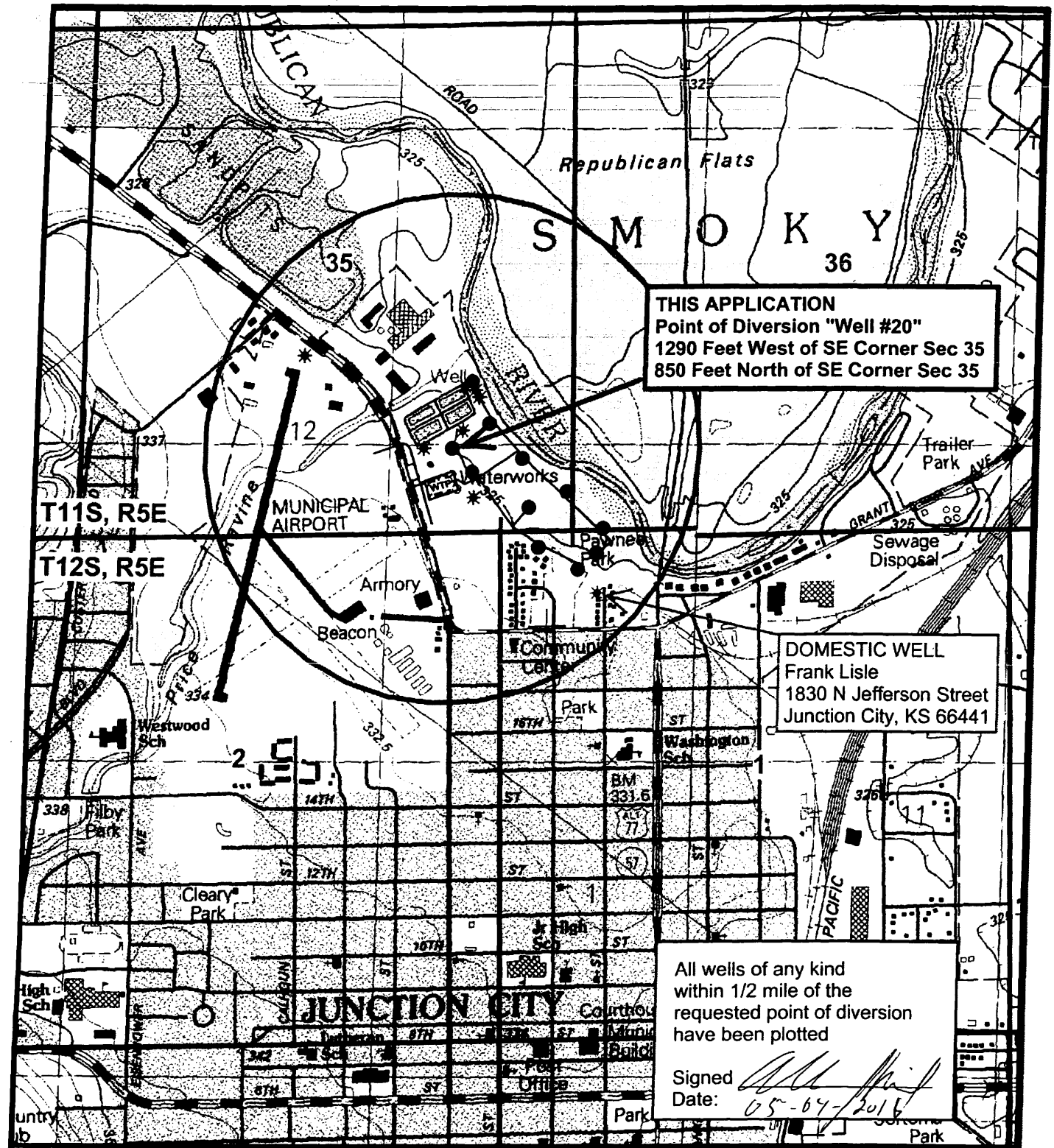

**THIS APPLICATION**  
 Point of Diversion "Well #20"  
 1290 Feet West of SE Corner Sec 35  
 850 Feet North of SE Corner Sec 35

**DOMESTIC WELL**  
 Frank Lisle  
 1830 N Jefferson Street  
 Junction City, KS 66441

All wells of any kind  
 within 1/2 mile of the  
 requested point of diversion  
 have been plotted

Signed: *[Signature]*  
 Date: 05-04-2016

Base map adapted from USGS Topo Quad

**LEGEND**

- Well For This Application
- Junction City Production Well
- \* Junction City Observation Well
- \* Other Well

- 1/2 Mile Radius
- 35 Section Number
- + Section Corner
- Section Line
- Water Pipeline

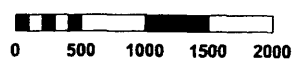

MAY 18 2016

KS DEPT OF AGRICULTURE

1320 Research Park Drive  
Manhattan, Kansas 66502  
(785) 564-6700



900 SW Jackson, Room 456  
Topeka, Kansas 66612  
(785) 296-3556

Jackie McClaskey, Secretary

Governor Sam Brownback

Doug Schemm  
Environmental Scientist  
Kansas Department of Agriculture  
Division of Water Resources

October 11, 2016

RE: Kansas Water Assurance District Eligibility, File No. 49,638

Hello Doug,

Thank you for providing me a copy of the application File No. 49,638 filed by the City of Junction City, Kansas for inclusion in the Kansas River Water Assurance District No. 1 (District). Water Management Services has reviewed the application of an additional 98.8 acre-feet per year diverted from groundwater for inclusion in the District.

The City of Junction City was originally determined to benefit substantially from district releases in 1986 as per K.S.A. 82a-1345(d). When determining benefit for a groundwater right holder, no specific statutory criteria has been identified as to the location of the point of diversion, however, the Chief Engineer decided when the district was formed and determinations were made that wells would generally need to be located within ¼ mile of the river and divert at least 1,000 acre-feet annually. The point of diversion requested under File No. 49,638 is located within the ¼ mile radius of the river and supports a diversion of greater than 1,000 acre-feet annually.

The Kansas Water Office analysis with the Operation Analysis and Simulation of the Integrated Systems (OASIS) computer model, provided to KDA-DWR on September 28, 2016, indicated that under current operations and simulated sedimentation that sufficient storage remained with the increased annual water use of 6,416.4 acre-feet per year to meet demands for at least 20-years into the future.

Therefore, if approved File No. 49,638 should be included in the Kansas River Water Assurance District No. 1.

Sincerely,

Ginger Pugh  
Engineering Associate  
Kansas Department of Agriculture  
Division of Water Resources

900 SW Jackson St., Ste 404  
Topeka, KS 66612



Phone: (785)-296-3185  
Fax: (785)-296-0878  
www.kwo.org

Tracy Streeter, Director

Sam Brownback, Governor

September 28, 2016

Mr. Doug Schemm  
Kansas Department of Agriculture  
Division of Water Resources  
Topeka Field Office  
6531 SE Forbes Ave., Ste B  
Topeka, KS 66619

Dear Mr. Schemm:

The Kansas Water Office (KWO) has reviewed the application filed with the Kansas Department of Agriculture/Division of Water Resources (DWR) by the City of Junction City, Kansas, for permit to appropriate water under application file number 49,638.

As the City of Junction City is an existing member of the Kansas River Water Assurance District No. 1 (KRWAD), the KWO reviewed the application in accordance with the KWO-KDA/DWR Water Assurance District Modeling MOU dated November 2, 2015, which states, the KWO will provide information in order for the Chief Engineer to ascertain whether the application meets the criteria of K.S.A. 82a-1345(d), specifically a determination for any new or existing member of an assurance district that sufficient additional storage may be yielded from assurance reservoirs to benefit the member.

Based upon your Aug. 23, 2016, notification email we have reviewed application File No. 49,638 as requesting an additional 32.2 million gallons per year (98.8 af/yr) increasing the total annual volume of water to 2,090.8 million gallons per year (6,416.4 af/yr) for the City of Junction City when combined with their existing senior rights.

The KWO uses the Operational Analysis and Simulation of the Integrated Systems (OASIS) computer model to simulate how the demands of the KRWAD members impact the assurance storage supply owned by the district in Milford, Tuttle Creek and Perry reservoirs. Data inputs to the model include total authorized water right quantities for water users on the Kansas River or projected demands as applied to estimated reservoir current capacities and after 20 years of sedimentation, respectively. For the future scenario run, the sedimentation rates applied to reservoirs in the model domain were based upon the most recent data available to the KWO. Both current and 20 years into the future simulations use climatic and hydrologic condition from calendar years 1950 through 2014.

The OASIS model first is run using the current reservoir area-elevation-capacities with the increased annual water use of 6,416.4 af/yr for the City of Junction City. Then the same simulation is run using the projected 2035 reservoir area-elevation-capacities and projected demands. In both simulations, natural flow is used when available to meet the demands in the basin. When insufficient natural flow is available, releases from assurance storage, as presently owned by the KRWAD in Milford Reservoir in the case of Junction City, are used to meet demands.

The current condition OASIS simulation results indicate assurance storage is sufficient for the requested increase to 6,416.4 af/yr of demand. Results of the OASIS simulation for projected reservoir capacities 20 years in future indicate assurance storage is also sufficient to meet the increased demand associated with this application.

Be advised that this analysis for the City of Junction City, Kansas, application File Number 49,638 is based on the operations in effect at the time of notice to review.

Sincerely,

A handwritten signature in black ink, appearing to read "Cara C. Hendricks", written in a cursive style.

Cara C. Hendricks, P.E.  
Kansas Water Office

Cc: Galen Biery

## Schemm, Doug

---

**From:** Schemm, Doug  
**Sent:** Tuesday, August 09, 2016 8:21 AM  
**To:** 'krwad@att.net'  
**Subject:** City of Junction City New App and Changes  
**Attachments:** Scan - Inbox\_018.pdf; Scan - Inbox\_014 (1).pdf; 20160809064523978.tif

Galen,  
Sorry size to big, I will send this in 2 batches.  
Doug

---

**From:** Schemm, Doug  
**Sent:** Tuesday, August 09, 2016 8:11 AM  
**To:** [krwad@att.net](mailto:krwad@att.net)  
**Subject:** City of Junction City New App and Changes

Good Morning Galen,  
The City of Junction City has a pending new application, File No. 49,638 to drill a new well near their current well field. This new application is requesting 32.2 million gallons additional water when combined with their senior water rights. In addition, the City is re-drilling current well 16 due to a collapsed screen. Applications to change the point of diversion are attached for the 3 files that cover this well, GE002; 9,658; and 23,804.  
I have attached copies of the applications and a cover letter.  
Thanks,  
Doug

## Schemm, Doug

---

**From:** Schemm, Doug  
**Sent:** Tuesday, August 09, 2016 8:25 AM  
**To:** 'krwad@att.net'  
**Subject:** City of Junction City New App and Changes  
**Attachments:** Scan - Inbox \_015 (1).pdf; Scan - Inbox \_016 (1).pdf

Other change apps.

---

**From:** Schemm, Doug  
**Sent:** Tuesday, August 09, 2016 8:11 AM  
**To:** [krwad@att.net](mailto:krwad@att.net)  
**Subject:** City of Junction City New App and Changes

Good Morning Galen,

The City of Junction City has a pending new application, File No. 49,638 to drill a new well near their current well field. This new application is requesting 32.2 million gallons additional water when combined with their senior water rights. In addition, the City is redrilling current well 16 due to a collapsed screen. Applications to change the point of diversion are attached for the 3 files that cover this well, GE002; 9,658; and 23,804.

I have attached copies of the applications and a cover letter.

Thanks,  
Doug



1320 Research Park Drive  
Manhattan, Kansas 66502  
Jackie McClaskey, Secretary

Phone: (785) 564-6700  
Fax: (785) 564-6777  
Email: ksag@kda.ks.gov  
www.agriculture.ks.gov  
Sam Brownback, Governor

May 18, 2016

CITY OF JUNCTION CITY  
700 N JEFFERSON PO BOX 287  
JUNCTION CITY KS 66441

RE: Application  
File No. 49638

Dear Sir or Madam:

Your application for permit to appropriate water in 35-11S-5E in Geary County, was received and has been assigned the file number noted above.

As a matter of record, the Division of Water Resources has on hand a large number of applications awaiting processing. Therefore to be fair to all concerned, and so that we can process those applications on hand in the order they were received, we intend to concentrate on the backlog of applications until the issue is resolved. Once review of your application has begun, we will contact you, if additional information is required.

In accordance with the provisions of the Kansas Water Appropriation Act, a portion of which is included below, the use of water as proposed prior to approval of the application is unlawful. Once approved, compliance with the terms, conditions and limitations of the permit is necessary. Conservation of the water resources of Kansas is required.

**Section 82a-728 of the Kansas Water Appropriation Act, provides (a) except for the appropriation of water for the purpose of domestic use, . . . it shall be unlawful for any person to appropriate or threaten to appropriate water from any source without first applying for and obtaining a permit to appropriate water in accordance with the provisions of the Water Appropriation Act or for any person to violate any condition of a vested right, appropriation right or an approved application for a permit to appropriate water for beneficial use.**

**(b) (1) The violation of any provision of this section by any person is a class C misdemeanor . . .**

**A class C misdemeanor is punishable by a fine not to exceed \$500 and/or a term of confinement not to exceed one month in the county jail. Each day that the violation occurs constitutes a separate offense.**

If you have any questions, please contact me at (785) 564-6645. If you wish to discuss a specific file, please have the file number ready so that we may help you more efficiently.

Sincerely,

A handwritten signature in black ink that reads "Brent A. Turney". The signature is written in a cursive style.

Brent A Turney, P.G.  
Change Application Unit Supervisor  
Water Appropriation Program

BAT: ALH  
pc: TOPEKA Field Office  
GMD

SCANNED

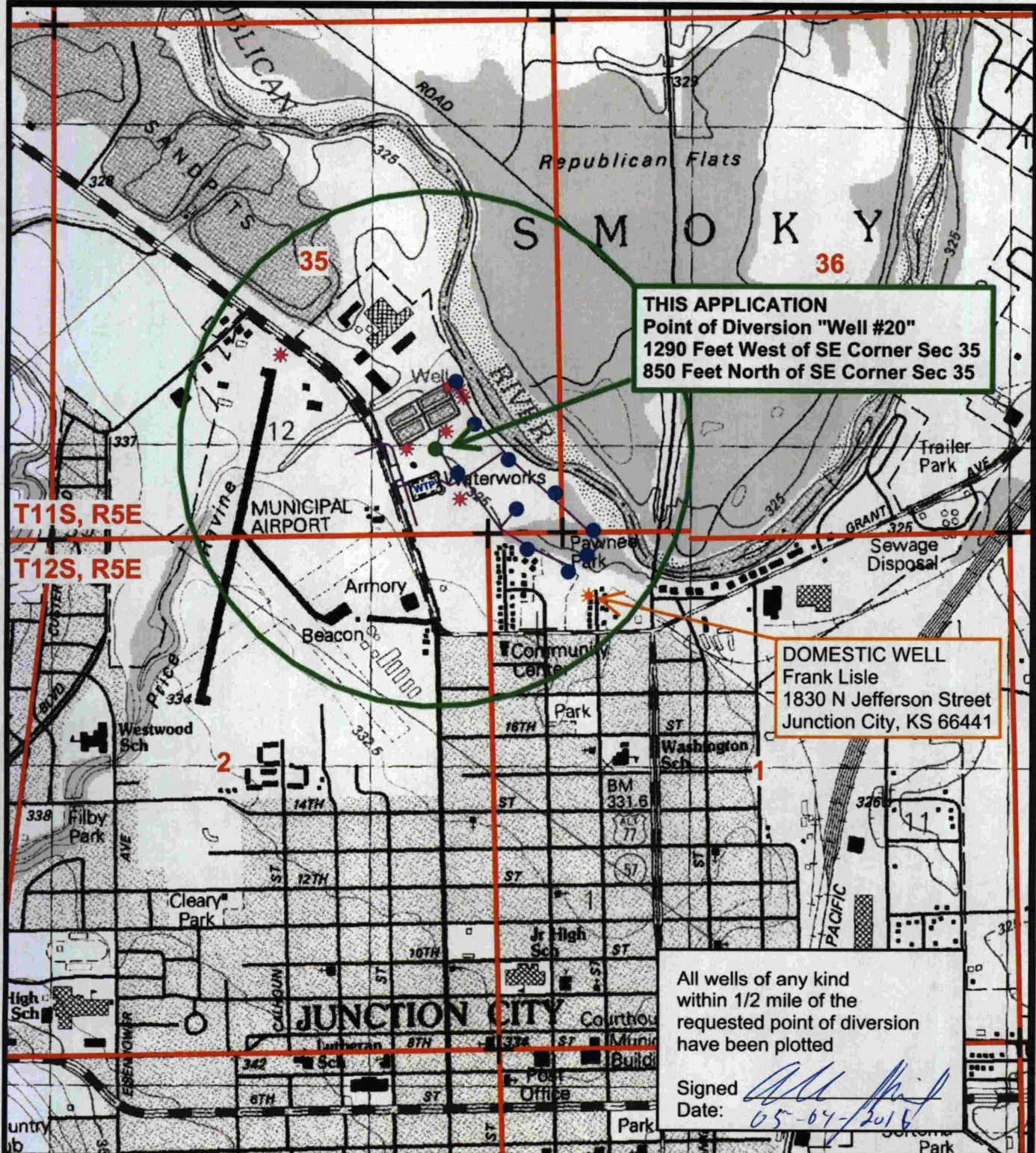

**LEGEND**

- Well For This Application
- Junction City Production Well
- \* Junction City Observation Well
- \* Other Well

- 1/2 Mile Radius
  - 35 Section Number
  - + Section Corner
  - Section Line
  - Water Pipeline
- WATER RESOURCES RECEIVED  
 MAY 18 2016  
 KS DEPT OF AGRICULTURE

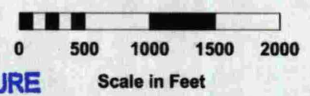

Application for Permit to appropriate Water for Beneficial Use for Well #20

SCANNED



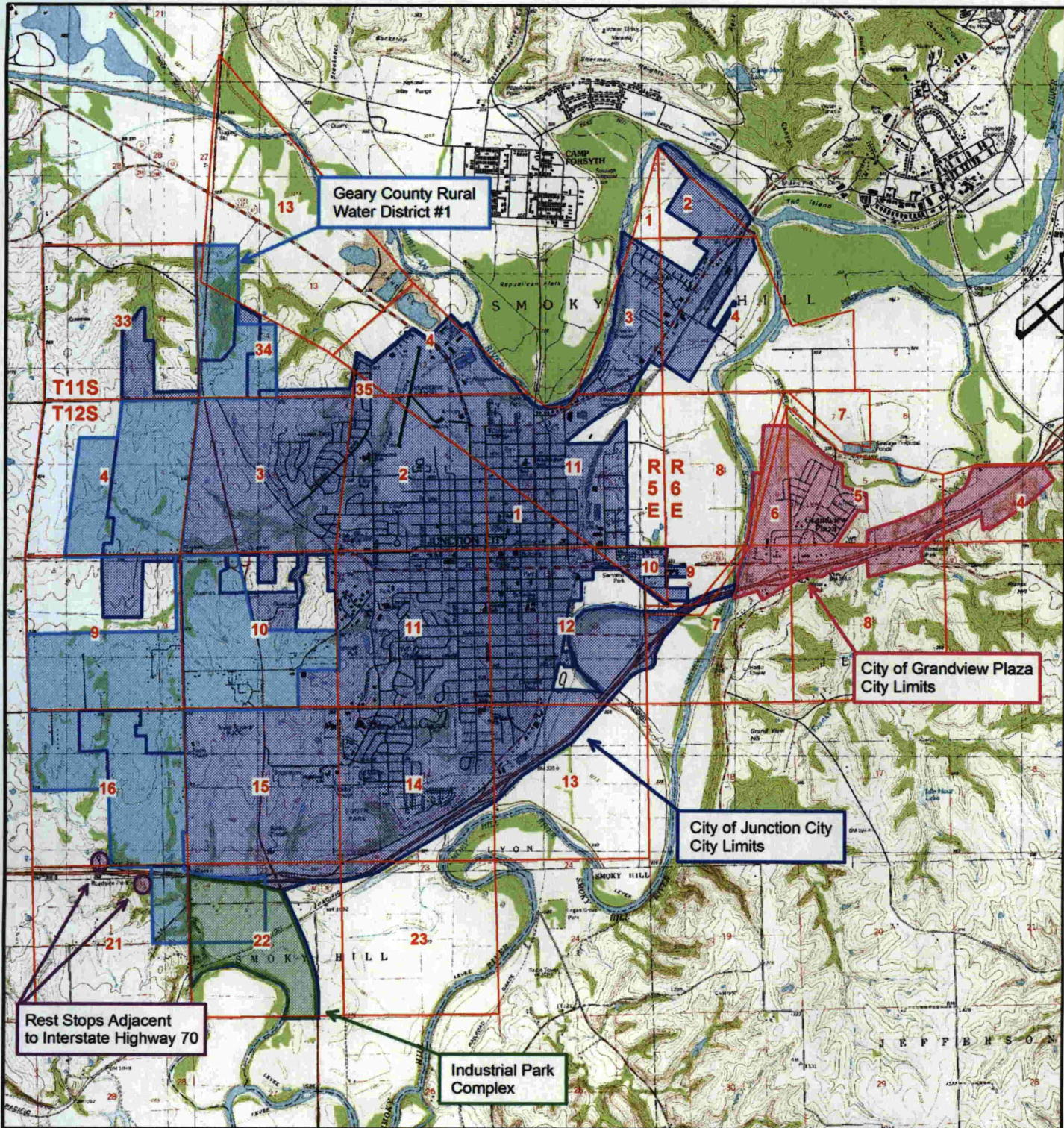



Base map adapted from USGS Topo Quad

**LEGEND**

-  City of Junction City
-  City of Grandview Plaza
-  Geary County, RWD #1
-  Industrial Park

-  Interstate 70 Rest Stops
-  PLSS Section Lines
- 22** PLSS Section Numbers

**WATER RESOURCES RECEIVED**

MAY 18 2016

KANSAS DEPT OF AGRICULTURE



Scale in Miles

**Application for Permit to Appropriate Water for Beneficial Use for Well #20**

SCANNED