

THE STATE OF KANSAS



**KANSAS DEPARTMENT OF AGRICULTURE**  
Jackie McClaskey, Secretary of Agriculture

**DIVISION OF WATER RESOURCES**  
David W. Barfield, Chief Engineer

File Number 49,702  
This item to be completed by the Division of Water Resources.

WATER RESOURCES  
RECEIVED

**APPLICATION FOR PERMIT TO  
APPROPRIATE WATER FOR BENEFICIAL USE**  
Filing Fee Must Accompany the Application  
(Please refer to Fee Schedule attached to this application form.)

SEP 08 2016  
12:59  
KS DEPT OF AGRICULTURE

*To the Chief Engineer of the Division of Water Resources, Kansas Department of Agriculture,  
109 SW 9<sup>th</sup> Street, Second Floor, Topeka, KS 66612-1283:*

1. Name of Applicant (Please Print): DILL FARMS LLC  
Address: 1976 ROAD 110  
City: HARTFORD State KS Zip Code: 66854-9233  
Telephone Number: (620) 392-5737

2. The source of water is:  surface water in \_\_\_\_\_ (stream)  
OR  groundwater in NEOSHO RIVER (drainage basin)

Certain streams in Kansas have minimum target flows established by law or may be subject to administration when water is released from storage for use by water assurance district members. If your application is subject to these regulations on the date we receive your application, you will be sent the appropriate form to complete and return to the Division of Water Resources.

3. The maximum quantity of water desired is 252 acre-feet OR \_\_\_\_\_ gallons per calendar year, to be diverted at a maximum rate of 1,400 gallons per minute OR \_\_\_\_\_ cubic feet per second.

Once your application has been assigned a priority, the requested maximum rate of diversion and maximum requested quantity of water under that priority number can **NOT** be increased. Please be certain your requested maximum rate of diversion and maximum quantity of water are appropriate and reasonable for your proposed project and are in agreement with the Division of Water Resources' requirements.

4. The water is intended to be appropriated for (Check use intended):  
(a)  Artificial Recharge (b)  Irrigation (c)  Recreational (d)  Water Power  
(e)  Industrial (f)  Municipal (g)  Stockwatering (h)  Sediment Control  
(i)  Domestic (j)  Dewatering (k)  Hydraulic Dredging (l)  Fire Protection  
(m)  Thermal Exchange (n)  Contamination Remediation

YOU **MUST** COMPLETE AND ATTACH ADDITIONAL DIVISION OF WATER RESOURCES FORM(S) PROVIDING INFORMATION TO SUBSTANTIATE YOUR REQUEST FOR THE AMOUNT OF WATER FOR THE INTENDED USE REFERENCED ABOVE.

**For Office Use Only:**

F.O. 1 GMD \_\_\_\_\_ Meets K.A.R. 5-3-1 (YES) NO) Use 1R Source GDS County LYON By gmc Date 9-8-2016  
Code \_\_\_\_\_ REG \_\_\_\_\_ Fee \$ 300 TR # \_\_\_\_\_ Receipt Date 9-9-2016 Check # 704D

5. The location of the proposed wells, pump sites or other works for diversion of water is:

**Note:** For the application to be accepted, the point of diversion location must be described to at least a 10 acre tract, unless you specifically request a 60 day period of time in which to locate the site within a specifically described, minimal legal quarter section of land.

- (A) One in the SW Quarter of the SE quarter of the NW quarter of Section 6, more particularly described as being near a point 3,000 feet North and 3,550 feet West of the Southeast corner of said section, in Township 20 South, Range 13 EAST, LYON County, Kansas. \* **Geo-Ctr of Groundwater Pit**
- (B) One in the \_\_\_\_\_ quarter of the \_\_\_\_\_ quarter of the \_\_\_\_\_ quarter of Section \_\_\_\_\_, more particularly described as being near a point \_\_\_\_\_ feet North and \_\_\_\_\_ feet West of the Southeast corner of said section, in Township \_\_\_\_\_ South, Range \_\_\_\_\_ East/West (circle one), \_\_\_\_\_ County, Kansas.
- (C) One in the \_\_\_\_\_ quarter of the \_\_\_\_\_ quarter of the \_\_\_\_\_ quarter of Section \_\_\_\_\_, more particularly described as being near a point \_\_\_\_\_ feet North and \_\_\_\_\_ feet West of the Southeast corner of said section, in Township \_\_\_\_\_ South, Range \_\_\_\_\_ East/West (circle one), \_\_\_\_\_ County, Kansas.
- (D) One in the \_\_\_\_\_ quarter of the \_\_\_\_\_ quarter of the \_\_\_\_\_ quarter of Section \_\_\_\_\_, more particularly described as being near a point \_\_\_\_\_ feet North and \_\_\_\_\_ feet West of the Southeast corner of said section, in Township \_\_\_\_\_ South, Range \_\_\_\_\_ East/West (circle one), \_\_\_\_\_ County, Kansas.

If the source of supply is groundwater, a separate application shall be filed for each proposed well or battery of wells, except that a single application may include up to four wells within a circle with a quarter (¼) mile radius in the same local source of supply which do not exceed a maximum diversion rate of 20 gallons per minute per well.

A battery of wells is defined as two or more wells connected to a common pump by a manifold; or not more than four wells in the same local source of supply within a 300 foot radius circle which are being operated by pumps not to exceed a total maximum diversion rate of 800 gallons per minute and which supply water to a common distribution system.

6. The owner of the point of diversion, if other than the applicant is (please print):

Applicant  
(name, address and telephone number)

\_\_\_\_\_  
(name, address and telephone number)

You must provide evidence of legal access to, or control of, the point of diversion from the landowner or the landowner's authorized representative. Provide a copy of a recorded deed, lease, easement or other document with this application. In lieu thereof, you may sign the following sworn statement:

I have legal access to, or control of, the point of diversion described in this application from the landowner or the landowner's authorized representative. I declare under penalty of perjury that the foregoing is true and correct.

Executed on \_\_\_\_\_, 2016.

  
Applicant's Signature

7. The proposed project for diversion of water will consist of 1 groundwater pit  
(number of wells, pumps or dams, etc.)  
and (was)(will be) completed (by) Already Existing  
(Month/Day/Year - each was or will be completed)

8. The first actual application of water for the proposed beneficial use was or is estimated to be Summer 2016  
(Mo/Day/Year)

## FEE SCHEDULE

1. The fee for an application for a permit to appropriate water for beneficial use, except for domestic use, shall be (see paragraph No. 2 below if requesting storage):

ACRE-FEET	FEE
0-100	\$200.00
<del>101-320</del>	<del>\$300.00</del>
More than 320	\$300.00 plus \$20.00 for each additional 100 acre-feet or any part thereof.

2. The fee for an application in which storage is requested, except for domestic use, shall be:

ACRE-FEET	FEE
0-250	\$200.00
More than 250	\$200.00 plus \$20.00 for each additional 250 acre-feet of storage or any part thereof.

Note: If an application requests both direct use *and* storage, the fee charged shall be as determined under No. 1 or No. 2 above, whichever is greater, but not both fees.

3. The fee for an application for a permit to appropriate water for water power or dewatering purposes shall be \$100.00 plus \$200.00 for each 100 cubic feet per second, or part thereof, of the diversion rate requested.

Note: The applicant shall notify the Chief Engineer and pay the statutorily required field inspection fee of ~~\$400.00~~ when construction of the works for diversion has been completed, except that for applications filed on or after July 1, 2009, for works constructed for sediment control use and for evaporation from a groundwater pit for industrial use shall be accompanied by a field inspection fee of \$200.00.

### MAKE CHECKS PAYABLE TO THE KANSAS DEPARTMENT OF AGRICULTURE

#### ATTENTION

A Water Conservation Plan may be required per K.S.A. 82a-733. A statement that your application for permit to appropriate water may be subject to the minimum desirable streamflow requirements per K.S.A. 82a-703a, b, and c may also be required from you. After the Division of Water Resources has had the opportunity to review your application, you will be notified whether or not you will need to submit a Water Conservation Plan. You also may be required to install a water flow meter or water stage measuring device on your diversion works prior to diverting water. There may be other special conditions or Groundwater Management District regulations that you will need to comply with if this application is approved.

#### CONVERSION FACTORS

1 acre-foot equals 325,851 gallons

1 million gallons equal 3.07 acre-feet

DILL FARMS LLC - NEW APPLICATION  
Sections 6 and 7, Township 20 South, Range 13 East  
Lyon County

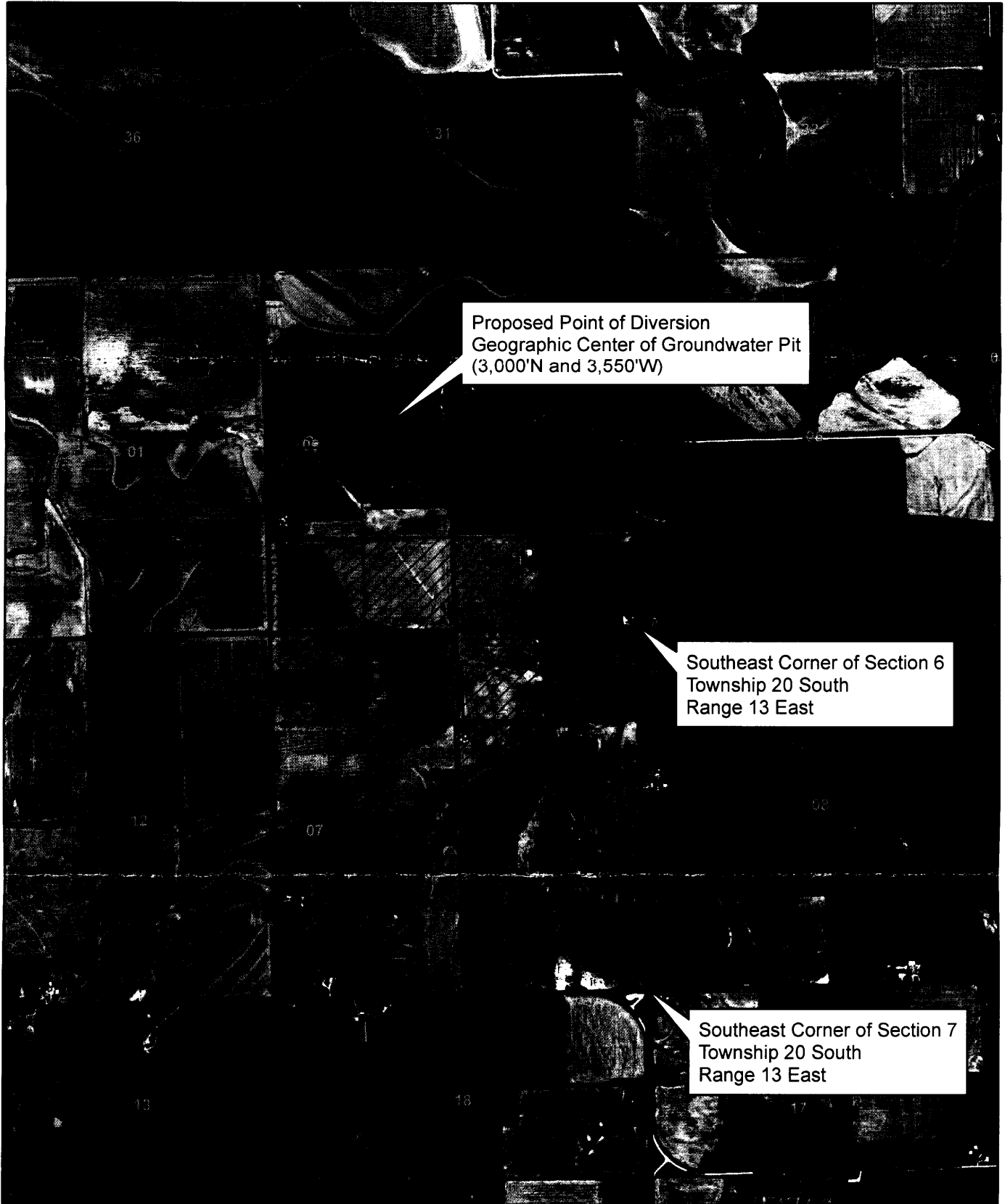

1:24,000



WATER RESOURCES  
RECEIVED  
Proposed Place of Use

● Proposed Point of Diversion

SEP 08 2016  
KS DEPT OF AGRICULTURE

All known wells within one-half mile of the proposed point of diversion are shown on this map.

*John H. Dill*





Topeka Field Office  
6531 SE Forbes Ave., Suite B  
Topeka, Kansas 66619

Jackie McClaskey, Secretary  
David W. Barfield, Chief Engineer  
Katherine A. Tietz, Water Commissioner

Phone: (785) 296-5733  
Fax: (785) 862-2460  
www.agriculture.ks.gov

Sam Brownback, Governor

August 4, 2016

DILL FARMS LLC  
1976 ROAD 110  
HARTFORD KS 66854-9233

RE: New Application for Appropriation of Water, and  
Dismissal of Appropriation of Water, File No. 49,053

Dear Mr. Dill:

Enclosed are application forms related to completing a new application for permit to appropriate water for beneficial use. Please review the "Application For Permit To Appropriate Water For Beneficial Use" form, and make any modifications you wish. Also review the proposed place of use on the site map, and the enclosed "Irrigation Use Supplemental Sheet". Please add owner name and address for the proposed place of use on the supplemental sheet and Paragraph No. 15.

**You must sign the application at both Paragraph Nos. 6 and 16.** For the requested quantity of 252 acre-feet, the filing fee would be **\$300**. Please submit the original application with signatures, and filing fee to the **Kansas Department of Agriculture, Division of Water Resources, 1320 Research Park Drive, Manhattan, KS 66502**.

In addition, enclosed is a "Voluntary Waiver of Hearing and Dismissal of Water Right" form for File No. 49,053. The proposed new application will essentially replace this file. Both the dismissal form and the enclosed Minimum Desirable Streamflow form must be signed and notarized.

You may contact the Topeka Field Office at (785) 296-5733, or myself at (785) 296-3495, for any additional assistance in completing these application forms.

Sincerely,

A handwritten signature in black ink that reads "Doug Schemm".

Douglas Schemm  
Environmental Scientist  
Topeka Field Office

Enclosures

WATER RESOURCES  
RECEIVED

SEP 08 2016

KS DEPT OF AGRICULTURE

\_\_\_\_\_ (Date)

Kansas Department of Agriculture  
Division of Water Resources  
David W. Barfield, Chief Engineer  
1320 Research Park Drive  
Manhattan, Kansas 66502

Re: Application  
File No. \_\_\_\_\_

Minimum Desirable Streamflow  
Neosho River Basin

Dear Sir:

I understand that a Minimum Desirable Streamflow requirement has been established by the legislature for the source of supply to which the above referenced application applies.

I understand that diversion of water pursuant to this application will be subject to regulation any time Minimum Desirable Streamflow requirements are not being met.

I also understand that if this application is approved, there could be times, as determined by the Division of Water Resources, when I would not be allowed to divert water. I realize that this could affect the economics of my decision to appropriate water.

I am aware of the above factors, and with the knowledge thereof, request that the Division of Water Resources proceed with processing and approval, if possible, of the above referenced application.

  
\_\_\_\_\_  
Signature of Applicant

  
\_\_\_\_\_  
(Print Applicant's Name)

State of Kansas )  
 ) ss  
County of \_\_\_\_\_ )

I hereby certify that the foregoing instrument was signed in my presence and sworn to before me this \_\_\_\_ day of \_\_\_\_\_, 2016.

\_\_\_\_\_  
Notary Public

My Commission Expires:

WATER RESOURCES  
RECEIVED

SEP 08 2016

**MINIMUM DESIRABLE STREAMFLOW FORM TO BE USED WHEN  
APPLICABLE WHEN FILING AN APPLICATION FOR PERMIT  
TO APPROPRIATE WATER FOR BENEFICIAL USE**

The Kansas Legislature has established minimum desirable streamflows for the streams listed below. If your proposed diversion of water is going to be from one of these watercourses or adjacent alluvial aquifers, please complete the back side of this page and submit it along with your application for permit to appropriate water.

Arkansas River  
Big Blue River  
Chapman Creek  
Chikaskia River  
Cottonwood River  
Delaware River  
Little Arkansas River  
Little Blue River  
Marais des Cygnes River  
Medicine Lodge River  
Mill Creek (Wabaunsee Co. area)  
Neosho River

Ninnescah River  
North Fork Ninnescah River  
Rattlesnake Creek  
Republican River  
Saline River  
Smoky Hill River  
Solomon River  
South Fork Ninnescah  
Spring River  
Walnut River  
Whitewater River

9. Will pesticide, fertilizer, or other foreign substance be injected into the water pumped from the diversion works?  
 Yes    No   If "yes", a check valve shall be required.

All chemigation safety requirements must be met including a chemigation permit and reporting requirements.

10. If you are planning to impound water, please contact the Division of Water Resources for assistance, prior to submitting the application. Please attach a reservoir area capacity table and inform us of the total acres of surface drainage area above the reservoir.

Have you also made an application for a permit for construction of this dam and reservoir with the Division of Water Resources?    Yes    No

- If yes, show the Water Structures permit number here \_\_\_\_\_
- If no, explain here why a Water Structures permit is not required \_\_\_\_\_  
Not building impoundment, existing groundwater pit

11. The application must be supplemented by a U.S.G.S. topographic map, aerial photograph or a detailed plat showing the following information. On the topographic map, aerial photograph, or plat, identify the center of the section, the section lines or the section corners and show the appropriate section, township and range numbers. Also, please show the following information:

- (a) The location of the proposed point(s) of diversion (wells, stream-bank installations, dams, or other diversion works) should be plotted as described in Paragraph No. 5 of the application, showing the North-South distance and the East-West distance from a section line or southeast corner of section.
- (b) If the application is for groundwater, please show the location of any existing water wells of any kind within ½ mile of the proposed well or wells. Identify each existing well as to its use and furnish the name and mailing address of the property owner or owners. If there are no wells within ½ mile, please advise us.
- (c) If the application is for surface water, the names and addresses of the landowner(s) ½ mile downstream and ½ mile upstream from your property lines must be shown.
- (d) The location of the proposed place of use should be shown by crosshatching on the topographic map, aerial photograph or plat.
- (e) Show the location of the pipelines, canals, reservoirs or other facilities for conveying water from the point of diversion \_\_\_\_\_

A 7.5 minute U.S.G.S. topographic map may be obtained by providing the section, township and range numbers to: Kansas Geological Survey, 1930 Constant, Campus West, University of Kansas, Lawrence, Kansas 66047.

12. List any application, appropriation of water, water right, or vested right file number that covers the same diversion points or any of the same place of use described in this application. Also list any other recent modifications made to existing permits or water rights in conjunction with the filing of this application.

Pd overlap with File Nos. 29,987; 46,940; and 49,054, geo-center of groundwater pit.

Partial PU overlap with File No. 49,053, which will be voluntarily dismissed upon approval of this new application.

WATER RESOURCES  
RECEIVED

SEP 08 2016

KS DEPT OF AGRICULTURE



13. Furnish the following well information if the proposed appropriation is for the use of groundwater. If the well has not been completed, give information obtained from test holes, if available.

Information below is from:  Test holes  Well as completed  Drillers log attached

Well location as shown in paragraph No.	(A)	(B)	(C)	(D)
Date Drilled	_____	_____	_____	_____
Total depth of well	_____	_____	_____	_____
Depth to water bearing formation	_____	_____	_____	_____
Depth to static water level	_____	_____	_____	_____
Depth to bottom of pump intake pipe	_____	_____	_____	_____

14. The relationship of the applicant to the proposed place where the water will be used is that of

Owner/tenant  
(owner, tenant, agent or otherwise)

15. The owner(s) of the property where the water is used, if other than the applicant, is (please print):

Audrey J. Peterson Living Trust, 2956 SW Gainsboro Road, Topeka, KS 66614-4412  
(name, address and telephone number)

Need owner name & address →

John Lawrence M Rust, 32 East 5th, Allen Ks, 66833, 620 528 3681  
(name, address and telephone number)

16. The undersigned states that the information set forth above is true to the best of his/her knowledge and that this application is submitted in good faith.

Dated at Hartford, Kansas, this 25 day of Aug, 2016  
(month) (year)

John K. Dill  
(Applicant Signature)

[REDACTED]  
APPLICANT(S) SOCIAL SECURITY IDENTIFICATION NUMBER(S)

By \_\_\_\_\_  
(Agent or Officer Signature)

\_\_\_\_\_  
and/or APPLICANT(S) TAXPAYER I.D. NO.(S)

\_\_\_\_\_  
(Agent or Officer - Please Print)

# IRRIGATION USE SUPPLEMENTAL SHEET

File No. \_\_\_\_\_

Name of Applicant (Please Print): Dill Farms LLC

1. Please supply the name and address of each landowner, the legal description of the lands to be irrigated, and designate the actual number of acres to be irrigated in each forty acre tract or fractional portion thereof:

**Landowner of Record** NAME: DILL FARMS LLC

ADDRESS: 1976 Road 110, Hartford, KS 66854-9233

S	T	R	NE¼				NW¼				SW¼				SE¼				TOTAL
			NE	NW	SW	SE	NE	NW	SW	SE	NE	NW	SW	SE	NE	NW	SW	SE	
6	20	13E															40		40
7	20	12E		40	12														52

7 20S 13E  
?  
see map

NAME: AUDREY J PETERSON LIVING TRUST

ADDRESS: 2956 SW GAINSBORO RD, TOPEKA KS 66614-4412

S	T	R	NE¼				NW¼				SW¼				SE¼				TOTAL
			NE	NW	SW	SE	NE	NW	SW	SE	NE	NW	SW	SE	NE	NW	SW	SE	
6	20	13E										40	40						80

**Landowner of Record** NAME: Audrey J Peterson  
ADDRESS: 821 S.W. 93rd, Waukegan, KS, 66546

Need owner name + address →

S	T	R	NE¼				NW¼				SW¼				SE¼				TOTAL
			NE	NW	SW	SE	NE	NW	SW	SE	NE	NW	SW	SE	NE	NW	SW	SE	
7	20	12E					40	40											80

7 20S 13E  
?  
see map

TOTAL = 252 Acres

WATER RESOURCES  
RECEIVED

SEP 08 2016

2. Please complete the following information for the description of the operation for the irrigation project. Attach supplemental sheets as needed.

a. Indicate the soils in the field(s) and their intake rates:

Soil Name	Percent of field (%)	Intake Rate (in/hr)	Irrigation Design Group
_____	_____	_____	_____
_____	_____	_____	_____
_____	_____	_____	_____
_____	_____	_____	_____
Total:	100 %		

b. Estimate the average land slope in the field(s): \_\_\_\_\_ %

Estimate the maximum land slope in the field(s): \_\_\_\_\_ %

c. Type of irrigation system you propose to use (check one):

- Center pivot                       Center pivot - LEPA                       "Big gun" sprinkler  
 Gravity system (furrows)                       Gravity system (borders)                       Sideroll sprinkler

Other, please describe: \_\_\_\_\_

d. System design features:

i. Describe how you will control tailwater:

ii. For sprinkler systems:

(1) Estimate the operating pressure at the distribution system: \_\_\_\_\_ psi

(2) What is the sprinkler package design rate? \_\_\_\_\_ gpm

(3) What is the wetted diameter (twice the distance the sprinkler throws water) of a sprinkler on the outer 100 feet of the system? \_\_\_\_\_ feet

(4) Please include a copy of the sprinkler package design information.

e. Crop(s) you intend to irrigate. Please note any planned crop rotations:

f. Please describe how you will determine when to irrigate and how much water to apply (particularly important if you do not plan a full irrigation).

You may attach any additional information you believe will assist in informing the Division of the need for your request.

**VOLUNTARY WAIVER OF HEARING & DISMISSAL OF WATER RIGHT**

To: Kansas Department of Agriculture  
Division of Water Resources (DWR)  
1320 Research Park Drive  
Manhattan, Kansas 66502  
<http://agriculture.ks.gov/dwr>

Re: Appropriation of Water   
Water Right   
Vested Right   
Term Permit   
(Check Appropriate Box Above)  
File No. 49,053

The undersigned owner(s) and/or authorized agent(s) of the above referenced water right, or permit, freely and voluntarily request that the file be dismissed and its priority forfeited. By signing this waiver, I am indicating my understanding and agreement that I am relinquishing all right, title and interest in said water right.

The signature(s) below represent all present owners (or an authorized agent) for the file number shown above (attach duplicate copies of this document as necessary).

The signature(s) below also indicate(s) a waiver of any right to a hearing or an appeal that I/we may have had regarding the dismissal and termination of the above referenced file. I/we recognize that if this closure request is submitted to the Division of Water Resources, it will terminate this water right and forfeit any priority associated with it forever.

Indicate here if you wish to retain the well(s) for domestic use (DWR water right not required):

John R. Dill  
(Signature of Owner or Authorized Agent)

\_\_\_\_\_  
(Signature of Spouse or Title of Authorized Agent)

DILL FARMS LLC  
(Please print name here)

\_\_\_\_\_  
(Please print name here)

1976 ROAD 110  
(Mailing Address)

\_\_\_\_\_  
(Mailing Address)

HARTFORD, KS 66854-9233  
(City, State, Zip)

\_\_\_\_\_  
(City, State, Zip)

**ACKNOWLEDGMENT**

State of Kansas )  
County of \_\_\_\_\_)

This instrument was acknowledged before me this \_\_\_\_\_ day of \_\_\_\_\_, \_\_\_\_\_ by  
(owners.) \_\_\_\_\_

(Seal)

WATER RESOURCES  
RECEIVED

\_\_\_\_\_  
Notary Public

My appointment expires: SEP 08 2016

DWS  
DWR Initials

KS DEPT OF AGRICULTURE

*\*Dismissal Contingent Upon Approval of New Application.*

1320 Research Park Drive  
Manhattan, Kansas 66502

Jackie McClaskey, Secretary



Phone: (785) 564-6700  
Fax: (785) 564-6777  
Email: ksag@kda.ks.gov  
www.agriculture.ks.gov  
Sam Brownback, Governor

September 9, 2016

DILL FARMS, LLC  
1976 ROAD 110  
HARFORD KS 66854

**FILE COPY**

RE: Application  
File No. 49702

Dear Sir or Madam:

Your application for permit to appropriate water in S06-T20-R13E in Lyon County, was received and has been assigned the file number noted above.

As a matter of record, the Division of Water Resources has on hand a large number of applications awaiting processing. Therefore to be fair to all concerned, and so that we can process those applications on hand in the order they were received, we intend to concentrate on the backlog of applications until the issue is resolved. Once review of your application has begun, we will contact you, if additional information is required.

In accordance with the provisions of the Kansas Water Appropriation Act, a portion of which is included below, the use of water as proposed prior to approval of the application is unlawful. Once approved, compliance with the terms, conditions and limitations of the permit is necessary. Conservation of the water resources of Kansas is required.

**Section 82a-728 of the Kansas Water Appropriation Act, provides (a) except for the appropriation of water for the purpose of domestic use, . . . it shall be unlawful for any person to appropriate or threaten to appropriate water from any source without first applying for and obtaining a permit to appropriate water in accordance with the provisions of the Water Appropriation Act or for any person to violate any condition of a vested right, appropriation right or an approved application for a permit to appropriate water for beneficial use.**

**(b) (1) The violation of any provision of this section by any person is a class C misdemeanor . . .**

**A class C misdemeanor is punishable by a fine not to exceed \$500 and/or a term of confinement not to exceed one month in the county jail. Each day that the violation occurs constitutes a separate offense.**

If you have any questions, please contact me at (785) 564-6645. If you wish to discuss a specific file, please have the file number ready so that we may help you more efficiently.

Sincerely,

A handwritten signature in cursive script that reads "Brent A. Turney".

Brent A Turney, P.G.  
Change Application Unit Supervisor  
Water Appropriation Program

BAT: dlw  
pc: TOPEKA Field Office  
GMD 0