

Submit To: CHIEF ENGINEER  
Division of Water Resources  
Kansas Department of Agriculture  
1320 Research Park Drive  
Manhattan, Kansas 66502  
http://agriculture.ks.gov/dwr

**APPLICATION FOR APPROVAL TO  
CHANGE THE PLACE OF USE, THE  
POINT OF DIVERSION OR THE USE  
MADE OF THE WATER UNDER AN  
EXISTING WATER RIGHT**



State of Kansas

**Filing Fee Must Accompany the Application**  
(Please refer to Fee Schedule on signature page of application form.)

Paragraph Nos. 1, 2, 3, 4 & 8 must be completed. Complete all other applicable portions. A topographic map or detailed plat showing the authorized and proposed points(s) of diversion and /or place of use must accompany this application.

1. Application is hereby made for approval of the Chief Engineer to change the

- Place of Use
- (Check one or more)  Point of Diversion
- Use Made of Water

WATER RESOURCES  
RECEIVED  
SEP 22 2017  
10:40  
KS DEPT OF AGRICULTURE

File No. 48,875

2. Name of applicant: ROGER HUSER

Address: 3522 HARPER RD

City, State and Zip: FREDONIA KS 66736

Phone Number: (620) 332-3858 E-mail address: R & A Services <roger@raservicesinc.com>

What is your relationship to the water right;  owner  tenant  agent  other? If other, please explain. \_\_\_\_\_

Name of water use correspondent: Same as applicant

Address: \_\_\_\_\_

City, State and Zip: \_\_\_\_\_

Phone Number: (\_\_\_\_) \_\_\_\_\_ E-mail address: \_\_\_\_\_

3. The change(s) proposed herein are desired for the following reasons (please be specific): \_\_\_\_\_

CHANGE WILL AUTHORIZE A SECOND POND ON THE SAME STREAM IN ORDER TO INCREASE STORAGE QUANTITY. THIS CHANGE WILL ALSO CREATE A COMPLETE OVERLAP WITH PENDING NEW APPLICATION.

The change(s) (was) (will be) completed by SUMMER 2017 Fall 2018  
(Date)

For Office Use Only:						
F.O. \	GMD	Meets K.A.R. 5-5-1 (YES / NO)	Use	Source	G / S	County
Code	667		IRR	G / S	WL	By AM Date 9-22-17
		Fee \$	200	TR #	Receipt Date	9-22-17 Check # 3048

9/26/2017 CM

4. The presently authorized place of use is:

Owner of Land — NAME: NO CHANGE

ADDRESS: \_\_\_\_\_

*No Change*

Sec.	Twp.	Range	NE¼				NW¼				SW¼				SE¼				TOTAL ACRES		
			NE¼	NW¼	SW¼	SE¼	NE¼	NW¼	SW¼	SE¼	NE¼	NW¼	SW¼	SE¼	NE¼	NW¼	SW¼	SE¼			

List any other water rights that cover this place of use. \_\_\_\_\_

Owner of Land — NAME: \_\_\_\_\_

ADDRESS: \_\_\_\_\_

Sec.	Twp.	Range	NE¼				NW¼				SW¼				SE¼				TOTAL ACRES			
			NE¼	NW¼	SW¼	SE¼	NE¼	NW¼	SW¼	SE¼	NE¼	NW¼	SW¼	SE¼	NE¼	NW¼	SW¼	SE¼				

List any other water rights that cover this place of use. \_\_\_\_\_

(If there are more than two landowners, attach additional sheets as necessary.)

5. It is proposed that the place of use be changed to:

Owner of Land — NAME: \_\_\_\_\_

ADDRESS: \_\_\_\_\_

Sec.	Twp.	Range	NE¼				NW¼				SW¼				SE¼				TOTAL ACRES				
			NE¼	NW¼	SW¼	SE¼	NE¼	NW¼	SW¼	SE¼	NE¼	NW¼	SW¼	SE¼	NE¼	NW¼	SW¼	SE¼					

List any other water rights that cover this place of use. \_\_\_\_\_

Owner of Land — NAME: \_\_\_\_\_

ADDRESS: \_\_\_\_\_

Sec.	Twp.	Range	NE¼				NW¼				SW¼				SE¼				TOTAL ACRES					
			NE¼	NW¼	SW¼	SE¼	NE¼	NW¼	SW¼	SE¼	NE¼	NW¼	SW¼	SE¼	NE¼	NW¼	SW¼	SE¼						

List any other water rights that cover this place of use. \_\_\_\_\_

**IF MORE SPACE IS NEEDED, ATTACH ADDITIONAL SHEETS AS NECESSARY**

6. The presently authorized point(s) of diversion (is) (are) ONE DAM  
(Provide description and number of points)

7. The proposed point(s) of diversion (is) (are) TWO DAMS  
(Provide description and number of points)

List all presently authorized point(s) of diversion:

8. **Presently authorized point of diversion:**  
 One in the NE Quarter of the SE Quarter of the NE Quarter of Section 20, Township 30 South, Range 14 EAST, in WILSON County, Kansas, 3,375 feet North 455 feet West of Southeast corner of section.  
 Authorized Rate \_\_\_\_\_ Authorized Quantity \_\_\_\_\_  
 (DWR use only: Computer ID No. \_\_\_\_\_ GPS \_\_\_\_\_ feet North \_\_\_\_\_ feet West)  
 This point will not be changed     This point will be changed as follows:  
**Proposed point of diversion: (Complete only if change is requested)**  
 One in the \_\_\_\_\_ Quarter of the \_\_\_\_\_ Quarter of the \_\_\_\_\_ Quarter of Section \_\_\_\_\_, Township \_\_\_\_\_ South, Range \_\_\_\_\_ (E/W), in \_\_\_\_\_ County, Kansas, \_\_\_\_\_ feet North \_\_\_\_\_ feet West of Southeast corner of section.  
 Proposed Rate \_\_\_\_\_ Proposed Quantity \_\_\_\_\_  
 This point is:  Additional Well     Geo Center    List other water rights that will use this point New Application

9. **Presently authorized point of diversion:**  
 One in the \_\_\_\_\_ Quarter of the \_\_\_\_\_ Quarter of the \_\_\_\_\_ Quarter of Section \_\_\_\_\_, Township \_\_\_\_\_ South, Range \_\_\_\_\_ (E/W), in \_\_\_\_\_ County, Kansas, \_\_\_\_\_ feet North \_\_\_\_\_ feet West of Southeast corner of section.  
 Authorized Rate \_\_\_\_\_ Authorized Quantity \_\_\_\_\_  
 (DWR use only: Computer ID No. \_\_\_\_\_ GPS \_\_\_\_\_ feet North \_\_\_\_\_ feet West)  
 This point will not be changed     This point will be changed as follows:  
**Proposed point of diversion: (Complete only if change is requested)**  
 One in the SE Quarter of the NW Quarter of the NW Quarter of Section 21, Township 30 South, Range 14 EAST, in WILSON County, Kansas, 4,006 feet North 4,506 feet West of Southeast corner of section.  
 Proposed Rate \_\_\_\_\_ Proposed Quantity \_\_\_\_\_  
 This point is:  Additional Well     Geo Center    List other water rights that will use this point New Application

10. **Presently authorized point of diversion:**  
 One in the \_\_\_\_\_ Quarter of the \_\_\_\_\_ Quarter of the \_\_\_\_\_ Quarter of Section \_\_\_\_\_, Township \_\_\_\_\_ South, Range \_\_\_\_\_ (E/W), in \_\_\_\_\_ County, Kansas, \_\_\_\_\_ feet North \_\_\_\_\_ feet West of Southeast corner of section.  
 Authorized Rate \_\_\_\_\_ Authorized Quantity \_\_\_\_\_  
 (DWR use only: Computer ID No. \_\_\_\_\_ GPS \_\_\_\_\_ feet North \_\_\_\_\_ feet West)  
 This point will not be changed     This point will be changed as follows:  
**Proposed point of diversion: (Complete only if change is requested)**  
 One in the \_\_\_\_\_ Quarter of the \_\_\_\_\_ Quarter of the \_\_\_\_\_ Quarter of Section \_\_\_\_\_, Township \_\_\_\_\_ South, Range \_\_\_\_\_ (E/W), in \_\_\_\_\_ County, Kansas, \_\_\_\_\_ feet North \_\_\_\_\_ feet West of Southeast corner of section.  
 Proposed Rate \_\_\_\_\_ Proposed Quantity \_\_\_\_\_  
 This point is:  Additional Well     Geo Center    List other water rights that will use this point \_\_\_\_\_

11. Describe the current condition of and future plans for any point(s) of diversion which will no longer be used. \_\_\_\_\_

IF MORE SPACE IS NEEDED, ATTACH ADDITIONAL SHEETS AS NECESSARY

WATER RESOURCES  
SEP 22 2017  
KS DEPT OF AGRICULTURE

12. The presently authorized use of water is for IRRIGATION purposes.

It is proposed that the use be changed to NO CHANGE purposes.

13. If changing the place of use and/or use made of water, describe how the consumptive use will not be increased.

N/A

(Please show any calculations here.)

14. It is requested that the maximum annual quantity of water be reduced to \_\_\_\_\_ (acre-feet or million gallons).

15. It is requested that the maximum rate of diversion of water be reduced to \_\_\_\_\_ gallons per minute (\_\_\_\_\_ c.f.s.).

16. The application must include either a topographic map or detailed plat. A U.S. Geological Survey Topographic Map, scale 1:24,000, is available through the Kansas Geological Survey, 1930 Constant Avenue, University of Kansas, Lawrence, Kansas 66047-3726 ([www.usgs.gov](http://www.usgs.gov)). The map should show the location of the presently authorized point(s) of diversion. Distances North and West of the Southeast corner of the section must be shown. The presently authorized place of use should also be shown. Identify the center of the section, the section lines and the section corners and show the appropriate section, township, and range numbers on the map. In addition the following information must also be shown on the map.

a. If a change in the location of the point(s) of diversion is proposed, show:

- 1) The location of the proposed point(s) of diversion. Distances North and West of the Southeast corner of the section must be shown. Please be certain that the information shown on the map agrees with the information shown in Paragraph Nos. 9, 10 and 11 of the application.
- 2) If the source of supply is groundwater, please show the location of existing water wells of any kind, including domestic wells, within 1/2 mile of the proposed well or wells. Identify each well as to its use and furnish name and mailing address of the property owner or owners. If there are no wells within 1/2 mile, please indicate so on the map.
- 3) If the source of supply is surface water, the names and mailing addresses of all landowner(s) 1/2 mile downstream and 1/2 mile upstream from your property lines must be shown.

b. If a change in the place of use is desired, show the proposed place of use by crosshatching on the map. Please be certain that the information shown on the map agrees with the information shown in Paragraph No. 5 of the application.

17. Attach documentation to show the change(s) proposed herein will not impair existing water rights and relates to the same local source of supply as to which the water right relates. This information may include statements, plats, geology reports, well logs, test hole logs, and other information as necessary information to show the above. Additional comments may be made below.

BOTH RESERVOIRS ARE LOCATED ON SAME TRIBUTARY STREAM.

18. If the proposed change(s) does not meet all applicable rules and regulations of the Kansas Water Appropriation Act, please identify the rules and regulations for which you request a waiver. State the reason why a waiver is needed and why the request should be granted. Attach documentation showing that granting the request will not impair existing water rights and will not prejudicially and unreasonably affect the public interest.

N/A

**IF MORE SPACE IS NEEDED, ATTACH ADDITIONAL SHEETS AS NECESSARY**

Any use of water that is not as authorized by the water right or permit to authorize water before the chief engineer approves this application is a violation of the Kansas Water Appropriation Act for which criminal or civil penalties may be assessed. Such violation is a class C misdemeanor, punishable by a fine not to exceed \$500 and/or a term of confinement not to exceed one month in the county jail. K.S.A. 82a-728(b). Civil penalties shall be not less than \$100 nor more than \$1,000 per violation. In the case of a continuing violation, each day such violation continues may be deemed a separate violation. In addition to these penalties the water right may be modified or suspended. K.S.A. 82a-737, as amended.

The application must be signed by all owners of the place of use authorized under the water right and his or her spouse, if married. Please indicate if there is no spouse. If land is being purchased under contract, the seller must sign as landowner until such time as the contract is completed.

In the event that all applicants cannot appear before one notary public, they may as necessary sign separate copies of the application before any notary public conveniently available to them. All copies signed in this manner shall be considered to be valid parts of the application.

If the request is signed on behalf of any Owner by someone with legal authority to do so (for example, an agent, one who has power of attorney, or an executor, executrix, conservator), it will be necessary to attach proper documents showing such authority.

I declare that I am an owner of the currently authorized place of use as identified herein, or that I represent all such owners and am authorized to make this application on their behalf, and declare further that the statements contained herein are true, correct, and complete. By filing this application I authorize the chief engineer to permanently reduce the quantity of water and/or rate of diversion as specified in sections 14 and 15 of this application.

Dated at Needesha, Kansas, this 19 day of September, 2017.

Roger Huser (Owner)
Roger Huser (Please Print)

Ann Huser (Spouse)
Ann Huser (Please Print)

(Owner)
(Please Print)
(Owner)
(Please Print)

(Spouse)
(Please Print)
(Spouse)
(Please Print)

State of Kansas
County of Wilson } SS



I hereby certify that the foregoing application was signed in my presence and sworn to before me this 19 day of Sept, 2017.

My Commission Expires 9/11/20

Stephanie Tyler
Notary Public

FEE SCHEDULE

Each application to change the place of use, the point of diversion or the use made of the water under this section shall be accompanied by the application fee set forth in the schedule below:

- (1) Application to change a point of diversion 300 feet or less \$100
(2) Application to change a point of diversion more than 300 feet \$200
(3) Application to change the place of use \$200
(4) Application to change the use made of the water \$300

Make check payable to Kansas Department of Agriculture.

WATER RESOURCES RECEIVED
SEP 22 2017
KS DEPT OF AGRICULTURE

## FEE SCHEDULE

1. The fee for an application for a permit to appropriate water for beneficial use, except for domestic use, shall be (see paragraph No. 2 below if requesting storage):

ACRE-FEET	FEE
0-100	\$200.00
101-320	\$300.00
More than 320	\$300.00 plus \$20.00 for each additional 100 acre-feet or any part thereof.

2. The fee for an application in which storage is requested, except for domestic use, shall be:

ACRE-FEET	FEE
0-250	\$200.00
More than 250	\$200.00 plus \$20.00 for each additional 250 acre-feet of storage or any part thereof.

Note: If an application requests both direct use *and* storage, the fee charged shall be as determined under No. 1 or No. 2 above, whichever is greater, but not both fees.

3. The fee for an application for a permit to appropriate water for water power or dewatering purposes shall be \$100.00 plus \$200.00 for each 100 cubic feet per second, or part thereof, of the diversion rate requested.

Note: The applicant shall notify the Chief Engineer and pay the statutorily required field inspection fee of \$400.00 when construction of the works for diversion has been completed, except that for applications filed on or after July 1, 2009, for works constructed for sediment control use and for evaporation from a groundwater pit for industrial use shall be accompanied by a field inspection fee of \$200.00.

### **MAKE CHECKS PAYABLE TO THE KANSAS DEPARTMENT OF AGRICULTURE**

#### **ATTENTION**

A Water Conservation Plan may be required per K.S.A. 82a-733. A statement that your application for permit to appropriate water may be subject to the minimum desirable streamflow requirements per K.S.A. 82a-703a, b, and c may also be required from you. After the Division of Water Resources has had the opportunity to review your application, you will be notified whether or not you will need to submit a Water Conservation Plan. You also may be required to install a water flow meter or water stage measuring device on your diversion works prior to diverting water. There may be other special conditions or Groundwater Management District regulations that you will need to comply with if this application is approved.

#### **CONVERSION FACTORS**

1 acre-foot equals 325,851 gallons

1 million gallons equal 3.07 acre-feet

WATER RESOURCES  
RECEIVED

SEP 22 2017

KS DEPT OF AGRICULTURE

  
**Kansas**  
Department of Agriculture  
*Division of Water Resources*

Topeka Field Office  
6531 SE Forbes Ave., Suite B  
Topeka, Kansas 66619

Jackie McClaskey, Secretary  
David W. Barfield, Chief Engineer  
Katherine A. Tjetsort, Water Commissioner

Phone: (785) 296-5733  
Fax: (785) 862-2460  
[www.agriculture.ks.gov](http://www.agriculture.ks.gov)  
Sam Brownback, Governor

August 24, 2017

WATER RESOURCES  
RECEIVED

SEP 22 2017

KS DEPT OF AGRICULTURE

ROGER HUSER  
3522 HARPER RD  
FREDONIA KS 66736

RE: Reduction in Place of Use, Appropriation of Water, File No. 48,875

Dear Mr. Huser:

Enclosed is a "Request to Reduce a Portion of an Existing Water Right" form for the above referenced file number. Please note that this reduction form **must be signed by all owners of the currently authorized place of use, and his or her spouse. All signatures must be notarized.**

Please submit the completed form, with all signatures, to the **Kansas Department of Agriculture, Division of Water Resources, 1320 Research Park Drive, Manhattan, KS 66502.**

You may contact the Topeka Field Office at (785) 296-5733, or myself at (785) 296-3495, for any additional assistance in completing this application form.

Sincerely,



Douglas Schemm  
Environmental Scientist  
Topeka Field Office

Enclosures



ROGER HUSER - FILE NO. 48,875  
 REDUCTION IN PLACE OF USE SITE MAP  
 SECS. 20 & 22, T30S, R14E

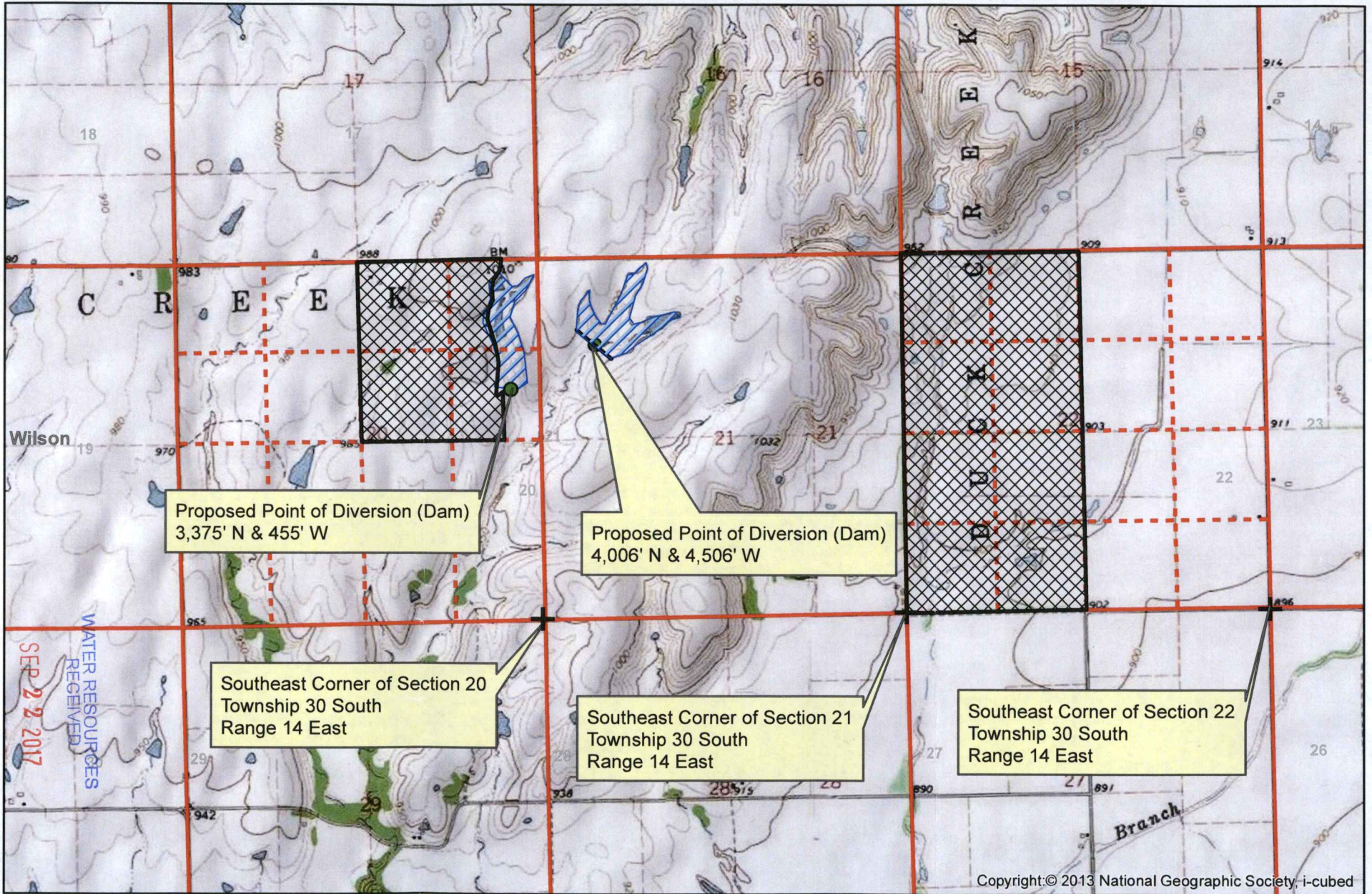

Proposed Point of Diversion (Dam)  
 3,375' N & 455' W

Proposed Point of Diversion (Dam)  
 4,006' N & 4,506' W

Southeast Corner of Section 20  
 Township 30 South  
 Range 14 East

Southeast Corner of Section 21  
 Township 30 South  
 Range 14 East

Southeast Corner of Section 22  
 Township 30 South  
 Range 14 East

● Proposed Point of Diversion

▨ Proposed Place of Use

1:24,000

KS DEPT. OF AGRICULTURE

SEP 22 2017

WATER RESOURCES  
 RECEIVED

Copyright © 2013 National Geographic Society, i-cubed





FILE NO. 48,875 - CHANGE IN POINT OF DIVERSION  
 SITE MAP, SECS. 20 & 21, T30S, R14E

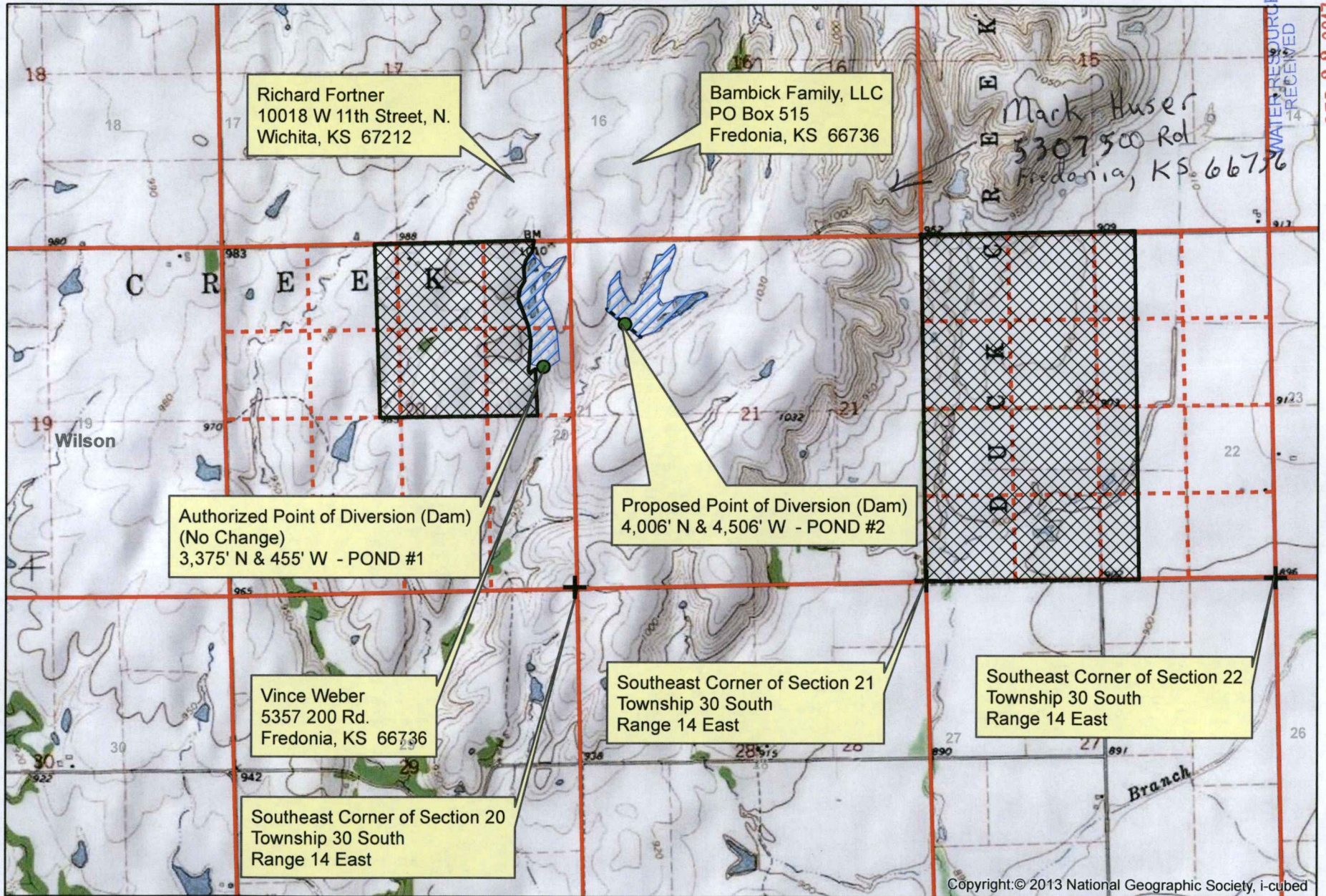

Richard Fortner  
 10018 W 11th Street, N.  
 Wichita, KS 67212

Bambick Family, LLC  
 PO Box 515  
 Fredonia, KS 66736

Mark Huser  
 5307 500 Rd  
 Fredonia, KS 66736

Authorized Point of Diversion (Dam)  
 (No Change)  
 3,375' N & 455' W - POND #1

Proposed Point of Diversion (Dam)  
 4,006' N & 4,506' W - POND #2

Vince Weber  
 5357 200 Rd.  
 Fredonia, KS 66736

Southeast Corner of Section 21  
 Township 30 South  
 Range 14 East

Southeast Corner of Section 22  
 Township 30 South  
 Range 14 East

Southeast Corner of Section 20  
 Township 30 South  
 Range 14 East

Copyright:© 2013 National Geographic Society, i-cubed

1:24,000

 Authorized Place of Use

 Proposed Point of Diversion

All known landowners adjacent to the stream  
 within one-half mile upstream and downstream  
 of the property lines have been shown.

*Roger Huser*

WATER RESOURCES  
 RECEIVED

SEP 22 2017

KS DEPT OF AGRICULTURE





THE STATE OF KANSAS



KANSAS DEPARTMENT OF AGRICULTURE  
Jackie McClaskey, Secretary of Agriculture

DIVISION OF WATER RESOURCES  
David W. Barfield, Chief Engineer

**REQUEST TO REDUCE A PORTION OF AN EXISTING WATER RIGHT  
(NO FEE REQUIRED)**

Identify the file which is the subject of this request:

- Vested Right, File No. \_\_\_\_\_
- (CHECK ONE)  Water Right, File No. \_\_\_\_\_
- Appropriation of Water, File No. 48,875

WATER RESOURCES  
RECEIVED

SEP 22 2017

To: CHIEF ENGINEER  
Division of Water Resources  
Kansas Department of Agriculture  
1320 Research Park Drive  
Manhattan, Kansas 66502

KS DEPT OF AGRICULTURE

From: (Names and addresses of owners of authorized place of use. Please see instructions on back.)

ROGER HUSER \ STEVE HUSER \ JAMES SHULTZ \ PEGGY SIERMAN  
3522 HARPER RD \ 2084 DECATUR RD \ 6409 CR 2500 \ 7309 W WASHINGTON  
FREDONIA KS 66736 \ FREDONIA KS 66736 \ ELK CITY KS 67344 \ FREDONIA KS 66736

REQUEST

The above listed owners request a:

[Complete only the sections that apply. Check only the boxes that apply. Fill in only the blanks that apply.]

A.  REDUCTION IN AUTHORIZED MAXIMUM ANNUAL QUANTITY OF WATER.

It is requested that the maximum annual quantity of water be reduced to \_\_\_\_\_  
(acre-feet or million gallons; circle one) per calendar year.

B.  REDUCTION IN AUTHORIZED MAXIMUM RATE OF DIVERSION OF WATER.

It is requested that the maximum rate of diversion of water be reduced to \_\_\_\_\_ gallons per minute  
(\_\_\_\_\_ c.f.s.).

Assisted by: DWS/TFO



I, the undersigned owner of this water right or permit declare that: (1) I am freely and voluntarily choosing to reduce the water right listed; and (2) I am waiving any rights to a hearing or an appeal that I may have had regarding the reduction of the water right listed.

I declare that I am an owner, as identified herein, or that I represent an owner, as identified herein, and am authorized to make this request on his or her behalf.

Dated at Fredonia, Kansas, this 12 day of September, 2017.  
(City) (Month) (Year)

Roger Huser  
(Owner)

Ann Huser  
(Spouse)

Roger Huser  
(Please Print)

Ann Huser  
(Please Print)

\_\_\_\_\_  
(Owner)

\_\_\_\_\_  
(Spouse)

\_\_\_\_\_  
(Please Print)

\_\_\_\_\_  
(Please Print)

\_\_\_\_\_  
(Owner)

\_\_\_\_\_  
(Spouse)

\_\_\_\_\_  
(Please Print)

\_\_\_\_\_  
(Please Print)

State of Kansas )  
County of Wilson ) ss



I hereby certify that the foregoing application was signed in my presence and sworn to before me this

12 day of September, 2017.  
(Month) (Year)

Teresa M. Apollo  
Notary Public

My Commission expires Nov 18 2018

WATER RESOURCES  
RECEIVED

SEP 22 2017

## INSTRUCTIONS:

The request must be signed by each owner of the place of use authorized by the water right or permit and his or her spouse, if married. All water right or permit owners, including spouses, must sign this request for it to be valid. Unless the water right or permit has been legally severed from the authorized place of use, the owners of the water right or permit are the owners of the authorized place of use. Please indicate if there is no spouse. If land is being purchased under contract, the seller must sign as owner until such time as the contract is completed.

In the event that all owners cannot sign together in front of one notary public, they may, as necessary, sign appropriate copies of the request in front of any notary public conveniently available to them. All copies signed in this manner shall be accepted as valid parts of the request.

If the request is signed on behalf of any owner by someone with legal authority to do so (for example, an agent, one who has power of attorney, or an executor, executrix, conservator), it will be necessary to attach proper documents showing such authority.





I, the undersigned owner of this water right or permit declare that: (1) I am freely and voluntarily choosing to reduce the water right listed; and (2) I am waiving any rights to a hearing or an appeal that I may have had regarding the reduction of the water right listed.

I declare that I am an owner, as identified herein, or that I represent an owner, as identified herein, and am authorized to make this request on his or her behalf.

Dated at Fredonia, Kansas, this 15th day of September, 2017.  
(City) (Month) (Year)

Michael Sierman  
(Owner)

Alison Sierman  
(Spouse)

Michael Sierman  
(Please Print)

Alison Sierman  
(Please Print)

\_\_\_\_\_  
(Owner)

\_\_\_\_\_  
(Spouse)

\_\_\_\_\_  
(Please Print)

\_\_\_\_\_  
(Please Print)

\_\_\_\_\_  
(Owner)

\_\_\_\_\_  
(Spouse)

\_\_\_\_\_  
(Please Print)

\_\_\_\_\_  
(Please Print)

State of Kansas )  
County of Wilson ) ss

I hereby certify that the foregoing application was signed in my presence and sworn to before me this

15 day of September, 2017.  
(Month) (Year)

TERRI JO MATNEY  
Notary Public

My Commission expires Sept 16, 2019

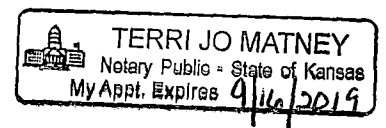

WATER RESOURCES  
RECEIVED

SEP 22 2017

KS DEPT OF AGRICULTURE

I, the undersigned owner of this water right or permit declare that: (1) I am freely and voluntarily choosing to reduce the water right listed; and (2) I am waiving any rights to a hearing or an appeal that I may have had regarding the reduction of the water right listed.

I declare that I am an owner, as identified herein, or that I represent an owner, as identified herein, and am authorized to make this request on his or her behalf.

Dated at Fredonia, Kansas, this 12<sup>th</sup> day of September, 2017.  
(City) (Month) (Year)

[Signature]  
(Owner)  
Steven Huser  
(Please Print)

[Signature]  
(Spouse)  
Florence Huser  
(Please Print)

\_\_\_\_\_  
(Owner)

\_\_\_\_\_  
(Spouse)

\_\_\_\_\_  
(Please Print)

\_\_\_\_\_  
(Please Print)

\_\_\_\_\_  
(Owner)

\_\_\_\_\_  
(Spouse)

\_\_\_\_\_  
(Please Print)

\_\_\_\_\_  
(Please Print)

State of Kansas )  
County of Wilson ) ss



I hereby certify that the foregoing application was signed in my presence and sworn to before me this

12 day of September, 2017.  
(Month) (Year)

[Signature]  
Notary Public

My Commission expires Nov 18 2018

WATER RESOURCES  
RECEIVED

SEP 22 2017

KS DEPT OF AGRICULTURE

1320 Research Park Drive  
Manhattan, Kansas 66502  
(785) 564-6700



900 SW Jackson, Room 456  
Topeka, Kansas 66612  
(785) 296-3556

Jackie McClaskey, Secretary

Governor Sam Brownback

ROGER HUSER  
3522 HARPER RD  
FREDONIA, KS 66736

9/22/2017

RE: File No 48875

**FILE COPY**

Dear Sir or Madam:

An application for approval of the Chief Engineer to change the following condition or conditions of the file number referred to above has been received:

- place of use PD
- point of diversion
- use made of water

As a matter of record, the Division of Water Resources has on hand a large number of applications awaiting processing. Therefore, to be fair to all concerned, and so that we can process those applications on hand in the order they were received, we intend to concentrate on the backlog of applications until the issue is resolved. You will be contacted regarding this application as soon as it has been examined.

In accordance with the provisions of the Kansas Water Appropriation Act, a portion of which is included below, the use of water prior to approval of the application is unlawful. You should not proceed and divert water as indicated by your plans in your application for a change for this file until you receive approval for this change from the Chief Engineer. Once approved, compliance with the terms, conditions and limitations of the permit is necessary. Conservation of the water resources of Kansas is required.

**Section 82a-728 of the Kansas Water Appropriation Act, provides (a) except for the appropriation of water for the purpose of domestic use, . . . it shall be unlawful for any person to appropriate or threaten to appropriate water from any source without first applying for and obtaining a permit to appropriate water in accordance with the provisions of the Water Appropriation Act or for any person to violate any condition of a vested right, appropriation right or an approved application for a permit to appropriate water for beneficial use.**

**(b) (1) The violation of any provision of this section by any person is a class C misdemeanor...**

**A class C misdemeanor is punishable by a fine not to exceed \$500 and/or a term of confinement not to exceed one month in the county jail. Each day that the violation occurs constitutes a separate offense.**

If you have any questions, please contact me at (785) 564-6645. If you wish to discuss a specific file, please have the file number ready so that we may help you more efficiently.

Sincerely,

A handwritten signature in cursive script that reads "Brent A. Tourney".

Brent Tourney, L.G.  
Change Applications Unit Supervisor  
Water Appropriation Program

BAT: DLW  
pc: TOPEKA Field Office GMD