

Kansas Department of Agriculture
Division of Water Resources
PERMIT OF NEW APPLICATION WORKSHEET

1. File Number: <p style="text-align: center;">50,050</p>	2. Status Change Date: <p style="text-align: center;"><i>8/3/2018</i></p>	3. Field Office: <p style="text-align: center;">01</p>	4. GMD: <p style="text-align: center;">0</p>
---	--	--	--

5. Status: Approved Denied by DWR/GMD Dismiss by Request/Failure to Return

6. Enclosures: Check Valve N of C Form Water Tube Driller Copy Meter

<p>7a. Applicant(s) New to system <input type="checkbox"/></p> <p style="text-align: right;">Person ID 66059 Add Seq# _____</p> <p>SHAWN & ROBIN LOYD 2252 LINDEN RD HIAWATHA KS 66434</p>	<p>7c. Landowner(s) New to system <input type="checkbox"/></p> <p style="text-align: right;">Person ID 66060 Add Seq# _____</p> <p>BRETT LOYD 11552 NACLORFF RD GREENVILLE IN 47124</p>
<p>7b. Landowner(s) New to system <input type="checkbox"/></p> <p style="text-align: right;">Person ID _____ Add Seq# _____</p> <p>7a.</p>	<p>7d. Misc. New to system <input type="checkbox"/></p> <p style="text-align: right;">Person ID _____ Add Seq# _____</p> <p>MIDWEST IRRIGATION % KEITH GRIMM 2991 GOLDFINCH RD HIAWATHA KS 66434 8371</p>

<p>8. WUR Correspondent New to system <input type="checkbox"/> Overlap File (s) WUC Agree <input type="checkbox"/> Yes <input type="checkbox"/> No</p> <p style="text-align: right;">Person ID _____ Add Seq# _____ Notarized WUC Form <input type="checkbox"/></p> <p>7a.</p>	<p>9. Use of Water: Changing? <input type="checkbox"/> Yes <input checked="" type="checkbox"/> No</p> <p style="text-align: center;"><input type="checkbox"/> Groundwater <input checked="" type="checkbox"/> Surface Water</p> <p><input checked="" type="checkbox"/> IRR <input type="checkbox"/> REC <input type="checkbox"/> DEW <input type="checkbox"/> MUN</p> <p><input type="checkbox"/> STK <input type="checkbox"/> SED <input type="checkbox"/> DOM <input type="checkbox"/> CON</p> <p><input type="checkbox"/> HYD DRG <input type="checkbox"/> WTR PWR <input type="checkbox"/> ART RECHRG</p> <p><input type="checkbox"/> IND SIC: _____ <input type="checkbox"/> OTHER: _____</p>
---	---

10. Completion Date: 12/31/2019 11. Perfection Date: 12/31/2023 12. Exp Date: _____

13. Conservation Plan Required? Yes No Date Required: _____ Date Approved: _____ Date to Comply: _____

14. Water Level Measuring Device? Yes No Date to Comply: _____ Date WLMD Installed: _____

*NOTE: THIS IS A SURFACE WATER STORAGE AND REDIVERSION APPLICATION.

Date Prepared: **6/21/2018** By: **DWS**
Date Entered: *8/6/2018* By: *WM*

File No. **50,050** 15. Formation Code: Drainage Basin: MISSOURI RIVER County: BR Special Use: Stream: WOLF RIVER TRIB 8 (MISSOURI)

16. Points of Diversion										17. Rate and Quantity				
MOD DEL ENT	PDIV	Qualifier	S	T	R	ID	'N	'W		Authorized Rate gpm	Quantity af	Additional Rate gpm	Quantity af	Overlap PD Files
√		86769 SW NW NE	14	3	16E	2	4476	2510		1500	516	1500	516	NONE

18. Storage: Rate **NF** Quantity **516** ac/ft Additional Rate **NF** Additional Quantity **516** ac/ft

19. Limitation: _____ af/yr at _____ gpm (_____ cfs) when combined with file number(s) _____
 Limitation: _____ af/yr at _____ gpm (_____ cfs) when combined with file number(s) _____

20. Meter Required? Yes No To be installed by **12/31/2019** Date Acceptable Meter Installed _____

21. Place of Use							NE¼				NW¼				SW¼				SE¼				Total	Owner	Chg? NO	Overlap Files	
MOD DEL ENT	PUSE	S	T	R	ID	NE ¼	NW ¼	SW ¼	SE ¼	NE ¼	NW ¼	SW ¼	SE ¼	NE ¼	NW ¼	SW ¼	SE ¼	NE ¼	NW ¼	SW ¼	SE ¼						
√	60914	14	3	16E	1	40	40	40	40	40	40		40					40	40	40	40	440	7a.	No Y	NONE		
√	68874	14	3	16E	2									40			36					76	7c.	No	NONE		

Comments:

KANSAS DEPARTMENT OF AGRICULTURE
Division of Water Resources

MEMORANDUM

TO: Files

DATE: June 21, 2018

FROM: Doug Schemm

RE: Application, File No. 50,050

Shawn & Robin Loyd have filed the application referred to above for a permit to appropriate 516 acre-feet of surface water at the rate of natural flows to be stored in a proposed reservoir located in the Northeast Quarter of Section 14, in Township 3 South, Range 16 East, Brown County, Kansas. The dam is located on a tributary to the Wolf River in the Missouri River basin. The point of diversion is located on property owned by the applicant, and the application form has been signed stating he has legal access to the point of diversion. The place of use is primarily owned by the applicant, with a portion owned by Brett Loyd, and it comprises a total of 516 acres. There are no other overlapping files in point of diversion or place of use.

Runoff computations are not necessary because historical runoff values for this area range from 14" to 18". The 952 acre drainage area will certainly yield more than the requested storage quantity in 1 out of every five (5) years (a 20% chance). Therefore, per K.A.R. 5-6-5, the runoff quantity is not the limiting factor, and the application can be processed with the requested 516 acre-feet. The requested quantity of water for direct use (rediversion) of 516 acre-feet for irrigation use on 516 acres, provides 1.0 acre-feet per acre, which is the maximum allowable per acre in Brown County, Kansas of 1.0 AF/acre, per K.A.R. 5-3-24. The proposed direct use quantity of 516 acre-feet, is equivalent to 4.9 times the capacity (104 AF), which is within the normal "rule of thumb" of direct use quantity being no more than 5 times capacity for reasonable storage quantity.

The applicant identified several downstream and upstream landowners within one-half (1/2) mile of the property lines. Nearby landowner letters were sent out on May 16, 2018, and no responses of any kind were received. There are no other surface water rights within a two-mile radius according to the WRIS database. No senior water rights will be impaired with approval of this application.

The proposed structure was reviewed by DWR Water Structures Program staff, under File No. DBR-0363/LBR-0030, and they determined that it qualifies for the hazard class A permit exemption specified in K.S.A. 82a-301(d)(1) (see May 4, 2018 letter from Ambrose Ketter). However, the letter does state that a floodplain fill permit is required prior to the start of construction. The applicant's floodplain fill permit, Structures File No, LBR-0030 will be signed in conjunction with the new application approval. As allowed by K.S.A. 82a-706(c) an approved water flow meter shall be installed on the secondary diversion works (pump site) for this file. If any chemical or foreign substance is injected into the water pumped under this permit, a check valve will also need to be installed. Since this is a proposed, new reservoir, a Special Condition on the Permit will be needed to provide an initial fill quantity of 104.7 acre-feet (capacity).

In a June 19, 2018 discussion, Katie Tietsort, Water Commissioner, Topeka Field Office, stated that the referenced new application should be approved. Based on the above discussion, that this area is open to new appropriations, the proposed appropriation of water is reasonable, the applicant has filed for the necessary permit from the DWR Water Structures Program, and senior rights will not be impacted, it is recommended that the referenced new application be approved.

Doug Schemm
Environmental Scientist
Topeka Field Office

sent to DWRB for signature

STATE OF KANSAS

DEPARTMENT OF AGRICULTURE
1320 RESEARCH PARK DRIVE
MANHATTAN, KS 66502
PHONE: (785) 564-6700
FAX: (785) 564-6777



900 SW JACKSON, ROOM 456
TOPEKA, KS 66612
PHONE: (785) 296-3556
www.agriculture.ks.gov

GOVERNOR JEFF COLYER, M.D.
JACKIE McCLASKEY, SECRETARY OF AGRICULTURE

August 8, 2018

SHAWN & ROBIN LOYD
2252 LINDEN RD
HIAWATHA KS 66434

FILE COPY

Re: Appropriation of Water, File No. 50,050

Dear Mr. and Mrs. Loyd:

There is enclosed a permit to appropriate water authorizing you to proceed with construction of the proposed diversion works (except those dams and stream obstructions regulated by K.S.A. 82a-301 through 305a), to divert such unappropriated water as may be available from the source and at the location specified in the permit, and to use it for the purpose and at the location described in the permit.

Your attention is directed to the enclosures and to the terms, conditions, and limitations specified in these approval documents. A water meter is required on the proposed re-diversion works and you must install it prior to water being put to beneficial use in order for you to maintain accurate records of water use. The meter should be used to provide the information required on the annual water use report.

Failure to notify the Chief Engineer of the Division of Water Resources of the completion of the diversion works within the time allowed, or within any authorized extension of time thereof, will result in the dismissal of this permit. Enclosed is a form which may be used to notify the Chief Engineer that the proposed diversion works have been completed. All requests for extensions of time to complete diversion works, or to perfect appropriations, must be submitted to the Chief Engineer before the expiration of time originally set forth in the permit to complete diversion works or to perfect an appropriation. If for any reason, you require an extension of time, you must request it before the expiration of time set forth in this permit. Failure to comply with this regulation will result in the dismissal of your permit or your water right. Any request for an extension of time shall be accompanied by the required statutory fee, which is currently \$100.00.

There is also enclosed an information sheet setting forth the procedure to obtain a Certificate of Appropriation which will establish the extent of your water right. If you have any questions, please contact our office. If you wish to discuss this specific file, please have the file number ready so that we may help you more efficiently.

Sincerely,

Kristen A. Baum
New Application Unit Supervisor
Water Appropriation Program

KAB:dws
Enclosures

pc: Topeka Field Office
Brett Loyd
Midwest Irrigation

KANSAS DEPARTMENT OF AGRICULTURE
Jackie McClaskey, Secretary of Agriculture

DIVISION OF WATER RESOURCES
David W. Barfield, Chief Engineer

**APPROVAL OF APPLICATION
and
PERMIT TO PROCEED**

(This is not a Certificate of Appropriation)

This is to certify that I have examined Application, **File No. 50,050** of the applicant

**SHAWN & ROBIN LOYD
2252 LINDEN RD
HIAWATHA KS 66434**

for a permit to appropriate water for beneficial use, together with the maps, plans and other submitted data, and that the application is hereby approved and the applicant is hereby authorized, subject to vested rights and prior appropriations, to proceed with the construction of the proposed diversion works (except those dams and stream obstructions regulated by K.S.A. 82a-301 through 305a, as amended), and to proceed with all steps necessary for the application of the water to the approved and proposed beneficial use and otherwise perfect the proposed appropriation subject to the following terms, conditions and limitations:

1. That the priority date assigned to such application is **April 30, 2018**.
2. That the water sought to be appropriated shall be used for irrigation use on land described in the application, as follows:

Sec. Twp. Range	NE¼				NW¼				SW¼				SE¼				TOTAL
	NE¼	NW¼	SW¼	SE¼	NE¼	NW¼	SW¼	SE¼	NE¼	NW¼	SW¼	SE¼	NE¼	NW¼	SW¼	SE¼	
14 3S 16E	40	40	40	40	40	40		40	40			36	40	40	40	40	516

3. That the appropriation sought shall be limited to all natural flows of an unnamed tributary to the Wolf River, designated in the office of the Chief Engineer as Wolf River Trib 8 (Missouri), not needed to satisfy all vested rights and prior appropriation rights to be incrementally accumulated as reservoir storage space becomes available to a maximum extent of **516 acre-feet** per calendar year in one (1) reservoir created by a dam located in the Southwest Quarter of the Northwest Quarter of the Northeast Quarter (SW¼ NW¼ NE¼) of Section 14, more particularly described as being near a point 4,476 feet North and 2,510 feet West of the Southeast corner of said section, in Township 3 South, Range 16 East, Brown County, Kansas, to provide **516 acre-feet** of water as needed for direct irrigation use to be withdrawn, released or otherwise diverted from the reservoir at a re-diversion rate of approximately **1,500 gallons per minute (3.34 c.f.s.)**. A reasonable maximum re-diversion rate will be established during the perfection period and assigned at certification.

4. That in accordance with K.A.R. 5-6-6, a maximum quantity not to exceed **104.7 acre-feet** of water may also be diverted to complete the initial filling of the reservoir only, and shall not count toward perfection of a water right under the authority of this permit. Subsequent refilling of the reservoir shall require authorization under a term permit.

5. That installation of works for diversion of water shall be completed on or before **December 31, 2019** or within any authorized extension thereof. The applicant shall notify the Chief Engineer and pay the statutorily required field inspection fee, which is currently \$400.00, when construction of the works has been completed. Failure to timely submit the notice and the fee will result in revocation of the permit. Any request for an extension of time shall be submitted prior to the expiration of the deadline and shall be accompanied by the required statutory fee, which is currently \$100.00.

6. That the proposed appropriation shall be perfected by the actual application of water to the proposed beneficial use on or before **December 31, 2023** or any authorized extension thereof. Any request for an extension of time shall be submitted prior to the expiration of the deadline and shall be accompanied by the required statutory fee, which is currently \$100.00.

7. That the applicant shall not be deemed to have acquired a water appropriation for a quantity in excess of the amount approved herein nor in excess of the amount found by the Chief Engineer to have been actually used for the approved purpose during one calendar year subsequent to approval of the application and within the time specified for perfection or any authorized extension thereof.

8. That the use of water herein authorized shall not be made so as to impair any use under existing water rights nor prejudicially and unreasonably affect the public interest.

9. That the right of the appropriator shall relate to a specific quantity of water and such right must allow for a reasonable raising or lowering of the static water level and for the reasonable increase or decrease of the streamflow at the appropriator's point of diversion.

10. That this permit does not constitute authority under K.S.A. 82a-301 through 305a to construct any dam or other obstruction; nor does it grant any right-of-way, or authorize entry upon or injury to, public or private property.

11. That all re-diversion works constructed under the authority of this permit into which any type of chemical or other foreign substance will be injected into the water pumped from the re-diversion works shall be equipped with an in-line, automatic quick-closing, check valve capable of preventing pollution of the source of the water supply. The type of valve installed shall meet specifications adopted by the Chief Engineer and shall be maintained in an operating condition satisfactory to the Chief Engineer.

12. That an acceptable water flow meter shall be installed and maintained on the re-diversion works authorized by this permit in accordance with the Kansas Administrative Regulations 5-1-4 through 5-1-12 adopted by the Chief Engineer. This water flow meter shall be used to provide an accurate quantity of water diverted as required for the annual water use report (including the meter reading at the beginning and end of the report year).

13. That the applicant shall maintain accurate and complete records from which the quantity of water diverted during each calendar year may be readily determined and the applicant shall file an annual water use report with the Chief Engineer by March 1 following the end of each calendar year. Failure to file the annual water use report by the due date shall cause the applicant to be subject to a civil penalty.

14. That no water user shall engage in nor allow the waste of any water diverted under the authority of this permit.

15. That failure without cause to comply with provisions of the permit and its terms, conditions and limitations will result in the forfeiture of the priority date, revocation of the permit and dismissal of the application.

16. That the right to appropriate water under authority of this permit is subject to any minimum desirable streamflow requirements identified and established pursuant to K.S.A. 82a-703c for the source of supply to which this water right applies.

RIGHT TO A HEARING AND TO ADMINISTRATIVE REVIEW

If you are aggrieved by this Order, then pursuant to K.S.A. 82a-1901, you may:

- 1) request an evidentiary hearing before the Chief Engineer, or
- 2) request administrative review by the Secretary of Agriculture.

Failure to request an evidentiary hearing before the Chief Engineer does not preclude your right to administrative review by the Secretary. To obtain an evidentiary hearing before the Chief Engineer, a written request for hearing must be filed within 15 days after service of this Order as provided in K.S.A. 77-531 (i.e., **within a total of 18 days after this Order was mailed to you**), with: Kansas Department of Agriculture, Attn: Legal Section, 1320 Research Park Drive, Manhattan, Kansas 66502, FAX (785) 564-6777.

If you do not file a request for an evidentiary hearing before the Chief Engineer, you may petition for administrative review of the Order by the Secretary of Agriculture. A petition for review shall be in writing and state the basis for requesting administrative review. The request for hearing may be denied if the request fails to clearly establish factual or legal issues for review. See K.S.A. 77-527. The petition must be filed within 30 days after service of this Order as provided in K.S.A. 77-531 (i.e., **within a total of 33 days after this Order was mailed to you**), and be filed with: Secretary of Agriculture, Attn: Legal Division, Kansas Department of Agriculture, 1320 Research Park Drive, Manhattan, Kansas 66502, FAX (785) 564-6777.

If neither a request for an evidentiary hearing nor a petition for administrative review is filed as set forth above, then this Order shall be effective and become a final agency action as defined in K.S.A. 77-607(b). Failure to timely request either an evidentiary hearing or administrative review may preclude further judicial review under the Kansas Judicial Review Act.

Ordered this 3rd day of August, 2018, in Topeka, Shawnee County, Kansas.

Lane P. Letourneau

Lane P. Letourneau, P.G.
Program Manager
Water Appropriation Program
Division of Water Resources
Kansas Department of Agriculture

State of Kansas)
) SS
County of Riley)

The foregoing instrument was acknowledged before me this 3rd day of August, 2018, by Lane P. Letourneau, P.G., Program Manager, Division of Water Resources, Kansas Department of Agriculture.



Danielle Wilson

Notary Public

CERTIFICATE OF SERVICE

On this ~~8th~~ day of ~~August~~, 2018, I hereby certify that the foregoing Approval of Application, File No. 50,050, dated ~~August 3rd~~, 2018 was mailed postage prepaid, first class, US mail to the following:

SHAWN & ROBIN LOYD
2252 LINDEN RD
HIAWATHA KS 66434

With photocopies to:

BRETT LOYD
11552 NACLORFF RD
GREENVILLE IN 47124

MIDWEST IRRIGATION
% KEITH GRIMM
1215 OREGON ST
HIAWATHA KS 66434

Topeka Field Office

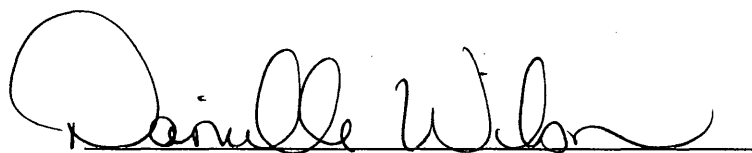

Division of Water Resources

340



KANSAS DEPARTMENT OF AGRICULTURE
Jackie McClaskey, Secretary of Agriculture

DIVISION OF WATER RESOURCES
David W. Barfield, Chief Engineer

APPLICATION COMPLETE
6/19/18
Reviewer: KAB For DWS

File Number 50050
This item to be completed by the Division of Water Resources.

Water Resources
Received
APR 30 2018
11:44
KS Dept Of Agriculture

APPLICATION FOR PERMIT TO
APPROPRIATE WATER FOR BENEFICIAL USE
Filing Fee Must Accompany the Application
(Please refer to Fee Schedule attached to this application form.)

To the Chief Engineer of the Division of Water Resources, Kansas Department of Agriculture,
1320 Research Park Drive, Manhattan, Kansas 66502:

- Name of Applicant (Please Print): SHAWN + ROBIN LOYD
Address: 2252 LINDEN Rd.
City: HIAWATHA State KS Zip Code 66434
Telephone Number: (785) 742-3125
- The source of water is: surface water in Wolf River Trib 8 (Missouri)
(stream)
OR groundwater in _____
(drainage basin)

Certain streams in Kansas have minimum target flows established by law or may be subject to administration when water is released from storage for use by water assurance district members. If your application is subject to these regulations on the date we receive your application, you will be sent the appropriate form to complete and return to the Division of Water Resources.

- The maximum quantity of water desired is 516 (Storage) acre-feet OR Rediver + 516 AF @ 1,500 gpm gallons per calendar year, to be diverted at a maximum rate of 1500/NF gallons per minute OR _____ cubic feet per second.

Once your application has been assigned a priority, the requested maximum rate of diversion and maximum requested quantity of water under that priority number can **NOT** be increased. Please be certain your requested maximum rate of diversion and maximum quantity of water are appropriate and reasonable for your proposed project and are in agreement with the Division of Water Resources' requirements.

- The water is intended to be appropriated for (Check use intended):

(a) <input type="checkbox"/> Artificial Recharge	(b) <input checked="" type="checkbox"/> Irrigation	(c) <input type="checkbox"/> Recreational	(d) <input type="checkbox"/> Water Power
(e) <input type="checkbox"/> Industrial	(f) <input type="checkbox"/> Municipal	(g) <input type="checkbox"/> Stockwatering	(h) <input type="checkbox"/> Sediment Control
(i) <input type="checkbox"/> Domestic	(j) <input type="checkbox"/> Dewatering	(k) <input type="checkbox"/> Hydraulic Dredging	(l) <input type="checkbox"/> Fire Protection
(m) <input type="checkbox"/> Thermal Exchange	(n) <input type="checkbox"/> Contamination Remediation		

YOU **MUST** COMPLETE AND ATTACH ADDITIONAL DIVISION OF WATER RESOURCES FORM(S) PROVIDING INFORMATION TO SUBSTANTIATE YOUR REQUEST FOR THE AMOUNT OF WATER FOR THE INTENDED USE REFERENCED ABOVE.

For Office Use Only:							
F.O. <input type="checkbox"/>	GMD <input type="checkbox"/>	Meets K.A.R. 5-3-1 (YES/NO) <input checked="" type="checkbox"/>	Use <u>IRP</u>	Source <u>G</u> <input checked="" type="checkbox"/>	County <u>BR</u>	By <u>AM</u>	Date <u>4-30-16</u>
Code <u>REB</u>	Fee \$ <u>340</u>	TR # _____	Receipt Date <u>4-30-16</u>	Check # <u>107A</u>			

8340

THE STATE OF KANSAS



KANSAS DEPARTMENT OF AGRICULTURE
Jackie McClaskey, Secretary of Agriculture

DIVISION OF WATER RESOURCES
David W. Barfield, Chief Engineer

File Number 50050
This item to be completed by the Division of Water Resources.

Water Resources
Received
APR 30 2018
11:44
KS Dept Of Agriculture

APPLICATION FOR PERMIT TO
APPROPRIATE WATER FOR BENEFICIAL USE
Filing Fee Must Accompany the Application
(Please refer to Fee Schedule attached to this application form.)

To the Chief Engineer of the Division of Water Resources, Kansas Department of Agriculture,
1320 Research Park Drive, Manhattan, Kansas 66502:

1. Name of Applicant (Please Print): SHAWN & ROBIN LOYD
Address: 2252 LINDEN Rd.
City: HIAWATHA State KS Zip Code 66434
Telephone Number: (785) 742-3125

2. The source of water is: surface water in _____ (stream)
OR groundwater in _____ (drainage basin)

Certain streams in Kansas have minimum target flows established by law or may be subject to administration when water is released from storage for use by water assurance district members. If your application is subject to these regulations on the date we receive your application, you will be sent the appropriate form to complete and return to the Division of Water Resources.

3. The maximum quantity of water desired is 516 acre-feet OR _____ gallons per calendar year, to be diverted at a maximum rate of 1500 gallons per minute OR _____ cubic feet per second.

Once your application has been assigned a priority, the requested maximum rate of diversion and maximum requested quantity of water under that priority number can **NOT** be increased. Please be certain your requested maximum rate of diversion and maximum quantity of water are appropriate and reasonable for your proposed project and are in agreement with the Division of Water Resources' requirements.

4. The water is intended to be appropriated for (Check use intended):
(a) Artificial Recharge (b) Irrigation (c) Recreational (d) Water Power
(e) Industrial (f) Municipal (g) Stockwatering (h) Sediment Control
(i) Domestic (j) Dewatering (k) Hydraulic Dredging (l) Fire Protection
(m) Thermal Exchange (n) Contamination Remediation

YOU **MUST** COMPLETE AND ATTACH ADDITIONAL DIVISION OF WATER RESOURCES FORM(S) PROVIDING INFORMATION TO SUBSTANTIATE YOUR REQUEST FOR THE AMOUNT OF WATER FOR THE INTENDED USE REFERENCED ABOVE.

For Office Use Only:
F.O. 1 GMD - Meets K.A.R. 5-3-1 (YES/NO) Use IRR Source G/S County BR By AM Date 4-30-16
Code REB Fee \$ 340 TR # _____ Receipt Date 4-30-16 Check # 1079

5/15/18 DAW
SCANNED

5. The location of the proposed wells, pump sites or other works for diversion of water is:

Note: For the application to be accepted, the point of diversion location must be described to at least a 10 acre tract, unless you specifically request a 60 day period of time in which to locate the site within a specifically described, minimal legal quarter section of land.

- (A) One in the SW quarter of the NW quarter of the NE quarter of Section 14, more particularly described as being near a point 446 feet North and 2510 feet West of the Southeast corner of said section, in Township 3 South, Range 16 East West (circle one), Brown County, Kansas.
- (B) One in the _____ quarter of the _____ quarter of the _____ quarter of Section _____, more particularly described as being near a point _____ feet North and _____ feet West of the Southeast corner of said section, in Township _____ South, Range _____ East/West (circle one), _____ County, Kansas.
- (C) One in the _____ quarter of the _____ quarter of the _____ quarter of Section _____, more particularly described as being near a point _____ feet North and _____ feet West of the Southeast corner of said section, in Township _____ South, Range _____ East/West (circle one), _____ County, Kansas.
- (D) One in the _____ quarter of the _____ quarter of the _____ quarter of Section _____, more particularly described as being near a point _____ feet North and _____ feet West of the Southeast corner of said section, in Township _____ South, Range _____ East/West (circle one), _____ County, Kansas.

If the source of supply is groundwater, a separate application shall be filed for each proposed well or battery of wells, except that a single application may include up to four wells within a circle with a quarter (1/4) mile radius in the same local source of supply which do not exceed a maximum diversion rate of 20 gallons per minute per well.

A battery of wells is defined as two or more wells connected to a common pump by a manifold; or not more than four wells in the same local source of supply within a 300 foot radius circle which are being operated by pumps not to exceed a total maximum diversion rate of 800 gallons per minute and which supply water to a common distribution system.

6. The owner of the point of diversion, if other than the applicant is (please print):

Same

 (name, address and telephone number)

~~Beth Joyl 11552 [unclear] [unclear] 5724~~

 (name, address and telephone number)

You must provide evidence of legal access to, or control of, the point of diversion from the landowner or the landowner's authorized representative. Provide a copy of a recorded deed, lease, easement or other document with this application. In lieu thereof, you may sign the following sworn statement:

I have legal access to, or control of, the point of diversion described in this application from the landowner or the landowner's authorized representative. I declare under penalty of perjury that the foregoing is true and correct.

Executed on 4/27/18, 2018. [Signature]
 Applicant's Signature

The applicant must provide the required information or signature irrespective of whether they are the landowner. Failure to complete this portion of the application will cause it to be unacceptable for filing and the application will be returned to the applicant.

7. The proposed project for diversion of water will consist of 1 Pond & Pump

 (number of wells, pumps or dams, etc.)
 and (was)(will be) completed (by) June 1st 2019

 (Month/Day/Year - each was or will be completed)

8. The first actual application of water for the proposed beneficial use was or is estimated to be July 1st 2019
 (Mo/Day/Year)

Water Resources
 Received
 APR 30 2018
 SCANNED
 KS Dept Of Agriculture

9. Will pesticide, fertilizer, or other foreign substance be injected into the water pumped from the diversion works?
 Yes No If "yes", a check valve shall be required.

All chemigation safety requirements must be met including a chemigation permit and reporting requirements.

10. If you are planning to impound water, please contact the Division of Water Resources for assistance, prior to submitting the application. Please attach a reservoir area capacity table and inform us of the total acres of surface drainage area above the reservoir. 952 Acres Drainage

Have you also made an application for a permit for construction of this dam and reservoir with the Division of Water Resources? Yes No

- If yes, show the Water Structures permit number here Applied for Low Hazard
- If no, explain here why a Water Structures permit is not required _____

11. The application must be supplemented by a U.S.G.S. topographic map, aerial photograph or a detailed plat showing the following information. On the topographic map, aerial photograph, or plat, identify the center of the section, the section lines or the section corners and show the appropriate section, township and range numbers. Also, please show the following information:

(a) The location of the proposed point(s) of diversion (wells, stream-bank installations, dams, or other diversion works) should be plotted as described in Paragraph No. 5 of the application, showing the North-South distance and the East-West distance from a section line or southeast corner of section.

(b) If the application is for groundwater, please show the location of any existing water wells of any kind within 1/2 mile of the proposed well or wells. Identify each existing well as to its use and furnish the name and mailing address of the property owner or owners. If there are no wells within 1/2 mile, please advise us.

(c) If the application is for surface water, the names and addresses of the landowner(s) 1/2 mile downstream and 1/2 mile upstream from your property lines must be shown.

(d) The location of the proposed place of use should be shown by crosshatching on the topographic map, aerial photograph or plat.

(e) Show the location of the pipelines, canals, reservoirs or other facilities for conveying water from the point of diversion to the place of use.

A 7.5 minute U.S.G.S. topographic map may be obtained by providing the section, township and range numbers to: Kansas Geological Survey, 1930 Constant, Campus West, University of Kansas, Lawrence, Kansas 66047.

12. List any application, appropriation of water, water right, or vested right file number that covers the same diversion points or any of the same place of use described in this application. Also list any other recent modifications made to existing permits or water rights in conjunction with the filing of this application.

None

Water Resources
Received

APR 30 2018

SCANNED

KS Dept Of Agriculture

MA

Furnish the following well information if the proposed appropriation is for the use of groundwater. If the well has not been completed, give information obtained from test holes, if available.

Information below is from: Test holes Well as completed Drillers log attached

Well location as shown in paragraph No.	(A)	(B)	(C)	(D)
Date Drilled	_____	_____	_____	_____
Total depth of well	_____	_____	_____	_____
Depth to water bearing formation	_____	_____	_____	_____
Depth to static water level	_____	_____	_____	_____
Depth to bottom of pump intake pipe	_____	_____	_____	_____

14. The relationship of the applicant to the proposed place where the water will be used is that of

owner/tenant
(owner, tenant, agent or otherwise)

15. The owner(s) of the property where the water is used, if other than the applicant, is (please print):

same?

Brett Loyd 11552 Madoff Rd Greenville, In 47124
(name, address and telephone number)

(name, address and telephone number)

16. The undersigned states that the information set forth above is true to the best of his/her knowledge and that this application is submitted in good faith.

Dated at Hawatha, Kansas, this 27 day of April, 2018.
(month) (year)

[Signature]
(Applicant Signature)

By _____
(Agent or Officer Signature)

(Agent or Officer - Please Print)

Assisted by Keith Gamm MWI, LLC Date: 4/18/18
(office/title)

**IRRIGATION USE
SUPPLEMENTAL SHEET**

File No. 50050

Name of Applicant (Please Print): Shawn i Robin Loyd

1. Please supply the name and address of each landowner, the legal description of the lands to be irrigated, and designate the actual number of acres to be irrigated in each forty acre tract or fractional portion thereof:

Landowner of Record NAME: Shawn i Robin Loyd
ADDRESS: 2252 Linden Rd Hiawatha KS 66434

S	T	R	NE¼				NW¼				SW¼				SE¼				TOTAL
			NE	NW	SW	SE	NE	NW	SW	SE	NE	NW	SW	SE	NE	NW	SW	SE	
14	3s	16E	40	40	40	40	40	40	40					40	40	40	40	440	

516
Total

Landowner of Record NAME: Brett Loyd
ADDRESS: 11552 Macbriff Rd Greenville, Ar 47124

S	T	R	NE¼				NW¼				SW¼				SE¼				TOTAL
			NE	NW	SW	SE	NE	NW	SW	SE	NE	NW	SW	SE	NE	NW	SW	SE	
14	3s	16E								40			36					76	

Landowner of Record NAME: _____
ADDRESS: _____

S	T	R	NE¼				NW¼				SW¼				SE¼				TOTAL
			NE	NW	SW	SE	NE	NW	SW	SE	NE	NW	SW	SE	NE	NW	SW	SE	

SCANNED

KS Dept. Of Agriculture

APR 30 2018

Received

Water Resources

Horned Owl Rd

1991

©2016 Google

Jackrabbit Rd

1901 S

Google Earth

Imagery Date: 4/1/2016 Lat: 39.790892° Lon: -95.588497° elev: 1163 ft eye alt: 9074 ft

2091st

1901st

50050

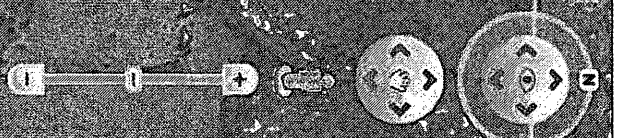

TOPOGRAPHIC SURVEY
 Compute Proposed Stream Obstruction Volume in the North One-Half
 of Section 14, Township 3 South, Range 16 East of the
 Sixth Principal Meridian, Brown County, Kansas

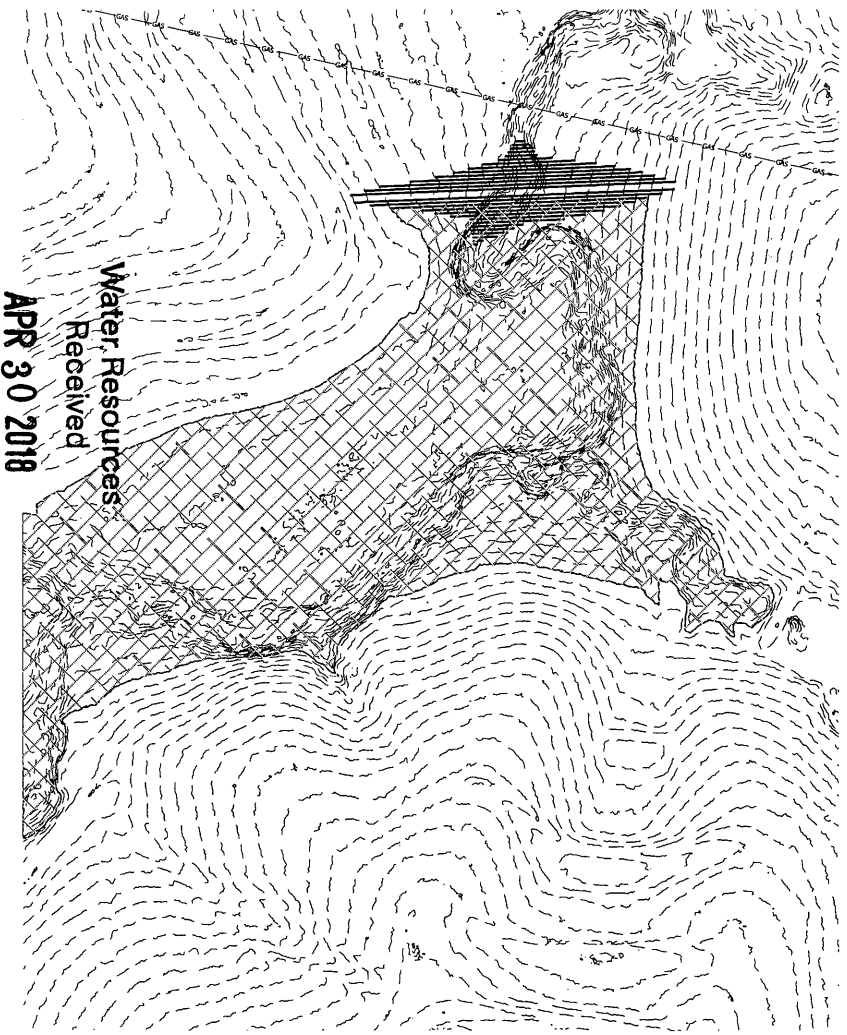

Contour	Area	1' Volume	Total Volume	Ac. Ft.	Embankment	Height
1089	-	-	-	-	-	-
1090	560.68	280.34	280.340	0.0064		1.28
1091	2,305.74	1,433.21	1,713.550	0.0393		2.28
1092	6,455.03	4,380.39	6,093.935	0.1399		3.28
1093	8,263.27	7,359.15	13,453.085	0.3088		4.28
1094	21,589.33	14,926.30	28,379.385	0.6515		5.28
1095	28,504.71	25,047.02	53,426.405	1.2265		6.28
1096	35,230.17	31,867.44	85,293.845	1.9581		7.28
1097	42,148.72	38,689.45	123,983.290	2.8463		8.28
1098	49,897.80	46,023.26	170,006.550	3.9028		9.28
1099	59,845.54	54,871.67	224,878.220	5.1625		10.28
1100	73,261.29	66,553.42	291,431.635	6.6903		11.28
1101	87,366.03	80,313.66	371,745.295	8.5341		12.28
1102	107,078.40	97,222.22	468,967.510	10.7660		13.28
1103	136,258.97	121,668.69	590,636.195	13.5591		14.28
1104	174,064.23	155,161.60	745,797.795	17.1212		15.28
1105	211,171.69	192,617.96	938,415.755	21.5431		16.28
1106	254,556.50	232,864.10	1,171,279.850	26.8889		17.28
1107	300,443.37	277,499.94	1,448,779.785	33.2594		18.28
1108	356,759.23	328,601.30	1,777,381.085	40.8031		19.28
1109	434,846.66	395,802.95	2,173,184.030	49.8894		20.28
1110	521,333.53	478,090.10	2,651,274.125	60.8649		21.28
1111	597,630.40	559,481.97	3,210,756.090	73.7088		22.28
1112	675,206.87	636,418.64	3,847,174.725	88.3190		23.28
1113	754,672.29	714,939.58	4,562,114.305	104.7317		24.28
1114	828,540.92	791,606.61	5,353,720.910	122.9045	7,378	25.28
1115	927,471.90	878,006.41	6,231,727.320	143.0608	8,436	26.28
1116	1,020,628.48	974,050.19	7,205,777.510	165.4219	9,604	27.28
1117	1,116,475.96	1,068,552.22	8,274,329.730	189.9525	10,923	28.28

22' →
 55' ←
 92' ←

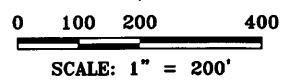
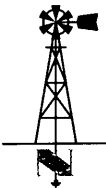

General Notes for Site:
 No field verification of LIDAR performed.
 Front toe of obstruction: 1089.74'
 Rear toe of obstruction: 1088.72'
 Assumed top of obstruction width: 12'
 Assumed front and back slope: 3:1

LAND SURVEYOR'S CERTIFICATE
 THIS IS TO CERTIFY THAT THIS SURVEY
 WAS DONE BY THE UNDERSIGNED, AND
 THAT THE SURVEY WAS DONE ON THE
 GROUND ON _____



THIS DRAWING ORIGINALLY CREATED AT
 SPECIFIED SCALE. IF LINE BELOW DOES NOT
 MEASURE 1 INCH, DRAWING HAS BEEN
 REDUCED.
 ORIGINAL DRAWING
 SIZE: 1 INCH

JORGENSEN SURVEYING
 73051 617 Ave
 Tecumseh, NE 68450
 (402) 335-2033
 jorgensensurveying@gmail.com

Stream Obstruction
 N 1/2 Sec 14, T3S, R16E
 Brown County, Kansas
 PREPARED FOR
 MWI - Shawn Loyd

SCALE 1"=200'
 FIELD ON: -
 CHK. BY MARCY
 DWN. BY BRENT
 DATE: 04/09/18
 SHEET 1 OF 2
 JOB NO. 5262.88

KS Dept Of Agriculture

SCANNED

5000

STATE OF KANSAS



DEPARTMENT OF AGRICULTURE
DIVISION OF WATER RESOURCES
TOPEKA FIELD OFFICE
6531 SE FORBES AVE., SUITE B
TOPEKA, KS 66619

PHONE: (785) 296-5733
FAX: (785) 296-8298
www.agriculture.ks.gov

GOVERNOR JEFF COLYER, M.D.
JACKIE McCLASKEY, SECRETARY OF AGRICULTURE

May 16, 2018

CURT H & AMANDA K JACOBSEN
1948 HORNED OWL RD
HIAWATHA KS 66434

Re: Pending Application, File No. 50,050

Dear Sir or Madam:

This is to advise you that Shawn & Robin Loyd have filed the application referred to above for a permit to appropriate 516 acre-feet of surface water per calendar year to be stored in a proposed reservoir, and re-divert 516 acre-feet of the stored water for irrigation use. The proposed point of diversion (where the dam crosses the centerline of the stream) is located in the Southwest Quarter of the Northwest Quarter of the Northeast Quarter (SW $\frac{1}{4}$ NW $\frac{1}{4}$ NE $\frac{1}{4}$) of Section 14, Township 3 South, Range 16 East, Brown County, Kansas.

Records in this office indicate that you own land along the stream in this vicinity and you are being notified of receipt of this application in order that you may be fully informed of the proposed location of the applicant's point of diversion and proposed use of water. Consideration will be given to comments or other information which you desire to submit to this office **within 15 days** from the date of this letter.

You can find the application and site map posted by the file number referenced above at:
<http://agriculture.ks.gov/divisions-programs/dwr/water-appropriation/notices>

If you have any questions or comments, you may also contact me at (785) 296-3495. If you call, please reference the file number so I can help you more efficiently.

Sincerely,

Douglas W. Schemm
Environmental Scientist
Topeka Field Office

pc: Shawn & Robin Loyd
Keith Grimm – MWI, LLC

STATE OF KANSAS



DEPARTMENT OF AGRICULTURE
DIVISION OF WATER RESOURCES
TOPEKA FIELD OFFICE
6531 SE FORBES AVE., SUITE B
TOPEKA, KS 66619

PHONE: (785) 296-5733
FAX: (785) 296-8298
www.agriculture.ks.gov

GOVERNOR JEFF COLYER, M.D.
JACKIE McCLASKEY, SECRETARY OF AGRICULTURE

May 16, 2018

OWEN L JACOBSEN TRUST
1911 HORNED OWL ROAD
HIAWATHA KS 66434

Re: Pending Application, File No. 50,050

Dear Sir or Madam:

This is to advise you that Shawn & Robin Loyd have filed the application referred to above for a permit to appropriate 516 acre-feet of surface water per calendar year to be stored in a proposed reservoir, and re-divert 516 acre-feet of the stored water for irrigation use. The proposed point of diversion (where the dam crosses the centerline of the stream) is located in the Southwest Quarter of the Northwest Quarter of the Northeast Quarter (SW $\frac{1}{4}$ NW $\frac{1}{4}$ NE $\frac{1}{4}$) of Section 14, Township 3 South, Range 16 East, Brown County, Kansas.

Records in this office indicate that you own land along the stream in this vicinity and you are being notified of receipt of this application in order that you may be fully informed of the proposed location of the applicant's point of diversion and proposed use of water. Consideration will be given to comments or other information which you desire to submit to this office **within 15 days** from the date of this letter.

You can find the application and site map posted by the file number referenced above at:
<http://agriculture.ks.gov/divisions-programs/dwr/water-appropriation/notices>

If you have any questions or comments, you may also contact me at (785) 296-3495. If you call, please reference the file number so I can help you more efficiently.

Sincerely,

Douglas W. Schemm
Environmental Scientist
Topeka Field Office

pc: Shawn & Robin Loyd
Keith Grimm – MWI, LLC

STATE OF KANSAS

DEPARTMENT OF AGRICULTURE
DIVISION OF WATER RESOURCES
TOPEKA FIELD OFFICE
6531 SE FORBES AVE., SUITE B
TOPEKA, KS 66619



PHONE: (785) 296-5733
FAX: (785) 296-8298
www.agriculture.ks.gov

GOVERNOR JEFF COLYER, M.D.
JACKIE McCLASKEY, SECRETARY OF AGRICULTURE

May 16, 2018

ROBERT K GEORGESON IRREVOCABLE TRUST
2145 VERMONT STREET
LAWRENCE KS 66044

Re: Pending Application, File No. 50,050

Dear Sir or Madam:

This is to advise you that Shawn & Robin Loyd have filed the application referred to above for a permit to appropriate 516 acre-feet of surface water per calendar year to be stored in a proposed reservoir, and re-divert 516 acre-feet of the stored water for irrigation use. The proposed point of diversion (where the dam crosses the centerline of the stream) is located in the Southwest Quarter of the Northwest Quarter of the Northeast Quarter (SW $\frac{1}{4}$ NW $\frac{1}{4}$ NE $\frac{1}{4}$) of Section 14, Township 3 South, Range 16 East, Brown County, Kansas.

Records in this office indicate that you own land along the stream in this vicinity and you are being notified of receipt of this application in order that you may be fully informed of the proposed location of the applicant's point of diversion and proposed use of water. Consideration will be given to comments or other information which you desire to submit to this office **within 15 days** from the date of this letter.

You can find the application and site map posted by the file number referenced above at:
<http://agriculture.ks.gov/divisions-programs/dwr/water-appropriation/notices>

If you have any questions or comments, you may also contact me at (785) 296-3495. If you call, please reference the file number so I can help you more efficiently.

Sincerely,

Douglas W. Schemm
Environmental Scientist
Topeka Field Office

pc: Shawn & Robin Loyd
Keith Grimm – MWI, LLC

STATE OF KANSAS



DEPARTMENT OF AGRICULTURE
DIVISION OF WATER RESOURCES
TOPEKA FIELD OFFICE
6531 SE FORBES AVE., SUITE B
TOPEKA, KS 66619

PHONE: (785) 296-5733
FAX: (785) 296-8298
www.agriculture.ks.gov

GOVERNOR JEFF COLYER, M.D.
JACKIE McCLASKEY, SECRETARY OF AGRICULTURE

May 16, 2018

STEVEN R MCCREREY
1128 190TH STREET
HIAWATHA KS 66434

Re: Pending Application, File No. 50,050

Dear Sir or Madam:

This is to advise you that Shawn & Robin Loyd have filed the application referred to above for a permit to appropriate 516 acre-feet of surface water per calendar year to be stored in a proposed reservoir, and re-divert 516 acre-feet of the stored water for irrigation use. The proposed point of diversion (where the dam crosses the centerline of the stream) is located in the Southwest Quarter of the Northwest Quarter of the Northeast Quarter (SW $\frac{1}{4}$ NW $\frac{1}{4}$ NE $\frac{1}{4}$) of Section 14, Township 3 South, Range 16 East, Brown County, Kansas.

Records in this office indicate that you own land along the stream in this vicinity and you are being notified of receipt of this application in order that you may be fully informed of the proposed location of the applicant's point of diversion and proposed use of water. Consideration will be given to comments or other information which you desire to submit to this office **within 15 days** from the date of this letter.

You can find the application and site map posted by the file number referenced above at:
<http://agriculture.ks.gov/divisions-programs/dwr/water-appropriation/notices>

If you have any questions or comments, you may also contact me at (785) 296-3495. If you call, please reference the file number so I can help you more efficiently.

Sincerely,

Douglas W. Schemm
Environmental Scientist
Topeka Field Office

pc: Shawn & Robin Loyd
Keith Grimm – MWI, LLC

STATE OF KANSAS



DEPARTMENT OF AGRICULTURE
DIVISION OF WATER RESOURCES
TOPEKA FIELD OFFICE
6531 SE FORBES AVE., SUITE B
TOPEKA, KS 66619

PHONE: (785) 296-5733
FAX: (785) 296-8298
www.agriculture.ks.gov

GOVERNOR JEFF COLYER, M.D.
JACKIE McCLASKEY, SECRETARY OF AGRICULTURE

May 16, 2018

JACOBSEN FARMS LLC
1804 HORNED OWL ROAD
HIAWATHA KS 66434

Re: Pending Application, File No. 50,050

Dear Sir or Madam:

This is to advise you that Shawn & Robin Loyd have filed the application referred to above for a permit to appropriate 516 acre-feet of surface water per calendar year to be stored in a proposed reservoir, and re-divert 516 acre-feet of the stored water for irrigation use. The proposed point of diversion (where the dam crosses the centerline of the stream) is located in the Southwest Quarter of the Northwest Quarter of the Northeast Quarter (SW $\frac{1}{4}$ NW $\frac{1}{4}$ NE $\frac{1}{4}$) of Section 14, Township 3 South, Range 16 East, Brown County, Kansas.

Records in this office indicate that you own land along the stream in this vicinity and you are being notified of receipt of this application in order that you may be fully informed of the proposed location of the applicant's point of diversion and proposed use of water. Consideration will be given to comments or other information which you desire to submit to this office **within 15 days** from the date of this letter.

You can find the application and site map posted by the file number referenced above at:
<http://agriculture.ks.gov/divisions-programs/dwr/water-appropriation/notices>

If you have any questions or comments, you may also contact me at (785) 296-3495. If you call, please reference the file number so I can help you more efficiently.

Sincerely,

Douglas W. Schemm
Environmental Scientist
Topeka Field Office

pc: Shawn & Robin Loyd
Keith Grimm – MWI, LLC

STATE OF KANSAS



DEPARTMENT OF AGRICULTURE
DIVISION OF WATER RESOURCES
TOPEKA FIELD OFFICE
6531 SE FORBES AVE., SUITE B
TOPEKA, KS 66619

PHONE: (785) 296-5733
FAX: (785) 296-8298
www.agriculture.ks.gov

GOVERNOR JEFF COLYER, M.D.
JACKIE McCLASKEY, SECRETARY OF AGRICULTURE

May 16, 2018

GREGORY & SUSAN GARTRELL TRUST
415 6 ROAD
STOCKTON KS 67669

Re: Pending Application, File No. 50,050

Dear Sir or Madam:

This is to advise you that Shawn & Robin Loyd have filed the application referred to above for a permit to appropriate 516 acre-feet of surface water per calendar year to be stored in a proposed reservoir, and re-divert 516 acre-feet of the stored water for irrigation use. The proposed point of diversion (where the dam crosses the centerline of the stream) is located in the Southwest Quarter of the Northwest Quarter of the Northeast Quarter (SW $\frac{1}{4}$ NW $\frac{1}{4}$ NE $\frac{1}{4}$) of Section 14, Township 3 South, Range 16 East, Brown County, Kansas.

Records in this office indicate that you own land along the stream in this vicinity and you are being notified of receipt of this application in order that you may be fully informed of the proposed location of the applicant's point of diversion and proposed use of water. Consideration will be given to comments or other information which you desire to submit to this office **within 15 days** from the date of this letter.

You can find the application and site map posted by the file number referenced above at:
<http://agriculture.ks.gov/divisions-programs/dwr/water-appropriation/notices>

If you have any questions or comments, you may also contact me at (785) 296-3495. If you call, please reference the file number so I can help you more efficiently.

Sincerely,

Douglas W. Schemm
Environmental Scientist
Topeka Field Office

pc: Shawn & Robin Loyd
Keith Grimm – MWI, LLC

STATE OF KANSAS

DEPARTMENT OF AGRICULTURE
DIVISION OF WATER RESOURCES
TOPEKA FIELD OFFICE
6531 SE FORBES AVE., SUITE B
TOPEKA, KS 66619



PHONE: (785) 296-5733
FAX: (785) 296-8298
www.agriculture.ks.gov

GOVERNOR JEFF COLYER, M.D.
JACKIE McCLASKEY, SECRETARY OF AGRICULTURE

May 16, 2018

DWIGHT C & SUE E MEYER
1780 HORNED OWL ROAD
HIAWATHA KS 66434

Re: Pending Application, File No. 50,050

Dear Sir or Madam:

This is to advise you that Shawn & Robin Loyd have filed the application referred to above for a permit to appropriate 516 acre-feet of surface water per calendar year to be stored in a proposed reservoir, and re-divert 516 acre-feet of the stored water for irrigation use. The proposed point of diversion (where the dam crosses the centerline of the stream) is located in the Southwest Quarter of the Northwest Quarter of the Northeast Quarter (SW $\frac{1}{4}$ NW $\frac{1}{4}$ NE $\frac{1}{4}$) of Section 14, Township 3 South, Range 16 East, Brown County, Kansas.

Records in this office indicate that you own land along the stream in this vicinity and you are being notified of receipt of this application in order that you may be fully informed of the proposed location of the applicant's point of diversion and proposed use of water. Consideration will be given to comments or other information which you desire to submit to this office **within 15 days** from the date of this letter.

You can find the application and site map posted by the file number referenced above at:
<http://agriculture.ks.gov/divisions-programs/dwr/water-appropriation/notices>

If you have any questions or comments, you may also contact me at (785) 296-3495. If you call, please reference the file number so I can help you more efficiently.

Sincerely,

Douglas W. Schemm
Environmental Scientist
Topeka Field Office

pc: Shawn & Robin Loyd
Keith Grimm – MWI, LLC

STATE OF KANSAS



DEPARTMENT OF AGRICULTURE
DIVISION OF WATER RESOURCES
TOPEKA FIELD OFFICE
6531 SE FORBES AVE., SUITE B
TOPEKA, KS 66619

PHONE: (785) 296-5733
FAX: (785) 296-8298
www.agriculture.ks.gov

GOVERNOR JEFF COLYER, M.D.
JACKIE McCLASKEY, SECRETARY OF AGRICULTURE

May 16, 2018

JAMES SIEBENMORGEN
2240 PLUM TREE ROAD
ROBINSON KS 66532

Re: Pending Application, File No. 50,050

Dear Sir or Madam:

This is to advise you that Shawn & Robin Loyd have filed the application referred to above for a permit to appropriate 516 acre-feet of surface water per calendar year to be stored in a proposed reservoir, and re-divert 516 acre-feet of the stored water for irrigation use. The proposed point of diversion (where the dam crosses the centerline of the stream) is located in the Southwest Quarter of the Northwest Quarter of the Northeast Quarter (SW $\frac{1}{4}$ NW $\frac{1}{4}$ NE $\frac{1}{4}$) of Section 14, Township 3 South, Range 16 East, Brown County, Kansas.

Records in this office indicate that you own land along the stream in this vicinity and you are being notified of receipt of this application in order that you may be fully informed of the proposed location of the applicant's point of diversion and proposed use of water. Consideration will be given to comments or other information which you desire to submit to this office **within 15 days** from the date of this letter.

You can find the application and site map posted by the file number referenced above at:
<http://agriculture.ks.gov/divisions-programs/dwr/water-appropriation/notices>

If you have any questions or comments, you may also contact me at (785) 296-3495. If you call, please reference the file number so I can help you more efficiently.

Sincerely,

Douglas W. Schemm
Environmental Scientist
Topeka Field Office

pc: Shawn & Robin Loyd
Keith Grimm – MWI, LLC

AMOUNT STATISTICS REPORT FOR POINTS OF DIVERSION UNDER A

50050 00

#####

AMOUNT STATISTICS REPORT FOR POINTS OF DIVERSION UNDER A

50050 00 IRR

Water Right and Points of Diversion Within 2.00 miles of point defined as:

4476 Feet North and 2510 Feet West of the Southeast Corner of Section 14 T 3S R 16E

SURFACE WATER ONLY

=====

File Number	Use	ST	SR	Dist (ft)	Q4	Q3	Q2	Q1	FeetN	FeetW	Sec	Twp	Rng	ID	Batt	Auth_Quan	Add_Quan	Unit	
A__	50050	00	IRR	AY	S	0	--	SW	NW	NE	4476	2510	14	3	16E	2	516.00	516.00	AF

=====

Total Net Quantities Authorized:	Direct	Storage
Total Requested Amount (AF) =	516.00	.00
Total Permitted Amount (AF) =	.00	.00
Total Inspected Amount (AF) =	.00	.00
Total Pro_Cert Amount (AF) =	.00	.00
Total Certified Amount (AF) =	.00	.00
Total Vested Amount (AF) =	.00	.00
TOTAL AMOUNT (AF) =	516.00	.00

An * after the source of supply indicates a pending application for change under the file number.
 An * after the ID indicates a 15 AF exemption was granted under the file number.
 A "G" in the Batt column indicates the GEO CTR of a battery. A "B" indicates a well in the battery.
 The number in the Batt column is the number of wells in the battery.

Water Rights and Points of Diversion Within 2.00 miles of point defined as:

4476 Feet North and 2510 Feet West of the Southeast Corner of Section 14 T 3S R 16E

SURFACE WATER ONLY

WATER USE CORRESPONDENTS:

=====

File Number Use ST SR

A__ 50050 00 IRR AY S

> SHAWN & ROBIN LOYD

>

> 2252 LINDEN RD

> HIAWATHA KS 66434

>-----

=====

#####

DEPARTMENT OF AGRICULTURE
1320 RESEARCH PARK DRIVE
MANHATTAN, KS 66502
PHONE: (785) 564-6700
FAX: (785) 564-6777

STATE OF KANSAS



900 SW JACKSON, ROOM 456
TOPEKA, KS 66612
PHONE: (785) 296-3556
www.agriculture.ks.gov

GOVERNOR JEFF COLYER, M.D.
JACKIE McCLASKEY, SECRETARY OF AGRICULTURE

May 4, 2018

Shawn Loyd
2252 Linden Rd
Hiawatha, KS 66434

RE: Low Hazard Dam Exemption

WSN: DBR-0363/LBR-0030

Legal Location: SW ¼ of the NW ¼ of the NE ¼ of Section 14, Township 3S, Range 16E

Hazard Classification: Low

Dear Mr. Loyd:

This letter is confirmation that the information submitted by you to the Division of Water Resources qualifies your proposed dam for exemption from the dam safety permit requirements specified in K.S.A. 82a-301(a).

You indicated that the proposed structure will have a height of 28.3 feet and an emergency spillway storage volume of less than 125 acre-feet. This, combined with your assertion that it will meet hazard class "A" standards, satisfies the requirements for the hazard class A permit exemption described in K.S.A. 82a-301(d)(1).

This exemption does **not** absolve the owner from compliance with other local, state, or federal requirements that may apply.

Please submit a floodplain fill application as per K.S.A 24-126. A permit must be issued prior to construction. If you have questions, contact Janelle Phillips at (785) 564-6656.

Additionally, a water appropriations permit will be required. For further information contact Doug Schemm at (785) 296-3495.

Finally, please note that your dam could be reclassified to a hazard class B or C in the future as a result of changes to downstream properties and/or other factors. **If this occurs, you will be required to obtain a permit in adherence to all aspects of K.S.A. 82a-301 through 82a-328.** This could also involve redesign and/or reconstruction to meet state statutes and regulations.

Should you have any other questions, please feel free to call me at (785) 564-6653, or e-mail me at ambrose.ketter@ks.gov.

Sincerely,

A handwritten signature in cursive script that reads "Ambrose J. Ketter".

Ambrose J. Ketter, P.E.
Water Structures Engineer

PC: Doug Schemm
Janelle Phillips



#50,050

Application for Permit

K.S.A. 82a-301-305a Dams, Stream Obstructions and Channel Changes
K.S.A. 24-126 Levees and Floodplain Fills

Use this form to apply for a Division of Water Resources permit to construct or modify a dam, stream obstruction, channel change, levee or floodplain fill. Refer to K.A.R. 5-40 through 5-46 for requirements and definitions.

Send the completed application, worksheet (if applicable), required fees and plans and other materials listed in K.A.R. 5-40-1 through 5-43-5 or K.A.R. 5-45-1 through 5-45-18 to:

Kansas Department of Agriculture
Division of Water Resources – Water Structures
1320 Research Park Drive
Manhattan, KS 66502

Land Owner Information			
Owner Name: Shawn Loyd			
Mailing Address: 2252 Linden Rd			
City/State: Hiawatha, KS		Zip Code: 66434	
Telephone: 785-742-3125		Email:	
Is the project or activity located entirely on property owned by the permit applicant? <input checked="" type="checkbox"/> Yes <input type="checkbox"/> No If no, attach a document listing the names and mailing addresses for all landowners located within the project.			
Applicant Information (if different than owner)			
Applicant Name: same		Title:	
Mailing Address:			
City/State:		Zip Code:	
Telephone:		Email:	
Designer Information			
Firm/Agency: MWI, LLC			
Contact Name: Keith		Title: Owner	
Mailing Address: 1215 Oregon St			
City/State: Hiawatha, KS		Zip Code: 66434	
Telephone: 785-547-7556		Email: keith@mwivalley.com	
Project Location and Description			
County: Brown		Stream Name: unnamed Tributary to Wolf River	
Legal: SW Qtr of the NW Qtr of the NE Qtr		Section: 14	Township(S): 3S Range(E/W): 16E
Project or site name: Loyd Home Place Irrigation Pond			
Project description and purpose: Water storage pond for Irrigation purposes			
KS DEPT OF AGRICULTURE			
Drainage area above the project: 521		acres	square miles
Area of disturbance (trees and/or vegetation) 1		acres	square miles

WATER RESOURCES
RECEIVED
JUN 04 2018

For office use only	WSN: LBR-0030	ECA: 2018173
Code FLP	Fee \$ 300-	TR#
	Rcpt Date 6-4-18	Check # 1082

Schedule		
Planned or actual start date (start of construction, clearing, excavation or fill)	August 1st 2018	
Planned or actual completion date (end of construction, stabilization of site)	Dec 1st - 2018	
Construction, excavation and fill will be halted and the Kansas State Historical Society will be contacted when historical sites or artifacts are encountered.	<input checked="" type="checkbox"/> Yes <input type="checkbox"/> No	
Project Activities and Fee Determination		
Project Activity (check all that apply)	Permit Fee	
<input type="checkbox"/> Construct, modify or repair a dam	\$200	
<input type="checkbox"/> Construct, modify or repair a stream obstruction		
<input type="checkbox"/> Construct or repair a channel change		
<input type="checkbox"/> Excavate or dredge within the banklines of a stream		
Drainage area \leq 5 square miles <input type="checkbox"/>	\$100	
Drainage area between 5 and 50 square miles <input type="checkbox"/>	\$200	
Drainage area \geq 50 square miles <input type="checkbox"/>	\$500	
	Pre-construction	Post-construction
<input type="checkbox"/> Construct, modify or repair a class A levee (see K.A.R. 5-45-8 for definition)	\$100	\$200
<input type="checkbox"/> Construct, modify or repair a class B levee	\$300	\$600
<input type="checkbox"/> Construct, modify or repair a class C levee	\$500	\$1,000
<input type="checkbox"/> Place fill in a mapped floodway fringe (Zone AE with defined floodway)	\$100	\$200
<input checked="" type="checkbox"/> Place fill in a mapped floodplain with no defined floodway (Zone A, AH, AO)	\$300	\$600
<input type="checkbox"/> Place fill in an unmapped floodplain (see K.A.R. 5-45-1)	\$300	\$600
<input type="checkbox"/> Place fill in a mapped floodway (Zone AE floodway)	\$500	\$1,000
<input type="checkbox"/> This project qualifies for a General Permit (attach worksheet DWR 2-190) (pipeline/cable crossing, or bridge/culvert replacement)	\$100	
The total permit fee required will be the general permit fee if applicable, OR the highest individual fee for the project activities checked above. Make checks payable to Kansas Department of Agriculture	300 Amount enclosed:	
Signature		
Application is hereby made for written consent or permit of the Chief Engineer, Division of Water Resources, for the project described above. By signing below, I certify that the information contained in this application is true, correct and complete, and that I am the owner or I am authorized by the owner to make this application for permit.		
Signature: 	Name (print or type): Keith Grimm	
	Date: 6/1/18	

WATER RESOURCES
RECEIVED

JUN 04 2018

STATE OF KANSAS

DEPARTMENT OF AGRICULTURE
1320 RESEARCH PARK DRIVE
MANHATTAN, KS 66502
PHONE: (785) 564-6700
FAX: (785) 564-6777



900 SW JACKSON, ROOM 456
TOPEKA, KS 66612
PHONE: (785) 296-3556
www.agriculture.ks.gov

GOVERNOR JEFF COLYER, M.D.
JACKIE McCLASKEY, SECRETARY OF AGRICULTURE

May 1, 2018

SHAWN & ROBIN LOYD
2252 LINDEN RD
HIAWATHA KS 66434

RE: Application
File No. 50050

Dear Sir or Madam:

Your application for permit to appropriate water in 14-3S-16E in Brown County, was received and has been assigned the file number noted above.

As a matter of record, the Division of Water Resources has on hand a large number of applications awaiting processing. Therefore to be fair to all concerned, and so that we can process those applications on hand in the order they were received, we intend to concentrate on the backlog of applications until the issue is resolved. Once review of your application has begun, we will contact you, if additional information is required.

In accordance with the provisions of the Kansas Water Appropriation Act, a portion of which is included below, the use of water as proposed prior to approval of the application is unlawful. Once approved, compliance with the terms, conditions and limitations of the permit is necessary. Conservation of the water resources of Kansas is required.

Section 82a-728 of the Kansas Water Appropriation Act, provides (a) except for the appropriation of water for the purpose of domestic use, . . . it shall be unlawful for any person to appropriate or threaten to appropriate water from any source without first applying for and obtaining a permit to appropriate water in accordance with the provisions of the Water Appropriation Act or for any person to violate any condition of a vested right, appropriation right or an approved application for a permit to appropriate water for beneficial use.

(b) (1) The violation of any provision of this section by any person is a class C misdemeanor . . .

A class C misdemeanor is punishable by a fine not to exceed \$500 and/or a term of confinement not to exceed one month in the county jail. Each day that the violation occurs constitutes a separate offense.

If you have any questions, please contact me at (785) 564-6637. If you wish to discuss a specific file, please have the file number ready so that we may help you more efficiently.

Sincerely,

Kristen A. Baum
New Applications Unit Supervisor
Water Appropriation Program

BAT: dlw
pc: TOPEKA Field Office
GMD

SCANNED

50050

Shawn Loyd Permit Sheet

952 acres Drainage

516 acres on permit

½ mile up stream and downstream landowners

JACOBSEN, CURT H. & AMANDA K.:
1948 HORNED OWL RD HIAWATHA, KS 66434

JACOBSEN, OWEN L. TRUST
1911 HORNED OWL RD HIAWATHA, KS 66434

GEORGESON, ROBERT K. IRREVOCABLE TRUST
2145 VERMONT ST LAWRENCE, KS 66044

MCCREREY, STEVEN R.
1128 190TH ST HIAWATHA, KS 66434

JACOBSEN FARMS, LLC
1804 HORNED OWL RD HIAWATHA, KS 66434

GARTRELL, GREGORY & SUSAN TRUST
415 6 RD STOCKTON, KS 67669

MEYER, DWIGHT C. & SUE E.
1780 HORNED OWL RD HIAWATHA, KS 66434

SIEBENMORGEN, JAMES
2240 PLUM TREE RD ROBINSON, KS 66532

Water Resources
Received

APR 30 2018

KS Dept Of Agriculture

SCANNED

SCANNED

KS Dept Of Agriculture

Water Resources
Received
APR 30 2018

TOPOGRAPHIC SURVEY
Compute Proposed Stream Obstruction Volume in the North One-Half
of Section 14, Township 3 South, Range 16 East of the
Sixth Principal Meridian, Brown County, Kansas



Water Level at Elev: 1113.25'

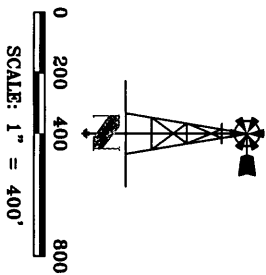

SCALE 1" = 400' FIELD NO.: CHK. BY: MANCY DRAWN BY: BRENT DATE: 04/09/18 SHEET 2 OF 2 JOB NO. 5262.88	Stream Obstruction N 1/2 Sec 14, T3S, R16E Brown County, Kansas	JORGENSEN SURVEYING 73051 617 Ave Tecumseh, NE 68450 (402) 335-2033 jorgensensurveying@gmail.com	THIS DRAWING ORIGINALLY CREATED AT SPECIFIED SCALE. IF LINE BELOW DOES NOT MEASURE 1 INCH, DRAWING HAS BEEN REDUCED. ORIGINAL DRAWING SIZE: 1 INCH
	PREPARED FOR MWI - Shawn Loyd		

5262.88

SCANNED

KS Dept Of Agriculture

APR 30 2018

Water Resources
Received

1991

Homed Owl Rd

S14 T3S R16E

4476 ft North

2510 ft west

Jack Rabbit Rd

© 2018 Google

Imagery Date: 4/1/2016 Lat: 39.789557 Lon: -95.5907019 elev: 1070 ft eye alt: 10761 ft

Google Earth
Earth Point

50050



50050

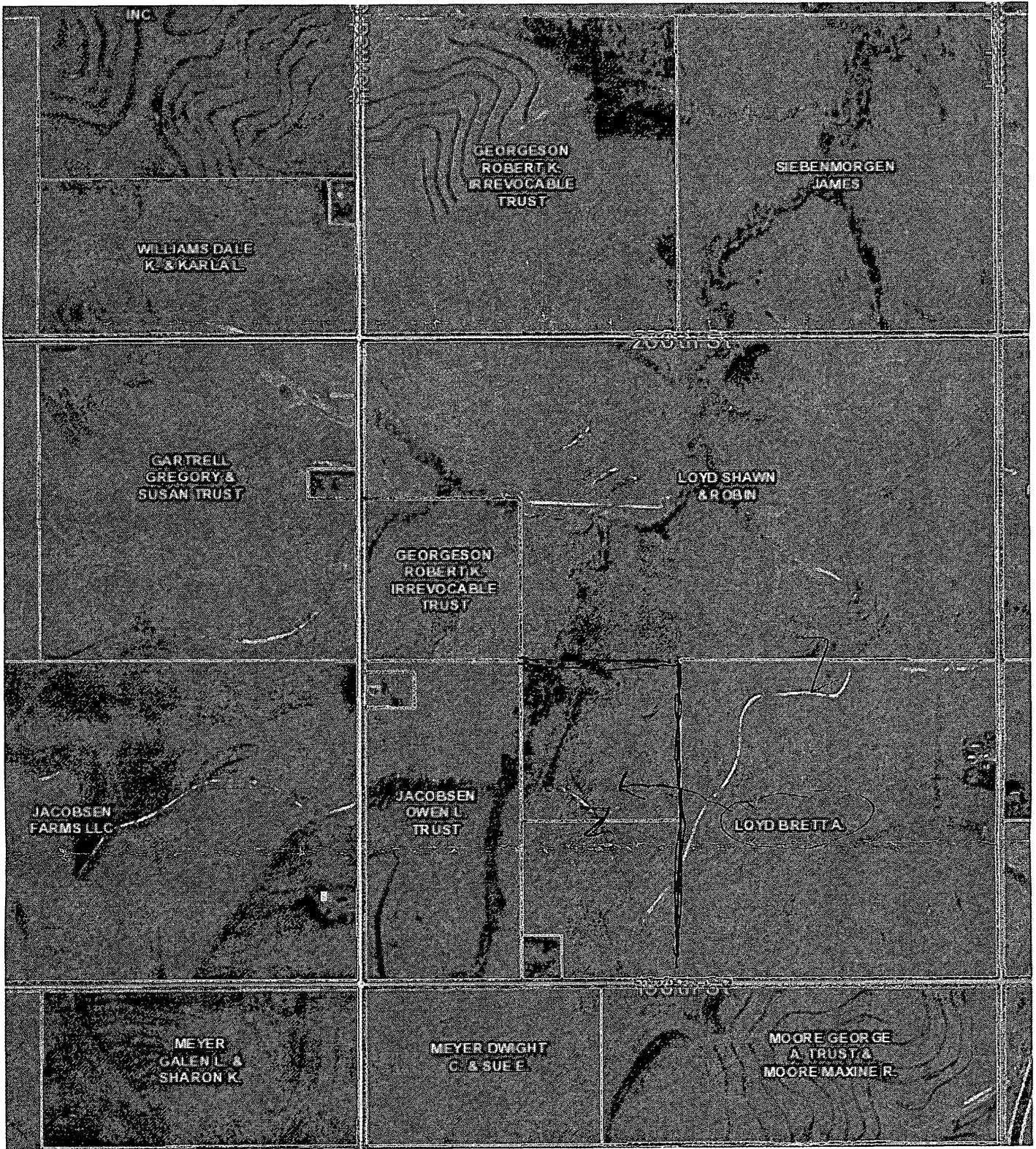

Water Resources
Received

APR 30 2018

KS Dept Of Agriculture

SCANNED

NEW STREAM WORKSHEET

ES ajw

Date: 5/7/18

File No. 50,050

Basin Name: MISSOURI RIVER Basin No. 1

Stream Name: WOLF RIVER TRIB 8 (MISSOURI)

Stream location (confluence with parent stream):

Section 1, Township 3 South, Range 16 (East)

Map Color Coding:

Basin Stream – Blue

Named Main Stream off Basin Stream – Yellow

Named Stream off Main Stream – Green

Unnamed Trib (1, 2, 3, 4, etc.) – Pink

Unnamed Trib to Unnamed Trib (A, B, C, etc.) – Orange

Unnamed Trib to Unnamed Trib to Unnamed Trib (1, 2, 3, etc.) – Purple

Stream No. 3942 (computer assigned - entered by data entry staff)

Date Entered 5/15/2018 By UM