

NOTICE

This scan only represents the application as filed. The information contained herein meets the requirements of K.A.R. 5-3-1 or K.A.R. 5-5-1, and has been found acceptable for filing in the office of the Chief Engineer. The application should not be considered to be a complete application as per K.A.R. 5-3-1b or K.A.R. 5-5-2a.

THE STATE OF KANSAS



KANSAS DEPARTMENT OF AGRICULTURE
Jackie McClaskey, Secretary of Agriculture

DIVISION OF WATER RESOURCES
David W. Barfield, Chief Engineer

Water Resources
Received

File Number 50055

This item to be completed by the Division of Water Resources.

MAY 14 2018
12:46

APPLICATION FOR PERMIT TO APPROPRIATE WATER FOR BENEFICIAL USE

KS Dept Of Agriculture

Filing Fee Must Accompany the Application
(Please refer to Fee Schedule attached to this application form.)

To the Chief Engineer of the Division of Water Resources, Kansas Department of Agriculture,
1320 Research Park Drive, Manhattan, KS 66502:

1. Name of Applicant (Please Print): TIFFANY CATTLE CO. INC.
Address: 1333 S 2500 RD
City: HERINGTON State: KS Zip Code 67499
Telephone Number: (785) 229-2902 shawn@tiffanycattle.com

2. The source of water is: surface water in _____ (stream)
OR groundwater in NEOSHO RIVER (drainage basin)

Certain streams in Kansas have minimum target flows established by law or may be subject to administration when water is released from storage for use by water assurance district members. If your application is subject to these regulations on the date we receive your application, you will be sent the appropriate form to complete and return to the Division of Water Resources.

3. The maximum quantity of water desired is 319.24 acre-feet OR 104.025 Million gallons per calendar year,
to be diverted at a maximum rate of 1000 gallons per minute OR _____ cubic feet per second.

Once your application has been assigned a priority, the requested maximum rate of diversion and maximum requested quantity of water under that priority number can **NOT** be increased. Please be certain your requested maximum rate of diversion and maximum quantity of water are appropriate and reasonable for your proposed project and are in agreement with the Division of Water Resources' requirements.

4. The water is intended to be appropriated for (Check use intended):
(a) Artificial Recharge (b) Irrigation (c) Recreational (d) Water Power
(e) Industrial (f) Municipal (g) Stockwatering (h) Sediment Control
(i) Domestic (j) Dewatering (k) Hydraulic Dredging (l) Fire Protection
(m) Thermal Exchange (n) Contamination Remediation

YOU **MUST** COMPLETE AND ATTACH ADDITIONAL DIVISION OF WATER RESOURCES FORM(S) PROVIDING INFORMATION TO SUBSTANTIATE YOUR REQUEST FOR THE AMOUNT OF WATER FOR THE INTENDED USE REFERENCED ABOVE.

For Office Use Only:										
1. O. <input type="checkbox"/>	GMD <input type="checkbox"/>	<input checked="" type="checkbox"/> Meets K.A.R. 5-3-1	(YES/NO)	Use <u>STL</u>	Source <u>GYS</u>	County <u>MR</u>	By <u>AWW</u>	Date <u>5/14/17</u>		
Code	<u>REC</u>	<u>REA</u>	Fee \$ <u>300</u>	TR #	Receipt Date <u>5/14/18</u>	Check # <u>43708</u>				

5. The location of the proposed wells, pump sites or other works for diversion of water is:

Note: For the application to be accepted, the point of diversion location must be described to at least a 10 acre tract, unless you specifically request a 60 day period of time in which to locate the site within a specifically described, minimal legal quarter section of land.

- (A) One in the SW quarter of the SE quarter of the NE quarter of Section 5, more particularly described as being near a point 2,677 feet North and 1,084 feet West of the Southeast corner of said section, in Township 16 South, Range 6 EAST, MORRIS County, Kansas.
- (B) One in the _____ quarter of the _____ quarter of the _____ quarter of Section _____, more particularly described as being near a point _____ feet North and _____ feet West of the Southeast corner of said section, in Township _____ South, Range _____ East/West (circle one), _____ County, Kansas.
- (C) One in the _____ quarter of the _____ quarter of the _____ quarter of Section _____, more particularly described as being near a point _____ feet North and _____ feet West of the Southeast corner of said section, in Township _____ South, Range _____ East/West (circle one), _____ County, Kansas.
- (D) One in the _____ quarter of the _____ quarter of the _____ quarter of Section _____, more particularly described as being near a point _____ feet North and _____ feet West of the Southeast corner of said section, in Township _____ South, Range _____ East/West (circle one), _____ County, Kansas.

If the source of supply is groundwater, a separate application shall be filed for each proposed well or battery of wells, except that a single application may include up to four wells within a circle with a quarter (1/4) mile radius in the same local source of supply which do not exceed a maximum diversion rate of 20 gallons per minute per well.

A battery of wells is defined as two or more wells connected to a common pump by a manifold; or not more than four wells in the same local source of supply within a 300 foot radius circle which are being operated by pumps not to exceed a total maximum diversion rate of 800 gallons per minute and which supply water to a common distribution system.

6. The owner of the point of diversion, if other than the applicant is (please print):

Shawn Tiffany 1333 S. 2500 Rd Herington, KS 67449
(name, address and telephone number)

You must provide evidence of legal access to, or control of, the point of diversion from the landowner or the landowner's authorized representative. Provide a copy of a recorded deed, lease, easement or other document with this application. In lieu thereof, you may sign the following sworn statement:

I have legal access to, or control of, the point of diversion described in this application from the landowner or the landowner's authorized representative. I declare under penalty of perjury that the foregoing is true and correct.

Executed on 10 May, 2018, Shawn M Tiffany
Applicant's Signature

7. The proposed project for diversion of water will consist of ONE WELL
(number of wells, pumps or dams, etc.)
and (was)(will be) completed (by) SUMMER 2018
(Month/Day/Year - each was or will be completed)

8. The first actual application of water for the proposed beneficial use was or is estimated to be Summer 2018
(Mo/Day/Year)

Water Resources
Received
MAY 14 2018
KS Dept Of Agriculture

9. Will pesticide, fertilizer, or other foreign substance be injected into the water pumped from the diversion works?

Yes No If "yes", a check valve shall be required.

All chemigation safety requirements must be met including a chemigation permit and reporting requirements.

10. If you are planning to impound water, please contact the Division of Water Resources for assistance, prior to submitting the application. Please attach a reservoir area capacity table and inform us of the total acres of surface drainage area above the reservoir.

Have you also made an application for a permit for construction of this dam and reservoir with the Division of Water Resources? Yes No

• If yes, show the Water Structures permit number here _____

• If no, explain here why a Water Structures permit is not required _____

GROUNDWATER WELL

11. The application must be supplemented by a U.S.G.S. topographic map, aerial photograph or a detailed plat showing the following information. On the topographic map, aerial photograph, or plat, identify the center of the section, the section lines or the section corners and show the appropriate section, township and range numbers. Also, please show the following information:

(a) The location of the proposed point(s) of diversion (wells, stream-bank installations, dams, or other diversion works) should be plotted as described in Paragraph No. 5 of the application, showing the North-South distance and the East-West distance from a section line or southeast corner of section.

(b) If the application is for surface water, the names and addresses of the landowner(s) ½ mile downstream and ½ mile upstream from your property lines must be shown.

(c) The location of the proposed place of use should be shown by crosshatching on the topographic map, aerial photograph or plat.

(d) Show the location of the pipelines, canals, reservoirs or other facilities for conveying water from the point of diversion to the place of use.

A 7.5 minute U.S.G.S. topographic map may be obtained by providing the section, township and range numbers to: Kansas Geological Survey, 1930 Constant, Campus West, University of Kansas, Lawrence, Kansas 66047.

12. List any application, appropriation of water, water right, or vested right file number that covers the same diversion points or any of the same place of use described in this application. Also list any other recent modifications made to existing permits or water rights in conjunction with the filing of this application.

FILE NOS. 38,788; 39,838; and 40,903 overlap in PU

Water Resources
Received

MAY 14 2018

KS Dept Of Agriculture

13. Furnish the following well information if the proposed appropriation is for the use of groundwater. If the well has not been completed, give information obtained from test holes, if available.

Information below is from: Test holes Well as completed Drillers log attached

Well location as shown in paragraph No.	(A)	(B)	(C)	(D)
Date Drilled	_____	_____	_____	_____
Total depth of well	_____	_____	_____	_____
Depth to water bearing formation	_____	_____	_____	_____
Depth to static water level	_____	_____	_____	_____
Depth to bottom of pump intake pipe	_____	_____	_____	_____

14. The relationship of the applicant to the proposed place where the water will be used is that of OWNER
(owner, tenant, agent or otherwise)

15. The owner(s) of the property where the water is used, if other than the applicant, is (please print):

(name, address and telephone number)

(name, address and telephone number)

16. The undersigned states that the information set forth above is true to the best of his/her knowledge and that this application is submitted in good faith.

Dated at Herington, Kansas, this 10 day of May, 2018.
(month) (year)

Tiffany Family Farms by:

Shawn M. [Signature]
(Applicant Signature)

45-2683697

APPLICANT(S) SOCIAL SECURITY IDENTIFICATION NUMBER(S)

By _____
(Agent or Officer Signature)

and/or
APPLICANT(S) TAXPAYER I.D. NO.(S)

(Agent or Officer - Please Print)

Assisted by DWS TOPEKA FO Date: 5/9/2018
(office/title)

Water Resources
Received

MAY 14 2018

KS Dept Of Agriculture

10 May 18
(Date)

Kansas Department of Agriculture
Division of Water Resources
David W. Barfield, Chief Engineer
1320 Research Park Drive
Manhattan, Kansas 66502

Re: Application
File No. 50055

Minimum Desirable Streamflow

Dear Sir:

I understand that a Minimum Desirable Streamflow requirement has been established by the legislature for the source of supply to which the above referenced application applies.

I understand that diversion of water pursuant to this application will be subject to regulation any time Minimum Desirable Streamflow requirements are not being met.

I also understand that if this application is approved, there could be times, as determined by the Division of Water Resources, when I would not be allowed to divert water. I realize that this could affect the economics of my decision to appropriate water.

I am aware of the above factors, and with the knowledge thereof, request that the Division of Water Resources proceed with processing and approval, if possible, of the above referenced application.

Shawn M Tiffany
Signature of Applicant

State of Kansas)
County of Morris) ss

Shawn M Tiffany
(Print Applicant's Name)

I hereby certify that the foregoing instrument was signed in my presence and sworn to before me this 10th day of May, 2018.

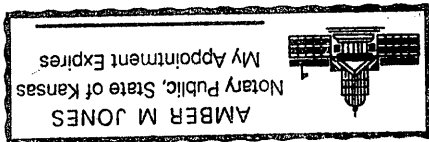

Amber Jones
Notary Public

My Commission Expires: 06/09/2021

Water Resources
Received

MAY 14 2018

**MINIMUM DESIRABLE STREAMFLOW FORM TO BE USED WHEN
APPLICABLE WHEN FILING AN APPLICATION FOR PERMIT
TO APPROPRIATE WATER FOR BENEFICIAL USE**

The Kansas Legislature has established minimum desirable streamflows for the streams listed below. If your proposed diversion of water is going to be from one of these watercourses or adjacent alluvial aquifers, please complete the back side of this page and submit it along with your application for permit to appropriate water.

Arkansas River
Big Blue River
Chapman Creek
Chikaskia River
Cottonwood River
Delaware River
Little Arkansas River
Little Blue River
Marais des Cygnes River
Medicine Lodge River
Mill Creek (Wabaunsee Co. area)
Neosho River

Ninnescah River
North Fork Ninnescah River
Rattlesnake Creek
Republican River
Saline River
Smoky Hill River
Solomon River
South Fork Ninnescah
Spring River
Walnut River
Whitewater River

**Water Resources
Received**

MAY 14 2018

KS Dept Of Agriculture

**STOCKWATER USE
SUPPLEMENTAL SHEET**

File No. 50055

Name of Applicant (Please Print): TIFFANY CATTLE CO. INC.

1. Please indicate type of livestock (cattle, hogs, etc.): CATTLE

2. Please complete the following table showing past and present water requirements:

PAST NUMBER OF HEAD AND WATER DIVERTED, IF APPLICABLE

LAST 5 YEARS	NUMBER OF HEAD	WATER DIVERTED (GALLONS)	GALLONS PER HEAD PER DAY
5 years ago			
Last year	15000	40,907,400	7.47
Present Year			

3. Please complete the following table showing estimated future water requirements:

ESTIMATED FUTURE NUMBER OF HEAD AND WATER DIVERTED

NEXT 5 YEARS	NUMBER OF HEAD	WATER TO BE DIVERTED (GALLONS)	GALLONS PER HEAD PER DAY
Year 1	19,000	104.025 Million gals	15
Year 2			
Year 3			
Year 4			
Year 5	19,000	104.025 Million gals	15

Please attach any additional information, tables, or curves showing past, present and estimated future water requirements to substantiate the amount of water requested.

4. Please designate the legal description of the location where the water is to be used. Show in the space provided below the Section (S), Township (T), and Range (R), and the number of acres in each forty acre tract or fractional portion thereof.

S	T	R	NE¼				NW¼				SW¼				SE¼				TOTAL
			NE	NW	SW	SE	NE	NW	SW	SE	NE	NW	SW	SE	NE	NW	SW	SE	
			FEEDLOT IN THE EAST HALF OF SEC. 31, THE SW QTR OF SEC. 32, BOTH IN T15S, AND THE NW QTR OF SEC. 5, T16S, ALL IN R6E. MORRIS CO.																

Water Resources
Received

MAY 14 2018

KS Dept Of Agriculture

- 5. Show quantities of water used and all associated water uses at the feedlot such as water used in feed mills, cooling of animals, washing, flushing of wastes, etc.:

DRINKING

19,000 head of Cattle x 15 gallons/head (avg.) x 365 days = 104.025 Million gallons

_____ head of _____ x _____ gallons/head (avg.) x _____ days = _____ gallons

_____ head of _____ x _____ gallons/head (avg.) x _____ days = _____ gallons

COOLING

0 gallons/hour x _____ hour/day x _____ days = _____ gallons

SANITATION

0 g.p.m. x 60 min/hr x _____ hr/wk x _____ wks/yr = _____ gallons

OTHER USE (Explain) _____ = _____ gallons

TOTAL ----- 104.025 M gallons

- 6. Show location of present and future location of confinement pens on your attached maps or photographs.

7. Total feed bunk space for cattle or livestock is 20,000 linear feet.

8. Total size of stock pens for confinement area of cattle, hogs, etc. is _____ square feet.

You may attach any additional information you believe will assist in informing the Division of Water Resources of the need for your request.

Water Resources
Received

MAY 14 2018

TIFFANY CATTLE CO. INC. - SITE MAP NEW APPLICATION

50055

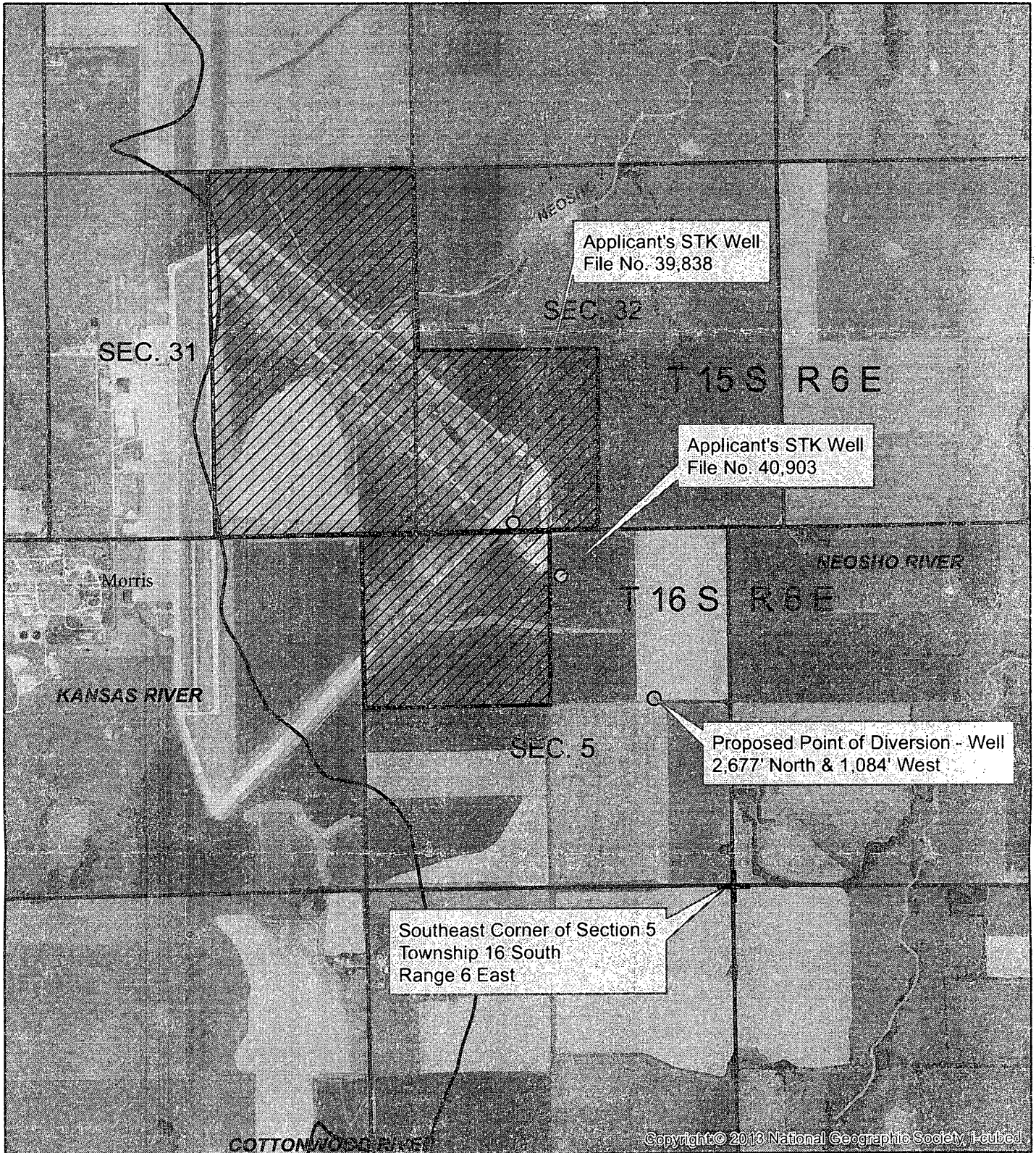

1:24,000

- Proposed Point of Diversion
- ▨ Proposed Place of Use

All Known Wells Within 1/2 mile of the proposed point of diversion are located on this map.

Water Resources Received
MAY 14 2013

Shawn M. Jeff

KS Dept Of Agriculture



Shawn Tiffany <shawnmtiffany@gmail.com>

New STK application

1 message

Schemm, Doug [KDA] <Doug.Schemm@ks.gov>

Wed, May 9, 2018 at 3:32 PM

To: "Shawn@tiffanycattle.com" <Shawn@tiffanycattle.com>

Cc: "Tietsort, Katie [KDA]" <Katie.Tietsort@ks.gov>, "Letourneau, Lane [KDA]" <Lane.Letourneau@ks.gov>

Shawn, as we discussed earlier today, your existing wells are barely able to supply enough water for your feedlot needs, and the dry weather ahead is only going to exacerbate the problem. You have identified an existing well that you can pump water from and run a pipeline to the feedlot. Due to your immediate need for additional water, it is obvious that going through the standard permitting process would not be timely enough to help with your urgent needs of the feedlot because of the time it takes to process an application.

Under these conditions this office contacted Lane Letourneau, Program Manager of the Division of Water Resources, to discuss your particular situation. Mr. Letourneau indicated that he had no objections to granting permission to pump from your existing well prior to issuing the permit under the following conditions:

#1) An application has been prepared and is attached to this e-mail. You **must sign the application at Paragraph Nos. 6 and 16**. For the requested quantity of 319.24 acre-feet, the filing fee would be **\$300**. In addition, please sign the site map and have the enclosed Minimum Desirable Streamflow form signed and notarized. Please submit the application and filing fee to the **Kansas Department of Agriculture, Division of Water Resources, 1320 Research Park Drive, Manhattan, KS 66502**, as soon as possible.

#2) That this permission to pump is limited to providing water for the feedlot only.

If you have questions about this information please give me a call at (785) 296-3495.

Doug Schemm

4 attachments

Tiffany Cattle Company.pdf
1205K

SUPPLEMENTAL SHEET STOCK.DOCX
25K

MDS Form.docx
19K

App GW STK use.docx
66K

**Water Resources
Received**

MAY 14 2018

KS Dept Of Agriculture

STATE OF KANSAS



DEPARTMENT OF AGRICULTURE
1320 RESEARCH PARK DRIVE
MANHATTAN, KS 66502
PHONE: (785) 564-6700
FAX: (785) 564-6777

900 SW JACKSON, ROOM 456
TOPEKA, KS 66612
PHONE: (785) 296-3556
www.agriculture.ks.gov

GOVERNOR JEFF COLYER, M.D.
JACKIE MCCLASKEY, SECRETARY OF AGRICULTURE

May 16, 2018

TIFFANY CATTLE CO, INC
1333 S 2500 RD
HERINTON KS 67499

RE: Application
File No. 50055

Dear Sir or Madam:

Your application for permit to appropriate water in 5-16S-6E in Morris County, was received and has been assigned the file number noted above.

As a matter of record, the Division of Water Resources has on hand a large number of applications awaiting processing. Therefore to be fair to all concerned, and so that we can process those applications on hand in the order they were received, we intend to concentrate on the backlog of applications until the issue is resolved. Once review of your application has begun, we will contact you, if additional information is required.

In accordance with the provisions of the Kansas Water Appropriation Act, a portion of which is included below, the use of water as proposed prior to approval of the application is unlawful. Once approved, compliance with the terms, conditions and limitations of the permit is necessary. Conservation of the water resources of Kansas is required.

Section 82a-728 of the Kansas Water Appropriation Act, provides (a) except for the appropriation of water for the purpose of domestic use, . . . it shall be unlawful for any person to appropriate or threaten to appropriate water from any source without first applying for and obtaining a permit to appropriate water in accordance with the provisions of the Water Appropriation Act or for any person to violate any condition of a vested right, appropriation right or an approved application for a permit to appropriate water for beneficial use.

(b) (1) The violation of any provision of this section by any person is a class C misdemeanor . . .

A class C misdemeanor is punishable by a fine not to exceed \$500 and/or a term of confinement not to exceed one month in the county jail. Each day that the violation occurs constitutes a separate offense.

If you have any questions, please contact me at (785) 564-6637. If you wish to discuss a specific file, please have the file number ready so that we may help you more efficiently.

Sincerely,

Kristen A. Baum
New Applications Unit Supervisor
Water Appropriation Program

BAT: dlw
pc: TOPEKA Field Office
GMD