

Kansas Department of Agriculture
Division of Water Resources
CHANGE: P/D WORKSHEET & Ownership update

| | | | | |
|--|--|---|------------------------------|--|
| 1. File Number: 47155 | 2. Status Change Date: 3/13/2019 | 3. Change Num: C1 | 4. Field Office: 1 | 5. GMD: |
| 6. Status: <input checked="" type="checkbox"/> Approved <input type="checkbox"/> Denied by DWR/GMD <input type="checkbox"/> Dismiss by Request/Failure to Return | | | | 7. Filing Date of Change: 4/6/18 |
| 8a. Applicant(s) _____ Person ID <u>32951</u> New to system <input type="checkbox"/> Add Seq# _____ TRACY BRUNNER 1611 100 AVE PO BOX 103 RAMONA KS 67475 | | 8c. Landowner(s) _____ Person ID <u>32951</u> New to system <input type="checkbox"/> Add Seq# _____ TRACY & DELORES Y BRUNNER 1611 100 AVE PO BOX 103 RAMONA KS 67475 <i>Name Chg</i> | | |
| 8b. Landowner(s) _____ Person ID <u>66642</u> New to system <input checked="" type="checkbox"/> Add Seq# <u>1</u> LAUREN & ANNA ORVELL BRUNNER TRUST KENT BRUNNER TRUSTEE 1611 100 AVE <i>3559 Upland Rd</i> PO BOX 103 RAMONA KS 67475 <i>Lost Springs 66859</i> | | 8d. WUC _____ Person ID <u>32951</u> New to system <input type="checkbox"/> Add Seq# _____ 8A | | |
| 9. Documents and Enclosure(s): <input checked="" type="checkbox"/> DWR Meter(s) Date to Comply: <u>12/31/2019</u> <input checked="" type="checkbox"/> N & P Date to Comply: <u>12/31/2019</u> | | | | |
| <input type="checkbox"/> Anti-Reverse Meter <input type="checkbox"/> Meter Seal <input checked="" type="checkbox"/> Check Valve <input checked="" type="checkbox"/> N & P Form <input type="checkbox"/> Water Tube <input checked="" type="checkbox"/> Driller Copy <input type="checkbox"/> H & E Letter <input type="checkbox"/> Conservation Plan Date Required: _____ Date Approved: _____ Date to Comply: _____ | | | | |
| 10. Use Made of Water From: _____ To: _____ | | | | |
| Date Prepared: 12/18/2018 By: LI Date Entered: 3/13/2019 By: LLM | | | | |

File No. **47155** 11. County: DK Basin: **SMOKEY HILL RIVER** Stream: **NA** Formation Code: **540** Special Use:

| 12. Points of Diversion | | | | | | | | | | Rate and Quantity | | | | | | |
|-------------------------|--------------|----------|------|-----------|----|----|---|------|-------------------------------|-------------------|--------------------|------------|--------------|---------------|----------|------------------|
| CHK | MOD | DEL | PDIV | Qualifier | S | T | R | ID | 'N | 'W | Comment (AKA Line) | Authorized | | Additional | | Overlap PD Files |
| ENT | | | | | | | | | | | | Rate gpm | Quantity mgy | Rate gpm | Quantity | |
| CHK | 75971 | NW NE SE | | 34 | 16 | 3E | 7 | 1995 | 1176 | | | 35 | 17 | 68 | 17 | NONE |
| ENT | <u>87372</u> | NE NE SE | | 34 | 16 | 3E | | 1995 | 1600 <u>150</u> | | | 0 | 0 | <u>35</u> | 0 | NONE |

SHOW AS BLANKET QUANTITY AND RATE

13. Storage: Rate _____ NF Quantity _____ ac/ft Additional Rate _____ NF Additional Quantity _____ ac/ft

14. Limitation: _____ af/yr at **20** gpm (**0.04** cfs) when combined with file number(s) **PER WELL**
 Limitation: _____ af/yr at **35** gpm (**0.08** cfs) when combined with file number(s) **WHEN WELLS OPERATE SIMUANEOUSLY**

15. 5YR Allocation: Allocation Type _____ Start Year _____ 5 YR Amount _____ Amount Unit _____ Base Acres _____ Comment _____

| 16. Place of Use | CHK | MOD | DEL | ENT | PUSE | NE¼ | | | | NW¼ | | | | SW¼ | | | | SE¼ | | | | Total | Owner | Chg? | Overlap Files | |
|------------------|-------|-----|-----|-----|------|-----|---|---|----|------|------|------|------|------|------|------|------|------|------|------|------|-------|-------|------|---------------|----------------------------------|
| | | | | | | S | T | R | ID | NE ¼ | NW ¼ | SW ¼ | SE ¼ | NE ¼ | NW ¼ | SW ¼ | SE ¼ | NE ¼ | NW ¼ | SW ¼ | SE ¼ | | | | | NE ¼ |
| MOD | 12602 | 34 | 16 | 3E | 1 | | | | | | | | | | | | | | | | | | | | | 8B & 8C YES 39749, 39943 & 45019 |
| | | | | | | | | | | | | | | | | | | | | | | | | | | |
| | | | | | | | | | | | | | | | | | | | | | | | | | | |
| | | | | | | | | | | | | | | | | | | | | | | | | | | |
| | | | | | | | | | | | | | | | | | | | | | | | | | | |

Base Acres: Year: Minimum Reasonable Quantity:

Comments: **OWNERSHIP UPDATE PER DK PROPERTY RECORDS**

KANSAS DEPARTMENT OF AGRICULTURE
Division of Water Resources

MEMORANDUM

TO: Files

DATE: March 12, 2019

FROM: Brent Turney

RE: Appropriation of Water
File No. 47,155

Tracy and Delores Y. Brunner, along with Kent Brunner on behalf of the Lauren W. Brunner Trust and Anna Orvell Brunner Trust, have submitted an application for approval to change the authorized point of diversion. The application as received on August 30, 2018, proposes a change in point of diversion to add another well as per K.A.R. 5-3-4(d)(1) which allows four (4) wells completed in a quarter ($\frac{1}{4}$) mile radius that are in the same local source of supply at a rate not to exceed 20 gallons per minute per well.

A two (2) mile review of the area found the referenced file to be the most junior appropriation with 2,019.56 acre-feet still available for appropriation. The application to add the second well should be allowed as the owners could file a new application to permit the two proposed wells. The change will be processed with the criteria of Part (d)(1) K.A.R. 5-3-4.

The referenced file is authorized 17 million gallons (16.5 acre-feet) at a rate of 35 gallons per minute from one (1) well for stockwatering use. This place of use is also served by Water Right, File Nos. 39,749; 39,943 & 45,019, which provide a limited 5.824 million gallons (17.9 acre-feet) per year.

The source of supply of the authorized point of diversion has been determined to be Chase Group formation (540). The proposed well will appropriate water from the same local source of supply.

The applicant indicated only one domestic well and three stockwatering wells located within one-half ($\frac{1}{2}$) mile of the proposed additional well. The domestic well owner was notified by letter of the proposed change. No comment was received.

As the rate of diversion is required to not exceed 20 gallons per minute per well as detailed in Part (d)(1) of K.A.R. 5-3-4, the rate will be limited not to exceed 20 gallons per minute when the wells operate independently and 35 gallons per minute when they operate simultaneously. A signed acknowledgement of the additional limitations was completed by Tracy Brunner and received in the Office of the Chief Engineer on January 25, 2019.

Katie Tietsort, Water Commissioner of the Topeka Field Office indicated by note dated March 5, 2019, with the submission of the additional conditions agreement signed by Tracy Brunner, February 23, 2019 and received in this office on March 8, 2019, she requested we proceed with the approval of the change as proposed.

The approval will require the installation of a water flowmeter and a check valve if chemigating. A water level measurement tube will not be required. A WWC-5 will be required by the approval with the notice of completion.

Based on the above discussion that impairment to existing water rights is unlikely and that no change in the source of supply will occur, therefore, it is recommended that the referenced application be approved.

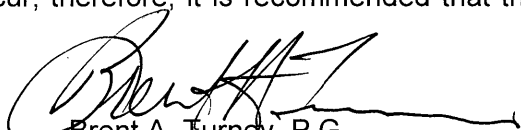
Brent A. Turney, P.G.
Change Application Unit Supervisor

1320 Research Park Drive
Manhattan, KS 66502
785-564-6700
www. agriculture.ks.gov



900 SW Jackson, Room 456
Topeka, KS 66612
785-296-3556

Mike Beam, Acting Secretary

Laura Kelly, Governor

FILE COPY

TRACY BRUNNER
1611 100 AVE
PO BOX 103
RAMONA KS 67475

March 20, 2019

RE: Appropriation of Water, File No. 47,155

Dear Mr. Brunner:

Enclosed is the order executed by the Chief Engineer, Division of Water Resources, Kansas Department of Agriculture, approving the application for change under the above referenced file.

Your attention is directed to the enclosures and to the terms, conditions, and the additional limitations on the rate of diversion specified in the approval for change. Specifically, the rate of diversion has been limited to require the wells operate at a maximum diversion rate not in excess of 35 gallons per minute (0.08 c.f.s.) when they operate together, and when they operate independently they shall not exceed 20 gallons per minute (0.04 c.f.s.). A condition of the approval is that an acceptable water flowmeter(s) must be installed on each of the diversion works authorized. A well log is a condition of the approval. Please return the required notification of completion of the diversion works, the installation of the meter, and well log (WWC-5) as soon as these actions are completed.

Please be reminded that reports of water usage must be submitted to this office annually. Records indicating the amount of water used should be furnished to the Chief Engineer by March 1 following the end of the previous calendar year so that the continued use of water becomes a matter of record in this office. The owner, or his or her legally designated agent, is held responsible for submitting annual water use reports. If an annual water use report is not received by the deadline, a fine may be assessed and all water use under such right may be suspended. Water use reports may now be filed online at www.kswaterusereport.org.

If you have any questions, please contact Katie Tietsort, Water Commissioner, Topeka Field Office at (785) 296-5733. If you wish to discuss a specific file, please have the file number ready so that we may help you more efficiently.

Sincerely,

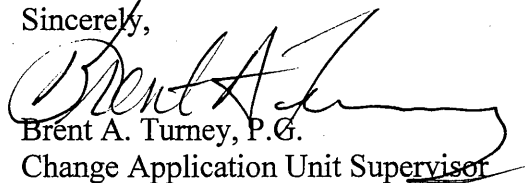

Brent A. Turney, P.G.
Change Application Unit Supervisor

BAT:LI:li
Enclosures

pc: Topeka Field Office
Kent Brunner

THE STATE OF KANSAS



KANSAS DEPARTMENT OF AGRICULTURE
Mike Beam, Acting Secretary of Agriculture

DIVISION OF WATER RESOURCES
David W. Barfield, Chief Engineer

APPROVAL OF APPLICATION FOR CHANGE IN POINT OF DIVERSION APPROPRIATION OF WATER FILE NO. 47,155

The Chief Engineer, Division of Water Resources, Kansas Department of Agriculture, after due consideration of the written application of Tracy and Delores Y. Brunner, 1611 100 Avenue, PO Box 103, Ramona, Kansas 67475, and Kent Brunner on behalf of Lauren W. Brunner Trust and Anna Orvell Brunner Trust, 3559 Upland Road, Lost Springs, Kansas, 66859, received in this office on August 30, 2018, for approval of a change in the location of the point of diversion under the Approval of Application, File No. 47,155, for permit to appropriate water for beneficial use, finds that the change is reasonable and will not impair existing rights, that the change relates to the same local source of supply and that the application should be and is hereby approved.

This order effectively adds an additional limitation on the maximum rate of diversion as set forth by the Approval of Application, File No. 47,155, to read as follows:

This appropriation right is further limited to a diversion rate which when the wells operate simultaneously will provide a maximum diversion rate not in excess of 35 gallons per minute (0.08 c.f.s.) and when they operate independently they shall not exceed 20 gallons per minute (0.04 c.f.s.) for stockwatering use from the points of diversion described herein.

The effective date of the change shall be the date this order is executed by the Chief Engineer, after which the authorized location of the points of diversion shall be:

one (1) well located in the Northwest Quarter of the Northeast Quarter of the Southeast Quarter (NW $\frac{1}{4}$ NE $\frac{1}{4}$ SE $\frac{1}{4}$) of Section 34, more particularly described as being near a point 1,995 feet North and 1,176 feet West of the Southeast corner of said section, and

one (1) well located in the Northeast Quarter of the Northeast Quarter of the Southeast Quarter (NE $\frac{1}{4}$ NE $\frac{1}{4}$ SE $\frac{1}{4}$) of Section 34, more particularly described as being near a point 1,995 feet North and 150 feet West of the Southeast corner of said section,

all in Township 16 South, Range 3 East, Dickinson County, Kansas,

located substantially as shown on the topographic map accompanying the application to change the point of diversion.

The water right owner shall submit to the Chief Engineer a copy of the well log required by the Kansas Department of Health and Environment under the authority of K.S.A. 82a-1212, currently form WWC-5, within 30 days following the drilling of the well at the location authorized herein.

RIGHT TO A HEARING AND TO ADMINISTRATIVE REVIEW

If you are aggrieved by this Order, then pursuant to K.S.A. 82a-1901, you may:

- 1) request an evidentiary hearing before the Chief Engineer, or
- 2) request administrative review by the Secretary of Agriculture.

Failure to request an evidentiary hearing before the Chief Engineer does not preclude your right to administrative review by the Secretary.

To obtain an evidentiary hearing before the Chief Engineer, a written request for hearing must be filed within 15 days after service of this Order as provided in K.S.A. 77-531 (i.e., **within a total of 18 days after this Order was mailed to you**), with: Kansas Department of Agriculture, Attn: Legal Section, 1320 Research Park Drive, Manhattan, KS 66502, FAX (785) 564-6777.

If you do not file a request for an evidentiary hearing before the Chief Engineer, you may petition for administrative review of the Order by the Secretary of Agriculture. A petition for review shall be in writing and state the basis for requesting administrative review. The request for hearing may be denied if the request fails to clearly establish factual or legal issues for review. See K.S.A. 77-527. The petition must be filed within 30 days after service of this Order as provided in K.S.A. 77-531 (i.e., **within a total of 33 days after this Order was mailed to you**), and be filed with: Secretary of Agriculture, Attn: Legal Division, Kansas Department of Agriculture, 1320 Research Park Drive, Manhattan, KS 66502, FAX (785) 564-6777.

If neither a request for an evidentiary hearing nor a petition for administrative review is filed as set forth above, then this Order shall be effective and become a final agency action as defined in K.S.A. 77-607(b). Failure to timely request either an evidentiary hearing or administrative review may preclude further judicial review under the Kansas Judicial Review Act.

Any request for a hearing or petition for administrative review shall be in writing and shall be submitted to the attention of: Chief Legal Counsel, Kansas Department of Agriculture, 1320 Research Park Drive, Manhattan, Kansas 66502, Fax: (785) 564 - 6777.

CERTIFICATE OF SERVICE

On this 20th day of March, 2019, I hereby certify that the attached Approval of Application for the Change in Point of Diversion for Appropriation of Water, File No. 47,155, dated March 13th, 2019, was mailed postage prepaid, first class, US mail to the following:

Tracy Brunner
1611 100 Ave
PO Box 103
Ramona, KS 67475

With photocopy sent to:
Topeka Field Office

With True & Correct Copy sent to:

Kent Brunner
Lauren W. Brunner Trust
Anna Orvell Brunner Trust
3559 Upland Road
Lost Springs KS 66859

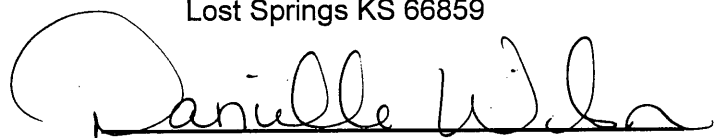
Division of Water Resources

Submit To: CHIEF ENGINEER
Division of Water Resources
Kansas Department of Agriculture
1320 Research Park Drive
Manhattan, Kansas 66502
http://agriculture.ks.gov/dwr

**APPLICATION FOR APPROVAL TO
CHANGE THE PLACE OF USE, THE
POINT OF DIVERSION OR THE USE
MADE OF THE WATER UNDER AN
EXISTING WATER RIGHT**



State of Kansas

Filing Fee Must Accompany the Application
(Please refer to Fee Schedule on signature page of application form.)

Paragraph Nos. 1, 2, 3, 4 & 8 must be completed. Complete all other applicable portions. A topographic map or detailed plat showing the authorized and proposed points(s) of diversion and /or place of use must accompany this application.

Water Resources
Received

AUG 30 2018
11:32

KS Dept Of Agriculture

1. Application is hereby made for approval of the Chief Engineer to change the

- Place of Use
- (Check one or more) Point of Diversion
- Use Made of Water

File No. 47,155

2. Name of applicant: TRACY BRUNNER

Address: 1611 100 AVE PO BOX 103

City, State and Zip: RAMONA, KS 67475

Phone Number: (785) 965-2228

E-mail address: _____

What is your relationship to the water right; owner tenant agent other? If other, please explain. _____

Name of water use correspondent: SAME AS APPLICANT

AMANDA@CEWRAAMPBEEF.COM

Address: _____

City, State and Zip: _____

Phone Number: () _____

E-mail address: _____

3. The change(s) proposed herein are desired for the following reasons (please be specific): _____

CHANGE IS TO ALLOW AN ADDITIONAL WELL TO BE INSTALLED UNDER THE REQUIREMENTS OF K.A.R. 5-3-4(d)

(1)

(Up to 4 wells in a quarter mile radius circle in same local source of supply)

The change(s) (was) (will be) completed by Summer 2018

(Date)

For Office Use Only:

F.O. 1 GMD 0 Meets K.A.R. 5-5-1 (YES) / NO Use STK Source (G) S County PL By MMW Date 8/30/18
Code CEW Fee \$ 200 TR # _____ Receipt Date 8/30/18 Check # WV

APPLICATION COMPLETE
1.25/19
Reviewer _____

SCANNED
9/5/18 DAW

6. The presently authorized point(s) of diversion (is) (are) ONE WELL
(Provide description and number of points)
7. The proposed point(s) of diversion are TWO WELLS
(Provide description and number of points)

List all presently authorized point(s) of diversion:

8. **Presently authorized point of diversion:**
 One in the NW Quarter of the NE Quarter of the SE Quarter of Section 34, Township 16 South, Range 3E, in DICKINSON County, Kansas, 1,995 feet North 1,176 feet West of Southeast corner of section. Authorized Rate 35 GPM Authorized Quantity 17 MGY.
 (DWR use only: Computer ID No. 75971 GPS _____ feet North _____ feet West)
 This point will not be changed This point will be changed as follows: SOURCE OF SUPPLY IS CHASE GP CODE #540.
Proposed point of diversion: (Complete only if change is requested)
 One in the _____ Quarter of the _____ Quarter of the _____ Quarter of Section _____, Township _____ South, Range _____ (EW), in _____ County, Kansas, _____ feet North _____ feet West of Southeast corner of section. Proposed Rate _____ Proposed Quantity _____
 This point is: Additional Well Geo.Center List other water rights that will use this point _____

9. **Presently authorized point of diversion:**
 One in the _____ Quarter of the _____ Quarter of the _____ Quarter of Section _____, Township _____ South, Range _____ (EW), in _____ County, Kansas, _____ feet North _____ feet West of Southeast corner of section. Authorized Rate _____ Authorized Quantity _____
 (DWR use only: Computer ID No. _____ GPS _____ feet North _____ feet West)
 This point will not be changed This point will be changed as follows:
Proposed point of diversion: (Complete only if change is requested)
 One in the NE Quarter of the NE Quarter of the SE Quarter of Section 34, Township 16 South, Range 3E, in DICKINSON County, Kansas, 1,995 feet North 150 feet West of Southeast corner of section. Proposed Rate _____ Proposed Quantity _____
 This point is: Additional Well Geo.Center List other water rights that will use this point _____

10. **Presently authorized point of diversion:**
 One in the _____ Quarter of the _____ Quarter of the _____ Quarter of Section _____, Township _____ South, Range _____ (EW), in _____ County, Kansas, _____ feet North _____ feet West of Southeast corner of section. Authorized Rate _____ Authorized Quantity _____
 (DWR use only: Computer ID No. _____ GPS _____ feet North _____ feet West)
 This point will not be changed This point will be changed as follows:
Proposed point of diversion: (Complete only if change is requested)
 One in the _____ Quarter of the _____ Quarter of the _____ Quarter of Section _____, Township _____ South, Range _____ (EW), in _____ County, Kansas, _____ feet North _____ feet West of Southeast corner of section. Proposed Rate _____ Proposed Quantity _____
 This point is: Additional Well Geo.Center List other water rights that will use this point _____

11. Describe the current condition of and future plans for any point(s) of diversion which will no longer be used. _____

IF MORE SPACE IS NEEDED, ATTACH ADDITIONAL SHEETS AS NECESSARY

X LFDWR 9/13/18-

4. The presently authorized place of use is:

Owner of Land — NAME: NO CHANGE

ADDRESS: _____

| Sec. | Twp. | Range | NE¼ | | | | NW¼ | | | | SW¼ | | | | SE¼ | | | | TOTAL ACRES | | |
|------|------|-------|-----|-----|-----|-----|-----|-----|-----|-----|-----|-----|-----|-----|-----|-----|-----|-----|-------------|--|--|
| | | | NE¼ | NW¼ | SW¼ | SE¼ | NE¼ | NW¼ | SW¼ | SE¼ | NE¼ | NW¼ | SW¼ | SE¼ | NE¼ | NW¼ | SW¼ | SE¼ | | | |
| | | | | | | | | | | | | | | | | | | | | | |
| | | | | | | | | | | | | | | | | | | | | | |
| | | | | | | | | | | | | | | | | | | | | | |

List any other water rights that cover this place of use. _____

Owner of Land — NAME: _____

ADDRESS: _____

| Sec. | Twp. | Range | NE¼ | | | | NW¼ | | | | SW¼ | | | | SE¼ | | | | TOTAL ACRES | | | |
|------|------|-------|-----|-----|-----|-----|-----|-----|-----|-----|-----|-----|-----|-----|-----|-----|-----|-----|-------------|--|--|--|
| | | | NE¼ | NW¼ | SW¼ | SE¼ | NE¼ | NW¼ | SW¼ | SE¼ | NE¼ | NW¼ | SW¼ | SE¼ | NE¼ | NW¼ | SW¼ | SE¼ | | | | |
| | | | | | | | | | | | | | | | | | | | | | | |
| | | | | | | | | | | | | | | | | | | | | | | |
| | | | | | | | | | | | | | | | | | | | | | | |

List any other water rights that cover this place of use. _____

(If there are more than two landowners, attach additional sheets as necessary.)

5. It is proposed that the place of use be changed to:

Owner of Land — NAME: _____

ADDRESS: _____

| Sec. | Twp. | Range | NE¼ | | | | NW¼ | | | | SW¼ | | | | SE¼ | | | | TOTAL ACRES | | | | |
|------|------|-------|-----|-----|-----|-----|-----|-----|-----|-----|-----|-----|-----|-----|-----|-----|-----|-----|-------------|--|--|--|--|
| | | | NE¼ | NW¼ | SW¼ | SE¼ | NE¼ | NW¼ | SW¼ | SE¼ | NE¼ | NW¼ | SW¼ | SE¼ | NE¼ | NW¼ | SW¼ | SE¼ | | | | | |
| | | | | | | | | | | | | | | | | | | | | | | | |
| | | | | | | | | | | | | | | | | | | | | | | | |
| | | | | | | | | | | | | | | | | | | | | | | | |

List any other water rights that cover this place of use. _____

Owner of Land — NAME: _____

ADDRESS: _____

| Sec. | Twp. | Range | NE¼ | | | | NW¼ | | | | SW¼ | | | | SE¼ | | | | TOTAL ACRES | | | | | |
|------|------|-------|-----|-----|-----|-----|-----|-----|-----|-----|-----|-----|-----|-----|-----|-----|-----|-----|-------------|--|--|--|--|--|
| | | | NE¼ | NW¼ | SW¼ | SE¼ | NE¼ | NW¼ | SW¼ | SE¼ | NE¼ | NW¼ | SW¼ | SE¼ | NE¼ | NW¼ | SW¼ | SE¼ | | | | | | |
| | | | | | | | | | | | | | | | | | | | | | | | | |
| | | | | | | | | | | | | | | | | | | | | | | | | |
| | | | | | | | | | | | | | | | | | | | | | | | | |

Water Resources
Received

AUG 30 2018

List any other water rights that cover this place of use. _____

KS Dept Of Agriculture

IF MORE SPACE IS NEEDED, ATTACH ADDITIONAL SHEETS AS NECESSARY

12. The presently authorized use of water is for STK purposes.

It is proposed that the use be changed to NO CHANGE purposes.

13. If changing the place of use and/or use made of water, describe how the consumptive use will not be increased.

N/A

(Please show any calculations here.)

14. It is requested that the maximum annual quantity of water be reduced to _____ (acre-feet or million gallons).

15. It is requested that the maximum rate of diversion of water be reduced to _____ gallons per minute (____ c.f.s.).

16. The application must include either a topographic map or detailed plat. A U.S. Geological Survey Topographic Map, scale 1:24,000, is available through the Kansas Geological Survey, 1930 Constant Avenue, University of Kansas, Lawrence, Kansas 66047-3726 (www.usgs.gov). The map should show the location of the presently authorized point(s) of diversion. Distances North and West of the Southeast corner of the section must be shown. The presently authorized place of use should also be shown. Identify the center of the section, the section lines and the section corners and show the appropriate section, township, and range numbers on the map. In addition the following information must also be shown on the map.

a. If a change in the location of the point(s) of diversion is proposed, show:

- 1) The location of the proposed point(s) of diversion. Distances North and West of the Southeast corner of the section must be shown. Please be certain that the information shown on the map agrees with the information shown in Paragraph Nos. 9, 10 and 11 of the application.
- 2) If the source of supply is groundwater, please show the location of existing water wells of any kind, including domestic wells, within 1/2 mile of the proposed well or wells. Identify each well as to its use and furnish name and mailing address of the property owner or owners. If there are no wells within 1/2 mile, please indicate so on the map.
- 3) If the source of supply is surface water, the names and mailing addresses of all landowner(s) 1/2 mile downstream and 1/2 mile upstream from your property lines must be shown.

b. If a change in the place of use is desired, show the proposed place of use by crosshatching on the map. Please be certain that the information shown on the map agrees with the information shown in Paragraph No. 5 of the application.

17. Attach documentation to show the change(s) proposed herein will not impair existing water rights and relates to the same local source of supply as to which the water right relates. This information may include statements, plats, geology reports, well logs, test hole logs, and other information as necessary information to show the above. Additional comments may be made below.

SAME LOCAL SOURCE OF SUPPLY. WELLS ARE LIMITED TO WITHIN A 1/4 MILE RADIUS CIRCLE.

18. If the proposed change(s) does not meet all applicable rules and regulations of the Kansas Water Appropriation Act, please identify the rules and regulations for which you request a waiver. State the reason why a waiver is needed and why the request should be granted. Attach documentation showing that granting the request will not impair existing water rights and will not prejudicially and unreasonably affect the public interest.

N/A

Water Resources
Received

AUG 30 2018

IF MORE SPACE IS NEEDED, ATTACH ADDITIONAL SHEETS AS NECESSARY

SCANNED

Any use of water that is not as authorized by the water right or permit to authorize water **before** the chief engineer approves this application is a violation of the Kansas Water Appropriation Act for which criminal or civil penalties may be assessed. Such violation is a class C misdemeanor, punishable by a fine not to exceed \$500 and/or a term of confinement not to exceed one month in the county jail. K.S.A. 82a-728(b). Civil penalties shall be not less than \$100 nor more than \$1,000 per violation. In the case of a continuing violation, each day such violation continues may be deemed a separate violation. In addition to these penalties the water right may be modified or suspended. K.S.A. 82a-737, as amended.

The application must be signed by all owners of the place of use authorized under the water right and his or her spouse, if married. Please indicate if there is no spouse. If land is being purchased under contract, the seller must sign as landowner until such time as the contract is completed.

In the event that all applicants cannot appear before one notary public, they may as necessary sign separate copies of the application before any notary public conveniently available to them. All copies signed in this manner shall be considered to be valid parts of the application.

If the request is signed on behalf of any Owner by someone with legal authority to do so (for example, an agent, one who has power of attorney, or an executor, executrix, conservator), it will be necessary to attach proper documents showing such authority.

I declare that I am an owner of the currently authorized place of use as identified herein, or that I represent all such owners and am authorized to make this application on their behalf, and declare further that the statements contained herein are true, correct, and complete. By filing this application I authorize the chief engineer to permanently reduce the quantity of water and/or rate of diversion as specified in sections 14 and 15 of this application.

Dated at Lawrence, Kansas, this 27th day of August, 20 18.

Tracy Brunner
(Owner)
Tracy Brunner
(Please Print)

Delores Y. Brunner
(Spouse)
Delores Y. Brunner
(Please Print)

(Owner)

(Please Print)

(Owner)

(Please Print)

(Spouse)

(Please Print)

(Spouse)

(Please Print)

State of Kansas }
County of Dickinson } SS

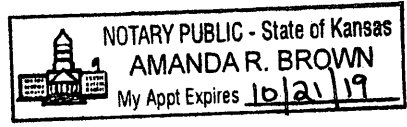

I hereby certify that the foregoing application was signed in my presence and sworn to before me this 27th day of August 27, 20 18.

Amanda R. Brown
Notary Public

My Commission Expires 10/21/19

FEE SCHEDULE

Each application to change the place of use, the point of diversion or the use made of the water under this section shall be accompanied by the application fee set forth in the schedule below:

- (1) Application to change a point of diversion 300 feet or less \$100
- (2) Application to change a point of diversion more than 300 feet \$200
- (3) Application to change the place of use \$200
- (4) Application to change the use made of the water \$300

Make check payable to **Kansas Department of Agriculture.**

New Well, Adding Point of Diversion File No. 47,155
Change in Point of Diversion

Any use of water that is not as authorized by the water right or permit to authorize water **before** the chief engineer approves this application is a violation of the Kansas Water Appropriation Act for which criminal or civil penalties may be assessed. Such violation is a class C misdemeanor, punishable by a fine not to exceed \$500 and/or a term of confinement not to exceed one month in the county jail. K.S.A. 82a-728(b). Civil penalties shall be not less than \$100 nor more than \$1,000 per violation. In the case of a continuing violation, each day such violation continues may be deemed a separate violation. In addition to these penalties the water right may be modified or suspended. K.S.A. 82a-737, as amended.

The application must be signed by all owners of the place of use authorized under the water right and his or her spouse, if married. Please indicate if there is no spouse. If land is being purchased under contract, the seller must sign as landowner until such time as the contract is completed.

In the event that all applicants cannot appear before one notary public, they may as necessary sign separate copies of the application before any notary public conveniently available to them. All copies signed in this manner shall be considered to be valid parts of the application.

If the request is signed on behalf of any Owner by someone with legal authority to do so (for example, an agent, one who has power of attorney, or an executor, executrix, conservator), it will be necessary to attach proper documents showing such authority.

I declare that I am an owner of the currently authorized place of use as identified herein, or that I represent all such owners and am authorized to make this application on their behalf, and declare further that the statements contained herein are true, correct, and complete. By filing this application I authorize the chief engineer to permanently reduce the quantity of water and/or rate of diversion as specified in sections 14 and 15 of this application.

Dated at Raymond, KS Dickinson Co., Kansas, this 24 day of October, 2018.

Lauren + Orvell Brunner Trust _____
(Owner) (Spouse)

Kent Brunner Trustee _____
(Please Print) (Please Print)

x Kent Brunner Trustee _____
(Owner signature) (Spouse)

_____ (Please Print) **Water Resources Received** (Please Print)

_____ (Owner) **OCT 29 2018** (Please Print)

_____ (Please Print) **KS Dept Of Agriculture** (Spouse)

State of Kansas }
County of Dickinson } SS

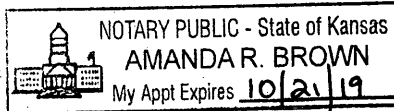

I hereby certify that the foregoing application was signed in my presence and sworn to before me this 24 day of October, 2018.

My Commission Expires 10/21/19

Amanda R. Brown
Notary Public

FEE SCHEDULE

Each application to change the place of use, the point of diversion or the use made of the water under this section shall be accompanied by the application fee set forth in the schedule below:

- (1) Application to change a point of diversion 300 feet or less \$100
- (2) Application to change a point of diversion more than 300 feet \$200
- (3) Application to change the place of use \$200
- (4) Application to change the use made of the water \$300

THE STATE OF KANSAS



KANSAS DEPARTMENT OF AGRICULTURE
Mike Beam, Interim Secretary of Agriculture

DIVISION OF WATER RESOURCES
David W. Barfield, Chief Engineer

The following conditions will be placed on Appropriation of Water, File No. 47,155, to insure that the proposed change in point of diversion will comply with K.A.R. 5-3-4(d).

1. That the rate of diversion for each well authorized by Appropriation of Water, File No. 47,155, shall not exceed a maximum diversion rate of 20 gallons per minute per well.
2. That Appropriation of Water, File No. 47,155, shall be further limited to a diversion rate which when the wells operate simultaneously will provide a maximum diversion rate not in excess of 35 gallons per minute (0.08 c.f.s.).

I understand that the Approval of Application for Change in Point of Diversion, Appropriation of Water, File No. 47,155, will be conditioned by the limitations stated above.

Tracy Brunner

Water Resources
Received

JAN 25 2019

KS Dept Of Agriculture

SCANNED

1320 Research Park Drive
Manhattan, KS 66502
785-564-6700
www.agriculture.ks.gov



900 SW Jackson, Room 456
Topeka, KS 66612
785-296-3556

Mike Beam, Interim Secretary

Laura Kelly, Governor

January 16, 2019

TRACY BRUNNER
PO BOX 103
RAMONA KS 67475

RE: Appropriation of Water
File No. 47,155

FILE COPY

Dear Mr. Brunner:

Reference is made to the application for approval of the Chief Engineer to change the authorized point of diversion under the referenced file number which was received in this office on August 30, 2018. As per our telephone conversation on January 15, 2019, we find that additional information is needed.

Rules and regulations state that if the source of supply for a proposed appropriation is groundwater, a separate application shall be filed for each proposed well or battery of wells. However, there is an exception to the single well per application. The rules do allow for up to four wells within a circle with a quarter-mile radius in the same local source of supply that do not exceed a maximum diversion rate of 20 gallons per minute per well.

Because your permit is authorized a total of 35 gallons per minute, we need assurances that the 20 gallons per minute per well will not be exceeded. In order to continue processing your application to add a second well, will require that Appropriation of Water, File No. 47,155, be conditioned so that each well will be limited to a rate of diversion not to exceed 20 gallons per minute, and that the entire water right not exceed a total rate of diversion not to exceed 35 gallons per minute. I have prepared the attached statement for your review and signature.

Please sign and return the attached document to this office at your earliest convenience so we may proceed with processing your application.

If you have any questions, please contact me at (785)-564-6645. If you wish to discuss a specific file, please have the file number ready so that I may help you more efficiently.

Sincerely,



Brent A. Turney, P.G.
Change Application Unit Supervisor

BAT
Enclosures
pc: Topeka Field Office

SCANNED

1320 Research Park Drive
Manhattan, KS 66502
785-564-6700
www. agriculture.ks.gov



900 SW Jackson, Room 456
Topeka, KS 66612
785-296-3556

Mike Beam, Interim Secretary

Laura Kelly, Governor

January 16, 2019

TRACY BRUNNER
PO BOX 103
RAMONA KS 67475

RE: Appropriation of Water
File No. 47,155

Dear Mr. Brunner:

Reference is made to the application for approval of the Chief Engineer to change the authorized point of diversion under the referenced file number which was received in this office on August 30, 2018. As per our telephone conversation on January 15, 2019, we find that additional information is needed.

Rules and regulations state that if the source of supply for a proposed appropriation is groundwater, a separate application shall be filed for each proposed well or battery of wells. However, there is an exception to the single well per application. The rules do allow for up to four wells within a circle with a quarter-mile radius in the same local source of supply that do not exceed a maximum diversion rate of 20 gallons per minute per well.

Because your permit is authorized a total of 35 gallons per minute, we need assurances that the 20 gallons per minute per well will not be exceeded. In order to continue processing your application to add a second well, will require that Appropriation of Water, File No. 47,155, be conditioned so that each well will be limited to a rate of diversion not to exceed 20 gallons per minute, and that the entire water right not exceed a total rate of diversion not to exceed 35 gallons per minute. I have prepared the attached statement for your review and signature.

Please sign and return the attached document to this office at your earliest convenience so we may proceed with processing your application.

If you have any questions, please contact me at (785)-564-6645. If you wish to discuss a specific file, please have the file number ready so that I may help you more efficiently.

Sincerely,

Brent A. Turney, P.G.
Change Application Unit Supervisor
Water Resources

Received

JAN 25 2019

KS Dept Of Agriculture

BAT
Enclosures
pc: Topeka Field Office

SCANNED

1320 Research Park Drive
Manhattan, KS 66502
785-564-6700
www. agriculture.ks.gov



900 SW Jackson, Room 456
Topeka, KS 66612
785-296-3556

Mike Beam, Interim Secretary

Laura Kelly, Governor

TRACY BRUNNER
PO BOX 103
RAMONA KS 67475

RECEIVED January 16, 2019

MAR 05 2019

COPY
RECEIVED

Topeka Field Office
DIVISION OF WATER RESOURCES
RE: Appropriation of Water
File No. 47,155

JAN 24 2019

Topeka Field Office
DIVISION OF WATER RESOURCES

Dear Mr. Brunner:

Reference is made to the application for approval of the Chief Engineer to change the authorized point of diversion under the referenced file number which was received in this office on August 30, 2018. As per our telephone conversation on January 15, 2019, we find that additional information is needed.

Rules and regulations state that if the source of supply for a proposed appropriation is groundwater, a separate application shall be filed for each proposed well or battery of wells. However, there is an exception to the single well per application. The rules do allow for up to four wells within a circle with a quarter-mile radius in the same local source of supply that do not exceed a maximum diversion rate of 20 gallons per minute per well.

Because your permit is authorized a total of 35 gallons per minute, we need assurances that the 20 gallons per minute per well will not be exceeded. In order to continue processing your application to add a second well, will require that Appropriation of Water, File No. 47,155, be conditioned so that each well will be limited to a rate of diversion not to exceed 20 gallons per minute, and that the entire water right not exceed a total rate of diversion not to exceed 35 gallons per minute. I have prepared the attached statement for your review and signature.

Please sign and return the attached document to this office at your earliest convenience so we may proceed with processing your application.

If you have any questions, please contact me at (785)-564-6645. If you wish to discuss a specific file, please have the file number ready so that I may help you more efficiently.

Sincerely,

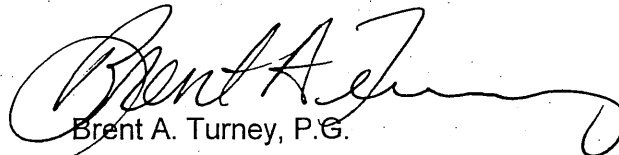

Brent A. Turney, P.G.
Change Application Unit Supervisor

BAT
Enclosures
pc: Topeka Field Office

Water Resources
Received

MAR 08 2019

KS Dept Of Agriculture

SCANNED
SCANNED

APPROVAL RECOMENDATION FROM K. TIETSOFT, WC TFO.

KANSAS DEPARTMENT OF AGRICULTURE

109 SW 9th St.

Topeka, Kansas 66612

Date 3/5/19

To: Brent Twenay

Rec 3/12/19
[Signature]

- | | |
|--|---|
| <input type="checkbox"/> For your information | <input type="checkbox"/> Please sign/return |
| <input type="checkbox"/> For your files | <input type="checkbox"/> Please reply direct |
| <input checked="" type="checkbox"/> For appropriate action | <input type="checkbox"/> Material you requested |
| <input type="checkbox"/> For your approval/RTN | <input type="checkbox"/> Please review |

Comments: Proceed :)

KAT-TFO
From
Division
Phone

THE STATE OF KANSAS



RECEIVED

MAR 05 2019

Topeka Field Office
DIVISION OF WATER RESOURCES

KANSAS DEPARTMENT OF AGRICULTURE
Mike Beam, Acting Secretary of Agriculture

DIVISION OF WATER RESOURCES
David W. Barfield, Chief Engineer

The following conditions will be placed on Appropriation of Water, File No. 47,155, to insure that the proposed change in point of diversion will comply with K.A.R. 5-3-4(d).

1. That the rate of diversion for each well authorized by Appropriation of Water, File No. 47,155, shall not exceed a maximum diversion rate of 20 gallons per minute per well.
2. That Appropriation of Water, File No. 47,155, shall be further limited to a diversion rate which when the wells operate simultaneously will provide a maximum diversion rate not in excess of 35 gallons per minute (0.08 c.f.s.).

I understand that the Approval of Application for Change in Point of Diversion, Appropriation of Water, File No. 47,155, will be conditioned by the limitations stated above.

Tracy Brunner

 Tracy Brunner 3/23/19

Water Resources
Received

MAR 08 2019

KS Dept Of Agriculture

SCANNED

SCANNED

Ireland, Leslie [KDA]

Subject: FW: Recommendation for Change File No. 47155 Brunner
Attachments: 47155 Appropriationrate lmts for rate_site_1_0.pdf

From: Ireland, Leslie [KDA]
Sent: Monday, December 17, 2018 10:23 AM
To: Turney, Brent [KDA] <Brent.Turney@ks.gov>
Subject: FW: Recommendation for Change File No. 47155 Brunner

From: Ireland, Leslie [KDA]
Sent: Monday, December 17, 2018 10:19 AM
To: Tietsort, Katie [KDA] <Katie.Tietsort@ks.gov>
Subject: FW: Recommendation for Change File No. 47155 Brunner

Katie,

The attached is what the approval will look like. Except it will be signed by Lane.

Leslie

From: Turney, Brent [KDA]
Sent: Monday, December 17, 2018 8:07 AM
To: Ireland, Leslie [KDA] <Leslie.Ireland@ks.gov>
Cc: Tietsort, Katie [KDA] <Katie.Tietsort@ks.gov>
Subject: RE: Recommendation for Change File No. 47155 Brunner

Leslie,

We don't assign a rate or quantity per well, we will just limit the rate of diversion per well not to exceed 20 gallons per minute.

Brent

Brent A. Turney, P.G.
Kansas Department of Agriculture
Division of Water Resources
1320 Research Park Drive
Manhattan Kansas 66502
(785) 564-6645
Brent.Turney@ks.gov
www.agriculture.ks.gov

From: Ireland, Leslie [KDA]
Sent: Friday, December 14, 2018 11:15 AM
To: Turney, Brent [KDA] <Brent.Turney@ks.gov>
Cc: Tietsort, Katie [KDA] <Katie.Tietsort@ks.gov>
Subject: FW: Recommendation for Change File No. 47155 Brunner

Forgot Brent...

From: Ireland, Leslie [KDA]
Sent: Friday, December 14, 2018 11:14 AM
To: Tietzsort, Katie [KDA] <Katie.Tietzsort@ks.gov>
Subject: RE: Recommendation for Change File No. 47155 Brunner

A modification of the application like the attached.. what I don't know is if I've ever assigned the rate and not the quantity.

If we assigned the quantity too (Which I know we've assigned both), I took a look at the historical data,

The quantity average on the existing well is 18.7411 AF with a max of 22.114 AF . The right is authorized 52 .17 AF or 17 mgy. He could assign the quantity evenly 26.085 AF or 8.5 mgy with both assigned 17.5 gpm. He could pump the quantity at each well 337 days pumping 24/7. At 20 gpm it is 295 days.

So like you said we need to talk with Brent.... I've added him to these emails so he can take a look Monday.

Have a great weekend.. our party is getting going. But if there is anything else let me know.. here all day....
Leslie

From: Tietzsort, Katie [KDA]
Sent: Friday, December 14, 2018 10:47 AM
To: Ireland, Leslie [KDA] <Leslie.Ireland@ks.gov>
Subject: Re: Recommendation for Change File No. 47155 Brunner

Yes that's right, I agree on that limitation good catch!!!! But I still don't think we have addressed the existing well that currently pumps at 35 gpm! I need to talk to Brent about this again.

Sent from my iPhone

On Dec 14, 2018, at 10:23 AM, Ireland, Leslie [KDA] <Leslie.Ireland@ks.gov> wrote:

Katie,

The right is for 35 gpm, so no they can't pump each well at 20 gpm at the same time. If they pump each well at 20 they would exceed the permitted rate. Hence the limitation.. it would be best if he would set the wells to each pump 17.5 gpm. I think I saw a reported rate on one year at 70 gpm so didn't want to jam him up and we probably giving him too much flexibility. But if you want a formal reduction to 20 gpm for the right the limitation to 35 gpm wouldn't be need. It would be only one well can operate at a time at 20 gpm? or the permit could be issued with each well assigned. 17.5 gmp? Then no limitation.

Didn't know about the additional agreements he needed to make about the pump . Brent talked with him.. I didn't know about the pump I suggested sending an email yesterday about the rate limitation...but got the "we're good he wants to proceed" It seems I should send an email.. about the agreement to reduce the pump size and then what about the 17.5 gpm assigned per well???

Leslie

....

From: Tietsort, Katie [KDA]
Sent: Friday, December 14, 2018 9:57 AM
To: Ireland, Leslie [KDA] <Leslie.Ireland@ks.gov>
Subject: RE: Recommendation for Change File No. 47155 Brunner

Where did the 35 gpm limitation come from? They can pump 20 gpm from each well and no limitation by reg, right?

And so did Brunner agree to reduce the size of the pump in the existing well to reduce the currently pumping rate in that 35 gpm well to 20 gpm?

Katie Tietsort
<[image002.jpg](#)>
Kansas Department of Agriculture
6531 SE Forbes Ave Ste B
Topeka, KS 66619
katie.tietsort@ks.gov
Phone 785-296-5733

Achiever~Responsibility~Input~Relator~Arranger

From: Ireland, Leslie [KDA]
Sent: Friday, December 14, 2018 9:27 AM
To: Tietsort, Katie [KDA] <Katie.Tietsort@ks.gov>
Subject: Recommendation for Change File No. 47155 Brunner

Katie,

Please let me know if you could recommend this change.

As always comments and concerns are welcome.

Leslie Ireland, Environmental Scientist
Kansas Department of Agriculture
Division of Water Resources - Change Unit
(785) 564-6633
Leslie.Ireland@ks.gov
www.agriculture.ks.gov

Ireland, Leslie [KDA]

Subject: FW: Recommendation for Change File No. 47155 Brunner
Attachments: 47155 Appropriationrate lmts for rate_site_1_0.pdf

From: Ireland, Leslie [KDA]
Sent: Monday, December 17, 2018 10:23 AM
To: Turney, Brent [KDA] <Brent.Turney@ks.gov>
Subject: FW: Recommendation for Change File No. 47155 Brunner

From: Ireland, Leslie [KDA]
Sent: Monday, December 17, 2018 10:19 AM
To: Tietsort, Katie [KDA] <Katie.Tietsort@ks.gov>
Subject: FW: Recommendation for Change File No. 47155 Brunner

Katie,

The attached is what the approval will look like. Except it will be signed by Lane.

Leslie

From: Turney, Brent [KDA]
Sent: Monday, December 17, 2018 8:07 AM
To: Ireland, Leslie [KDA] <Leslie.Ireland@ks.gov>
Cc: Tietsort, Katie [KDA] <Katie.Tietsort@ks.gov>
Subject: RE: Recommendation for Change File No. 47155 Brunner

Leslie,
We don't assign a rate or quantity per well, we will just limit the rate of diversion per well not to exceed 20 gallons per minute.
Brent

Brent A. Turney, P.G.
Kansas Department of Agriculture
Division of Water Resources
1320 Research Park Drive
Manhattan Kansas 66502
(785) 564-6645
Brent.Turney@ks.gov
www.agriculture.ks.gov

From: Ireland, Leslie [KDA]
Sent: Friday, December 14, 2018 11:15 AM
To: Turney, Brent [KDA] <Brent.Turney@ks.gov>
Cc: Tietsort, Katie [KDA] <Katie.Tietsort@ks.gov>
Subject: FW: Recommendation for Change File No. 47155 Brunner

Forgot Brent...

From: Ireland, Leslie [KDA]
Sent: Friday, December 14, 2018 11:14 AM
To: Tietzort, Katie [KDA] <Katie.Tietzort@ks.gov>
Subject: RE: Recommendation for Change File No. 47155 Brunner

A modification of the application like the attached.. what I don't know is if I've ever assigned the rate and not the quantity.

If we assigned the quantity too (Which I know we've assigned both), I took a look at the historical data,

The quantity average on the existing well is 18.7411 AF with a max of 22.114 AF . The right is authorized 52 .17 AF or 17 mg. He could assign the quantity evenly 26.085 AF or 8.5 mg with both assigned 17.5 gpm. He could pump the quantity at each well 337 days pumping 24/7. At 20 gpm it is 295 days.

So like you said we need to talk with Brent.... I've added him to these emails so he can take a look Monday.

Have a great weekend.. our party is getting going. But if there is anything else let me know.. here all day....
Leslie

From: Tietzort, Katie [KDA]
Sent: Friday, December 14, 2018 10:47 AM
To: Ireland, Leslie [KDA] <Leslie.Ireland@ks.gov>
Subject: Re: Recommendation for Change File No. 47155 Brunner

Yes that's right, I agree on that limitation good catch!!!! But I still don't think we have addressed the existing well that currently pumps at 35 gpm! I need to talk to Brent about this again.

Sent from my iPhone

On Dec 14, 2018, at 10:23 AM, Ireland, Leslie [KDA] <Leslie.Ireland@ks.gov> wrote:

Katie,

The right is for 35 gpm, so no they can't pump each well at 20 gpm at the same time. If they pump each well at 20 they would exceed the permitted rate. Hence the limitation.. it would be best if he would set the wells to each pump 17.5 gpm. I think I saw a reported rate on one year at 70 gpm so didn't want to jam him up and we probably giving him too much flexibility. But if you want a formal reduction to 20 gpm for the right the limitation to 35 gpm wouldn't be need. It would be only one well can operate at a time at 20 gpm? or the permit could be issued with each well assigned. 17.5 gmp? Then no limitation.

Didn't know about the additional agreements he needed to make about the pump . Brent talked with him.. I didn't know about the pump I suggested sending an email yesterday about the rate limitation...but got the "we're good he wants to proceed" It seems I should send an email.. about the agreement to reduce the pump size and then what about the 17.5 gpm assigned per well???

Leslie

....

From: Tietsort, Katie [KDA]

Sent: Friday, December 14, 2018 9:57 AM

To: Ireland, Leslie [KDA] <Leslie.Ireland@ks.gov>

Subject: RE: Recommendation for Change File No. 47155 Brunner

Where did the 35 gpm limitation come from? They can pump 20 gpm from each well and no limitation by reg, right?

And so did Brunner agree to reduce the size of the pump in the existing well to reduce the currently pumping rate in that 35 gpm well to 20 gpm?

Katie Tietsort

<[image002.jpg](#)>

Kansas Department of Agriculture

6531 SE Forbes Ave Ste B

Topeka, KS 66619

katie.tietsort@ks.gov

Phone 785-296-5733

Achiever~Responsibility~Input~Relator~Arranger

From: Ireland, Leslie [KDA]

Sent: Friday, December 14, 2018 9:27 AM

To: Tietsort, Katie [KDA] <Katie.Tietsort@ks.gov>

Subject: Recommendation for Change File No. 47155 Brunner

Katie,

Please let me know if you could recommend this change.

As always comments and concerns are welcome.

Leslie Ireland, Environmental Scientist

Kansas Department of Agriculture

Division of Water Resources - Change Unit

(785) 564-6633

Leslie.Ireland@ks.gov

www.agriculture.ks.gov



GOVERNOR JEFF COLYER, M.D.
JACKIE McCLASKEY, SECRETARY OF AGRICULTURE

September 15, 2018

LEROY F STRODA TRUST
177 OAT RD
RAMONA KS 67475

Re: Appropriation of Water, File No. 47,155

Dear Sir or Madam;

This letter updates the September 15, 2018 letter that was to inform you that Tracy and Delores Brunner have filed an application to change the point of diversion under the referenced file authorized for stockwatering use. The section number for the proposed well has been corrected.

The application proposes the following change:

from: one (1) well located in the Northwest Quarter of the Northeast Quarter of the Southeast Quarter (NW $\frac{1}{4}$ NE $\frac{1}{4}$ SE $\frac{1}{4}$) of Section 34, more particularly described as being near a point 1,995 feet North and 1,176 feet West of the Southeast corner of said section, at a quantity not to exceed (17 million gallons (52.17 acre-feet) per calendar year and at a diversion rate not in excess of 35 gallons per minute (0.08 c.f.s.),

to: one (1) well located in the Northwest Quarter of the Northeast Quarter of the Southeast Quarter (NW $\frac{1}{4}$ NE $\frac{1}{4}$ SE $\frac{1}{4}$) of Section 34, more particularly described as being near a point 1,995 feet North and 1,176 feet West of the Southeast corner of said section, and

one (1) well located in the Northeast Quarter of the Northeast Quarter of the Southeast Quarter (NE $\frac{1}{4}$ NE $\frac{1}{4}$ SE $\frac{1}{4}$) of Section 34, more particularly described as being near a point 1,995 feet North and 150 feet West of the Southeast corner of said section,

limited to a maximum rate of 35 gallons per minute when the wells operate simultaneously, and an annual quantity not to exceed 17 million gallons (52.17 acre-feet)

all in Township 16 South, Range 3 East, Dickinson County, Kansas.

A map of the proposed change has been enclosed to further inform you of the proposed change.

FILE COPY

Records in this office indicate that you may have a well or wells in this vicinity of the proposed change in point of diversion. You are being notified of the proposal so that you may furnish this office written comments or other information you may desire to submit. Such written comments or other information must be received in this office within 15 days from the date of this letter.

If you have any questions, please contact our office, my desk phone is (785) 564-6633. If you wish to discuss a specific file, please have the file numbers ready so that we may help you more efficiently.

Sincerely,



Leslie Ireland
Environmental Scientist
Water Appropriation Program

LI:li

Enclosure

pc: Topeka Field Office
Tracy & Delores Brunner

STATE OF KANSAS

DEPARTMENT OF AGRICULTURE
1320 RESEARCH PARK DRIVE
MANHATTAN, KS 66502
PHONE: (785) 564-6700
FAX: (785) 564-6777



900 SW JACKSON, ROOM 456
TOPEKA, KS 66612
PHONE: (785) 296-3556
www.agriculture.ks.gov

GOVERNOR JEFF COLYER, M.D.
JACKIE McCLASKEY, SECRETARY OF AGRICULTURE

September 14, 2018

LEROY F. STRODA TRUST
177 OAT RD
RAMONA KS 67475

Re: Appropriation of Water, File No. 47,155

Dear Sir or Madam;

This letter is to inform you that Tracy and Delores Brunner have filed an application to change the point of diversion under the referenced file authorized for stockwatering use.

The application proposes the following change:

from: one (1) well located in the Northwest Quarter of the Northeast Quarter of the Southeast Quarter (NW $\frac{1}{4}$ NE $\frac{1}{4}$ SE $\frac{1}{4}$) of Section 34, more particularly described as being near a point 1,995 feet North and 1,176 feet West of the Southeast corner of said section, at a quantity not to exceed (17 million gallons (52.17 acre-feet) per calendar year and at a diversion rate not in excess of 35 gallons per minute (0.08 c.f.s.),

to: one (1) well located in the Northwest Quarter of the Northeast Quarter of the Southeast Quarter (NW $\frac{1}{4}$ NE $\frac{1}{4}$ SE $\frac{1}{4}$) of Section 34, more particularly described as being near a point 1,995 feet North and 1,176 feet West of the Southeast corner of said section, and

one (1) well located in the Northeast Quarter of the Northeast Quarter of the Southeast Quarter (NE $\frac{1}{4}$ NE $\frac{1}{4}$ SE $\frac{1}{4}$) of Section 18, more particularly described as being near a point 1,995 feet North and 150 feet West of the Southeast corner of said section,

limited to a maximum rate of 35 gallons per minute when the wells operate simultaneously, and an annual quantity not to exceed 17 million gallons (52.17 acre-feet)

all in Township 16 South, Range 3 East, Dickinson County, Kansas.

A map of the proposed change has been enclosed to further inform you of the proposed change.

FILE COPY

Records in this office indicate that you may have a well or wells in this vicinity of the proposed change in point of diversion. You are being notified of the proposal so that you may furnish this office written comments or other information you may desire to submit. Such written comments or other information must be received in this office within 15 days from the date of this letter.

If you have any questions, please contact our office, my desk phone is (785) 564-6633. If you wish to discuss a specific file, please have the file numbers ready so that we may help you more efficiently.

Sincerely,



Leslie Ireland
Environmental Scientist
Water Appropriation Program

LI:li

Enclosure

pc: Topeka Field Office
Tracy & Delores Brunner

FILE COPY

47155
NEARBY

KGS
Hydrology

Water Well
Database
Query

Township: 16S, Range: 3E, Section: 34
Select location of well to view details.
Click on column heading to sort.

Save Data
to File

7 records returned.

| T-R-S | Owner | Well Depth Ascend. Desc. | Static Water Level Ascend. Desc. | Est. Yield Ascend. Desc. | Well Use | Other ID | Action Taken | Completion Date Ascend. Desc. | Scan? |
|---------------------------|-----------------|--------------------------------|--|--------------------------------|---------------------|----------|--------------|-------------------------------------|-------|
| Sec. 34 SE SW SW | Brunner, Lauren | 103 ft. | 83 ft. | 12 gpm. | Domestic | | Constructed | 30-Nov-1987 | PDF |
| Sec. 34 NE NE SE | Stroda, Kenny | 86 ft. | 26 ft. | 40 gpm. | Domestic, Livestock | | Constructed | 28-Nov-2007 | PDF |
| Sec. 34 SW SW SW | Brunner Ranch | 85 ft. | 71 ft. | 10 gpm. | Domestic | W Well | Constructed | 13-Feb-1990 | PDF |
| Sec. 34 SW SE SE | Brunner Ranch | 71 ft. | 41 ft. | 20 gpm. | Domestic | | Constructed | 12-Feb-1990 | PDF |
| Sec. 34 NW SW SW | Cow Camp Ranch | 65 ft. | 28 ft. | 4 gpm. | Domestic, Livestock | | Constructed | 14-Feb-2014 | PDF |
| Sec. 34 SE NE NE | Stroda, Leroy | 90 ft. | 45 ft. | 30 gpm. | Domestic | | Constructed | 04-May-1991 | PDF |
| Sec. 34 NE SE NW | Cow Camp Ranch | 90 ft. | 41 ft. | 35 gpm. | Domestic | | Constructed | 01-Aug-2002 | Scan |

Kansas Geological Survey
Comments to webadmin@kgs.ku.edu
URL=<http://www.kgs.ku.edu/Magellan/WaterWell/index.html>
Display Programs Updated July 2, 2014
Data added continuously.

*NO WELLS IN SW 3E
OF 33-16 3E
1 well in NW -
IS OWNED BY
THEY BRUNNER
SE SE OF 34
OWNED
BY BRUNNER
RANCH*

Water Rights and Points of Diversion Within 1.50 miles of point defined as:

1995 ft N and 150 ft W of the SE Corner of Section 34, T 16S, R 3E

Located at: 97.078101 West Longitude and 38.614670 North Latitude

GROUNDWATER ONLY

*PROPOSED PD
FILE NO. 47,155*

| File Number | Use | ST | SR | Dist (ft) | Q4 | Q3 | Q2 | Q1 | FeetN | FeetW | Sec | Twp | Rng | ID | Batt | Auth_Quan | Add_Quan | Unit |
|-------------|-----|-----|----|-----------|------|----|----|----|-------|-------|------|-----|-----|----|-------|-----------|----------|------|
| A__ 39749 | 00 | STK | NK | G | 4758 | -- | SE | SW | SW | 175 | 4546 | 34 | 16 | 3E | 6 G 2 | 3.36 | 3.36 | AF |
| Same | | | | | 4938 | -- | SW | SW | SW | 232 | 4762 | 34 | 16 | 3E | 1 B 2 | | | |
| Same | | | | | 4582 | -- | SE | SW | SW | 119 | 4330 | 34 | 16 | 3E | 3 B 2 | | | |
| A__ 39943 | 00 | STK | NK | G | 2125 | -- | SW | SE | SE | 83 | 1078 | 34 | 16 | 3E | 2 | 9.21 | 9.21 | AF |
| A__ 45019 | 00 | STK | NK | G | 2125 | -- | SW | SE | SE | 83 | 1078 | 34 | 16 | 3E | 2 | 15.62 | 5.31 | AF |
| A__ 47155 | 00 | STK | LR | G* | 1026 | -- | NW | NE | SE | 1995 | 1176 | 34 | 16 | 3E | 7 | 52.17 | 52.17 | AF |

| Total Net Quantities Authorized: | Direct | Storage |
|----------------------------------|--------|---------|
| Total Requested Amount (AF) = | .00 | .00 |
| Total Permitted Amount (AF) = | .00 | .00 |
| Total Inspected Amount (AF) = | 52.17 | .00 |
| Total Pro_Cert Amount (AF) = | .00 | .00 |
| Total Certified Amount (AF) = | 17.87 | .00 |
| Total Vested Amount (AF) = | .00 | .00 |
| TOTAL AMOUNT (AF) = | 70.04 | .00 |

An * after the source of supply indicates a pending application for change for the file number.
 An * after the ID indicates a 15 AF exemption was granted for the file number.
 A "G" in the Batt column indicates the GEO CTR of a battery. A "B" indicates a well in the battery.
 The number in the Batt column is the number of wells in the battery.

Water Rights and Points of Diversion Within 1.50 miles of point defined as:

97.078101 West Longitude and 38.614670 North Latitude

GROUNDWATER ONLY

WATER USE CORRESPONDENTS:

File Number Use ST SR

A__ 39749 00 STK NK G

- > TRACY BRUNNER
- > 1611 100 AVE
- > PO BOX 103
- > RAMONA KS 67475

A__ 39943 00 STK NK G

- > TRACY BRUNNER
- > 1611 100 AVE
- > PO BOX 103
- > RAMONA KS 67475

A__ 45019 00 STK NK G

- > TRACY BRUNNER
- > 1611 100 AVE
- > PO BOX 103
- > RAMONA KS 67475

A__ 47155 00 STK LR G

- > TRACY BRUNNER

> 1611 100 AVE
> PO BOX 103
> RAMONA KS 67475

>-----
=====

AMOUNT STATISTICS REPORT FOR POINTS OF DIVERSION UNDER A 47155 00

#####

AMOUNT STATISTICS REPORT FOR POINTS OF DIVERSION UNDER A 47155 00 STK

Water Right and Points of Diversion Within 2.00 miles of point defined as:

1995 Feet North and 1176 Feet West of the Southeast Corner of Section 34 T 16S R 3E

GROUNDWATER ONLY

```

=====
File Number  Use ST SR Dist (ft) Q4 Q3 Q2 Q1 FeetN FeetW Sec Twp Rng ID Batt Auth_Quan Add_Quan Unit
A__ 39749 00 STK NK G      3830 -- SE SW SW  175 4546 34 16 3E 6 G 2      3.36      3.36 AF
Same          3996 -- SW SW SW  232 4762 34 16 3E 1 B 2
Same          3670 -- SE SW SW  119 4330 34 16 3E 3 B 2
A__ 39943 00 STK NK G      1915 -- SW SE SE   83 1078 34 16 3E 2          9.21      9.21 AF
A__ 45019 00 STK NK G      1915 -- SW SE SE   83 1078 34 16 3E 2          15.62     5.31 AF
A__ 47155 00 STK LR G*      0 -- NW NE SE  1995 1176 34 16 3E 7          52.17     52.17 AF
=====
    
```

```

=====
Total Net Quantities Authorized:  Direct      Storage
Total Requested Amount (AF) =      .00          .00
Total Permitted Amount (AF) =      .00          .00
Total Inspected Amount (AF) =     52.17         .00
Total Pro_Cert Amount (AF) =      .00          .00
Total Certified Amount (AF) =     17.87         .00
Total Vested Amount (AF) =        .00          .00
TOTAL AMOUNT (AF) =      70.04         .00
=====
    
```

An * after the source of supply indicates a pending application for change under the file number.
 An * after the ID indicates a 15 AF exemption was granted under the file number.
 A "G" in the Batt column indicates the GEO CTR of a battery. A "B" indicates a well in the battery.
 The number in the Batt column is the number of wells in the battery.

Water Rights and Points of Diversion Within 2.00 miles of point defined as:

1995 Feet North and 1176 Feet West of the Southeast Corner of Section 34 T 16S R 3E

GROUNDWATER ONLY

WATER USE CORRESPONDENTS:

```

=====
File Number  Use ST SR
A__ 39749 00 STK NK G
> TRACY BRUNNER
> 1611 100 AVE
> PO BOX 103
> RAMONA KS 67475
-----
A__ 39943 00 STK NK G
> TRACY BRUNNER
> 1611 100 AVE
> PO BOX 103
> RAMONA KS 67475
-----
A__ 45019 00 STK NK G
> TRACY BRUNNER
> 1611 100 AVE
> PO BOX 103
> RAMONA KS 67475
-----
    
```

A__ 47155 00 STK LR G

> TRACY BRUNNER

> 1611 100 AVE

> PO BOX 103

> RAMONA KS 67475

>-----

=====

#####

DIVISION OF WATER RESOURCES — KANSAS DEPARTMENT OF AGRICULTURE
FIELD INSPECTION REPORT

Field Office No. 1
 G.M.D. No. 1

Full
 Partial *in compliance*
 Compliance Investigation

Test 1 of 1 diversion points. County Dickinson

File No. 47,155 Inspection Date 3-1-11 Inspector Ahlgvist

Current Landowner: Tracy Brunner Phone No. (785) 965-2228

Address 1611 100 Avenue / P.O. Box 103 Ramona KS 67475
 Additional landowners and addresses identified in remarks section.

Water Use () Domestic () Industrial () Irrigation () Municipal () Hydraulic Dredging
 Classification: () Recreation Stockwatering () Water Power () Artificial Recharge () Contamination Remediation
 Source: Groundwater () Surface Water Basin/Stream Smoky Hill

Authorized Point of Diversion: NW NE SE Sec. 34 T. 16 R. 3E ID No. 07
 Approximately 1995 ft. North and 1176 ft. West of SE corner of Sec. 34

Actual Point of Diversion: as authorized Sec. 34 T. 16 R. 3E
 Approximately _____ ft. North and _____ ft. West of SE corner of Sec. 34

How were distances determined? G.P.S. 38.61467 N 97.08169 W
 "Approved" Quantity 17.0 mgy 52.17 AF AF "Approved" Diversion Rate 35 g.p.m. (.08 c.f.s.)

Priority Date 9-25-08 Approval Date 11-18-09 Perfection Date 12-31-2014

Other applications covering land and/or point of diversion 39,749 ; 39,443^{PM}, 45,019^{PM}
 (include discussion of overlapping files in remarks section) used for stockwatering purposes in the Southwest Quarter (SW 1/4) of Section 34, in township 16 South, Range 3 East, Dickinson County, Kansas.

LAND TO BE INCLUDED ON CERTIFICATE:

| S | T | R | NE 1/4 | | | | NW 1/4 | | | | SW 1/4 | | | | SE 1/4 | | | | TOTAL ACRES | |
|---|---|---|--------|----|----|----|--------|----|----|----|--------|----|----|----|--------|----|----|----|-------------|--|
| | | | NE | NW | SW | SE | NE | NW | SW | SE | NE | NW | SW | SE | NE | NW | SW | SE | | |
| | | | | | | | | | | | | | | | | | | | | |
| | | | | | | | | | | | | | | | | | | | | |
| | | | | | | | | | | | | | | | | | | | | |

LAND IRRIGATED — YEAR OF RECORD

| S | T | R | NE 1/4 | | | | NW 1/4 | | | | SW 1/4 | | | | SE 1/4 | | | | TOTAL ACRES | |
|---|---|---|--------|----|----|----|--------|----|----|----|--------|----|----|----|--------|----|----|----|-------------|--|
| | | | NE | NW | SW | SE | NE | NW | SW | SE | NE | NW | SW | SE | NE | NW | SW | SE | | |
| | | | | | | | | | | | | | | | | | | | | |
| | | | | | | | | | | | | | | | | | | | | |
| | | | | | | | | | | | | | | | | | | | | |

TESTED DIVERSION RATES
 Maximum G.P.M. 29.24 (c.f.s. 0.00) Normal G.P.M. 29.24 (c.f.s. 0.00)

FOR D.W.R. USE ONLY

Year of Record _____ Extension of time needed: Yes No Attached? Yes No
 AF Applied = _____ hrs. x _____ g.p.m. x $\frac{4.419}{24 \times 1000}$ = _____ AF
 "Approved" land irrigated _____ acres, with _____ AF = _____ AF/acre

WATER RESOURCES RECEIVED

Perfected Rate _____ g.p.m. (_____ c.f.s.) MAR 09 2011 quantity _____ AF

AMOUNT STATISTICS REPORT FOR POINTS OF DIVERSION UNDER A 47155 00

- UPDATED -

#####

AMOUNT STATISTICS REPORT FOR POINTS OF DIVERSION UNDER A 47155 00 STK

Water Right and Points of Diversion Within 2.00 miles of point defined as:

1995 Feet North and 1176 Feet West of the Southeast Corner of Section 34 T 16S R 3E

GROUNDWATER ONLY

| File Number | Use | ST | SR | Dist (ft) | Q4 | Q3 | Q2 | Q1 | FeetN | FeetW | Sec | Twp | Rng | ID | Auth | Quan | Add | Quan | Unit |
|-------------|-----|----|----|-----------|----|----|----|----|-------|-------|-----|-----|-----|----|------|-------|-------|------|------|
| A_ 39749 00 | STK | NK | G | (WR) 3996 | -- | SW | SW | SW | 232 | 4762 | 34 | 16 | 3E | 1 | | 3.36 | 3.36 | | AF |
| Same | | | | 3670 | -- | SE | SW | SW | 119 | 4330 | 34 | 16 | 3E | 3 | | | | | |
| Same | | | | 3830 | -- | SE | SW | SW | 175 | 4546 | 34 | 16 | 3E | 6 | | | | | |
| A_ 39943 00 | STK | NK | G | (WR) 1915 | -- | SW | SE | SE | 83 | 1078 | 34 | 16 | 3E | 2 | | 9.21 | 9.21 | | AF |
| A_ 45019 00 | STK | NK | G | (WR) 1915 | -- | SW | SE | SE | 83 | 1078 | 34 | 16 | 3E | 2 | | 15.62 | 5.31 | | AF |
| A_ 47155 00 | STK | AY | G | 0 | -- | NW | NE | SE | 1995 | 1176 | 34 | 16 | 3E | 7 | | 52.17 | 52.17 | | AF |

VOK
Spacing
Non-Dom
1,320 f

| Total Net Quantities Authorized: | Direct | Storage |
|----------------------------------|--------|---------|
| Total Requested Amount (AF) = | 52.17 | .00 |
| Total Permitted Amount (AF) = | .00 | .00 |
| Total Inspected Amount (AF) = | .00 | .00 |
| Total Pro_Cert Amount (AF) = | .00 | .00 |
| Total Certified Amount (AF) = | 17.87 | .00 |
| Total Vested Amount (AF) = | .00 | .00 |
| TOTAL AMOUNT (AF) = | 70.04 | .00 |

An * after the source of supply indicates a pending application for change under the file number

Water Rights and Points of Diversion Within 2.00 miles of point defined as:

1995 Feet North and 1176 Feet West of the Southeast Corner of Section 34 T 16S R 3E

GROUNDWATER ONLY

WATER USE CORRESPONDENTS:

| File Number | Use | ST | SR |
|-------------|-----------------|----|----|
| A_ 39749 00 | STK | NK | G |
| > | TRACY BRUNNER | | |
| > | 1611 100 AVE | | |
| > | PO BOX 103 | | |
| > | RAMONA KS 67475 | | |
| A_ 39943 00 | STK | NK | G |
| > | TRACY BRUNNER | | |
| > | 1611 100 AVE | | |
| > | PO BOX 103 | | |
| > | RAMONA KS 67475 | | |
| A_ 45019 00 | STK | NK | G |
| > | TRACY BRUNNER | | |
| > | 1611 100 AVE | | |
| > | PO BOX 103 | | |
| > | RAMONA KS 67475 | | |
| A_ 47155 00 | STK | AY | G |
| > | TRACY BRUNNER | | |
| > | 1611 100 AVE | | |
| > | PO BOX 103 | | |

Quantity - PU overlaps:
Auth / Add. (mgd)

39749: 1.094 / 1.094

39943: 3.0 / 3.0

45019: 5.091 / 1.73

Current TOTAL 9.185 / 5.824 mgd

+ 17 / 17 # 47155

Proposed (Future) 26.185 / 22.824 mgd
Auth. / Add.

end

Water Right Number, 47155-00, With A 2 Mile Buffer

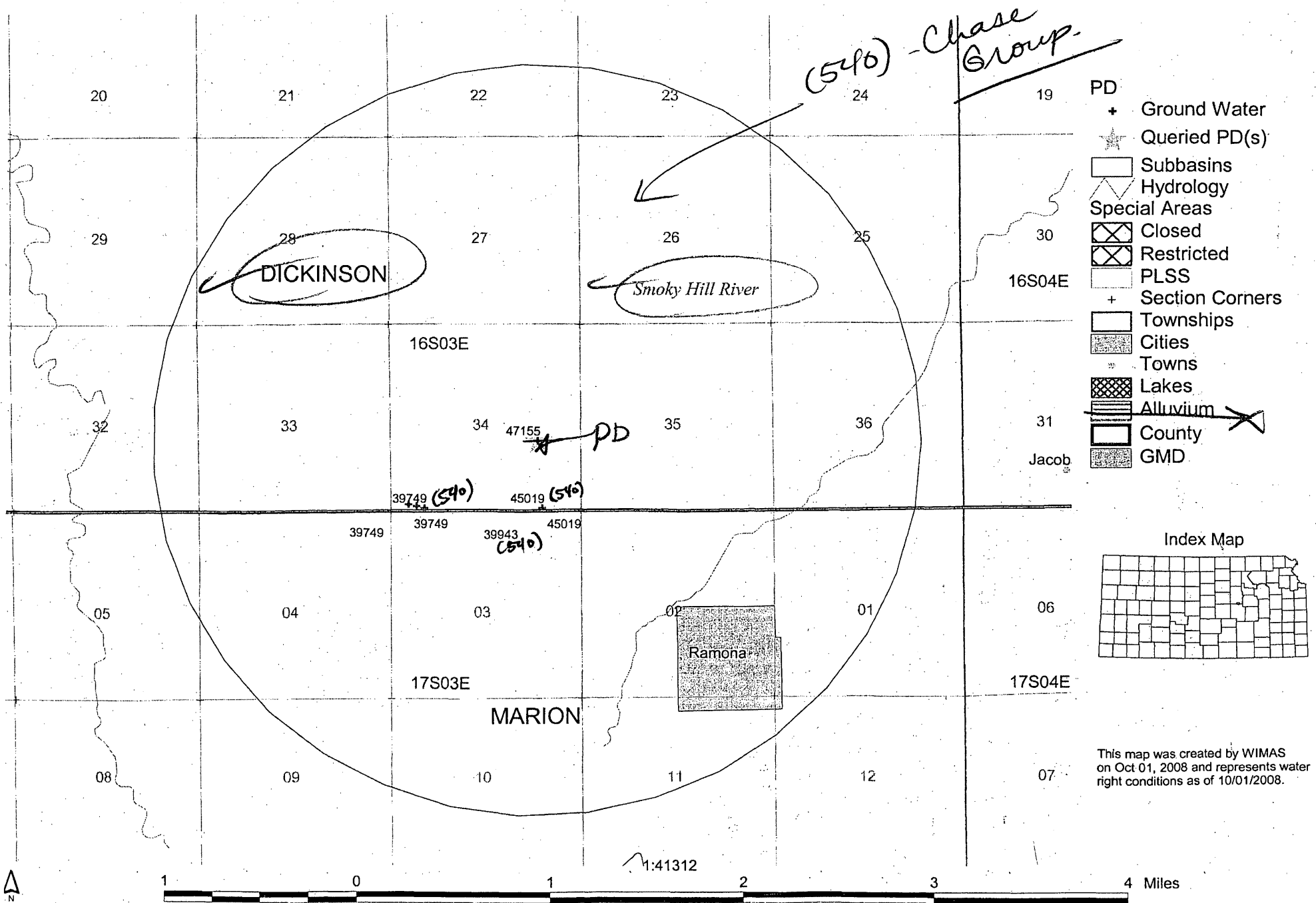

Safe Yield Report Sheet.
 Water Right Number, 47155-00, With A 2 Mile Buffer.
 Point of Diversion located in 34-16S-3E 7.

6010

Analysis Results

The selected PD is in an area OPEN to new appropriations.
 The safe yield, based on the variables listed below, is 2037.43 AF.
 Total prior appropriations in the circle is 70.04 AF.
 Total quantity of water available for appropriation is 1967.38 AF.

SY
 52.17 = 17.87 = PRIOR
 + 52.17 = 2019.56 = AVAIL.

Safe Yield Variables

The area used for the analysis is set at 8042 acres.
 The potential annual recharge of the area is estimated to be 3.04 inches.
 The percent of calculated recharge available for appropriation is 100 %.

Authorized Quantity values are as of 11/02/2009 and are based on Appropriated and Vested ground water rights and possible stream nodes for GMDs. Domestic, Term and Temporary water rights have been excluded.

There are 4 water right(s) and 5 point(s) of diversion within the circle.

| File Number | Use | ST | SR | Q4 | Q3 | Q2 | Q1 | FeetN | FeetW | Sec | Twp | Rng | ID | Qind | Auth_Quant | Add_Quant | Tacres | Nacres |
|-------------|-----|----|----|----|----|----|----|-------|-------|-----|-----|-----|----|------|------------|-----------|--------|--------|
| A 39749 00 | STK | NK | G | | SE | SW | SW | 119 | 4330 | 34 | 16 | 3E | 3 | WR | 3.36 | 3.36 | 0.00 | 0.00 |
| Same | | | | | SE | SW | SW | 175 | 4546 | 34 | 16 | 3E | 6 | | | | | |
| Same | | | | | SW | SW | SW | 232 | 4762 | 34 | 16 | 3E | 1 | | | | | |
| A 39943 00 | STK | NK | G | | SW | SE | SE | 83 | 1078 | 34 | 16 | 3E | 2 | WR | 9.21 | 9.21 | 0.00 | 0.00 |
| A 45019 00 | STK | NK | G | | SW | SE | SE | 83 | 1078 | 34 | 16 | 3E | 2 | WR | 15.62 | 5.31 | 0.00 | 0.00 |
| A 47155 00 | STK | AY | G | | NW | NE | SE | 1995 | 1176 | 34 | 16 | 3E | 7 | WR | 52.17 | 52.17 | 0.00 | 0.00 |

Water Right Number, 47155-00, With A 0.5 Mile Buffer

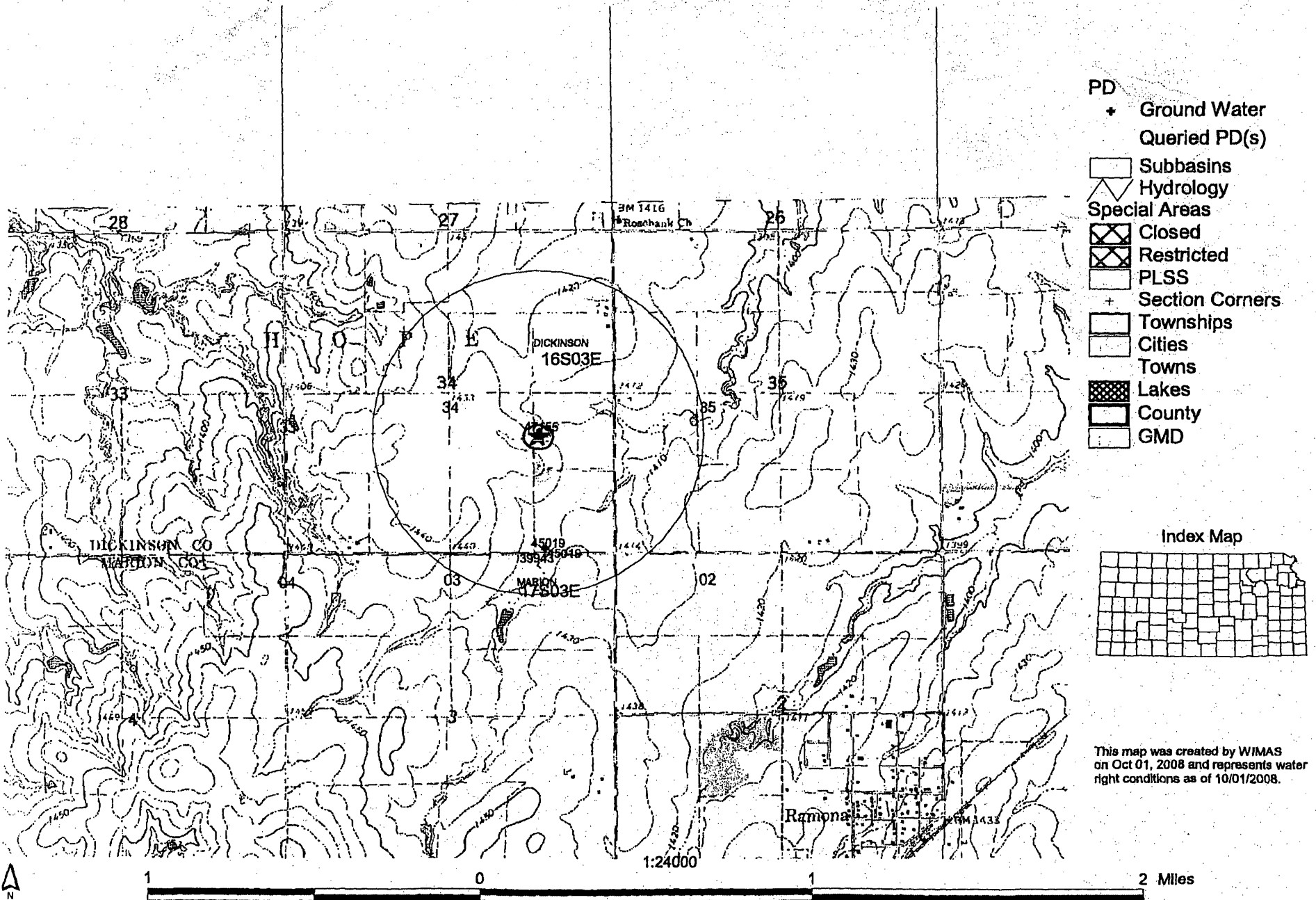

NOT THE PROPOSED WELL UNDO 7/17/18
 PROPOSED WELL (ALL WELLS) FILE NO. 47,155

WATER WELL RECORD

Form WWC-5

Division of Water Resources; App. No. _____

1 **LOCATION OF WATER WELL:**
 County: Dickinson Fraction: Ne 1/4 Ne 1/4 Sec 1/4 Section Number: 34 Township Number: T 16 S Range Number: R 3 E

Distance and direction from nearest town or city street address of well if located within city?
2 N 13 W Ramona
Global Positioning Systems (decimal degrees, min. of 4 digits)
 Latitude: _____
 Longitude: _____
 Elevation: _____
 Datum: _____
 Data Collection Method: _____

2 **WATER WELL OWNER:** Kenny Stroda
 RR#, St. Address, Box # : 177 Oak Rd
 City, State, ZIP Code : Ramona, Ke. 67475

3 **LOCATE WELL'S LOCATION WITH AN "X" IN SECTION BOX:**
 N

| | |
|----------|----------|
| -- NW -- | -- NE -- |
| -- SW -- | -- SE -- |

 E
 S

4 **DEPTH OF COMPLETED WELL** ft.
 Depth(s) Groundwater Encountered (1) 77.64 ft. (2) 77 ft. (3) ft.
 WELL'S STATIC WATER LEVEL ft. below land surface measured on mo/day/yr. 11-28-07
 Pump test data: Well water was ft. after hours pumping gpm
 Est. Yield... 40 gpm: Well water was ft. after hours pumping gpm
 WELL WATER TO BE USED AS: 5 Public water supply 8 Air conditioning 11 Injection well
 1 Domestic 3 Feedlot 6 Oil field water supply 9 Dewatering 12 Other (Specify below)
 2 Irrigation 4 Industrial 7 Domestic (lawn & garden) 10 Monitoring well Cattle
 Was a chemical/bacteriological sample submitted to Department? Yes No (X); If yes, mo/day/yr
 Sample was submitted Water well disinfected? Yes (X) No

5 **TYPE OF CASING USED:** 5 Wrought Iron 8 Concrete tile CASING JOINTS: Glued... (X) Clamped.....
 1 Steel 3 RMP (SR) 6 Asbestos-Cement 9 Other (specify below) Welded.....
 2 PVC 4 ABS 7 Fiberglass Threaded.....
 Blank casing diameter 5 in. to ft., Diameter in. to ft., Diameter in. to ft.
 Casing height above land surface 18 in., Weight SDR 26 lbs./ft. Wall thickness or guage No. : 214
TYPE OF SCREEN OR PERFORATION MATERIAL:
 1 Steel 3 Stainless Steel 5 Fiberglass 7 PVC 9 ABS 11 Other (Specify)
 2 Brass 4 Galvanized Steel 6 Concrete tile 8 RM (SR) 10 Asbestos-Cement 12 None used (open hole)
SCREEN OR PERFORATION OPENINGS ARE:
 1 Continuous slot 3 Mill slot 5 Gauzed wrapped 7 Torch cut 9 Drilled holes 11 None (open hole)
 2 Louvered shutter 4 Key punched 6 Wire wrapped 8 Saw Cut 10 Other (specify)
SCREEN-PERFORATED INTERVALS: From 60 ft. to 86 ft., From ft. to ft.
GRAVEL PACK INTERVALS: From 20 ft. to 86 ft., From ft. to ft.

6 **GROUT MATERIAL:** 1 Neat cement 2 Cement grout 3 Bentonite 4 Other
 Grout Intervals: From 0 ft. to 20 ft., From ft. to ft., From ft. to ft.
 What is the nearest source of possible contamination:
 1 Septic tank 4 Lateral lines 7 Pit privy 10 Livestock pens 13 Insecticide Storage 16 Other (specify below)
 2 Sewer lines 5 Cess pool 8 Sewage lagoon 11 Fuel storage 14 Abandoned water well
 3 Watertight sewer lines 6 Seepage pit 9 Feedyard 12 Fertilizer Storage 15 Oil well/gas well
 Direction from well? W How many feet? 300 +

| FROM | TO | LITHOLOGIC LOG | FROM | TO | PLUGGING INTERVALS |
|------|----|---------------------------|------|----|--------------------|
| 0 | 52 | Yellow Clay - mixed Shale | | | |
| 52 | 63 | Blue Shale | | | |
| 63 | 64 | some water | | | |
| 64 | 77 | Blue Shale | | | |
| 77 | 79 | Crumbled Shale - water | | | |
| 79 | 86 | Gray Shale | | | |

7 **CONTRACTOR'S OR LANDOWNER'S CERTIFICATION:** This water well was (1) constructed, (2) reconstructed, or (3) plugged under my jurisdiction and was completed on (mo/day/year) 11-28-07 and this record is true to the best of my knowledge and belief. Kansas Water Well Contractor's License No. 180 This Water Well Record was completed on (mo/day/year) 12-19-07 under the business name of Barckhus Drilling by (signature) Saul H. Barckhus

INSTRUCTIONS: Use typewriter or ball point pen. PLEASE PRESS FIRMLY and PRINT clearly. Please fill in blanks, underline or circle the correct answers. Send top three copies to Kansas Department of Health and Environment, Bureau of Water, Geology Section, 1000 SW Jackson St., Suite 420, Topeka, Kansas 66612-1367. Telephone 785-296-5522. Send one to WATER WELL OWNER and retain one for your records. Fee of \$5.00 for each constructed well. Visit us at <http://www.kdheks.gov/waterwell/index.html>.

47155

1 LOCATION OF WATER WELL: Fraction Ne 1/4 Sec 7 NW 1/4 Section Number 34 Township Number T 10 S Range Number R 3 E
 County Dickinson

Distance and direction from nearest town or city street address of well if located within city?
1 W 1 1/2 N Ramona

2 WATER WELL OWNER Cow Camp Ranch
 RR#, St. Address, Box # RR1 Board of Agriculture, Division of Water Resource
 City, State, ZIP Code Ramona, KS 67475 Application Number:

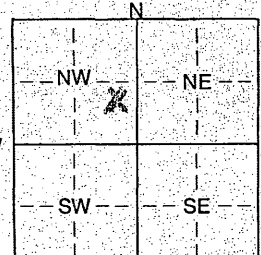
3 LOCATE WELL'S LOCATION WITH AN "X" IN SECTION BOX:

 4 DEPTH OF COMPLETED WELL 90 ft. ELEVATION:
 Depth(s) Groundwater Encountered 1. 32 ft. 2. 41 ft. 3. 2-1-02 ft.
 WELL'S STATIC WATER LEVEL 41 ft. below land surface measured on mo/day/yr 2-1-02
 Pump test data: Well water was _____ ft. after _____ hours pumping _____ gpm
 Est. Yield 30-40 gpm: Well water was _____ ft. after _____ hours pumping _____ gpm
 Bore Hole Diameter 4 in. to 40 ft. and _____ in. to _____ ft.
 WELL WATER TO BE USED AS: 5 Public water supply 8 Air conditioning 11 Injection well
1 Domestic 3 Feedlot 6 Oil field water supply 9 Dewatering 12 Other (Specify below)
 2 Irrigation 4 Industrial 7 Domestic (lawn & garden) 10 Monitoring well
 Was a chemical/bacteriological sample submitted to Department? Yes _____ No X; If yes, mo/day/yr sample was submitted
 Water Well Disinfected? Yes X No _____

5 TYPE OF BLANK CASING USED:
 1 Steel 3 RMP (SR) 6 Asbestos-Cement 9 Other (specify below)
 2 PVC 4 ABS 7 Fiberglass
 Blank casing diameter 5 in. to 70 ft. Dia _____ in. to _____ ft. Dia _____ in. to _____ ft.
 Casing height above land surface 20 in., weight Class 160 lbs./ft. Wall thickness or gauge No. 214
 TYPE OF SCREEN OR PERFORATION MATERIAL:
 1 Steel 3 Stainless steel 5 Fiberglass 8 RMP (SR) 10 Asbestos-cement
 2 Brass 4 Galvanized steel 6 Concrete tile 9 ABS 11 Other (specify) _____
 12 None used (open hole)
 SCREEN OR PERFORATION OPENINGS ARE:
 1 Continuous slot 3 Mill slot 5 Gauzed wrapped 8 Saw cut 11 None (open hole)
 2 Louvered shutter 4 Key punched 6 Wire wrapped 9 Drilled holes
 7 Torch cut 10 Other (specify) _____
 SCREEN-PERFORATED INTERVALS: From _____ ft. to _____ ft. From _____ ft. to _____ ft.
 GRAVEL PACK INTERVALS: From 20 ft. to 90 ft. From _____ ft. to _____ ft.

6 GROUT MATERIAL: 1 Neat cement 2 Cement grout 3 Bentonite 4 Other _____
 Grout Intervals: From 0 ft. to 20 ft. From _____ ft. to _____ ft. From _____ ft. to _____ ft.
 What is the nearest source of possible contamination:
 1 Septic tank 4 Lateral lines 7 Pit privy 10 Livestock pens 14 Abandoned water well
 2 Sewer lines 5 Cess pool 8 Sewage lagoon 11 Fuel storage 15 Oil well/Gas well
 3 Watertight sewer lines 6 Seepage pit 9 Feedyard 12 Fertilizer storage 16 Other (specify below) _____
 13 Insecticide storage
 Direction from well? SW How many feet? 4 mi

| FROM | TO | LITHOLOGIC LOG | FROM | TO | PLUGGING INTERVALS |
|------|----|-------------------------|------|----|--------------------|
| 0 | 40 | Yellow Clay mixed Shale | | | |
| 40 | 43 | Lime | | | |
| 43 | 55 | Yellow Clay | | | |
| 55 | 60 | Gray Clay | | | |
| 60 | 82 | Yellow Shale | | | |
| 82 | 83 | Water | | | |
| 83 | 90 | Gray Shale | | | |

7 CONTRACTOR'S OR LANDOWNER'S CERTIFICATION: This water well was (1) constructed (2) reconstructed; or (3) plugged under my jurisdiction and was completed on (mo/day/year) 2-1-02 and this record is true to the best of my knowledge and belief. Kansas Water Well Contractor's Licence No. 100 This Water Well Record was completed on (mo/day/yr) 2-11-02 under the business name of Backhus Drilling by (signature) Steve M. Backhus

INSTRUCTIONS: Use typewriter or ball point pen. PLEASE PRESS FIRMLY and PRINT clearly. Please fill in blanks, underline or circle the correct answers. Send top three copies to Kansas Department of Health and Environment, Bureau of Water, Topeka, Kansas 66620-0001. Telephone 785-296-5524. Send one to WATER WELL OWNER and retain one for your records. Fee of \$5.00 for each constructed well.

SCANNED

Dickinson County Property Data

General Information

Thursday September 13 2018 3:41:04 PM

Subject Property

[Print](#)

Parcel ID : 0212583400000005000

[Click here to locate on Map](#)

Name : BRUNNER, LAUREN W TRUST

[Property Record Card](#)

Location : 1600 BLK 100 AVE, Hope, KS 67451

Legal Desc : S34, T16, R03, SE4 SW4, LESS R/W.

-Office-

The information displayed here was collected for assessment purposes only

The owner names and legal descriptions provided are not adequate for use in legal documents

Owner Information

Name :

Mailing Address :

BRUNNER, LAUREN W TRUST

C/O: BRUNNER, KENT 3559 UPLAND RD
LOST SPRINGS, KS 66859

BRUNNER, ANNA ORVELL TRUST

C/O: BRUNNER, KENT 3559 UPLAND RD
LOST SPRINGS, KS 66859

Property Details

| | | | |
|------------------|-------------------|---------------|---------------------|
| Property Type : | Property Status : | Taxing Unit : | Neighborhood Code : |
| Agricultural Use | Active | 152 | 016 |

Market Land Details

| | | | | |
|----------------|-------------|-------------|---------|---------------|
| Actual Width : | Eff Width : | Eff Depth : | Acres : | Square Feet : |
|----------------|-------------|-------------|---------|---------------|

No Permit Details found.

Value Details

Year : 2018
 Land : \$21,320
 Building : \$0
 Total : \$21,320

No Information Available

Book/Page Historical

Document List:

Z302/833 Z300/681 D228/969 D228/967

No Sale Details found. (Please log in to view this data.)

Dickinson County Property Data

General Information

Thursday September 13 2018 3:42:17 PM

Subject Property

Print

Parcel ID : 0212583400000004000

[Click here to locate on Map](#)

Name : BRUNNER, LAUREN W TRUST

[Property Record Card](#)

Location : 1617 100 AVE, Ramona, KS 67475

Legal Desc : S34, T16, R03, SW4, EXC SE4 SW4, LESS R/W.

The information displayed here was collected for assessment purposes only

The owner names and legal descriptions provided are not adequate for use in legal documents

Owner Information

Name :

Mailing Address :

BRUNNER, LAUREN W TRUST

C/O: BRUNNER, KENT 3559 UPLAND RD
LOST SPRINGS, KS 66859

BRUNNER, ANNA ORVELL TRUST

C/O: BRUNNER, KENT 3559 UPLAND RD
LOST SPRINGS, KS 66859

Property Details

Property Type :

Property Status :

Taxing Unit :

Neighborhood Code :

Farm Homesite

Active

153

016

Market Land Details

Actual Width : Eff Width :

Eff Depth :

Acres :

Square Feet :

1.2

Actual Width : Eff Width :

Eff Depth :

Acres :

Square Feet :

96

Permit Details

Number :

Date :

Amount :

Purpose :

00074

9/18/2001

\$0

API

DK23-11

5/3/2011

\$250,000

Grain Storage

Value Details

Year : 2018

Land : \$15,000

Building : \$80,440

Total : \$95,440

Year : 2018

Land : \$8,100

Building : \$42,840

Total : \$50,940

CONFIRMED
EA

Year : 2018
Land : \$14,400
Building : \$52,250
Total : \$66,650

Book/Page Current Listing

| Date : | Book : | Page : | Other Doc : |
|----------|--------|--------|-------------|
| 6/1/2005 | | | |

Book/Page Historical

Document List:

Z302/833 Z300/681 D228/969 D228/967

No Sale Details found. (Please log in to view this data.)

STATE OF KANSAS

DEPARTMENT OF AGRICULTURE
1320 RESEARCH PARK DRIVE
MANHATTAN, KS 66502
PHONE: (785) 564-6700
FAX: (785) 564-6777



900 SW JACKSON, ROOM 456
TOPEKA, KS 66612
PHONE: (785) 296-3556
www.agriculture.ks.gov

GOVERNOR JEFF COLYER, M.D.
JACKIE McCLASKEY, SECRETARY OF AGRICULTURE

TRACY BRUNNER
1611 100 AVE PO BOX 103
RAMONA, KS 67475

August 31, 2018

RE: File No 47155

Dear Sir or Madam:

An application for approval of the Chief Engineer to change the following condition or conditions of the file number referred to above has been received:

- place of use PD
- point of diversion
- use made of water

As a matter of record, the Division of Water Resources has on hand a large number of applications awaiting processing. Therefore, to be fair to all concerned, and so that we can process those applications on hand in the order they were received, we intend to concentrate on the backlog of applications until the issue is resolved. You will be contacted regarding this application as soon as it has been examined.

In accordance with the provisions of the Kansas Water Appropriation Act, a portion of which is included below, the use of water prior to approval of the application is unlawful. You should not proceed and divert water as indicated by your plans in your application for a change for this file until you receive approval for this change from the Chief Engineer. Once approved, compliance with the terms, conditions and limitations of the permit is necessary. Conservation of the water resources of Kansas is required.

Section 82a-728 of the Kansas Water Appropriation Act, provides (a) except for the appropriation of water for the purpose of domestic use, . . . it shall be unlawful for any person to appropriate or threaten to appropriate water from any source without first applying for and obtaining a permit to appropriate water in accordance with the provisions of the Water Appropriation Act or for any person to violate any condition of a vested right, appropriation right or an approved application for a permit to appropriate water for beneficial use.

(b) (1) The violation of any provision of this section by any person is a class C misdemeanor...

A class C misdemeanor is punishable by a fine not to exceed \$500 and/or a term of confinement not to exceed one month in the county jail. Each day that the violation occurs constitutes a separate offense.

If you have any questions, please contact me at (785) 564-6645. If you wish to discuss a specific file, please have the file number ready so that we may help you more efficiently.

Sincerely,

Brent Tournay, L.G.
Change Applications Unit Supervisor
Water Appropriation Program

BAT: DLW
pc: TOPEKA Field Office GMD

SCANNED

1/10/2014
J. G. G.

IN FORMS WITH -
NEED TO PUT THIS
35 gpm total. Also
WELL AND NOT TO EXCEED
THAN 20 gpm PER
APPROVAL TO NO MORE
SURE WE LEAD
WE USED TO MAKE
AS PER KAR (5-3-1(D)(1)).
Treated with APPROVAL

LES/IE

5-3-1(D)(1)
APPROVAL
WELL
THAN 20 gpm PER
APPROVAL TO NO MORE
SURE WE LEAD
WE USED TO MAKE
AS PER KAR (5-3-1(D)(1)).
Treated with APPROVAL

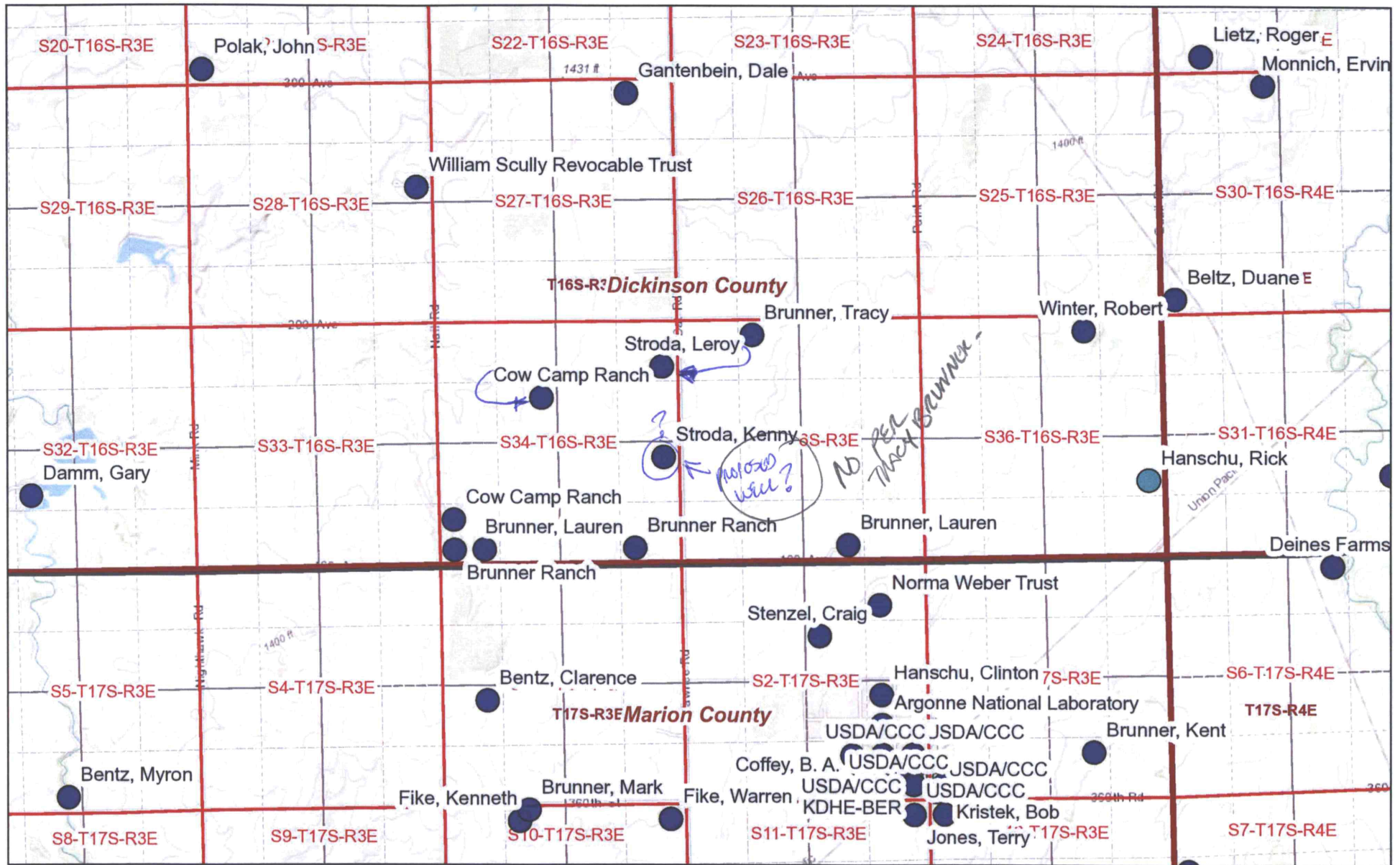

- Constructed
- Reconstructed
- Plugged

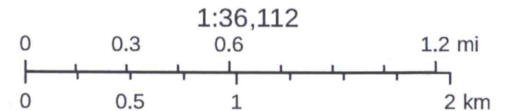

Sources: Esri, HERE, Garmin, Intermap, increment P Corp., GEBCO, USGS, FAO, NPS, NRCAN, GeoBase, IGN, Kadaster NL, Ordnance Survey, Esri

2/4/18 - LI/DWR

TRACY BRUNNER - FILE NO. 47,155
 CHANGE IN POINT OF DIVERSION MAP
 SEC. 34, T16S, R3E



Domestic Well
 Leroy F Stroda Trust
 PO Box 202
 Hope KS 67451-0202

File No. 47,155 - STK Well
 Authorized Point of Diversion
 1,995' N & 1,176' W

1/4 mile radius circle

Proposed Points of Diversion -
 New Well - 1,995' N & 150' W
 Existing STK Well - 1,995' N & 1176' W

File Nos. 39,943 & 45,019 - STK Well
 Owned by Applicant

Southeast Corner of Section 34
 Township 16 South
 Range 3 East

Copyright © 2013 National Geographic Society, Inc.

1:12,000

- Proposed Points of Diversion
- Water Resources
- Authorized Parcel

All known wells within 1/2 mile of the proposed point of diversion are shown on this map.

Tracy Brunner

AUG 30 2018

KS Dept Of Agriculture

SCANNED

TRACY BRUNNER - FILE NO. 47,155
 CHANGE IN POINT OF DIVERSION MAP
 SEC. 34, T16S, R3E



1:12,000

- Proposed Points of Diversion
- Water Resources
- Authorized Place of Use

All known wells within 1/2 mile of the proposed point of diversion are shown on this map.

Tracy Brunner

AUG 30 2018

KS Dept Of Agriculture

SCANNED