

Kansas Department of Agriculture  
 Division of Water Resources  
**CHANGE: P/D WORKSHEET**

|  |  |   |                               |  |
|--|--|---|-------------------------------|--|
| 1. File Number:<br><b>50,004</b>   | 2. Status Change Date:<br><b>6/10/2019</b> | 3. Change Num:<br><b>C1</b>   | 4. Field Office:<br><b>01</b> | 5. GMD:                                    |
| 6. Status: <input checked="" type="checkbox"/> Approved <input type="checkbox"/> Denied by DWR/GMD <input type="checkbox"/> Dismiss by Request/Failure to Return   |  |   |                               | 7. Filing Date of Change:<br><b>6/4/19</b> |
| 8a. Applicant(s)<br>New to system <input type="checkbox"/><br><br><b>SCOTT AND LYNETTE HILL<br/>1209 3300 AVE<br/>ABILENE KS 67410</b><br><br><b>**NOTE NAME CHANGE**</b>  |  | 8c. Landowner(s)<br>New to system <input type="checkbox"/><br><br>Person ID <u>41266</u><br>Add Seq# <u>1</u> |                               |  |
| 8b. Landowner(s)<br>New to system <input type="checkbox"/><br><br><b>8A.</b>   |  | 8d. WUC<br>New to system <input type="checkbox"/><br><br><b>8a.</b>   |                               |  |
| 9. Documents and Enclosure(s): <input checked="" type="checkbox"/> DWR Meter(s) Date to Comply: <u>12/31/19</u> <input checked="" type="checkbox"/> N & P Date to Comply: <u>12/31/19</u>  |  |   |                               |  |
| <input type="checkbox"/> Anti-Reverse Meter <input type="checkbox"/> Meter Seal <input type="checkbox"/> Check Valve <input checked="" type="checkbox"/> N & P Form <input type="checkbox"/> Water Tube <input type="checkbox"/> Driller Copy <input type="checkbox"/> H & E Letter<br><input type="checkbox"/> Conservation Plan    Date Required: _____    Date Approved: _____    Date to Comply: _____ |  |   |                               |  |
| 10. Use Made of Water    From: _____    To: _____  |  |   |                               |  |
| Date Prepared: <b>6/7/19</b> By: <b>LHH/TFO</b><br>Date Entered:    By:  |  |   |                               |  |

File No. **50,004**      11. County: **DICKINSON**      Basin: **Smoky Hill**      Stream:      Formation Code: **540**      Special Use:

| 12. Points of Diversion |     |     |      |                 |           |            |           |          |             |             | Rate and Quantity        |                                   |          |         |          |                  |
|-------------------------|-----|-----|------|-----------------|-----------|------------|-----------|----------|-------------|-------------|--------------------------|-----------------------------------|----------|---------|----------|------------------|
| CHK                     | MOD | DEL | PDIV | Qualifier       | S         | T          | R         | ID       | 'N          | 'W          | Comment (AKA Line)       | Rate                              | Quantity | Rate    | Quantity | Overlap PD Files |
| ENT                     |     |     |      |                 |           |            |           |          |             |             |                          | gpm/cfs                           | af/mgy   | gpm/cfs | af/mgy   |                  |
| <b>CHK 86627</b>        |     |     |      | <b>NE SW SE</b> | <b>24</b> | <b>11S</b> | <b>2E</b> | <b>4</b> | <b>1244</b> | <b>1559</b> | <b>BATT 1 of 2 Wells</b> |                                   |          |         |          | <b>None</b>      |
| <b>ENT</b>              |     |     |      | <b>SE NW SE</b> | <b>24</b> | <b>11S</b> | <b>2E</b> |          | <b>1421</b> | <b>1382</b> | <b>BATT 1 of 2 Wells</b> |                                   |          |         |          | <b>None</b>      |
| <b>ENT</b>              |     |     |      | <b>SE NW SE</b> | <b>24</b> | <b>11S</b> | <b>2E</b> |          | <b>1333</b> | <b>1471</b> | <b>GEOCTR</b>            | <b>reduced to: 800 gpm 378 AF</b> |          |         |          | <b>None</b>      |

13. Storage: Rate \_\_\_\_\_ NF      Quantity \_\_\_\_\_ ac/ft      Additional Rate \_\_\_\_\_ NF      Additional Quantity \_\_\_\_\_ ac/ft

14. Limitation: \_\_\_\_\_ af/yr at \_\_\_\_\_ gpm ( \_\_\_\_\_ cfs) when combined with file number(s) \_\_\_\_\_  
 Limitation: \_\_\_\_\_ af/yr at \_\_\_\_\_ gpm ( \_\_\_\_\_ cfs) when combined with file number(s) \_\_\_\_\_

15. 5YR Allocation:    Allocation Type \_\_\_\_\_    Start Year \_\_\_\_\_    5 YR Amount \_\_\_\_\_    Amount Unit \_\_\_\_\_    Base Acres \_\_\_\_\_    Comment \_\_\_\_\_

| 16. Place of Use |     |     |     |      |   |   |   |    |         |         |         |         |         |         |         |         |         |         | Total   | Owner   | Chg?    | Overlap Files |         |         |  |  |  |  |  |
|------------------|-----|-----|-----|------|---|---|---|----|---------|---------|---------|---------|---------|---------|---------|---------|---------|---------|---------|---------|---------|---------------|---------|---------|--|--|--|--|--|
| CHK              | MOD | DEL | ENT | PUSE | S | T | R | ID | NE¼     |         |         |         | NW¼     |         |         |         | SW¼     |         |         |         | SE¼     |               |         |         |  |  |  |  |  |
|                  |     |     |     |      |   |   |   |    | NE<br>¼ | NW<br>¼ | SW<br>¼ | SE<br>¼ | NE<br>¼ | NW<br>¼ | SW<br>¼ | SE<br>¼ | NE<br>¼ | NW<br>¼ | SW<br>¼ | SE<br>¼ | NE<br>¼ | NW<br>¼       | SW<br>¼ | SE<br>¼ |  |  |  |  |  |
| <b>CHK 68772</b> |     |     |     |      |   |   |   |    |         |         |         |         |         |         |         |         |         |         |         |         |         |               |         |         |  |  |  |  |  |
|                  |     |     |     |      |   |   |   |    |         |         |         |         |         |         |         |         |         |         |         |         |         |               |         |         |  |  |  |  |  |
|                  |     |     |     |      |   |   |   |    |         |         |         |         |         |         |         |         |         |         |         |         |         |               |         |         |  |  |  |  |  |
|                  |     |     |     |      |   |   |   |    |         |         |         |         |         |         |         |         |         |         |         |         |         |               |         |         |  |  |  |  |  |
|                  |     |     |     |      |   |   |   |    |         |         |         |         |         |         |         |         |         |         |         |         |         |               |         |         |  |  |  |  |  |
|                  |     |     |     |      |   |   |   |    |         |         |         |         |         |         |         |         |         |         |         |         |         |               |         |         |  |  |  |  |  |

Base Acres:      Year:      Minimum Reasonable Quantity:  
 Comments:

Topeka Field Office  
6531 SE Forbes Ave., Suite B  
Topeka, KS 66619



Phone: 785-296-5733  
Fax: 785-296-8298  
[www.agriculture.ks.gov](http://www.agriculture.ks.gov)

Mike Beam, Secretary

Laura Kelly, Governor

June 11, 2019

SCOTT AND LYNETTE HILL  
1209 3300 AVE  
ABILENE KS 67410

Re: Appropriation of Water, File No. 50,004

Dear Mr. & Mrs. Hill:

Enclosed is the order executed by David W. Barfield, Chief Engineer, Division of Water Resources, Kansas Department of Agriculture, approving the application for change under the above referenced file number.

Your attention is directed to the terms, conditions, and limitations specified in this approval for change. A condition of this order requires the installation of water flow meter(s) before the first use of water in accordance with the Chief Engineer's specifications found in K.A.R. 5-1-4 through K.A.R. 5-1-12. A copy of these specifications and a list of acceptable meters can be obtained from our website at the following web address:

<http://agriculture.ks.gov/meters>

This order also requires that the diversion works should be completed, including installation of the flow meter(s), by December 31, 2019 and reported to the Division of Water Resources using the enclosed Notice of Completion of Diversion Works form. The form is also available on our website at: <http://agriculture.ks.gov/wa-forms> . If you do not have access to the internet, please contact this office and we will send you a paper copy of the referenced information.

**This document is a summary order by this agency regarding this matter.** This order shall become final if a request for a hearing is not filed with the Chief Engineer within 15 days of the date of service of this order.

If you have any questions, please feel free to contact this office at (785) 296-5733. If you wish to refer to a specific file, please reference it when you contact us.

Sincerely,

A handwritten signature in blue ink that reads "Katherine A. Tietsort".

Katherine A. Tietsort  
Water Commissioner

KAT:lh  
Enclosures

Submit completed application to:  
 Kansas Department of Agriculture  
 Division of Water Resources  
 Field Office for your area.  
 Call for address:  
 Topeka -- (785) 296-5733  
 Stafford -- (620) 234-5311  
 Stockton -- (785) 425-6787  
 Garden City -- (620) 276-2901  
<http://agriculture.ks.gov/dwr>

## DWR FIELD OFFICE APPLICATION FOR APPROVAL TO CHANGE THE PLACE OF USE AND/OR THE POINT OF DIVERSION



**STATE OF KANSAS**

**Filing Fee Must Accompany the Application, K.S.A. 82a-708b(b), as amended.**  
 Fee Schedule is on the third page of this application form.

**Paragraph Nos. 1, 2, 3 & 5 must be completed. Complete all other applicable portions.** If change in point of diversion is greater than 100 feet, or if place of use will be changed, include a topographic map or detailed plat showing the authorized and proposed point(s) of diversion and/or place of use.

**RECEIVED**

File No. 50,004

**JUN 04 2019**  
**4:30 PM**  
**Topeka Field Office**  
**DIVISION OF WATER RESOURCES**

1. Application is hereby made for approval of the Chief Engineer to change the (check one or both):  
 Place of Use                       Point of Diversion  
 under the water right which is the subject of this application in accordance with the conditions described below.  
 The source of supply is:                       Groundwater                       Surface water

2. Name and address of Applicant: Scott Hill  
1209 3300 Ave ABILENE KS 67410  
 Phone Number: (    )                      Email address: \_\_\_\_\_  
 Name and address of Water Use Correspondent: \_\_\_\_\_  
 Phone Number: (    )                      Email address: \_\_\_\_\_

3. The presently authorized place of use is:  
 Owner of Land ---- NAME: Scott & Lynette Hill  
 ADDRESS: 1209 3300 Ave ABILENE KS 67410  
 (If there is more than one landowner, attach supplemental sheets as necessary.)

| Sec. | Twp. | Range | NE¼ |     |     |     | NW¼ |     |     |     | SW¼ |     |     |     | SE¼ |     |     |     | TOTAL ACRES |
|------|------|-------|-----|-----|-----|-----|-----|-----|-----|-----|-----|-----|-----|-----|-----|-----|-----|-----|-------------|
|      |      |       | NE¼ | NW¼ | SW¼ | SE¼ | NE¼ | NW¼ | SW¼ | SE¼ | NE¼ | NW¼ | SW¼ | SE¼ | NE¼ | NW¼ | SW¼ | SE¼ |             |
| 24   | 11S  | 2E    |     |     |     |     |     |     |     |     | 40  | 40  | 35  | 40  | 40  | 40  | 40  | 40  | 315         |
|      |      |       |     |     |     |     |     |     |     |     |     |     |     |     |     |     |     |     |             |

4. If this application is for a change in place of use, it is proposed that the place of use be changed to:  
 Owner of Land ---- NAME: NO CHANGE IN PLACE OF USE  
 ADDRESS: \_\_\_\_\_  
 (If there is more than one landowner, attach supplemental sheets as necessary.)

| Sec. | Twp. | Range | NE¼ |     |     |     | NW¼ |     |     |     | SW¼ |     |     |     | SE¼ |     |     |     | TOTAL ACRES |
|------|------|-------|-----|-----|-----|-----|-----|-----|-----|-----|-----|-----|-----|-----|-----|-----|-----|-----|-------------|
|      |      |       | NE¼ | NW¼ | SW¼ | SE¼ | NE¼ | NW¼ | SW¼ | SE¼ | NE¼ | NW¼ | SW¼ | SE¼ | NE¼ | NW¼ | SW¼ | SE¼ |             |
|      |      |       |     |     |     |     |     |     |     |     |     |     |     |     |     |     |     |     |             |
|      |      |       |     |     |     |     |     |     |     |     |     |     |     |     |     |     |     |     |             |

|   |
|---|
| <b>For Office Use Only: Code</b> _____ <b>Fee \$</b> _____ <b>TR #</b> _____ <b>Receipt Date</b> _____ <b>Check #</b> _____ |
|---|

5. **Presently authorized point of diversion:**  
 One in the NE Quarter of the SW Quarter of the SE Quarter of Section 24, Township 11 South, Range 2 EAST, in Dickinson County, Kansas, 1244 feet North 1559 feet West of Southeast corner of section.  
 Authorized Rate \_\_\_\_\_ Authorized Quantity \_\_\_\_\_ Depth of well \_\_\_\_\_ (feet)  
**(DWR use only: Computer ID No. \_\_\_\_\_ GPS \_\_\_\_\_ feet North \_\_\_\_\_ feet West)**  
 This point will not be changed  This point will be changed as follows:  No change, point better described with GPS as follows:  
**Proposed point of diversion: (Complete only if change is requested or if existing point is better described by GPS)**  
 One in the \_\_\_\_\_ Quarter of the \_\_\_\_\_ Quarter of the \_\_\_\_\_ Quarter of Section \_\_\_\_\_, Township \_\_\_\_\_ South, Range \_\_\_\_\_, in \_\_\_\_\_ County, Kansas, \_\_\_\_\_ feet North \_\_\_\_\_ feet West of Southeast corner of section.  
 Proposed Rate \_\_\_\_\_ Proposed Quantity \_\_\_\_\_ Proposed well depth (feet) \_\_\_\_\_  
 This point is:  Additional Well  Geo Center List other water rights that will use this point \_\_\_\_\_

6. **Proposed point of diversion: (NEW WELL – BATTERY OF TWO WELLS)**  
 One in the SE Quarter of the NW Quarter of the SE Quarter of Section 24, Township 11 South, Range 2 EAST, in Dickinson County, Kansas, 1421 feet North 1382 feet West of Southeast corner of section.  
 Authorized Rate \_\_\_\_\_ Authorized Quantity \_\_\_\_\_ Depth of well \_\_\_\_\_ (feet)  
**Proposed point of diversion: (GEOGRAPHIC CENTER)**  
 One in the SE Quarter of the NW Quarter of the SE Quarter of Section 24, Township 11 South, Range 2 EAST, in Dickinson County, Kansas, 1333 feet North 1471 feet West of Southeast corner of section.  
 Proposed Rate 800 gpm Proposed Quantity 378 AF Proposed well depth (feet) \_\_\_\_\_  
 This point is:  Additional Well  Geo Center List other water rights that will use this point \_\_\_\_\_

7. The changes herein are desired for the following reasons?  
 (please be specific) Second well needed to provided sufficient rate and quantity of water to operate irrigation system.

8. If a well, is the test hole log attached?  Yes  No

9. The change(s) (was)(will be) completed by?  
Following approval of application.

10. If the point of diversion is a well:  
 (a) What are you going to do with the old well?  
Use as part of battery  
 (b) When will this be done? N/A

11. Groundwater Management District recommendation attached?  
 Yes  No

12. Assisted by Lloyd Hemphill

13a. If the proposed point of diversion will be relocated more than 300 feet but within 2,640 feet of the existing point of diversion, attach a topographic map or aerial photograph. For groundwater sources, show all wells (including domestic) within one-half mile of the proposed point of diversion and the names and mailing addresses of the owners. For surface water sources, show the names and addresses of the landowner(s) one-half mile downstream and one-half mile upstream from your property lines

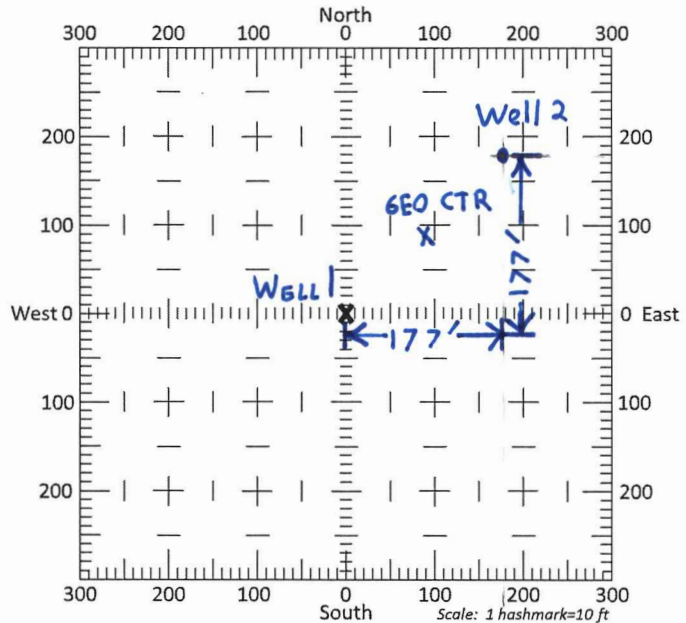

13b. If the proposed point of diversion will be relocated within 300 feet of the existing point of diversion, indicate its location on the diagram shown above in relation to the existing point of diversion. (PLEASE NOTE: The "X" in center of diagram above represents the presently authorized point of diversion.)

14. If the proposed groundwater point of diversion is 300 or fewer feet from the existing point of diversion, complete the following:
- (a) Does the undersigned represent all owners of the currently authorized place(s) of use identified in this application?  
 Yes     No    (If no, all owners must sign this application.)
  - (b) Will the ownership interest of any owner of the currently authorized place(s) of use identified in this application be adversely affected if this application is approved as requested?  
 Yes     No    (If yes, all owners must sign this application.)
  - (c) If this application is not approved expeditiously, will there be substantial damage to property, public health or safety?  
 Yes     No    (If no, all owners must sign this application.)

If the application proposes a surface water change in point of diversion, a groundwater change in point of diversion greater than 300 feet, or a change in place of use, the application must be signed by all owners of the currently authorized place of use, or their duly authorized agent (attach notarized statement authorizing representation).

I hereby verify, being first duly sworn upon my oath or affirmation and under penalty of perjury, that I am of lawful age and the owner, the spouse of the owner, or a duly authorized agent of the owner(s) to make this application on their behalf, in regards to the water right(s) to which this application pertains. I further verify that the statements contained in this application are true, correct and complete.

Dated at Topeka, Kansas, this 4<sup>th</sup> day of June, 2019.

|                        |                |
|------------------------|----------------|
| <u>[Signature]</u>     |                |
| (Owner)                | (Spouse)       |
| <u>Scott L. Hill</u>   |                |
| (Please Print)         | (Please Print) |
| <u>Lynette K. Hill</u> |                |
| (Owner)                | (Spouse)       |
| <u>Lynette K. Hill</u> |                |
| (Please Print)         | (Please Print) |
|                        |                |
| (Owner)                | (Spouse)       |
|                        |                |
| (Please Print)         | (Please Print) |

State of Kansas }  
 County of Shawnee } SS

I hereby certify that the foregoing application was signed in my presence and sworn to before me this 4<sup>th</sup> day of June, 2019.

My Commission Expires \_\_\_\_\_

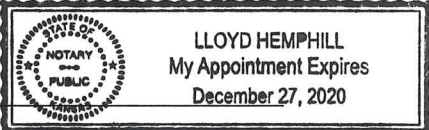

LLOYD HEMPHILL  
 My Appointment Expires  
 December 27, 2020

[Signature]  
 Notary Public

**ONLY COMPLETE APPLICATIONS WILL BE PROCESSED.** To be complete, all of the applicable portions of the application form must be completed with accurate information; maps, if necessary, must be included; signatures of all the appropriate owners' must be affixed to the application and notarized; and the appropriate fee must be paid.

**FEE SCHEDULE**

Each application to change the place of use or the point of diversion under this section shall be accompanied by the application fee set forth in the schedule below: Make checks payable to: **Kansas Department of Agriculture**

- (1) Application to change a point of diversion 300 feet or less ..... \$100
- (2) Application to change a point of diversion more than 300 feet ..... \$200
- (3) Application to change the place of use ..... \$200

**SUMMARY ORDER APPROVING APPLICATION FOR CHANGE AND IMPOSING CONDITIONS**

This Summary Order is issued under authority of K.S.A. 82a-708b, as amended, and K.A.R. 5-5-1, *et seq.* and other applicable provisions of the *Kansas Water Appropriation Law, K.S.A. 82a-701 et. seq.*, and rules and regulations promulgated thereunder. With the exception of those conditions expressly contained herein, this Summary Order does not change the terms, conditions and limitations of File No. 50,004.

1. A change application was received on June 4, 2019 requesting that the place of use and / or point of diversion authorized under the above-referenced file number be changed as described in the application.
2. On and after the effective date of this summary order, the authorized place(s) of use shall be located substantially as shown on the topographic map accompanying the application to change the place of use.  Applicable  Not Applicable
3. The change in point of diversion shall not impair existing rights and shall be limited to the same source or sources of water as previously authorized. The point of diversion authorized by this summary order shall be located within a 50 foot radius of the authorized point(s) of diversion.  Applicable  Not Applicable
4. The point(s) of diversion described herein is administratively corrected to be more accurately described using the Global Positioning System (GPS), as described in the application.  Applicable  Not Applicable
5. The point(s) of diversion authorized herein shall not actually be located more than \_\_\_\_\_ feet from the previously authorized point(s) of diversion.  Applicable  Not Applicable
6. As required by K.A.R. 5-3-5d, if the works for diversion is a well with a diversion rate of 100 gallons per minute or more, a tube or other device suitable for making water level measurements shall be installed, operated and maintained in accordance with K.A.R. 5-6-13.  Applicable  Not Applicable
7. **The owner of the authorized place(s) of use shall properly install an acceptable water flow meter on or before December 31, 2019**, or before the first use of water, whichever occurs first. The water flow meter shall be installed, operated and maintained in accordance with K.A.R. 5-1-4 through 5-1-12. As required by K.S.A. 82a-732, as amended, and K.A.R. 5-3-5e, the owner shall maintain records and report the reading of the water flow meter and the total quantity of water diverted annually to the Chief Engineer by March 1 following the end of each calendar year.  Applicable  Not Applicable
8. **Installation of the works for diversion of water shall be completed on or before December 31, 2019**, or within any authorized extension of time. By March 1, 2020 the applicant shall notify the Chief Engineer that construction of the works for diversion has been completed, on the form provided by the Chief Engineer, as required by K.A.R. 5-8-4e.  Applicable  Not Applicable
9. **The completed well log shall be submitted with the required notice.**  Applicable  Not Applicable
10. All diversion works into which any type of chemical or other foreign substance will be injected into the water shall be equipped with an in-line, automatic, quick-closing check valve capable of preventing pollution of the source of the water supply. The check valve(s) shall be installed, operated and maintained in accordance with K.A.R. 5-3-5c.  Applicable  Not Applicable
11. Additional Conditions are attached.  Yes  No
12. In accordance with K.S.A. 82a-708a, as amended, and K.A.R. 5-5-14, all of the owners of the authorized place(s) of use of water appropriated under the above-referenced file number are responsible for compliance with its terms, conditions and limitations, as amended and/or supplemented by this Summary Order, and with applicable provisions of the *Kansas Water Appropriation Law* and the *Rules and Regulations* promulgated thereunder. Failure to comply with these provisions may result in civil penalties pursuant to K.S.A. 82a-737, as amended, and/or the suspension or revocation and dismissal of the water or appropriation right or any other enforcement actions authorized by law.

**Administrative Appeal and Effective Date of Order**

If you are aggrieved by this order, pursuant to K.S.A. 82a-1901, you may request an evidentiary hearing before the Chief Engineer or request administrative review by the Secretary of Agriculture. A request for hearing by the Chief Engineer must be filed within **15 days** of service of this Order and a request for administrative review by the Secretary must be filed within **30 days** pursuant to K.S.A. 77-531. Any request for administrative review must state a basis for review pursuant to K.S.A. 77-527. File any request with **Kansas Department of Agriculture, Legal Division, 1320 Research Park Drive, Manhattan, KS 66502**. Failure to timely request a hearing or review may preclude review under the Kansas Judicial Review Act.

*For Use by Register of Deeds*

FOR OFFICE USE ONLY  
**APPLICATION APPROVED AND SUMMARY ORDER ISSUED**

By: Katherine A. Tietzart  
Duly Authorized Designee of the Chief Engineer  
(Print Name): Katherine A. Tietzart  
Division of Water Resources - Kansas Department of Agriculture  
Date of Issuance: June 10, 2019  
State of Kansas )  
County of Shawnee ) SS  
Acknowledged before me on June 10, 2019  
by Debbie Croucher  
Signature: Debbie Croucher  
Notary Public

My commission expires: \_\_\_\_\_ (Notary Seal)

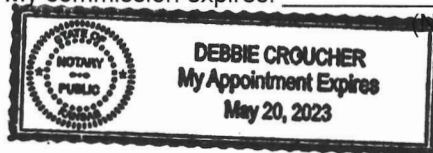

**Approval of Application for Change in Point of Diversion  
File No. 50,004**

**Additional Conditions**

- 1) That this approval is further limited such that both wells shall be located within a three hundred (300) foot radius circle, in the same local source of supply and shall be limited to a total maximum diversion rate not in excess of 800 gallons per minute (1.78 c.f.s.).
  
- 2) That the authorized rate under Appropriation of Water, File No. 50,004 shall be reduced from 1,600 gallons per minute to 800 gallons per minute.



## CERTIFICATE OF SERVICE

On this 11<sup>th</sup> day of June, 2019, I hereby certify that the attached **APPROVAL OF APPLICATION FOR CHANGE IN POINT OF DIVERSION**, Appropriation of Water, File No. 50,004, dated June 10, 2019 was mailed postage prepaid, first class, US mail to the following:

SCOTT AND LYNETTE HILL  
1209 3300 AVE  
ABILENE KS 67410

A handwritten signature in blue ink, appearing to read "Debra Leach", written over a horizontal line.

Staff