

Kansas Department of Agriculture
Division of Water Resources
PERMIT OF NEW APPLICATION WORKSHEET

1. File Number: <p style="text-align: center; font-size: 1.2em;">50,167</p>	2. Status Change Date: <p style="text-align: center; font-size: 1.2em;">2/27/2019</p>	3. Field Office: <p style="text-align: center; font-size: 1.2em;">01</p>	4. GMD: <p style="text-align: center; font-size: 1.2em;">0</p>
5. Status: <input checked="" type="checkbox"/> Approved <input type="checkbox"/> Denied by DWR/GMD <input type="checkbox"/> Dismiss by Request/Failure to Return			
6. Enclosures: <input checked="" type="checkbox"/> Check Valve <input checked="" type="checkbox"/> N of C Form <input checked="" type="checkbox"/> Water Tube <input checked="" type="checkbox"/> Driller Copy <input checked="" type="checkbox"/> Meter			
<p>7a. Applicant(s) New to system <input type="checkbox"/></p> <p style="text-align: right;">Person ID 34305 Add Seq# _____</p> <p style="text-align: center; font-weight: bold; margin-top: 20px;">HOOK FARMS LLC 8920 NW US HIGHWAY 24 SILVER LAKE KS 66539-9471</p>	<p>7c. Landowner(s) New to system <input type="checkbox"/></p> <p style="text-align: right;">Person ID _____ Add Seq# _____</p>		
<p>7b. Landowner(s) New to system <input type="checkbox"/></p> <p style="text-align: right;">Person ID 65830 Add Seq# _____</p> <p style="text-align: center; font-weight: bold; margin-top: 20px;">THOMAS L WAIT 100 MONROE HILL CT HERNDON VA 20170</p>	<p>7d. Misc. New to system <input type="checkbox"/></p> <p style="text-align: right;">Person ID _____ Add Seq# _____</p>		
<p>8. WUR Correspondent New to system <input type="checkbox"/> Overlap File (s) WUC Agree <input type="checkbox"/> Yes <input type="checkbox"/> No</p> <p style="font-weight: bold; margin-top: 10px;">7a.</p> <p style="text-align: right;">Person ID _____ Add Seq# _____ Notarized WUC Form <input type="checkbox"/></p>	<p>9. Use of Water: Changing? <input type="checkbox"/> Yes <input checked="" type="checkbox"/> No</p> <p style="text-align: center;"><input checked="" type="checkbox"/> Groundwater <input type="checkbox"/> Surface Water</p> <p><input checked="" type="checkbox"/> IRR <input type="checkbox"/> REC <input type="checkbox"/> DEW <input type="checkbox"/> MUN</p> <p><input type="checkbox"/> STK <input type="checkbox"/> SED <input type="checkbox"/> DOM <input type="checkbox"/> CON</p> <p><input type="checkbox"/> HYD DRG <input type="checkbox"/> WTR PWR <input type="checkbox"/> ART RECHRG</p> <p><input type="checkbox"/> IND SIC: _____ <input type="checkbox"/> OTHER: _____</p>		
10. Completion Date: <u>12/31/2020</u> 11. Perfection Date: <u>12/31/2024</u> 12. Exp Date: _____			
13. Conservation Plan Required? <input type="checkbox"/> Yes <input checked="" type="checkbox"/> No Date Required: _____ Date Approved: _____ Date to Comply: _____			
14. Water Level Measuring Device? <input type="checkbox"/> Yes <input checked="" type="checkbox"/> No Date to Comply: _____ Date WLMD Installed: _____			
Date Prepared: 1/24/2019 By: DWS Date Entered: 2/28/2019 By: CLM			

File No. **50,167** 15. Formation Code: 113 Drainage Basin: **Kansas River** County: SN Special Use: Stream:

16. Points of Diversion										17. Rate and Quantity MOD ADDL RATE AND QTY				
MOD DEL ENT	PDIV	Qualifier	S	T	R	ID	'N	'W		Rate gpm	Quantity af	Rate gpm	Quantity af	Overlap PD Files
√	2447	SW NW NE	21	11	15E	7	4470	2090	(Batt 1 of 2)	800	116	240	10	34,069*
√	86431	SW NW NE	21	11	15E	15	4446	2164	(Batt 1 of 2)					
√	87177	SW NW NE	21	11	15E	16	4433	2113	(Geo-Ctr)					
All in TRACT 1162 POTTAWATOMIE RESERVE LANDS														

18. Storage: Rate _____ NF Quantity _____ ac/ft Additional Rate _____ NF Additional Quantity _____ ac/ft

19. Limitation: **116** af/yr at **800** gpm (_____ cfs) when combined with file number(s) **34,069**
 Limitation: _____ af/yr at _____ gpm (_____ cfs) when combined with file number(s) _____

20. Meter Required? Yes No To be installed by **12/31/2020** Date Acceptable Meter Installed _____

21. Place of Use						NE¼				NW¼				SW¼				SE¼				Total	Owner	Chg?	NO	Overlap Files
MOD DEL ENT	PUSE	S	T	R	ID	NE ¼	NW ¼	SW ¼	SE ¼	NE ¼	NW ¼	SW ¼	SE ¼	NE ¼	NW ¼	SW ¼	SE ¼	NE ¼	NW ¼	SW ¼	SE ¼					
√	10362	16	11	15E	5												7						23	7b.	NO	34,069
√	868	21	11	15E	7		38	12		32			11										93	7b.	NO	34,069

Comments: ***CHANGE IN POINT OF DIVERSION ON SENIOR FILE TO CREATE COMPLETE OVERLAP (Battery of 2 wells).**
 Place of Use acreage: 7 acres in SE SW of Sec. 16 is in TRACT 760; 16 acres in SW SE of Sec. 16 is in TRACT 764; 50 acres in NE of 21 is in TRACT 1162; and 43 acres in NW of 21 is in Tract 771; all in POTTAWATOMIE RESERVE LANDS

KANSAS DEPARTMENT OF AGRICULTURE
Division of Water Resources
M E M O R A N D U M

TO: Files

DATE: January 24, 2019

FROM: Doug Schemm

RE: Application, File No. 50,167

Shannon Hook has filed the referenced new application to appropriate 116 acre-feet of groundwater from a battery of wells at a rate of 800 gallons per minute for irrigation use on 116 acres. The well battery will be located in the Northeast Quarter of Section 21, Township 11 South, Range 15 East, Shawnee County, within the Kansas River Drainage Basin. Note that Water Right, File No. 34,069 currently authorizes one of the wells in the proposed battery, and a change in point of diversion will create a complete overlap with this new application. The files will also overlap in place of use. The entire place of use is owned by Thomas L. Wait, and the applicant has signed the application form stating he has access to the point of diversion.

Water Right, File No. 34,069 is authorized 106 acre-feet at 560 gallons per minute. The requested quantity of water of 116 acre-feet is equivalent to the maximum allowable to irrigate the proposed acreage of 116 acres, with 1.0 acre-feet per acre in Shawnee County. This new application will be limited to 116 acre-feet at 800 gallons per minute when combined with the senior file, providing 10 additional acre-feet and 240 gallons per minute from this well battery. The wells and place of use are located within various tracts within the Pottawatomie Reserve Lands.

The applicant identified multiple wells within one-half mile (complying with K.A.R. 5-3-4), and nearby notification letters were sent out on December 4, 2018. A telephone call was received from one domestic well owner (Munger) who was concerned about impact to their well. We discussed her domestic water right, and that the new application was for minimal additional water and rate above the existing well. She presented no specific evidence that approval of this application would impair her domestic well located over 1,300 feet away. The point of diversion meets minimum well spacing criteria to all existing wells per the requirements in K.A.R. 5-4-4. It is located over 1,700 feet from the nearest irrigation well, and over 1,000 feet from the nearest domestic well. The proposed well is located over ¼ mile from the Kansas River, so no notification of the KRWAD is required.

The well log from the senior file shows sand and gravel extending from 11 feet to 46 feet below ground surface where shale bedrock was encountered. Static water level is 12 feet below ground surface, providing over 34 feet of saturated thickness. The source of water is the Kansas River alluvium. K.A.R. 5-3-11 states that calculated recharge in the Kansas River alluvium shall be determined by taking 25% of the average annual rainfall in the area of consideration. For this application, the calculated recharge was determined to be 8.4 inches. The extent of the alluvium (per LIDAR data) for the area of consideration provides a total of 6,255 acres. Based on a potential recharge of 8.4 inches, with 75% available for appropriation, safe yield was determined to be 3,284.14 acre-feet. Existing water rights have appropriated 2,985.86 acre-feet within the area of consideration, leaving 298.28 acre-feet available, and the application complies with safe yield.

The applicant has submitted a signed Kansas River Assurance District form, which has been properly notarized. By completing this statement, the applicant affirms his/her knowledge that there could be times when the diversion of water may not be allowed under this permit. In accordance with K.S.A. 82a-706c, the Chief Engineer retains full authority to require any water user to install meters, gages, or other measuring devices, which devices he or she or his or her agents may read at any time. Water flowmeter requirements are further described in K.A.R. 5-1-4 through K.A.R. 5-1-12. If any chemical or foreign substance is injected into the water pumped under this permit, a check valve will also need to be installed.

In a January 2, 2019 discussion, Katie Tietsort, Water Commissioner, Topeka Field Office, recommended approval of the referenced new application. Based on the above discussion, well spacing and safe yield criteria are met, and approval of the application will not impair senior water rights nor prejudicially or unreasonably affect the public interest, it is recommended that the referenced new application be approved, in conjunction with the change in point of diversion for File No. 34,069.

Douglas W. Schemm
Environmental Scientist
Topeka Field Office

1320 Research Park Drive
Manhattan, KS 66502
785-564-6700
www. agriculture.ks.gov



900 SW Jackson, Room 456
Topeka, KS 66612
785-296-3556

Mike Beam, Acting Secretary

Laura Kelly, Governor

HOOK FARMS LLC
8920 NW US HIGHWAY 24
SILVER LAKE KS 66539-9471

March 4, 2019

FILE COPY

Re: Appropriation of Water, File No. 50,167

Dear Sir or Madam:

There is enclosed a permit to appropriate water authorizing you to proceed with construction of the proposed diversion works (except those dams and stream obstructions regulated by K.S.A. 82a-301 through 305a), to divert such unappropriated water as may be available from the source and at the location specified in the permit, and to use it for the purpose and at the location described in the permit.

Your attention is directed to the enclosures and to the terms, conditions, and limitations specified in these approval documents. A water meter is required on the proposed diversion works and you must install it prior to water being put to beneficial use in order for you to maintain accurate records of water use. The meter should be used to provide the information required on the annual water use report.

Failure to notify the Chief Engineer of the Division of Water Resources of the completion of the diversion works within the time allowed, or within any authorized extension of time thereof, will result in the dismissal of this permit. Enclosed is a form which may be used to notify the Chief Engineer that the proposed diversion works have been completed.

All requests for extensions of time to complete diversion works, or to perfect appropriations, must be submitted to the Chief Engineer before the expiration of time originally set forth in the permit to complete diversion works or to perfect an appropriation. If for any reason, you require an extension of time, you must request it before the expiration of time set forth in this permit. Failure to comply with this regulation will result in the dismissal of your permit or your water right. Any request for an extension of time shall be accompanied by the required statutory fee, which is currently \$100.00. There is also enclosed an information sheet setting forth the procedure to obtain a Certificate of Appropriation which will establish the extent of your water right. If you have any questions, please contact our office. If you wish to discuss this specific file, please have the file number ready so that we may help you more efficiently.

Sincerely,

Kristen A. Baum
New Application Unit Supervisor
Water Appropriation Program

KAB:dws
Enclosures

pc: Topeka Field Office
Thomas L Wait



THE STATE OF KANSAS

KANSAS DEPARTMENT OF AGRICULTURE
 Mike Beam, Acting Secretary of Agriculture

DIVISION OF WATER RESOURCES
 David W. Barfield, Chief Engineer

APPROVAL OF APPLICATION
and
PERMIT TO PROCEED

(This Is Not a Certificate of Appropriation)

This is to certify that I have examined Application, **File No. 50,167** of the applicant

HOOK FARMS LLC
8920 NW US HIGHWAY 24
SILVER LAKE KS 66539-9471

for a permit to appropriate water for beneficial use, together with the maps, plans and other submitted data, and that the application is hereby approved and the applicant is hereby authorized, subject to vested rights and prior appropriations, to proceed with the construction of the proposed diversion works (except those dams and stream obstructions regulated by K.S.A. 82a-301 through 305a, as amended), and to proceed with all steps necessary for the application of the water to the approved and proposed beneficial use and otherwise perfect the proposed appropriation subject to the following terms, conditions and limitations:

1. That the priority date assigned to such application is **November 16, 2018**.
2. That the water sought to be appropriated shall be used for irrigation use on land within Tracts 760, 764, 771, and 1162 of the Pottawatomie Reserve Lands, described in the application, as follows:

Sec. Twp. Range	NE¼				NW¼				SW¼				SE¼				TOTAL
	NE¼	NW¼	SW¼	SE¼	NE¼	NW¼	SW¼	SE¼	NE¼	NW¼	SW¼	SE¼	NE¼	NW¼	SW¼	SE¼	
16 11S 15E												7			16		23
21 11S 15E		38	12		32			11									93

3. That the authorized source from which the appropriation shall be made is groundwater, to be withdrawn by means of a battery of two (2) wells located in Tract 1162 of the Pottawatomie Reserve Lands, with a geographic center located in the Southwest Quarter of the Northwest Quarter of the Northeast Quarter (SW¼ NW¼ NE¼) of Section 21, more particularly described as being near a point 4,433 feet North and 2,113 feet West of the Southeast corner of said section, in Township 11 South, Range 15 East, Shawnee County, Kansas, located substantially as shown on the topographic map accompanying the application.

4. That the appropriation sought shall be limited to a maximum diversion rate not in excess of **800 gallons per minute (1.78 c.f.s.)** and to a quantity not to exceed **116 acre-feet** of water for any calendar year.

5. That installation of works for diversion of water shall be completed on or before **December 31, 2020** or within any authorized extension thereof. The applicant shall notify the Chief Engineer and pay the statutorily required field inspection fee of \$400.00 when construction of the works has been completed. Failure to timely submit the notice and the fee will result in revocation of the permit. Any request for an extension of time shall be submitted prior to the expiration of the deadline and shall be accompanied by the required statutory fee of \$100.00.

6. That the proposed appropriation shall be perfected by the actual application of water to the proposed beneficial use on or before **December 31, 2024** or any authorized extension thereof. Any request for an extension of time shall be submitted prior to the expiration of the deadline and shall be accompanied by the required statutory fee of \$100.00.

7. That the applicant shall not be deemed to have acquired a water appropriation for a quantity in excess of the amount approved herein nor in excess of the amount found by the Chief Engineer to have been actually used for the approved purpose during one calendar year subsequent to approval of the application and within the time specified for perfection or any authorized extension thereof.

8. That the use of water herein authorized shall not be made so as to impair any use under existing water rights nor prejudicially and unreasonably affect the public interest.

9. That the right of the appropriator shall relate to a specific quantity of water and such right must allow for a reasonable raising or lowering of the static water level and for the reasonable increase or decrease of the streamflow at the appropriator's point of diversion.

10. That this permit does not constitute authority under K.S.A. 82a-301 through 305a to construct any dam or other obstruction; nor does it grant any right-of-way, or authorize entry upon or injury to, public or private property.

11. That all diversion works constructed under the authority of this permit into which any type of chemical or other foreign substance will be injected into the water pumped from the diversion works shall be equipped with an in-line, automatic quick-closing, check valve capable of preventing pollution of the source of the water supply. The type of valve installed shall meet specifications adopted by the Chief Engineer and shall be maintained in an operating condition satisfactory to the Chief Engineer.

12. That all wells with a diversion rate of 100 gallons per minute or more drilled under the authority of this permit shall have a tube or other device installed in a manner acceptable to, and in accordance with specifications adopted by, the Chief Engineer. This tube or device shall be suitable for making water level measurements and shall be maintained in a condition satisfactory to the Chief Engineer.

13. That an acceptable water flow meter shall be installed and maintained on the diversion works authorized by this permit in accordance with the Kansas Administrative Regulations 5-1-4 through 5-1-12 adopted by the Chief Engineer. This water flow meter shall be used to provide an accurate quantity of water diverted as required for the annual water use report (including the meter reading at the beginning and end of the report year).

14. That the applicant shall maintain accurate and complete records from which the quantity of water diverted during each calendar year may be readily determined and the applicant shall file an annual water use report with the Chief Engineer by March 1 following the end of each calendar year. Failure to file the annual water use report by the due date shall cause the applicant to be subject to a civil penalty.

15. That no water user shall engage in nor allow the waste of any water diverted under the authority of this permit.

16. That failure without cause to comply with provisions of the permit and its terms, conditions and limitations will result in the forfeiture of the priority date, revocation of the permit and dismissal of the application.

17. That the right to appropriate water under authority of this permit is subject to any minimum desirable streamflow requirements identified and established pursuant to K.S.A. 82a-703c for the source of supply to which this water right applies.

18. That this permit is limited such that all wells shall be located within a three hundred (300) foot radius circle, in the same local source of supply, and shall supply water to a common distribution system.

19. That the quantity of water and rate of diversion approved under this permit is further limited to the quantity and rate which combined with Water Right, File No. 34,069, will provide a total not to exceed **116 acre-feet** of water per calendar year to be diverted at a maximum diversion rate not in excess of **800 gallons per minute** (1.78 c.f.s.) for irrigation use from the point of diversion described herein.

RIGHT TO A HEARING AND TO ADMINISTRATIVE REVIEW

If you are aggrieved by this Order, then pursuant to K.S.A. 82a-1901, you may:

- 1) request an evidentiary hearing before the Chief Engineer, or
- 2) request administrative review by the Secretary of Agriculture.

Failure to request an evidentiary hearing before the Chief Engineer does not preclude your right to administrative review by the Secretary. To obtain an evidentiary hearing before the Chief Engineer, a written request for hearing must be filed within 15 days after service of this Order as provided in K.S.A. 77-531 (i.e., **within a total of 18 days after this Order was mailed to you**), with: Kansas Department of Agriculture, Attn: Legal Section, 1320 Research Park Drive, Manhattan, Kansas 66502, FAX (785) 564-6777.

If you do not file a request for an evidentiary hearing before the Chief Engineer, you may petition for administrative review of the Order by the Secretary of Agriculture. A petition for review shall be in writing and state the basis for requesting administrative review. The request for hearing may be denied if the request fails to clearly establish factual or legal issues for review. See K.S.A. 77-527. The petition must be filed within 30 days after service of this Order as provided in K.S.A. 77-531 (i.e., **within a total of 33 days after this Order was mailed to you**), and be filed with: Secretary of Agriculture, Attn: Legal Division, Kansas Department of Agriculture, 1320 Research Park Drive, Manhattan, Kansas 66502, FAX (785) 564-6777.

If neither a request for an evidentiary hearing nor a petition for administrative review is filed as set forth above, then this Order shall be effective and become a final agency action as defined in K.S.A. 77-607(b). Failure to timely request either an evidentiary hearing or administrative review may preclude further judicial review under the Kansas Judicial Review Act.

Ordered this 27th day of February, 2019, in Manhattan, Riley County, Kansas.

Lane P. Letourneau

Lane P. Letourneau, P.G.
Program Manager
Water Appropriation Program
Division of Water Resources
Kansas Department of Agriculture

State of Kansas)
) SS
County of Riley)

The foregoing instrument was acknowledged before me this 27th day of February, 2019, by Lane P. Letourneau, P.G., Program Manager, Division of Water Resources, Kansas Department of Agriculture.

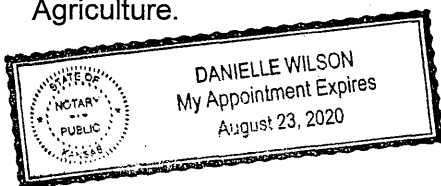

Danielle Wilson

Notary Public

CERTIFICATE OF SERVICE

On this ~~4th~~ day of ~~March~~, 2019, I hereby certify that the foregoing Approval of Application and Permit to Proceed, File No. 50,167, dated ~~February 27, 2019~~ was mailed postage prepaid, first class, US mail to the following:

HOOK FARMS LLC
8920 NW US HIGHWAY 24
SILVER LAKE KS 66539-9471

With photocopies to:

THOMAS L WAIT
100 MONROE HILL CT
HERNDON VA 20170

Topeka Field Office

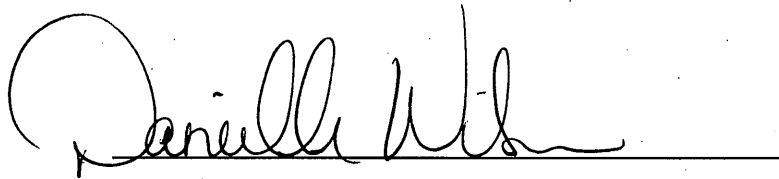
A handwritten signature in black ink, appearing to read "Daniel L. Wait", is written over a horizontal line.

Division of Water Resources

THE STATE OF KANSAS



KANSAS DEPARTMENT OF AGRICULTURE
Jackie McClaskey, Secretary of Agriculture

DIVISION OF WATER RESOURCES
David W. Barfield, Chief Engineer

File Number 5067
This item to be completed by the Division of Water Resources.

Water Resources
Received

APPLICATION COMPLETE
1/2/19
Reviewer CAB

APPLICATION FOR PERMIT TO
APPROPRIATE WATER FOR BENEFICIAL USE
Filing Fee Must Accompany the Application
(Please refer to Fee Schedule attached to this application form.)

NOV 16 2018
11:34
KS Dept Of Agriculture

To the Chief Engineer of the Division of Water Resources, Kansas Department of Agriculture,
1320 Research Park Drive, Manhattan, KS 66502:

1. Name of Applicant (Please Print): SHANNON HOOK
Address: 8948 NW US HWY 24
City: SILVER LAKE State KS Zip Code 66539
Telephone Number: ()

2. The source of water is: [] surface water in (stream)
OR [x] groundwater in KANSAS RIVER (drainage basin)

Certain streams in Kansas have minimum target flows established by law or may be subject to administration when water is released from storage for use by water assurance district members. If your application is subject to these regulations on the date we receive your application, you will be sent the appropriate form to complete and return to the Division of Water Resources.

3. The maximum quantity of water desired is 116 acre-feet OR gallons per calendar year,
to be diverted at a maximum rate of 800 gallons per minute OR cubic feet per second.

Once your application has been assigned a priority, the requested maximum rate of diversion and maximum requested quantity of water under that priority number can NOT be increased. Please be certain your requested maximum rate of diversion and maximum quantity of water are appropriate and reasonable for your proposed project and are in agreement with the Division of Water Resources' requirements.

4. The water is intended to be appropriated for (Check use intended):
(a) [] Artificial Recharge (b) [x] Irrigation (c) [] Recreational (d) [] Water Power
(e) [] Industrial (f) [] Municipal (g) [] Stockwatering (h) [] Sediment Control
(i) [] Domestic (j) [] Dewatering (k) [] Hydraulic Dredging (l) [] Fire Protection
(m) [] Thermal Exchange (n) [] Contamination Remediation

* QUANTITY LIMITED TO 116 AF WHEN COMBINED WITH FILE NO. 34069

** RATE LIMITED TO 800 gpm WHEN COMBINED WITH FILE NO. 34069

For Office Use Only:
F.O. 1 GMD Meets K.A.R. 5-3-1 (YES/NO) Use RR Source GS County SN By DAW Date 11/16/18
Code RE2 Fee \$ 300 TR # Receipt Date 11/16/18 Check # 8528

SCANNED
11/21/2018 UM

5. The location of the proposed wells, pump sites or other works for diversion of water is:

Note: For the application to be accepted, the point of diversion location must be described to at least a 10 acre tract, unless you specifically request a 60 day period of time in which to locate the site within a specifically described, minimal legal quarter section of land.

ONE WELL

(A) One in the SW quarter of the NW quarter of the NE quarter of Section 21, more particularly described as being near a point 4424 feet North and 2069 feet West of the Southeast corner of said section, in Township 11 South, Range 21 EAST, SHAWNEE County, Kansas.

ONE WELL

(B) One in the SW quarter of the NW quarter of the NE quarter of Section 21, more particularly described as being near a point 4442 feet North and 2157 feet West of the Southeast corner of said section, in Township 11 South, Range 21 EAST, SHAWNEE County, Kansas.

GEOCTR

(C) One in the SW quarter of the NW quarter of the NE quarter of Section 21, more particularly described as being near a point 4433 feet North and 2113 feet West of the Southeast corner of said section, in Township 11 South, Range 21 EAST, SHAWNEE County, Kansas.

(D) One in the _____ quarter of the _____ quarter of the _____ quarter of Section _____, more particularly described as being near a point _____ feet North and _____ feet West of the Southeast corner of said section, in Township _____ South, Range _____ East/West (circle one), _____ County, Kansas.

If the source of supply is groundwater, a separate application shall be filed for each proposed well or battery of wells, except that a single application may include up to four wells within a circle with a quarter (1/4) mile radius in the same local source of supply which do not exceed a maximum diversion rate of 20 gallons per minute per well.

A battery of wells is defined as two or more wells connected to a common pump by a manifold; or not more than four wells in the same local source of supply within a 300 foot radius circle which are being operated by pumps not to exceed a total maximum diversion rate of 800 gallons per minute and which supply water to a common distribution system.

6. The owner of the point of diversion, if other than the applicant is (please print):

THOMAS L WAIT 100 MONROE HILL CT HERNDON VA 20170

(name, address and telephone number)

(name, address and telephone number)

You must provide evidence of legal access to, or control of, the point of diversion from the landowner or the landowner's authorized representative. Provide a copy of a recorded deed, lease, easement or other document with this application. In lieu thereof, you may sign the following sworn statement:

I have legal access to, or control of, the point of diversion described in this application from the landowner or the landowner's authorized representative. I declare under penalty of perjury that the foregoing is true and correct.

Executed on November 14, 2018.

Hook Farms LLC by R. [Signature] Hook Member
Applicant's Signature

The applicant must provide the required information or signature irrespective of whether they are the landowner. Failure to complete this portion of the application will cause it to be unacceptable for filing and the application will be returned to the applicant.

7. The proposed project for diversion of water will consist of BATTERY OF 2 WELLS

(number of wells, pumps or dams, etc.)

and WILL BE completed (by) JUNE 2019

(Month/Day/Year - each was or will be completed)

8. The first actual application of water for the proposed beneficial use was or is estimated to be JULY 2019

(Mo/Day/Year)

13. Furnish the following well information if the proposed appropriation is for the use of groundwater. If the well has not been completed, give information obtained from test holes, if available.

Information below is from: Test holes Well as completed Drillers log attached

Well location as shown in paragraph No.	(A)	(B)	(C)	(D)
Date Drilled	<u>11-12-80</u>	<u>2-21-18</u>	_____	_____
Total depth of well	<u>45'</u>	<u>50'</u>	_____	_____
Depth to water bearing formation	_____	_____	_____	_____
Depth to static water level	<u>17.6</u>	<u>12'</u>	_____	_____
Depth to bottom of pump intake pipe	_____	_____	_____	_____

14. The relationship of the applicant to the proposed place where the water will be used is that of

TENANT
(owner, tenant, agent or otherwise)

15. The owner(s) of the property where the water is used, if other than the applicant, is (please print):

SEE IRRIGATION USE SUPPLEMENTAL SHEET
(name, address and telephone number)

(name, address and telephone number)

16. The undersigned states that the information set forth above is true to the best of his/her knowledge and that this application is submitted in good faith.

Dated at Silver Lake, Kansas, this 14 day of November, 2018.
(month) (year)

Hook Farms LLC by
A. Glen Hark Member
(Applicant Signature)

By _____
(Agent or Officer Signature)

(Agent or Officer - Please Print)

Assisted by BRETT BUNGER TFO/ ASST WATER COMM. Date: 11-17-18
(office/title)

Water Resources
Received
NOV 16 2018
SCANNED
KS Dept. Of Agriculture

- 9. Will pesticide, fertilizer, or other foreign substance be injected into the water pumped from the diversion works?
 Yes No If "yes", a check valve shall be required.

All chemigation safety requirements must be met including a chemigation permit and reporting requirements.

- 10. If you are planning to impound water, please contact the Division of Water Resources for assistance, prior to submitting the application. Please attach a reservoir area capacity table and inform us of the total acres of surface drainage area above the reservoir.

Have you also made an application for a permit for construction of this dam and reservoir with the Division of Water Resources? Yes No

- If yes, show the Water Structures permit number here _____
- If no, explain here why a Water Structures permit is not required _____

- 11. The application must be supplemented by a U.S.G.S. topographic map, aerial photograph or a detailed plat showing the following information. On the topographic map, aerial photograph, or plat, identify the center of the section, the section lines or the section corners and show the appropriate section, township and range numbers. Also, please show the following information:

- (a) The location of the proposed point(s) of diversion (wells, stream-bank installations, dams, or other diversion works) should be plotted as described in Paragraph No. 5 of the application, showing the North-South distance and the East-West distance from a section line or southeast corner of section.
- (b) If the application is for groundwater, please show the location of any existing water wells of any kind within 1/2 mile of the proposed well or wells. Identify each existing well as to its use and furnish the name and mailing address of the property owner or owners. If there are no wells within 1/2 mile, please advise us.
- (c) If the application is for surface water, the names and addresses of the landowner(s) 1/2 mile downstream and 1/2 mile upstream from your property lines must be shown.
- (d) The location of the proposed place of use should be shown by crosshatching on the topographic map, aerial photograph or plat.
- (e) Show the location of the pipelines, canals, reservoirs or other facilities for conveying water from the point of diversion to the place of use.

A 7.5 minute U.S.G.S. topographic map may be obtained by providing the section, township and range numbers to: Kansas Geological Survey, 1930 Constant, Campus West, University of Kansas, Lawrence, Kansas 66047.

- 12. List any application, appropriation of water, water right, or vested right file number that covers the same diversion points or any of the same place of use described in this application. Also list any other recent modifications made to existing permits or water rights in conjunction with the filing of this application.

P/D & P/U - 34069

APR 21 1968

IRRIGATION USE SUPPLEMENTAL SHEET

File No. 50167

Name of Applicant (Please Print): SHANNON HOOK

1. Please supply the name and address of each landowner, the legal description of the lands to be irrigated, and designate the actual number of acres to be irrigated in each forty acre tract or fractional portion thereof:

Landowner of Record NAME: THOMAS L WAIT

ADDRESS: 100 MONROE HILL CT HERNDON VA 20170

S	T	R	NE¼				NW¼				SW¼				SE¼				TOTAL			
			NE	NW	SW	SE	NE	NW	SW	SE	NE	NW	SW	SE	NE	NW	SW	SE				
16	11	15E															760 7			764 16	23	
21	11	15E			1162 38					32			771								11	93

116 acres

Landowner of Record NAME: _____

ADDRESS: _____

S	T	R	NE¼				NW¼				SW¼				SE¼				TOTAL				
			NE	NW	SW	SE	NE	NW	SW	SE	NE	NW	SW	SE	NE	NW	SW	SE					

Landowner of Record NAME: _____

ADDRESS: _____

S	T	R	NE¼				NW¼				SW¼				SE¼				TOTAL					
			NE	NW	SW	SE	NE	NW	SW	SE	NE	NW	SW	SE	NE	NW	SW	SE						

Water Resources
Received

NOV 16 2018

2. Please complete the following information for the description of the operation for the irrigation project. Attach supplemental sheets as needed.

a. Indicate the soils in the field(s) and their intake rates:

Soil Name	Percent of field (%)	Intake Rate (in/hr)	Irrigation Design Group
_____	_____	_____	_____
_____	_____	_____	_____
_____	_____	_____	_____
_____	_____	_____	_____
Total:	100 %		

b. Estimate the average land slope in the field(s): _____ %

Estimate the maximum land slope in the field(s): _____ %

c. Type of irrigation system you propose to use (check one):

Center pivot Center pivot - LEPA "Big gun" sprinkler
 Gravity system (furrows) Gravity system (borders) Sideroll sprinkler

Other, please describe: _____

d. System design features:

i. Describe how you will control tailwater:

ii. For sprinkler systems:

(1) Estimate the operating pressure at the distribution system: _____ psi

(2) What is the sprinkler package design rate? _____ gpm

(3) What is the wetted diameter (twice the distance the sprinkler throws water) of a sprinkler on the outer 100 feet of the system? _____ feet

(4) Please include a copy of the sprinkler package design information.

e. Crop(s) you intend to irrigate. Please note any planned crop rotations:

f. Please describe how you will determine when to irrigate and how much water to apply (particularly important if you do not plan a full irrigation).

You may attach any additional information you believe will assist in informing the Division of the need for your request.

(Date)

Kansas Department of Agriculture
Division of Water Resources
David W. Barfield, Chief Engineer
1320 Research Park Drive
Manhattan, Kansas 66502

Re: Application File No. 50167

Minimum Desirable Streamflow
Kansas River Assurance District
Water Reservation Rights

Dear Sir:

I understand that a Minimum Desirable Streamflow requirement has been established, an Assurance District has been formed and established or a Water Reservation Right is held by the Kansas Water Office (**circle the appropriate item**) for the source of supply to which the above referenced application applies, namely the Kansas River.

I understand that diversion of water pursuant to this application will be subject to regulation any time Minimum Desirable Streamflow requirements are not being met, Assurance District or Water Marketing releases are being made from storage in Federal Reservoirs or when a Reservation Right upstream of a Federal Reservoir is being administered.

I also understand that if this application is approved, there could be times, as determined by the Division of Water Resources, when I would not be allowed to divert water. I realize that this could affect the economics of my decision to appropriate water.

I am aware of the above factors, and with the knowledge thereof, request that the Division of Water Resources proceed with processing and approval, if possible, of the above referenced application.

Hook Farms LLC by
R. Shannon Hook Member
Signature of Applicant
R. Shannon Hook
Print Applicant Name

State of Kansas)
County of Shawnee) SS

I hereby certify that the foregoing instrument was signed in my presence and sworn to before me this 14th day of November, 2018

Paula Brazda
Notary Public

My Commission Expires: 8/25/21

 **Paula Brazda**
Notary Public
State of Kansas
My Commission Expires 8/25/21

Water Resources
Received
NOV 16 2018

50167

WELLS WITHIN ONE-HALF MILE

- #1) Leroy Hare Sr (DOM.)
2040 NW Menoken Rd
Topeka KS 66618
- #2) Catherine A Montgomery (DOM.)
2120 NW Menoken Rd
Topeka KS 66618
- #3) James F Munger (DOM.)
2138 NW Menoken Rd
Topeka KS 66618-4703
- #4) Dennis Stover (DOM.)
8548 NW US Hwy 24
Silver Lake KS 66539
- #5) Roy A & Sandra A Sutton (DOM.)
5425 NW 17th St
Topeka KS 66618
- #6) Thomas W Graham (DOM.)
5245 NW 17th St
Topeka KS 66618-3804
- #7) Shawnee Terminal Elevator (Ind – File No. 3058)
PO Box 170
Seneca KS 66538
- #8) Rick Stover (IRR – File No. 27869)
5636 NW 17th St
Topeka KS 66618-4707
- #9) Oldcastle Precast Inc (IND. – File No. 41043)
5230 NW 17th
Topeka KS
- #10) Edward I & Catherine A Clare (IRR. – File No. 48270)
3868 114th St
Meriden KS 66512

Water Resources
Received

NOV 16 2018

KS Dept Of Agriculture

SCANNED

Shawnee Co.

50,167

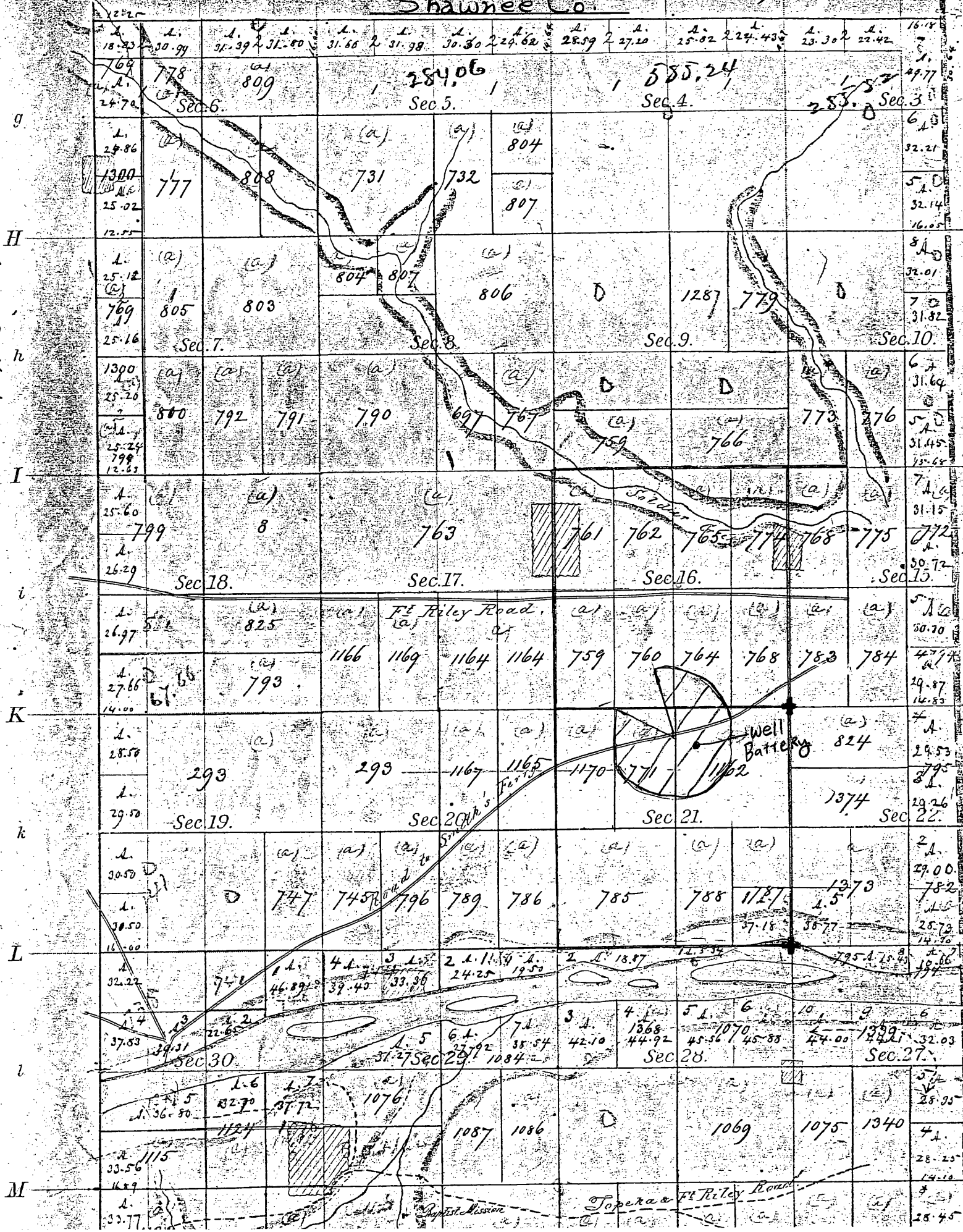

50,167
meets safe
yield

Analysis Results

The selected PD is in an area OPEN to new appropriations.

The safe yield based on the variables listed below is 3,284.14 AF.

Total prior appropriations in the circle is 2,985.86 AF. $-0 = 2985.86$

Total quantity of water available for appropriation is 298.28 AF. ✓

Safe Yield Variables

The area used for the analysis is set at 6,255 acres.

The potential annual recharge at the circle center is estimated to be 8.4 inches.

The percent of recharge available for appropriation is 75%.

Authorized Quantity values are as of 02-JAN-2019 and are based on Appropriated and Vested ground water right and possible stream nodes for GMD #2. Domestic, Term and Temporary water rights have been excluded.

There are 34 water rights and 38 points of diversion within the circle.

File Number	Use	ST	SR	Q4	Q3	Q2	Q1	FeetN	FeetW	Sec	Twp	Rng	ID	Qind	Auth Quant	Add Quant	Tot Acres	Net Acres
A 2639 00	IRR	NK	G		SE	SE	NE	3106	421	17	11	15E	3	WR	70.00	70.00	70.00	70.00
A 2896 00	IRR	NK	G		CW	E2	SW	1300	3950	20	11	15E	5	WR	80.00	80.00	160.00	160.00
A 3058 00	IND	NK	G		SE	SE	SE	0	0	16	11	15E	1	WR	14.55	14.55		
A 6394 00	IRR	NK	G			NC	SW	0	0	21	11	15E	1	WR	123.00	123.00	77.00	77.00
A 7604 00	IRR	NK	G			NC	SW	1255	3958	22	11	15E	1	WR	66.00	66.00	93.60	93.60
A 10154 00	IRR	NK	G			NW	CR	3950	5040	28	11	15E	1	WRF	15.90	15.90	138.00	138.00
A 10154 00	REC	NK	G			NW	CR	3950	5040	28	11	15E	1	WRF	10.33	10.33		
A 19714 00	IRR	NK	G		SW	NW	SE	1840	2080	20	11	15E	2	WR	47.00	47.00 ✓	71.00	71.00
A 27869 00	IRR	NK	G	NC	SE	SE	NW	2975	2989	21	11	15E	8	WR	12.00	12.00	12.00	12.00
A 28246 00	IRR	NK	G			NC	S2	1300	2600	21	11	15E	12	WR	80.00	80.00 ✓	132.00	132.00
A 28631 00	IRR	NK	G		SE	SW	SW	250	4050	20	11	15E	3	WR	32.00	32.00	32.00	32.00
A 29554 00	IRR	NK	G			NC	S2	1300	2600	21	11	15E	12	WR	29.00	29.00 ✓	132.00	0.00
A 30001 00	IRR	NK	G		SE	SE	NE	2690	50	16	11	15E	3	WR	30.00	30.00	43.00	43.00
A 30505 00	IRR	NK	G					3257	1845	15	11	15E	9	WR	105.00	105.00	136.00	136.00
A 32318 00	IRR	NK	G		SW	NE	SE	1500	700	16	11	15E	11	WR	5.90	5.90 ✓	34.92	34.92
A 34067 00	IRR	NK	G		NW	SE	NW	3462	3950	22	11	15E	2	WR	99.00	99.00	110.00	110.00
A 34069 00	IRR	NK	G		SW	NW	NE	4446	2164	21	11	15E	15	WR	106.00	106.00	116.00	116.00
A 34760 00	IRR	NK	G			NC	NW	3960	3960	20	11	15E	4	WR	82.00	82.00	137.00	137.00
A 37660 00	IRR	NK	G		SE	SW	NW	2674	4468	21	11	15E	14	WR	97.00	97.00	117.00	117.00
A 39304 00	IRR	NK	G					4599	1658	15	11	15E	6	WR	59.00	59.00	126.00	126.00
A 39806 00	IRR	NK	G					4599	1658	15	11	15E	6	WR	20.00	20.00	126.00	0.00
A 39960 00	IRR	NK	G		NW	SE	SE	804	666	21	11	15E	11	WR	68.00	68.00	71.00	71.00
A 40355 00	IRR	NK	G		CW	E2	SW	1300	3950	20	11	15E	5	WR	21.00	21.00	160.00	0.00
A 41003 00	IRR	NK	G		NE	SE	SE	1124	228	08	11	15E	6	WR	52.00	52.00	102.00	102.00
A 41043 00	IND	NK	G		SE	SE	NE	3060	205	21	11	15E	13	WR	3.13	3.13		

File Number	Use	ST	SR	Q4	Q3	Q2	Q1	FeetN	FeetW	Sec	Twp	Rng	ID	Qind	Auth Quant	Add Quant	Tot Acres	Net Acres
A 42750 00	IRR	NK	G			NC	S2	1300	2600	21	11	15E	12	WR	125.00	16.00✓	132.00	0.00
A 43212 00	IRR	NK	G		SW	NE	SE	1500	700	16	11	15E	11	WR	33.92	28.02	34.92	0.00
A 46601 00	MUN	LO	G		NE	NE	NE	4929	124	16	11	15E	5	WR	700.01	700.01✓		
Same	MUN	LO	G		NE	NE	NE	4729	459	16	11	15E	6	WR				
Same	MUN	LO	G		SE	NE	NE	4481	119	16	11	15E	7	WR				
Same	MUN	LO	G		NE	NE	NE	4713	234	16	11	15E	9	WR				
A 46602 00	MUN	LO	G		SW	SE	SW	232	3761	09	11	15E	3	WR	700.01	700.01✓		
Same	MUN	LO	G		NW	SE	SW	593	3744	09	11	15E	4	WR				
Same	MUN	LO	G		SE	SW	SW	582	4226	09	11	15E	5	WR				
Same	MUN	LO	G		SW	SE	SW	469	3910	09	11	15E	8	WR				
A 46603 00	MUN	LO	G		SW	SW	SE	228	2473	09	11	15E	6	WR	700.01	0.00✓		
Same	MUN	LO	G		SW	SW	SE	13	2067	09	11	15E	7	WR				
Same	MUN	LO	G		NW	NW	NE	5002	2526	16	11	15E	8	WR				
Same	MUN	LO	G		SW	SW	SE	31	2331	09	11	15E	9	WR				
A 48247 00	IRR	LO	G			NC	NE	3960	1300	20	11	15E	7	WR	101.00	101.00	101.00	101.00
A 48260 A	IRR	KK	G		SW	NW	SE	1840	2080	20	11	15E	2	WR	71.00	24.00	71.00	0.00
A 48270 00	IRR	LO	G		SW	NW	NW	4360	5140	22	11	15E	4	WR	66.00	66.00	66.00	66.00
A 48844 00	REC	LO	G		NE	NW	SW	2050	4250	16	11	15E	12	WR	23.00	23.00		
A 50167 00	IRR	AY	G		SW	NW	NE	4470	2090	21	11	15E	7	WR	116.00	0.00	116.00	0.00
Same	IRR	AY	G		SW	NW	NE	4446	2164	21	11	15E	15	WR				
Same	IRR	AY	G		SW	NW	NE	4433	2113	21	11	15E	16	WR				

Limitations

File Number	Seq Num	Limitations
A 10154 00	1	COMMENT-340 GPM WHEN COMBINED WITH OTHER USES
A 39806 00	2	500 GPM COM/W #39,304
A 40355 00	1	990 GPM COM/W #2896 ON LAND LISTED IN APPROVAL
A 42750 00	2	125 AF/YR @ 1075 GPM COM/W #28246 & 29554 ✓
A 43212 00	3	33.92 AF/YR @ 625 GPM COM/W #32318 ✓
A 46603 00	1400 AF 2	456.2 MGY COM/W #46601 & #46602 ✓
A 48260 A	1	71 AF/YR @ 1000 GPM COM/W #19714 ✓

$80 + 29 = 109 + 16 = 125 ✓$

$5.9 + 28.02 = 33.92 ✓$

$47 + 24 = 71 ✓$

>-----
 A__ 48270 00 IRR LO G
 > EDWARD I & CATHERINE A CLARE
 >
 > 3868 114TH ST
 > MERIDEN KS 66512
 >-----

A__ 48844 00 REC LO G
 > N R HAMM CONTRACTOR INC
 > 609 PERRY PL
 > PO BOX 17
 > PERRY KS 66073
 >-----

A__ 50167 00 IRR AY G
 > HOOK FARMS LLC
 >
 > 8920 NW US HIGHWAY 24
 > SILVER LAKE KS 66539
 >-----

T__ 20169013 SU IND GY G
 > PENNYS CONCRETE LLC
 > JOE MARNEY
 > PO BOX 4449
 > TOPEKA KS 66604
 >-----

 AMOUNT STATISTICS REPORT FOR POINTS OF DIVERSION UNDER A 50167 00 IRR

Water Right and Points of Diversion Within 2.00 miles of point defined as:
 4433 Feet North and 2113 Feet West of the Southeast Corner of Section 21 T 11S R 15E
 GROUNDWATER ONLY

- Geo-Center

All wells > 1,320' meets spacing

File Number	Use	ST	SR	Dist (ft)	Q4	Q3	Q2	Q1	FeetN	FeetW	Sec	Twp	Rng	ID	Batt	Auth_Quan	Add_Quan	Unit
A__ 2639 00	IRR	NK	G	5203	--	SE	SE	NE	3106	421	17	11	15E	3		70.00	70.00	AF
A__ 2896 00	IRR	NK	G	7749	--	CW	E2	SW	1300	3950	20	11	15E	5		80.00	80.00	AF
A__ 3058 00	IND	NK	G	<u>2078</u>	--	SE	SE	SE	-----	-----	16	11	15E	1		14.55	14.55	AF
A__ 6394 00	IRR	NK	G	3683	--	NC	SW	-----	-----	-----	21	11	15E	1		123.00	123.00	AF
A__ 7604 00	IRR	NK	G	4661	--	NC	SW	-----	-----	-----	22	11	15E	1		66.00	66.00	AF
A__ 10154 00	IRR	NK	G	6507	--	NW	CR	-----	-----	-----	28	11	15E	1		15.90	15.90	AF
A__ 10154 00	REC	NK	G	6507	--	NW	CR	-----	-----	-----	28	11	15E	1		10.33	10.33	AF
A__ 10154 00	THX	NK	G	6507	--	NW	CR	-----	-----	-----	28	11	15E	1		53.22	53.22	AF
A__ 19714 00	IRR	NK	G	5833	--	SW	NW	SE	1840	2080	20	11	15E	2		47.00	47.00	AF
A__ 27869 00	IRR	NK	G	<u>1701</u>	NC	SE	SE	NW	2975	2989	21	11	15E	8		12.00	12.00	AF
A__ 28246 00	IRR	NK	G	3171	--	NC	S2	-----	-----	-----	21	11	15E	12		80.00	80.00	AF
A__ 28631 00	IRR	NK	G	8328	--	SE	SW	SW	250	4050	20	11	15E	3		32.00	32.00	AF
A__ 29554 00	IRR	NK	G	3171	--	NC	S2	-----	-----	-----	21	11	15E	12		29.00	29.00	AF
A__ 30001 00	IRR	NK	G	4060	--	SE	SE	NE	2690	50	16	11	15E	3		30.00	30.00	AF
A__ 30505 00	IRR	NK	G	6916	--	---	---	---	3257	1845	15	11	15E	9		105.00	105.00	AF
A__ 32318 00	IRR	NK	G	2716	--	SW	NE	SE	1500	700	16	11	15E	11		5.90	5.90	AF
A__ 34067 00	IRR	NK	G	3618	--	NW	SE	NW	3462	3950	22	11	15E	2		99.00	99.00	AF
A__ 34069 00	IRR	NK	G*	<u>53</u>	--	SW	NW	NE	4446	2164	21	11	15E	15		106.00	106.00	AF

**Applicant's*

Senior File with pd change to create 2 well battery

A__	34760	00	IRR	NK	G	7062	--	--	NC	NW	3960	3960	20	11	15E	4	82.00	82.00	AF
A__	37660	00	IRR	NK	G	2939	--	SE	SW	NW	2674	4468	21	11	15E	14	97.00	97.00	AF
A__	39304	00	IRR	NK	G	7934	--	--	--	--	4599	1658	15	11	15E	6	59.00	59.00	AF
A__	39806	00	IRR	NK	G	7934	--	--	--	--	4599	1658	15	11	15E	6	20.00	20.00	AF
A__	39960	00	IRR	NK	G	3907	--	NW	SE	SE	804	666	21	11	15E	11	68.00	68.00	AF
A__	40355	00	IRR	NK	G	7749	--	CW	E2	SW	1300	3950	20	11	15E	5	21.00	21.00	AF
A__	41003	00	IRR	NK	G	7910	--	NE	SE	SE	1124	228	8	11	15E	6	52.00	52.00	AF
A__	41043	00	IND	NK	G	<u>2351</u>	--	SE	SE	NE	3060	205	21	11	15E	13	3.13	3.13	AF
A__	42750	00	IRR	NK	G	3171	--	--	NC	S2	1300	2600	21	11	15E	12	125.00	16.00	AF
A__	43212	00	IRR	NK	G	2716	--	SW	NE	SE	1500	700	16	11	15E	11	33.92	28.02	AF
A__	46601	00	MUN	LO	G	5861	--	NE	NE	NE	4713	234	16	11	15E	9 G 3	700.01	700.01	AF
Same						6101	--	NE	NE	NE	4929	124	16	11	15E	5 B 3			
Same						5811	--	NE	NE	NE	4729	459	16	11	15E	6 B 3			
Same						5679	--	SE	NE	NE	4481	119	16	11	15E	7 B 3			
A__	46602	00	MUN	LO	G	6854	--	SW	SE	SW	469	3910	9	11	15E	8 G 3	700.01	700.01	AF
Same						6585	--	SW	SE	SW	232	3761	9	11	15E	3 B 3			
Same						6928	--	NW	SE	SW	593	3744	9	11	15E	4 B 3			
Same						7057	--	SE	SW	SW	582	4226	9	11	15E	5 B 3			
A__	46603	00	MUN	LO	G	6146	--	SW	SW	SE	31	2331	9	11	15E	9 G 3	700.01	.00	AF
Same						6352	--	SW	SW	SE	228	2473	9	11	15E	6 B 3			
Same						6118	--	SW	SW	SE	13	2067	9	11	15E	7 B 3			
Same						5885	--	NW	NW	NE	5002	2526	16	11	15E	8 B 3			
A__	48247	00	IRR	LO	G	4418	--	--	NC	NE	3960	1300	20	11	15E	7	101.00	101.00	AF
A__	48260	A	IRR	KK	G	5833	--	SW	NW	SE	1840	2080	20	11	15E	2	71.00	24.00	AF
A__	48270	00	IRR	LO	G	<u>2323</u>	--	SW	NW	NW	4360	5140	22	11	15E	4	66.00	66.00	AF
A__	48844	00	REC	LO	G	3657	--	NE	NW	SW	2050	4250	16	11	15E	12	23.00	23.00	AF
A__	50167	00	IRR	AY	G	0	--	SW	NW	NE	4433	2113	21	11	15E	16 G 2	116.00	.00	AF
Same						44	--	SW	NW	NE	4470	2090	21	11	15E	7 B 2			
Same						53	--	SW	NW	NE	4446	2164	21	11	15E	15 B 2			
T__	20169013	SU	IND	GY	G	7679	--	SE	NW	SW	1560	3990	20	11	15E	6	92.01	92.01	AF

```

=====
Total Net Quantities Authorized:  Direct      Storage
Total Requested Amount (AF) =      .00          .00
Total Permitted Amount (AF) =     116.01         .00
Total Inspected Amount (AF) =     1590.03         .00
Total Pro_Cert Amount (AF) =        .00          .00
Total Certified Amount (AF) =     1425.05         .00
Total Vested Amount (AF) =          .00          .00
TOTAL AMOUNT (AF) =      3131.08         .00

```

An * after the source of supply indicates a pending application for change under the file number.
 An * after the ID indicates a 15 AF exemption was granted under the file number.
 A "G" in the Batt column indicates the GEO CTR of a battery. A "B" indicates a well in the battery.
 The number in the Batt column is the number of wells in the battery.

Water Rights and Points of Diversion Within 2.00 miles of point defined as:

4433 Feet North and 2113 Feet West of the Southeast Corner of Section 21 T 11S R 15E

GROUNDWATER ONLY

WATER USE CORRESPONDENTS:

```

=====
File Number      Use ST SR

```

A__ 2639 00 IRR NK G

> BERNARD SCHWERMANN

STATE OF KANSAS

DEPARTMENT OF AGRICULTURE
DIVISION OF WATER RESOURCES
TOPEKA FIELD OFFICE
6531 SE FORBES AVE., SUITE B
TOPEKA, KS 66619



PHONE: (785) 296-5733
FAX: (785) 296-8298
www.agriculture.ks.gov

GOVERNOR JEFF COLYER, M.D.
JACKIE McCLASKEY, SECRETARY OF AGRICULTURE

December 4, 2018\

JAMES F MUNGER
2138 NW MENOKEN ROAD
TOPEKA KS 66618-4703

Re: Pending New Application, File No. 50,167

Dear Sir or Madam:

This is to advise you that Shannon Hook has filed the application referred to above for a permit to appropriate 116 acre-feet of groundwater per calendar year for irrigation use to be diverted at a maximum rate of 800 gallons per minute. Please note, the proposed point of diversion is **an existing battery of two wells**, currently authorized under Water Right, File No. 34,069. The geographic center of the well battery is located in the Southwest Quarter of the Northwest Quarter of the Northeast Quarter of Section 21, in Township 11 South, Range 15 East, Shawnee County, Kansas.

Records in this office indicate that you may have a well or wells in this vicinity and you are being notified of receipt of this application in order that you may be fully informed of the proposed location of the applicant's point of diversion and proposed use of water. Consideration will be given to comments or other information which you desire to submit to this office **within 15 days** from the date of this letter.

You can find the application and site map posted by the file number referenced above at:
<http://agriculture.ks.gov/divisions-programs/dwr/water-appropriation/notices>

If you have any questions or comments, you may also contact me at (785) 296-3495. If you call, please reference the file number so I can help you more efficiently.

Sincerely,

Douglas W. Schemm
Environmental Scientist
Topeka Field Office

pc: Shannon Hook

STATE OF KANSAS

DEPARTMENT OF AGRICULTURE
DIVISION OF WATER RESOURCES
TOPEKA FIELD OFFICE
6531 SE FORBES AVE., SUITE B
TOPEKA, KS 66619



PHONE: (785) 296-5733
FAX: (785) 296-8298
www.agriculture.ks.gov

GOVERNOR JEFF COLYER, M.D.
JACKIE McCLASKEY, SECRETARY OF AGRICULTURE

December 4, 2018

DENNIS STOVER
8548 NW US HWY 24
SILVER LAKE KS 66539

Re: Pending New Application, File No. 50,167

Dear Sir or Madam:

This is to advise you that Shannon Hook has filed the application referred to above for a permit to appropriate 116 acre-feet of groundwater per calendar year for irrigation use to be diverted at a maximum rate of 800 gallons per minute. Please note, the proposed point of diversion is **an existing battery of two wells**, currently authorized under Water Right, File No. 34,069. The geographic center of the well battery is located in the Southwest Quarter of the Northwest Quarter of the Northeast Quarter of Section 21, in Township 11 South, Range 15 East, Shawnee County, Kansas.

Records in this office indicate that you may have a well or wells in this vicinity and you are being notified of receipt of this application in order that you may be fully informed of the proposed location of the applicant's point of diversion and proposed use of water. Consideration will be given to comments or other information which you desire to submit to this office **within 15 days** from the date of this letter.

You can find the application and site map posted by the file number referenced above at:
<http://agriculture.ks.gov/divisions-programs/dwr/water-appropriation/notices>

If you have any questions or comments, you may also contact me at (785) 296-3495. If you call, please reference the file number so I can help you more efficiently.

Sincerely,

Douglas W. Schemm
Environmental Scientist
Topeka Field Office

pc: Shannon Hook

STATE OF KANSAS

DEPARTMENT OF AGRICULTURE
DIVISION OF WATER RESOURCES
TOPEKA FIELD OFFICE
6531 SE FORBES AVE., SUITE B
TOPEKA, KS 66619



PHONE: (785) 296-5733
FAX: (785) 296-8298
www.agriculture.ks.gov

GOVERNOR JEFF COLYER, M.D.
JACKIE McCLASKEY, SECRETARY OF AGRICULTURE

December 4, 2018

ROY A & SANDRA A SUTTON
5425 NW 17TH STREET
TOPEKA KS 66618

Re: Pending New Application, File No. 50,167

Dear Sir or Madam:

This is to advise you that Shannon Hook has filed the application referred to above for a permit to appropriate 116 acre-feet of groundwater per calendar year for irrigation use to be diverted at a maximum rate of 800 gallons per minute. Please note, the proposed point of diversion is **an existing battery of two wells**, currently authorized under Water Right, File No. 34,069. The geographic center of the well battery is located in the Southwest Quarter of the Northwest Quarter of the Northeast Quarter of Section 21, in Township 11 South, Range 15 East, Shawnee County, Kansas.

Records in this office indicate that you may have a well or wells in this vicinity and you are being notified of receipt of this application in order that you may be fully informed of the proposed location of the applicant's point of diversion and proposed use of water. Consideration will be given to comments or other information which you desire to submit to this office **within 15 days** from the date of this letter.

You can find the application and site map posted by the file number referenced above at:
<http://agriculture.ks.gov/divisions-programs/dwr/water-appropriation/notices>

If you have any questions or comments, you may also contact me at (785) 296-3495. If you call, please reference the file number so I can help you more efficiently.

Sincerely,

Douglas W. Schemm
Environmental Scientist
Topeka Field Office

pc: Shannon Hook

STATE OF KANSAS

DEPARTMENT OF AGRICULTURE
DIVISION OF WATER RESOURCES
TOPEKA FIELD OFFICE
6531 SE FORBES AVE., SUITE B
TOPEKA, KS 66619



PHONE: (785) 296-5733
FAX: (785) 296-8298
www.agriculture.ks.gov

GOVERNOR JEFF COLYER, M.D.
JACKIE MCCLASKEY, SECRETARY OF AGRICULTURE

December 4, 2018

THOMAS W GRAHAM
5245 NW 17TH STREET
TOPEKA KS 66618-3804

Re: Pending New Application, File No. 50,167

Dear Sir or Madam:

This is to advise you that Shannon Hook has filed the application referred to above for a permit to appropriate 116 acre-feet of groundwater per calendar year for irrigation use to be diverted at a maximum rate of 800 gallons per minute. Please note, the proposed point of diversion is **an existing battery of two wells**, currently authorized under Water Right, File No. 34,069. The geographic center of the well battery is located in the Southwest Quarter of the Northwest Quarter of the Northeast Quarter of Section 21, in Township 11 South, Range 15 East, Shawnee County, Kansas.

Records in this office indicate that you may have a well or wells in this vicinity and you are being notified of receipt of this application in order that you may be fully informed of the proposed location of the applicant's point of diversion and proposed use of water. Consideration will be given to comments or other information which you desire to submit to this office **within 15 days** from the date of this letter.

You can find the application and site map posted by the file number referenced above at:
<http://agriculture.ks.gov/divisions-programs/dwr/water-appropriation/notices>

If you have any questions or comments, you may also contact me at (785) 296-3495. If you call, please reference the file number so I can help you more efficiently.

Sincerely,

Douglas W. Schemm
Environmental Scientist
Topeka Field Office

pc: Shannon Hook

STATE OF KANSAS

DEPARTMENT OF AGRICULTURE
DIVISION OF WATER RESOURCES
TOPEKA FIELD OFFICE
6531 SE FORBES AVE., SUITE B
TOPEKA, KS 66619



PHONE: (785) 296-5733
FAX: (785) 296-8298
www.agriculture.ks.gov

GOVERNOR JEFF COLYER, M.D.
JACKIE McCLASKEY, SECRETARY OF AGRICULTURE

December 4, 2018

SHAWNEE TERMINAL ELEVATOR
PO BOX 170
SENECA KS 66538

Re: Pending New Application, File No. 50,167

Dear Sir or Madam:

This is to advise you that Shannon Hook has filed the application referred to above for a permit to appropriate 116 acre-feet of groundwater per calendar year for irrigation use to be diverted at a maximum rate of 800 gallons per minute. Please note, the proposed point of diversion is **an existing battery of two wells**, currently authorized under Water Right, File No. 34,069. The geographic center of the well battery is located in the Southwest Quarter of the Northwest Quarter of the Northeast Quarter of Section 21, in Township 11 South, Range 15 East, Shawnee County, Kansas.

Records in this office indicate that you may have a well or wells in this vicinity and you are being notified of receipt of this application in order that you may be fully informed of the proposed location of the applicant's point of diversion and proposed use of water. Consideration will be given to comments or other information which you desire to submit to this office **within 15 days** from the date of this letter.

You can find the application and site map posted by the file number referenced above at:
<http://agriculture.ks.gov/divisions-programs/dwr/water-appropriation/notices>

If you have any questions or comments, you may also contact me at (785) 296-3495. If you call, please reference the file number so I can help you more efficiently.

Sincerely,

Douglas W. Schemm
Environmental Scientist
Topeka Field Office

pc: Shannon Hook

STATE OF KANSAS

DEPARTMENT OF AGRICULTURE
DIVISION OF WATER RESOURCES
TOPEKA FIELD OFFICE
6531 SE FORBES AVE., SUITE B
TOPEKA, KS 66619



PHONE: (785) 296-5733
FAX: (785) 296-8298
www.agriculture.ks.gov

GOVERNOR JEFF COLYER, M.D.
JACKIE McCLASKEY, SECRETARY OF AGRICULTURE

December 4, 2018

RICK STOVER
5636 NW 17TH STREET
TOPEKA KS 66618-4707

Re: Pending New Application, File No. 50,167

Dear Sir or Madam:

This is to advise you that Shannon Hook has filed the application referred to above for a permit to appropriate 116 acre-feet of groundwater per calendar year for irrigation use to be diverted at a maximum rate of 800 gallons per minute. Please note, the proposed point of diversion is **an existing battery of two wells**, currently authorized under Water Right, File No. 34,069. The geographic center of the well battery is located in the Southwest Quarter of the Northwest Quarter of the Northeast Quarter of Section 21, in Township 11 South, Range 15 East, Shawnee County, Kansas.

Records in this office indicate that you may have a well or wells in this vicinity and you are being notified of receipt of this application in order that you may be fully informed of the proposed location of the applicant's point of diversion and proposed use of water. Consideration will be given to comments or other information which you desire to submit to this office **within 15 days** from the date of this letter.

You can find the application and site map posted by the file number referenced above at:
<http://agriculture.ks.gov/divisions-programs/dwr/water-appropriation/notices>

If you have any questions or comments, you may also contact me at (785) 296-3495. If you call, please reference the file number so I can help you more efficiently.

Sincerely,

Douglas W. Schemm
Environmental Scientist
Topeka Field Office

pc: Shannon Hook

STATE OF KANSAS

DEPARTMENT OF AGRICULTURE
DIVISION OF WATER RESOURCES
TOPEKA FIELD OFFICE
6531 SE FORBES AVE., SUITE B
TOPEKA, KS 66619



PHONE: (785) 296-5733
FAX: (785) 296-8298
www.agriculture.ks.gov

GOVERNOR JEFF COLYER, M.D.
JACKIE McCLASKEY, SECRETARY OF AGRICULTURE

December 4, 2018

OLDCASTLE PRECAST INC
5230 NW 17TH
TOPEKA KS 66618

Re: Pending New Application, File No. 50,167

Dear Sir or Madam:

This is to advise you that Shannon Hook has filed the application referred to above for a permit to appropriate 116 acre-feet of groundwater per calendar year for irrigation use to be diverted at a maximum rate of 800 gallons per minute. Please note, the proposed point of diversion is **an existing battery of two wells**, currently authorized under Water Right, File No. 34,069. The geographic center of the well battery is located in the Southwest Quarter of the Northwest Quarter of the Northeast Quarter of Section 21, in Township 11 South, Range 15 East, Shawnee County, Kansas.

Records in this office indicate that you may have a well or wells in this vicinity and you are being notified of receipt of this application in order that you may be fully informed of the proposed location of the applicant's point of diversion and proposed use of water. Consideration will be given to comments or other information which you desire to submit to this office **within 15 days** from the date of this letter.

You can find the application and site map posted by the file number referenced above at:
<http://agriculture.ks.gov/divisions-programs/dwr/water-appropriation/notices>

If you have any questions or comments, you may also contact me at (785) 296-3495. If you call, please reference the file number so I can help you more efficiently.

Sincerely,

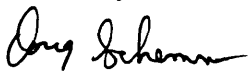
Douglas W. Schemm
Environmental Scientist
Topeka Field Office

pc: Shannon Hook

STATE OF KANSAS

DEPARTMENT OF AGRICULTURE
DIVISION OF WATER RESOURCES
TOPEKA FIELD OFFICE
6531 SE FORBES AVE., SUITE B
TOPEKA, KS 66619



PHONE: (785) 296-5733
FAX: (785) 296-8298
www.agriculture.ks.gov

GOVERNOR JEFF COLYER, M.D.
JACKIE McCLASKEY, SECRETARY OF AGRICULTURE

December 4, 2018

EDWARD I & CATHERINE A CLARE
3868 114TH ST
MERIDEN KS 66512

Re: Pending New Application, File No. 50,167

Dear Sir or Madam:

This is to advise you that Shannon Hook has filed the application referred to above for a permit to appropriate 116 acre-feet of groundwater per calendar year for irrigation use to be diverted at a maximum rate of 800 gallons per minute. Please note, the proposed point of diversion is **an existing battery of two wells**, currently authorized under Water Right, File No. 34,069. The geographic center of the well battery is located in the Southwest Quarter of the Northwest Quarter of the Northeast Quarter of Section 21, in Township 11 South, Range 15 East, Shawnee County, Kansas.

Records in this office indicate that you may have a well or wells in this vicinity and you are being notified of receipt of this application in order that you may be fully informed of the proposed location of the applicant's point of diversion and proposed use of water. Consideration will be given to comments or other information which you desire to submit to this office **within 15 days** from the date of this letter.

You can find the application and site map posted by the file number referenced above at:
<http://agriculture.ks.gov/divisions-programs/dwr/water-appropriation/notices>

If you have any questions or comments, you may also contact me at (785) 296-3495. If you call, please reference the file number so I can help you more efficiently.

Sincerely,

Douglas W. Schemm
Environmental Scientist
Topeka Field Office

pc: Shannon Hook

STATE OF KANSAS

DEPARTMENT OF AGRICULTURE
DIVISION OF WATER RESOURCES
TOPEKA FIELD OFFICE
6531 SE FORBES AVE., SUITE B
TOPEKA, KS 66619



PHONE: (785) 296-5733
FAX: (785) 296-8298
www.agriculture.ks.gov

GOVERNOR JEFF COLYER, M.D.
JACKIE McCLASKEY, SECRETARY OF AGRICULTURE

December 4, 2018

CATHERINE A MONTGOMERY
2120 NW MENOKEN ROAD
TOPEKA KS 66618

Re: Pending New Application, File No. 50,167

Dear Sir or Madam:

This is to advise you that Shannon Hook has filed the application referred to above for a permit to appropriate 116 acre-feet of groundwater per calendar year for irrigation use to be diverted at a maximum rate of 800 gallons per minute. Please note, the proposed point of diversion is **an existing battery of two wells**, currently authorized under Water Right, File No. 34,069. The geographic center of the well battery is located in the Southwest Quarter of the Northwest Quarter of the Northeast Quarter of Section 21, in Township 11 South, Range 15 East, Shawnee County, Kansas.

Records in this office indicate that you may have a well or wells in this vicinity and you are being notified of receipt of this application in order that you may be fully informed of the proposed location of the applicant's point of diversion and proposed use of water. Consideration will be given to comments or other information which you desire to submit to this office **within 15 days** from the date of this letter.

You can find the application and site map posted by the file number referenced above at:
<http://agriculture.ks.gov/divisions-programs/dwr/water-appropriation/notices>

If you have any questions or comments, you may also contact me at (785) 296-3495. If you call, please reference the file number so I can help you more efficiently.

Sincerely,

Douglas W. Schemm
Environmental Scientist
Topeka Field Office

pc: Shannon Hook

STATE OF KANSAS



PHONE: (785) 296-5733

FAX: (785) 296-8298

www.agriculture.ks.gov

DEPARTMENT OF AGRICULTURE
DIVISION OF WATER RESOURCES
TOPEKA FIELD OFFICE
6531 SE FORBES AVE., SUITE B
TOPEKA, KS 66619

GOVERNOR JEFF COLYER, M.D.
JACKIE McCLASKEY, SECRETARY OF AGRICULTURE

December 4, 2018

LEROY HARE SR
2040 NW MENOKEN ROAD
TOPEKA KS 66618

Re: Pending New Application, File No. 50,167

Dear Sir or Madam:

This is to advise you that Shannon Hook has filed the application referred to above for a permit to appropriate 116 acre-feet of groundwater per calendar year for irrigation use to be diverted at a maximum rate of 800 gallons per minute. Please note, the proposed point of diversion is **an existing battery of two wells**, currently authorized under Water Right, File No. 34,069. The geographic center of the well battery is located in the Southwest Quarter of the Northwest Quarter of the Northeast Quarter of Section 21, in Township 11 South, Range 15 East, Shawnee County, Kansas.

Records in this office indicate that you may have a well or wells in this vicinity and you are being notified of receipt of this application in order that you may be fully informed of the proposed location of the applicant's point of diversion and proposed use of water. Consideration will be given to comments or other information which you desire to submit to this office **within 15 days** from the date of this letter.

You can find the application and site map posted by the file number referenced above at:
<http://agriculture.ks.gov/divisions-programs/dwr/water-appropriation/notices>

If you have any questions or comments, you may also contact me at (785) 296-3495. If you call, please reference the file number so I can help you more efficiently.

Sincerely,

Douglas W. Schemm
Environmental Scientist
Topeka Field Office

pc: Shannon Hook

WATER WELL RECORD Form WWC-5

Division of Water Resources App. No.

34069

Well ID

Original Record Correction Change in Well Use

1 LOCATION OF WATER WELL: County: Shawnee Fraction: NE 1/4 SW 1/4 NW 1/4 NE 1/4 Section Number: 21 Township Number: T 11 S Range Number: R 15 E W

2 WELL OWNER: Last Name: Hook First: Shannon Street or Rural Address where well is located (if unknown, distance and direction from nearest town or intersection): If at owner's address, check here:
 Business: Hook Farms Address: 8948 NW US HWY 24 1/4 mi South of 24 HWY & Menoken Rd. West side of Menoken Rd
 Address: City: Silver Lake State: KS ZIP: 66539

3 LOCATE WELL WITH "X" IN SECTION BOX:

N

		X	

W E

S

-----1 mile-----

4 DEPTH OF COMPLETED WELL: 50 ft.
 Depth(s) Groundwater Encountered: 1) 23 ft.
 2) ft. 3) ft. or 4) Dry Well
 WELL'S STATIC WATER LEVEL: 12 ft.
 below land surface, measured on (mo-day-yr) 2/21/2018
 above land surface, measured on (mo-day-yr)
 Pump test data: Well water was ft. after hours pumping gpm
 Well water was ft. after hours pumping gpm
 Estimated Yield: 500 gpm
 Bore Hole Diameter: 24 in. to 50 ft. and in. to ft.

5 Latitude: 39.085189 (decimal degrees)
Longitude: 95.751070 (decimal degrees)
 Datum: WGS 84 NAD 83 NAD 27
 Source for Latitude/Longitude:
 GPS (unit make/model: (WAAS enabled? Yes No)
 Land Survey Topographic Map
 Online Mapper:
6 Elevation: 885 ft. Ground Level TOC
 Source: Land Survey GPS Topographic Map
 Other KOLAR

7 WELL WATER TO BE USED AS:

1. Domestic: Household Lawn & Garden Livestock
 Irrigation
 Feedlot
 Industrial

2. Public Water Supply: well ID
 Dewatering: how many wells?
 Aquifer Recharge: well ID
 Monitoring: well ID
 Environmental Remediation: well ID
 Air Sparge Soil Vapor Extraction
 Recovery Injection

10. Oil Field Water Supply: lease
 11. Test Hole: well ID
 Cased Uncased Geotechnical
 12. Geothermal: how many bores?
 a) Closed Loop Horizontal Vertical
 b) Open Loop Surface Discharge Inj. of Water
 13. Other (specify):

Was a chemical/bacteriological sample submitted to KDHE? Yes No If yes, date sample was submitted:
 Water well disinfected? Yes No

8 TYPE OF CASING USED: Steel PVC Other CASING JOINTS: Glued Clamped Welded Threaded
 Casing diameter 16 in. to 50 ft., Diameter in. to ft., Diameter in. to ft.
 Casing height above land surface 24 in. Weight lbs./ft. Wall thickness or gauge No. SDR20
TYPE OF SCREEN OR PERFORATION MATERIAL:
 Steel Stainless Steel Fiberglass PVC Other (Specify)
 Brass Galvanized Steel Concrete tile None used (open hole)
SCREEN OR PERFORATION OPENINGS ARE:
 Continuous Slot Mill Slot Gauze Wrapped Torch Cut Drilled Holes Other (Specify)
 Louvered Shutter Key Punched Wire Wrapped Saw Cut None (Open Hole)
SCREEN-PERFORATED INTERVALS: From 25 ft. to 45 ft., From ft. to ft., From ft. to ft.
GRAVEL PACK INTERVALS: From 21 ft. to 50 ft., From ft. to ft., From ft. to ft.

9 GROUT MATERIAL: Neat cement Cement grout Bentonite Other
 Grout Intervals: From 0 ft. to 21 ft., From ft. to ft., From ft. to ft.

Nearest source of possible contamination:
 Septic Tank Lateral Lines Pit Privy Livestock Pens Insecticide Storage
 Sewer Lines Cess Pool Sewage Lagoon Fuel Storage Abandoned Water Well
 Watertight Sewer Lines Seepage Pit Feedyard Fertilizer Storage Oil Well/Gas Well
 Other (Specify)
 Direction from well? Distance from well? ft.

10 FROM	TO	LITHOLOGIC LOG	FROM	TO	LITHO. LOG (cont.) or PLUGGING INTERVALS
0	1	Clay			
1	11	Fine Sand w/Clay			
11	15	Fine Sand			
15	23	Grey Sand			
23	43	Medium Sand			
43	46	Boulders			
46	50	Shale			
Notes:					

11 CONTRACTOR'S OR LANDOWNER'S CERTIFICATION: This water well was constructed, reconstructed, or plugged under my jurisdiction and was completed on (mo-day-year) 2/21/2018 and this record is true to the best of my knowledge and belief. Kansas Water Well Contractor's License No. 760 This Water Well Record was completed on (mo-day-year) 2/21/2018 under the business name of Associated Drilling, Inc.

Send one copy to WATER WELL OWNER and retain one for your records. Fee of \$5.00 for each constructed well.
 KS Department of Health and Environment, Bureau of Water, Geology Section, 1000 SW Jackson St., Suite 420, Topeka, Kansas 66612-1367. Telephone 785-296-3565.
 Visit us at <http://www.kdheks.gov/waterwell/index.html> KSA 82a-1212

STATE OF KANSAS

DEPARTMENT OF AGRICULTURE
1320 RESEARCH PARK DRIVE
MANHATTAN, KS 66502
PHONE: (785) 564-6700
FAX: (785) 564-6777



900 SW JACKSON, ROOM 456
TOPEKA, KS 66612
PHONE: (785) 296-3556
www.agriculture.ks.gov

GOVERNOR JEFF COLYER, M.D.
JACKIE McCLASKEY, SECRETARY OF AGRICULTURE

November 21, 2018

SHANNON HOOK
8948 NW US HWY 24
SILVER LAKE, KS 66539

RE: Application, File No. **50167**

Dear Sir or Madam:

The Division of Water Resources (Division) has received your application for a permit to appropriate water for beneficial use. Your application has been assigned the file number referenced above. Please be aware that the Division may have a large number of pending applications on hand at times and makes every attempt to process them in the order in which they are received. You will be contacted if additional information is required.

Please note, this letter only acknowledges receipt of your application and does not guarantee approval. In accordance with the provisions of the Kansas Water Appropriation Act, the use of water as proposed prior to approval of the application is unlawful.

Additional information about the process may be found on our website at agriculture.ks.gov/divisions-programs/dwr. If you have any other questions, please contact our office at 785-564-6640 or your local Topeka Field Office at 785-296-5733. If you call, please reference the file number so we can help you more efficiently.

Sincerely,

A handwritten signature in black ink that reads "Brent A. Tourney". The signature is written in a cursive style.

Brent Tourney, L.G.
Change Applications Unit Supervisor
Water Appropriation Program

SCANNED

**IRRIGATION USE
SUPPLEMENTAL SHEET**

File No. 50167

Name of Applicant (Please Print): SHANNON HOOK

1. Please supply the name and address of each landowner, the legal description of the lands to be irrigated, and designate the actual number of acres to be irrigated in each forty acre tract or fractional portion thereof:

Landowner of Record NAME: THOMAS L WAIT
ADDRESS: 100 MONROE HILL CT HERNDON VA 20170

S	T	R	NE¼				NW¼				SW¼				SE¼				TOTAL							
			NE	NW	SW	SE	NE	NW	SW	SE	NE	NW	SW	SE	NE	NW	SW	SE								
16	11	15E																7			16					23
21	11	15E		38	12			32																		93

Landowner of Record NAME: _____
ADDRESS: _____

S	T	R	NE¼				NW¼				SW¼				SE¼				TOTAL							
			NE	NW	SW	SE	NE	NW	SW	SE	NE	NW	SW	SE	NE	NW	SW	SE								

Landowner of Record NAME: _____
ADDRESS: _____

S	T	R	NE¼				NW¼				SW¼				SE¼				TOTAL							
			NE	NW	SW	SE	NE	NW	SW	SE	NE	NW	SW	SE	NE	NW	SW	SE								

Water Resources
Received

2. Please complete the following information for the description of the operation for the irrigation project. Attach supplemental sheets as needed.

a. Indicate the soils in the field(s) and their intake rates:

Soil Name	Percent of field (%)	Intake Rate (in/hr)	Irrigation Design Group
_____	_____	_____	_____
_____	_____	_____	_____
_____	_____	_____	_____
_____	_____	_____	_____
Total:	100 %		

b. Estimate the average land slope in the field(s): _____%

Estimate the maximum land slope in the field(s): _____%

c. Type of irrigation system you propose to use (check one):

- Center pivot
 Center pivot - LEPA
 "Big gun" sprinkler
 Gravity system (furrows)
 Gravity system (borders)
 Sideroll sprinkler

Other, please describe: _____

d. System design features:

i. Describe how you will control tailwater:

ii. For sprinkler systems:

- (1) Estimate the operating pressure at the distribution system: _____ psi
- (2) What is the sprinkler package design rate? _____ gpm
- (3) What is the wetted diameter (twice the distance the sprinkler throws water) of a sprinkler on the outer 100 feet of the system? _____ feet
- (4) Please include a copy of the sprinkler package design information.

e. Crop(s) you intend to irrigate. Please note any planned crop rotations:

f. Please describe how you will determine when to irrigate and how much water to apply (particularly important if you do not plan a full irrigation).

You may attach any additional information you believe will assist in informing the Division of the need for your request.

1:12,000

New Application

50167

