

NOTICE

This scan only represents the application as filed. The information contained herein meets the requirements of K.A.R. 5-3-1 or K.A.R. 5-5-1, and has been found acceptable for filing in the office of the Chief Engineer. The application should not be considered to be a complete application as per K.A.R. 5-3-1b or K.A.R. 5-5-2a.

THE STATE OF KANSAS



KANSAS DEPARTMENT OF AGRICULTURE
Mike Beam, Secretary of Agriculture

DIVISION OF WATER RESOURCES
David W. Barfield, Chief Engineer

File Number 50251
This item to be completed by the Division of Water Resources.

Water Resources
Received

MAY 06 2019

2:00

APPLICATION FOR PERMIT TO
APPROPRIATE WATER FOR BENEFICIAL USE

Filing Fee Must Accompany the Application
(Please refer to Fee Schedule attached to this application form.)

KS Dept Of Agriculture

To the Chief Engineer of the Division of Water Resources, Kansas Department of Agriculture,
1320 Research Park Drive, Manhattan, KS 66502:

1. Name of Applicant (Please Print): WICKSTRUM FARMS INC

Address: 11870 HWY 13

City: WESTMORELAND State: KS Zip Code 66549-9660

Telephone Number: (785) 457-3549

2. The source of water is: surface water in MCINTIRE CREEK TRIB 2 ^{# 3066}

(stream)

OR groundwater in BIG BLUE RIVER

(drainage basin)

Certain streams in Kansas have minimum target flows established by law or may be subject to administration when water is released from storage for use by water assurance district members. If your application is subject to these regulations on the date we receive your application, you will be sent the appropriate form to complete and return to the Division of Water Resources. **REDIVERSION OF 256.25 AF @ 1,500 GPM**

3. The maximum quantity of water desired is 256.25 acre-feet OR _____ gallons per calendar year, to be diverted at a maximum rate of NF gallons per minute OR _____ cubic feet per second.

Once your application has been assigned a priority, the requested maximum rate of diversion and maximum requested quantity of water under that priority number can **NOT** be increased. Please be certain your requested maximum rate of diversion and maximum quantity of water are appropriate and reasonable for your proposed project and are in agreement with the Division of Water Resources' requirements.

4. The water is intended to be appropriated for (Check use intended):

- | | | | |
|--|--|---|---|
| (a) <input type="checkbox"/> Artificial Recharge | (b) <input checked="" type="checkbox"/> Irrigation | (c) <input type="checkbox"/> Recreational | (d) <input type="checkbox"/> Water Power |
| (e) <input type="checkbox"/> Industrial | (f) <input type="checkbox"/> Municipal | (g) <input checked="" type="checkbox"/> Stockwatering | (h) <input type="checkbox"/> Sediment Control |
| (i) <input type="checkbox"/> Domestic | (j) <input type="checkbox"/> Dewatering | (k) <input type="checkbox"/> Hydraulic Dredging | (l) <input type="checkbox"/> Fire Protection |
| (m) <input type="checkbox"/> Thermal Exchange | (n) <input type="checkbox"/> Contamination Remediation | | |

YOU **MUST** COMPLETE AND ATTACH ADDITIONAL DIVISION OF WATER RESOURCES FORM(S) PROVIDING INFORMATION TO SUBSTANTIATE YOUR REQUEST FOR THE AMOUNT OF WATER FOR THE INTENDED USE REFERENCED ABOVE.

For Office Use Only:							
F.O. Code	GMD <u>0</u>	Meets K.A.R. 5-3-1	(YES/NO) Use <u>1225K</u>	Source <u>G(S)</u>	County <u>PT</u>	By <u>DAW</u>	Date <u>5/6/19</u>
	REG <u>REZ</u>	Fee \$ <u>300</u>	TR # _____	Receipt Date <u>5/10/19</u>	Check # <u>42889</u>		

5/7/2019 LLM

5. The location of the proposed wells, pump sites or other works for diversion of water is:

Note: For the application to be accepted, the point of diversion location must be described to at least a 10 acre tract, unless you specifically request a 60 day period of time in which to locate the site within a specifically described, minimal legal quarter section of land.

- (A) One in the NW quarter of the NE quarter of the NW quarter of Section 17, more particularly described as being near a point 4902 feet North and 3907 feet West of the Southeast corner of said section, in Township 8 South, Range 8 EAST, POTTAWATOMIE County, Kansas.
- (B) One in the _____ quarter of the _____ quarter of the _____ quarter of Section _____, more particularly described as being near a point _____ feet North and _____ feet West of the Southeast corner of said section, in Township _____ South, Range _____ East/West (circle one), _____ County, Kansas.
- (C) One in the _____ quarter of the _____ quarter of the _____ quarter of Section _____, more particularly described as being near a point _____ feet North and _____ feet West of the Southeast corner of said section, in Township _____ South, Range _____ East/West (circle one), _____ County, Kansas.
- (D) One in the _____ quarter of the _____ quarter of the _____ quarter of Section _____, more particularly described as being near a point _____ feet North and _____ feet West of the Southeast corner of said section, in Township _____ South, Range _____ East/West (circle one), _____ County, Kansas.

If the source of supply is groundwater, a separate application shall be filed for each proposed well or battery of wells, except that a single application may include up to four wells within a circle with a quarter (1/4) mile radius in the same local source of supply which do not exceed a maximum diversion rate of 20 gallons per minute per well.

A battery of wells is defined as two or more wells connected to a common pump by a manifold; or not more than four wells in the same local source of supply within a 300 foot radius circle which are being operated by pumps not to exceed a total maximum diversion rate of 800 gallons per minute and which supply water to a common distribution system.

6. The owner of the point of diversion, if other than the applicant is (please print):

(name, address and telephone number)

(name, address and telephone number)

You must provide evidence of legal access to, or control of, the point of diversion from the landowner or the landowner's authorized representative. Provide a copy of a recorded deed, lease, easement or other document with this application. In lieu thereof, you may sign the following sworn statement:

I have legal access to, or control of, the point of diversion described in this application from the landowner or the landowner's authorized representative. I declare under penalty of perjury that the foregoing is true and correct.

Executed on 03 May, 2019. X Garry Wickstrom
Applicant's Signature

7. The proposed project for diversion of water will consist of ONE DAM AND RESERVOIR
(number of wells, pumps or dams, etc.)

and (will be) completed (by) FALL 2019
(Month/Day/Year - each was or will be completed)

8. The first actual application of water for the proposed beneficial use was or is estimated to be FALL 2019
(Mo/Day/Year)

9. Will pesticide, fertilizer, or other foreign substance be injected into the water pumped from the diversion works?

Yes No If "yes", a check valve shall be required.

All chemigation safety requirements must be met including a chemigation permit and reporting requirements.

10. If you are planning to impound water, please contact the Division of Water Resources for assistance, prior to submitting the application. Please attach a reservoir area capacity table and inform us of the total acres of surface drainage area above the reservoir.

Have you also made an application for a permit for construction of this dam and reservoir with the Division of Water Resources? Yes No

• If yes, show the Water Structures permit number here DPT-0171

• If no, explain here why a Water Structures permit is not required _____

11. The application must be supplemented by a U.S.G.S. topographic map, aerial photograph or a detailed plat showing the following information. On the topographic map, aerial photograph, or plat, identify the center of the section, the section lines or the section corners and show the appropriate section, township and range numbers. Also, please show the following information:

(a) The location of the proposed point(s) of diversion (wells, stream-bank installations, dams, or other diversion works) should be plotted as described in Paragraph No. 5 of the application, showing the North-South distance and the East-West distance from a section line or southeast corner of section.

(b) If the application is for groundwater, please show the location of any existing water wells of any kind within 1/2 mile of the proposed well or wells. Identify each existing well as to its use and furnish the name and mailing address of the property owner or owners. If there are no wells within 1/2 mile, please advise us.

(c) If the application is for surface water, the names and addresses of the landowner(s) 1/2 mile downstream and 1/2 mile upstream from your property lines must be shown.

(d) The location of the proposed place of use should be shown by crosshatching on the topographic map, aerial photograph or plat.

(e) Show the location of the pipelines, canals, reservoirs or other facilities for conveying water from the point of diversion to the place of use.

A 7.5 minute U.S.G.S. topographic map may be obtained by providing the section, township and range numbers to: Kansas Geological Survey, 1930 Constant, Campus West, University of Kansas, Lawrence, Kansas 66047.

12. List any application, appropriation of water, water right, or vested right file number that covers the same diversion points or any of the same place of use described in this application. Also list any other recent modifications made to existing permits or water rights in conjunction with the filing of this application.

PU OVERLAP 46,470; 48,177; AND 50,013 (STK USE)

PU OVERLAP 48,528 AND 48,529 (IRR USE) QUANTITY BASED ON POTENTIAL ANNUAL RUNOFF

FROM 205 ACRE DRAINAGE AREA. STK USE 150 AF (48.9 MGY) LIMITED TO 71.175 WITH SENIOR

STK FILES. IRR USE = 256.25 AF (LIMITED TO 773.85 WITH SENIOR IRR FILES) BOTH USES

UNDER THIS FILE LIMITED TO 256.25 AF

Received

MAY 06 2019

13. Furnish the following well information if the proposed appropriation is for the use of groundwater. If the well has not been completed, give information obtained from test holes, if available.

Information below is from: Test holes Well as completed Drillers log attached

Well location as shown in paragraph No.	(A)	(B)	(C)	(D)
Date Drilled	_____	_____	_____	_____
Total depth of well	_____	_____	_____	_____
Depth to water bearing formation	_____	_____	_____	_____
Depth to static water level	_____	_____	_____	_____
Depth to bottom of pump intake pipe	_____	_____	_____	_____

14. The relationship of the applicant to the proposed place where the water will be used is that of owner
(owner, tenant, agent or otherwise)

15. The owner(s) of the property where the water is used, if other than the applicant, is (please print):

(name, address and telephone number)

(name, address and telephone number)

16. The undersigned states that the information set forth above is true to the best of his/her knowledge and that this application is submitted in good faith.

Dated at 03 May, Kansas, this ____ day of _____, 2019
(month) (year)

x Larry Wickstrom
(Applicant Signature)

By _____
(Agent or Officer Signature)

(Agent or Officer - Please Print)

03 May 2019
(Date)

Kansas Department of Agriculture
Division of Water Resources
David W. Barfield, Chief Engineer
1320 Research Park Drive
Manhattan, Kansas 66502

Re: Application File No. 50251

Minimum Desirable Streamflow

Dear Sir:

I understand that a Minimum Desirable Streamflow requirement has been established by the legislature for the source of supply to which the above referenced application applies.

I understand that diversion of water pursuant to this application will be subject to regulation any time Minimum Desirable Streamflow requirements are not being met.

I also understand that if this application is approved, there could be times, as determined by the Division of Water Resources, when I would not be allowed to divert water. I realize that this could affect the economics of my decision to appropriate water.

I am aware of the above factors, and with the knowledge thereof, request that the Division of Water Resources proceed with processing and approval, if possible, of the above referenced application.

Larry Wickstrum
Signature of Applicant

State of Kansas)
County of Pottawatomie) ss

Larry Wickstrum
(Print Applicant's Name)

I hereby certify that the foregoing instrument was signed in my presence and sworn to before me this 3 day of May, 2019.

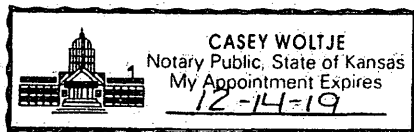

Casey Woltje
Notary Public

My Commission Expires: 12-14-2019

Water Resources
Received

MAY 06 2019

**MINIMUM DESIRABLE STREAMFLOW FORM TO BE USED WHEN
APPLICABLE WHEN FILING AN APPLICATION FOR PERMIT
TO APPROPRIATE WATER FOR BENEFICIAL USE**

The Kansas Legislature has established minimum desirable streamflows for the streams listed below. If your proposed diversion of water is going to be from one of these watercourses or adjacent alluvial aquifers, please complete the back side of this page and submit it along with your application for permit to appropriate water.

Arkansas River	Ninnescah River
Big Blue River	North Fork Ninnescah River
Chapman Creek	Rattlesnake Creek
Chikaskia River	Republican River
Cottonwood River	Saline River
Delaware River	Smoky Hill River
Little Arkansas River	Solomon River
Little Blue River	South Fork Ninnescah
Marais des Cygnes River	Spring River
Medicine Lodge River	Walnut River
Mill Creek (Wabaunsee Co. area)	Whitewater River
Neosho River	

1320 Research Park Drive
Manhattan, KS 66502
785-564-6700
www. agriculture.ks.gov



900 SW Jackson, Room 456
Topeka, KS 66612
785-296-3556

Mike Beam, Secretary

Laura Kelly, Governor

May 6, 2019

WICKSTRUM FARMS, INC
11870 HWY 13
WESTMORELAND, KS 66549

RE: Application, File No. **50251**

Dear Sir or Madam:

The Division of Water Resources (Division) has received your application for a permit to appropriate water for beneficial use. Your application has been assigned the file number referenced above. Please be aware that the Division may have a large number of pending applications on hand at times and makes every attempt to process them in the order in which they are received. You will be contacted if additional information is required.

Please note, this letter only acknowledges receipt of your application and does not guarantee approval. In accordance with the provisions of the Kansas Water Appropriation Act, the use of water as proposed prior to approval of the application is unlawful.

Additional information about the process may be found on our website at agriculture.ks.gov/divisions-programs/dwr. If you have any other questions, please contact our office at 785-564-6640 or your local Topeka Field Office at 785-296-5733. If you call, please reference the file number so we can help you more efficiently.

Sincerely,

A handwritten signature in cursive script that reads "Kristen A. Baum".

Kristen A. Baum
New Applications Unit Supervisor
Water Appropriation Program

**IRRIGATION USE
SUPPLEMENTAL SHEET**

File No. 50251

Name of Applicant (Please Print): WICKSTROM FARMS INC.

1. Please supply the name and address of each landowner, the legal description of the lands to be irrigated, and designate the actual number of acres to be irrigated in each forty acre tract or fractional portion thereof:

Landowner of Record NAME: WICKSTROM FARMS INC.
ADDRESS: 11870 Hwy 13 Westmoreland, KS. 66549-9660

S	T	R	NE¼				NW¼				SW¼				SE¼				TOTAL	
			NE	NW	SW	SE	NE	NW	SW	SE	NE	NW	SW	SE	NE	NW	SW	SE		
8	8	8E									25.5				24	26	40	32	40	187.5
10	8	8E													14.5	3	8	40	34	99.5
11	8	8E									25	38	14.5							77.5
14	8	8E					34.5	29	22	26										111.5

Landowner of Record NAME: _____
ADDRESS: _____

S	T	R	NE¼				NW¼				SW¼				SE¼				TOTAL		
			NE	NW	SW	SE	NE	NW	SW	SE	NE	NW	SW	SE	NE	NW	SW	SE			
16	8	8E			32.5	30	5	13.5			9										90
17	8	8E	24	32	1.5															57.5	
21	8	8E						40	40											80	

Landowner of Record NAME: _____ ADDRESS: _____ TOTAL = 703.5

S	T	R	NE¼				NW¼				SW¼				SE¼				TOTAL	
			NE	NW	SW	SE	NE	NW	SW	SE	NE	NW	SW	SE	NE	NW	SW	SE		

DWR 1-100.23 (7-7-00)

Water Resources
Received
MAY 06 2019
KS Dept Of Agriculture

1:24,000

NEW APPLICATION - Stockwatering Use

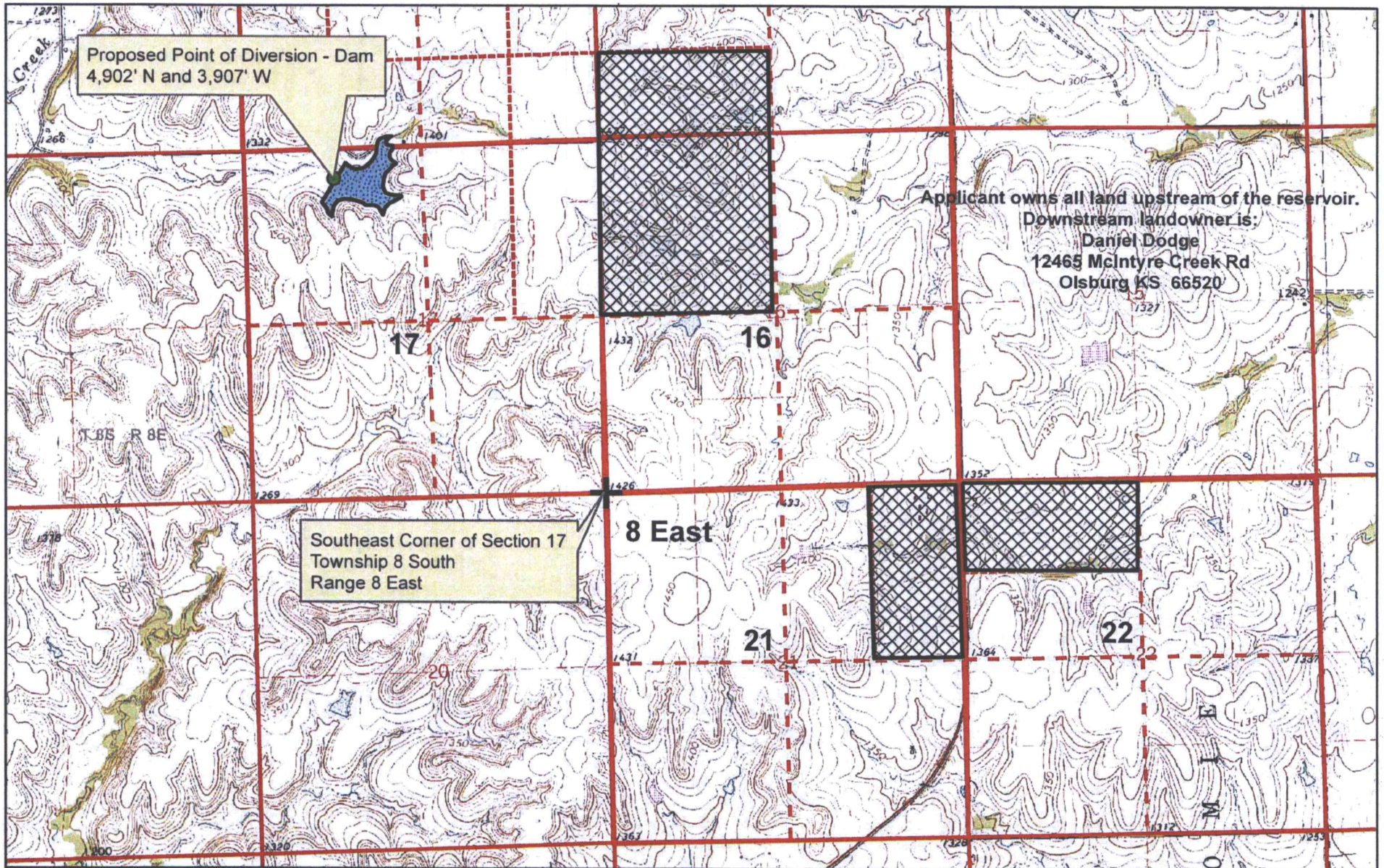

● Proposed Point of Diversion



Proposed Place of Use

All upstream and downstream landowners within 1/2 mile have been identified.

1:24,000

New Application - Irrigation Use

15209

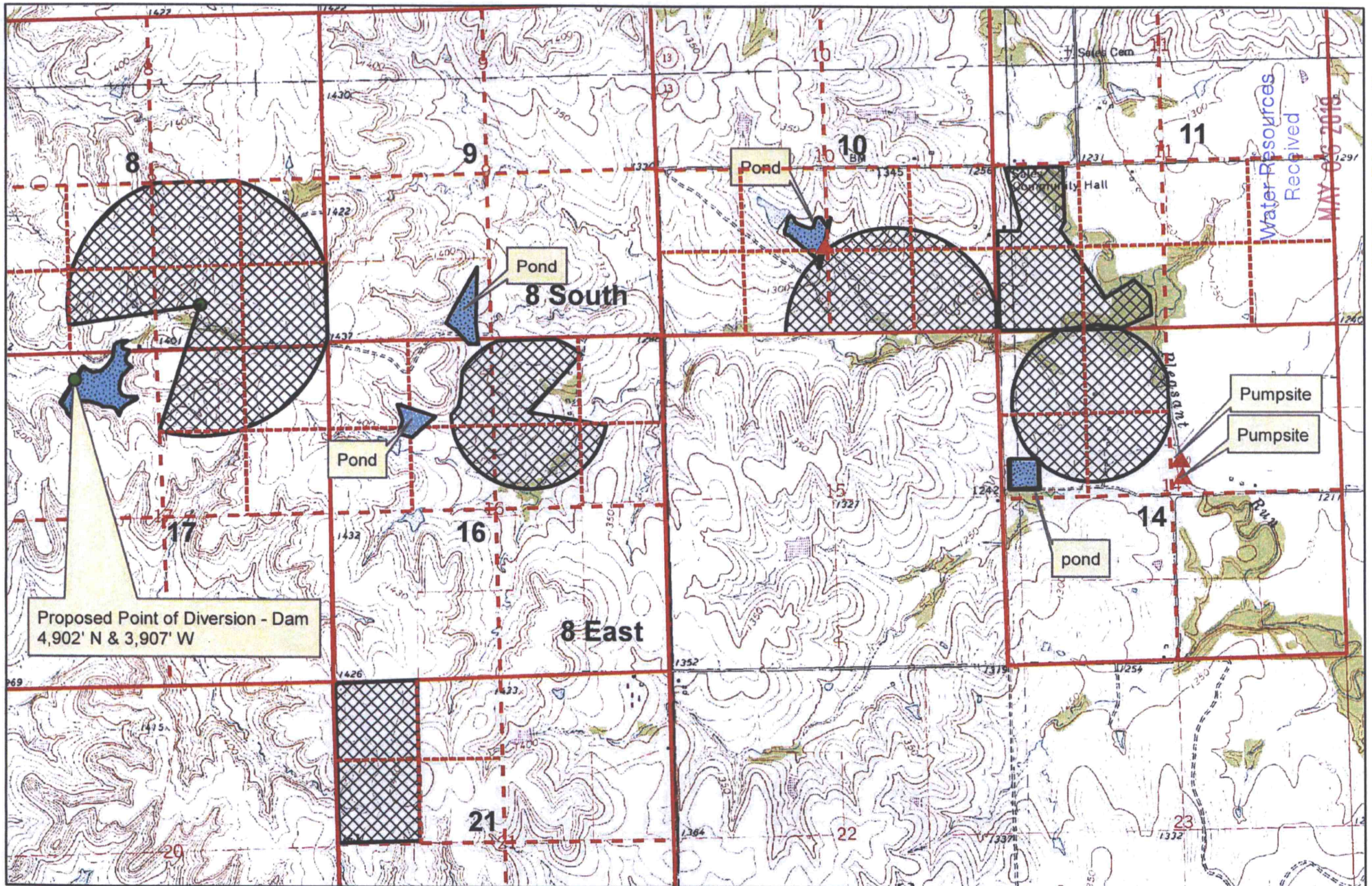

● Proposed Point of Diversion



Proposed Place of Use (IRR)