

NOTICE

This scan only represents the application as filed. The information contained herein meets the requirements of K.A.R. 5-3-1 or K.A.R. 5-5-1, and has been found acceptable for filing in the office of the Chief Engineer. The application should not be considered to be a complete application as per K.A.R. 5-3-1b or K.A.R. 5-5-2a.

THE STATE OF KANSAS



KANSAS DEPARTMENT OF AGRICULTURE
Mike Beam, Secretary of Agriculture

DIVISION OF WATER RESOURCES
Earl D. Lewis Jr., Chief Engineer

WATER RESOURCES
RECEIVED

MAR 24 2023

11:00
KS DEPT OF AGRICULTURE

File Number **50998**
This item to be completed by the Division of Water Resources.

APPLICATION FOR PERMIT TO APPROPRIATE WATER FOR BENEFICIAL USE

Filing Fee Must Accompany the Application
(Please refer to Fee Schedule attached to this application form.)

*To the Chief Engineer of the Division of Water Resources, Kansas Department of Agriculture,
1320 Research Park Drive, Manhattan, Kansas 66502:*

1. Name of Applicant (Please Print): John Leiszler
Address: 417 Deer Rd.
City: Clifton State KANSAS Zip Code 66937
Telephone Number: (785) 313-2197

2. The source of water is: surface water in _____ (stream)
OR groundwater in Republican River Basin (drainage basin)

Certain streams in Kansas have minimum target flows established by law or may be subject to administration when water is released from storage for use by water assurance district members. If your application is subject to these regulations on the date we receive your application, you will be sent the appropriate form to complete and return to the Division of Water Resources.

3. The maximum quantity of water desired is 414 acre-feet OR _____ gallons per calendar year, to be diverted at a maximum rate of 2500 gallons per minute OR _____ cubic feet per second.

Once your application has been assigned a priority, the requested maximum rate of diversion and maximum requested quantity of water under that priority number can **NOT** be increased. Please be certain your requested maximum rate of diversion and maximum quantity of water are appropriate and reasonable for your proposed project and are in agreement with the Division of Water Resources' requirements.

4. The water is intended to be appropriated for (Check use intended):

(a) <input type="checkbox"/> Artificial Recharge	(b) <input checked="" type="checkbox"/> Irrigation	(c) <input type="checkbox"/> Recreational	(d) <input type="checkbox"/> Water Power
(e) <input type="checkbox"/> Industrial	(f) <input type="checkbox"/> Municipal	(g) <input type="checkbox"/> Stockwatering	(h) <input type="checkbox"/> Sediment Control
(i) <input type="checkbox"/> Domestic	(j) <input type="checkbox"/> Dewatering	(k) <input type="checkbox"/> Hydraulic Dredging	(l) <input type="checkbox"/> Fire Protection
(m) <input type="checkbox"/> Thermal Exchange	(n) <input type="checkbox"/> Contamination Remediation		

YOU **MUST** COMPLETE AND ATTACH ADDITIONAL DIVISION OF WATER RESOURCES FORM(S) PROVIDING INFORMATION TO SUBSTANTIATE YOUR REQUEST FOR THE AMOUNT OF WATER FOR THE INTENDED USE REFERENCED ABOVE.

For Office Use Only:															
F.O. Code	<u>1</u>	GMD	<u>RE 3</u>	Meets K.A.R. 5-3-1	<input checked="" type="checkbox"/> YES / <input type="checkbox"/> NO	Use	<u>IRR</u>	Source	<input checked="" type="checkbox"/> G / <input type="checkbox"/> S	County	<u>WS</u>	By	<u>ALB</u>	Date	<u>3/27/23</u>
Fee \$	<u>320</u>	TR #		Receipt Date	<u>3/24/23</u>	Check #	<u>9173</u>								

3/29/2023
LMoody

5. The location of the proposed wells, pump sites or other works for diversion of water is:

Note: For the application to be accepted, the point of diversion location must be described to at least a 10 acre tract, unless you specifically request a 60 day period of time in which to locate the site within a specifically described, minimal legal quarter section of land.

- (A) One in the NE quarter of the SW quarter of the SE quarter of Section 29, more particularly described as being near a point 1154 feet North and 1546 feet West of the Southeast corner of said section, in Township 03 South, Range 01 ~~East~~ West (circle one), Washington County, Kansas.
- (B) One in the _____ quarter of the _____ quarter of the _____ quarter of Section _____, more particularly described as being near a point _____ feet North and _____ feet West of the Southeast corner of said section, in Township _____ South, Range _____ East/West (circle one), _____ County, Kansas.
- (C) One in the _____ quarter of the _____ quarter of the _____ quarter of Section _____, more particularly described as being near a point _____ feet North and _____ feet West of the Southeast corner of said section, in Township _____ South, Range _____ East/West (circle one), _____ County, Kansas.
- (D) One in the _____ quarter of the _____ quarter of the _____ quarter of Section _____, more particularly described as being near a point _____ feet North and _____ feet West of the Southeast corner of said section, in Township _____ South, Range _____ East/West (circle one), _____ County, Kansas.

If the source of supply is groundwater, a separate application shall be filed for each proposed well or battery of wells, except that a single application may include up to four wells within a circle with a quarter (1/4) mile radius in the same local source of supply which do not exceed a maximum diversion rate of 20 gallons per minute per well.

A battery of wells is defined as two or more wells connected to a common pump by a manifold; or not more than four wells in the same local source of supply within a 300 foot radius circle which are being operated by pumps not to exceed a total maximum diversion rate of 800 gallons per minute and which supply water to a common distribution system.

6. The owner of the point of diversion, if other than the applicant is (please print):

Jim Leiszler 636 9th rd Clifton KS 785-275-2653
(name, address and telephone number)

Mike Leiszler 25 Arrowhead rd Clifton KS 785-632-0090
(name, address and telephone number)

You must provide evidence of legal access to, or control of, the point of diversion from the landowner or the landowner's authorized representative. Provide a copy of a recorded deed, lease, easement or other document with this application. In lieu thereof, you may sign the following sworn statement:

I have legal access to, or control of, the point of diversion described in this application from the landowner or the landowner's authorized representative. I declare under penalty of perjury that the foregoing is true and correct.

Executed on March 17, 2023. John Leiszler
Applicant's Signature

The applicant must provide the required information or signature irrespective of whether they are the landowner. Failure to complete this portion of the application will cause it to be unacceptable for filing and the application will be returned to the applicant.

7. The proposed project for diversion of water will consist of 1 well and 1 pump
(number of wells, pumps or dams, etc.)

and (was)(will be) completed (by) march/1/2024
(Month/Day/Year - each was or will be completed)

WATER RESOURCES
RECEIVED

MAR 24 2023

File No. _____

8. The first actual application of water for the proposed beneficial use was or is estimated to be march/1/2024.
(Mo/Day/Year)

WATER RESOURCES
RECEIVED

MAR 24 2023

KS DEPT OF AGRICULTURE

- 9. Will pesticide, fertilizer, or other foreign substance be injected into the water pumped from the diversion works?
 Yes No If "yes", a check valve shall be required.

All chemigation safety requirements must be met including a chemigation permit and reporting requirements.

- 10. If you are planning to impound water, please contact the Division of Water Resources for assistance, prior to submitting the application. Please attach a reservoir area capacity table and inform us of the total acres of surface drainage area above the reservoir.

Have you also made an application for a permit for construction of this dam and reservoir with the Division of Water Resources? Yes No

- If yes, show the Water Structures permit number here _____
- If no, explain here why a Water Structures permit is not required _____

- 11. The application must be supplemented by a U.S.G.S. topographic map, aerial photograph or a detailed plat showing the following information. On the topographic map, aerial photograph, or plat, identify the center of the section, the section lines or the section corners and show the appropriate section, township and range numbers. Also, please show the following information:

- (a) The location of the proposed point(s) of diversion (wells, stream-bank installations, dams, or other diversion works) should be plotted as described in Paragraph No. 5 of the application, showing the North-South distance and the East-West distance from a section line or southeast corner of section.
- (b) If the application is for groundwater, please show the location of any existing water wells of any kind within ½ mile of the proposed well or wells. Identify each existing well as to its use and furnish the name and mailing address of the property owner or owners. If there are no wells within ½ mile, please advise us.
- (c) If the application is for surface water, the names and addresses of the landowner(s) ½ mile downstream and ½ mile upstream from your property lines must be shown.
- (d) The location of the proposed place of use should be shown by crosshatching on the topographic map, aerial photograph or plat.
- (e) Show the location of the pipelines, canals, reservoirs or other facilities for conveying water from the point of diversion to the place of use.

A 7.5 minute U.S.G.S. topographic map may be obtained by providing the section, township and range numbers to: Kansas Geological Survey, 1930 Constant, Campus West, University of Kansas, Lawrence, Kansas 66047.

- 12. List any application, appropriation of water, water right, or vested right file number that covers the same diversion points or any of the same place of use described in this application. Also list any other recent modifications made to existing permits or water rights in conjunction with the filing of this application.

WATER RESOURCES
 RECEIVED
 MAR 24 2023
 KS DEPT OF AGRICULTURE

13. Furnish the following well information if the proposed appropriation is for the use of groundwater. If the well has not been completed, give information obtained from test holes, if available.

Information below is from: Test holes Well as completed Drillers log attached

Well location as shown in paragraph No.	(A)	(B)	(C)	(D)
Date Drilled	<u>3/7/23</u>	_____	_____	_____
Total depth of well	<u>420</u>	_____	_____	_____
Depth to water bearing formation	<u>20</u>	_____	_____	_____
Depth to static water level	<u>40</u>	_____	_____	_____
Depth to bottom of pump intake pipe	_____	_____	_____	_____

14. The relationship of the applicant to the proposed place where the water will be used is that of owner
(owner, tenant, agent or otherwise)

15. The owner(s) of the property where the water is used, if other than the applicant, is (please print):

Jim Leiszler 636 9th Rd 785-275-2653
(name, address and telephone number)

Mike Leiszler 25 Arrowhead Rd 785-632-0090
(name, address and telephone number)

16. The undersigned states that the information set forth above is true to the best of his/her knowledge and that this application is submitted in good faith.

Dated at Clifton, Kansas, this 17 day of march, 2023.
(month) (year)

(Applicant Signature)

By _____
(Agent or Officer Signature)

(Agent or Officer - Please Print)

Assisted by _____ Date: _____
(office/title)

WATER RESOURCES
RECEIVED

MAR 24 2023

WELL LOG

DATE: 3/7/2023

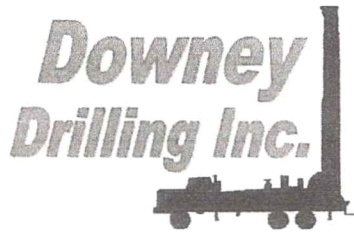

CUSTOMER NAME: JOHN LEISZLER

LEGAL: SE 29-3S-1E

COUNTY: WASHINGTON CO. KS

GPS: 39 45' 36.16" N

-97 20' 06.66" W

SAND STICKS WERE 2.5-4MINS A STICK

DRILLER: RYAN

WO: 22-061

TW	FROM	TO	TYPE	HARDNESS	COLOR	SPEED	PULL DOWN	OTHER / DRILLING ACTION
	0	3	TOP SOIL	FIRM	BROWN	SLOW	NO	SMOOTH
	3	8	CLAY	FIRM	BROWN	SLOW	NO	SMOOTH
X	8	17	OCHER BR ROCK	HARD	GOLD	SLOW	NO	CHATTER
X	17	32	WHITE SHALE LIMESTONE LAYERS	HARD	WHITE	SLOW	NO	IN & OUT
	32	36	SHALE	FIRM	DARK	SLOW	NO	SMOOTH
	36	69	SHALE W/ SAND LAYERS	FIRM	GRAY	SLOW	NO	SMOOTH
	69	70	LIMESTONE	FIRM	WHITE	SLOW	NO	CHOPPY
	70	80	SHALE	FIRM	GRAY	SLOW	NO	SMOOTH
	80	98	SHALE	FIRM	DARK LIGHT GRAY	SLOW	NO	SMOOTH
	98	140	SHALE W/ SAND LAYERS	SOFT	GRAY	FAST	NO	SLIGHT
	140	163	SHALE	FIRM	DARK LIGHT GRAY	SLOW	NO	SMOOTH
	163	186	WHITE SHALE LIGHT GRAY SHALE W/ SAND LAYERS	SOFT	GRAY	FASTER	NO	SMOOTH
	186	221	BROWN/RED SHALE	SOFT	BROWN/RED	FASTER	NO	SMOOTH
X	221	230	SHALE FINE-MED SAND	SOFT	GRAY	VERY FAST	NO	SLIGHT
X	230	240	FINE-MED SAND SS	SOFT	GRAY	VERY FAST	NO	CHATTER
X	240	245	SHALE SAND (SLIGHTLY SLOWER)	SOFT	GRAY /	SEMI FAST	NO	SLIGHT
X	245	257	SAND SS	SOFT	BROWN	VERY FAST	NO	CHATTER
X	257	283	SHALE ? (SLIGHTLY SLOWER)	SOFT	GRAY /BR	FASTER	NO	SLIGHT
	283	297	SHALE (RED) SAND -TIGHT	SOFT	BROWN/RED	FASTER	NO	CHATTER
	297	318	SHALE FINE-MED SAND TSS (SLIGHT CHATTER)	FIRM	RED	SLOW	NO	SMOOTH
X	318	321	FINE-MED SAND	SOFTER	BROWN	FAST	NO	CHATTER
	321	325	SHALE	FIRM	RED	SLOW	NO	SMOOTH
X	325	340	SAND W/ SHALE LAYERS	SOFT	BROWN/RED	FAST	NO	CHATTER
	340	351	SHALE SAND SS LAYERS	SEMI SOFT	RED	SLOWER	NO	SLIGHT
X	351	360	SAND SS FINER SAND	SOFT	GRAY	VERY FAST	NO	CHATTER
	360	373	SHALE W/ SAND SS LAYERS	SEMI SOFT	GRAY	FASTER	NO	SLIGHT
X	373	416	FINE-MED SAND SS	SOFT	GRAY	VERY FAST	NO	CHATTER
	416	420	SHALE	FIRM	DRK GRY	SLOW	NO	SMOOTH
			QG - 6					
			QT - 10					

WATER RESOURCES RECEIVED

MAR 24 2023

KS DEPT OF AGRICULTURE

IRRIGATION USE SUPPLEMENTAL SHEET

File No. _____

Name of Applicant (Please Print): John Leiszler

1. Please supply the name and address of each landowner, the legal description of the lands to be irrigated, and designate the actual number of acres to be irrigated in each forty acre tract or fractional portion thereof:

Landowner of Record NAME: Jim Leiszler
ADDRESS: 630 9th Rd, Clifton, KS 66937

S	T	R	NE¼				NW¼				SW¼				SE¼				TOTAL
			NE	NW	SW	SE	NE	NW	SW	SE	NE	NW	SW	SE	NE	NW	SW	SE	
29	3	1	28	40	34	3													105

Landowner of Record NAME: Jim, Mike, & John Leiszler
ADDRESS: 417 Deer Rd. Clifton, KS 66937

S	T	R	NE¼				NW¼				SW¼				SE¼				TOTAL	
			NE	NW	SW	SE	NE	NW	SW	SE	NE	NW	SW	SE	NE	NW	SW	SE		
29	3	1														40	40	40	40	160

Landowner of Record NAME: Jim, Mike, John, & Chris Leiszler
ADDRESS: 417 Deer Rd. Clifton, KS 66937

S	T	R	NE¼				NW¼				SW¼				SE¼				TOTAL	
			NE	NW	SW	SE	NE	NW	SW	SE	NE	NW	SW	SE	NE	NW	SW	SE		
32	3	1	40	40																80

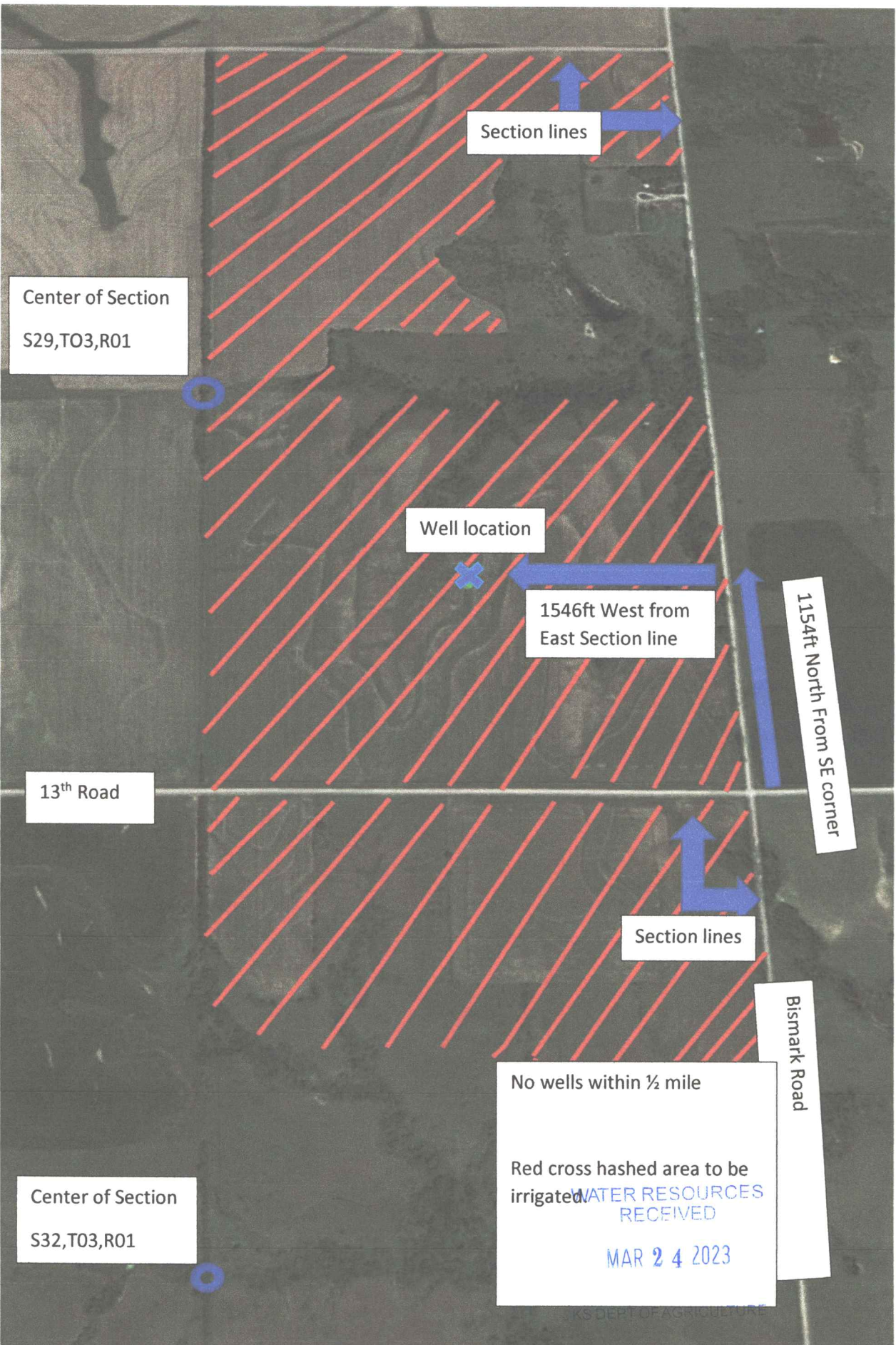

Section lines

Center of Section
S29, T03, R01

Well location

1546ft West from
East Section line

1154ft North From SE corner

13th Road

Section lines

Bismark Road

No wells within 1/2 mile

Red cross hashed area to be irrigated

WATER RESOURCES RECEIVED

MAR 24 2023

Center of Section
S32, T03, R01

(Date)

Kansas Department of Agriculture
Division of Water Resources
Earl D. Lewis, Jr., Chief Engineer
1320 Research Park Drive
Manhattan, Kansas 66502

Re: Application
File No. _____

Minimum Desirable Streamflow

I understand that a Minimum Desirable Streamflow requirement has been established by the legislature for the source of supply to which the above referenced application applies.

I understand that diversion of water pursuant to this application will be subject to regulation any time Minimum Desirable Streamflow requirements are not being met.

I also understand that if this application is approved, there could be times, as determined by the Division of Water Resources, when I would not be allowed to divert water. I realize that this could affect the economics of my decision to appropriate water.

I am aware of the above factors, and with the knowledge thereof, request that the Division of Water Resources proceed with processing and approval, if possible, of the above referenced application.

John Leiszler
Signature of Applicant

State of Kansas)
County of Washington) ss

John Leiszler
(Print Applicant's Name)

I hereby certify that the foregoing instrument was signed in my presence and sworn to before me this 10 day of March, 2023.

Emily Weiche
Notary Public

My Commission Expires: 12/21/2026

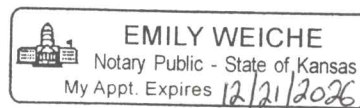

WATER RESOURCES
RECEIVED

MAR 24 2023

DATA ENTRY SYSTEM ID NUMBER SHEET

FILE NUMBER 50998

APPLICANT PERSON ID & SEQ #	PDIV ID	BATTERY ID
31874	90203	

LANDOWNER PERSON ID & SEQ #	PUSE ID	
68946	71304	
68947	71305	
54238	71306	

**WATER USE CORRESPONDENT
PERSON ID & SEQ #**
