

Submit To:
CHIEF ENGINEER
Division of Water Resources
Kansas Department of Agriculture
1320 Research Park Drive
Manhattan, KS 66502-5000
<http://agriculture.ks.gov/dwr>

APPLICATION FOR PERMIT TO APPROPRIATE WATER FOR BENEFICIAL USE



State of Kansas

STATUTORY FILING FEE MUST ACCOMPANY THIS APPLICATION
Please refer to the Fee Schedule attached to this application form.

File Number: **51472**

This item to be completed by the Division of Water Resources staff.

WATER RESOURCES
RECEIVED

APR 14 2025

11:20 am

KS Dept. of Agriculture

1. Name of Applicant: JESSEE GRAIN, Attn: RICK JESSEE
Address: 6878 SE HWY 160
City: COLUMBUS State: KS Zip Code: 66725
Phone: 620 249-4897 Rick / 620 674-1568 Erick Email: e_jessee@hotmail.com

2. The source of water is: surface water in SPRING RIVER (SPRING RIVER)
(stream)
 groundwater in _____
(drainage basin)

3. The maximum annual quantity of water desired is 178.3 acre-feet gallons
to be diverted at a maximum rate of 1200 gpm c.f.s. natural flows natural evaporation
 This project involves surface water storage and redirection. The maximum annual quantity of water desired to be
rediverted is _____ acre-feet gallons, at a rate of _____ gpm c.f.s.

Conversion Factors

1 acre-foot (AF) = 325,851 gallons

1 million gallons (mg) = 3.07 acre-feet (AF)

1 cubic foot per second (c.f.s.) = 448.8 gallons per minute (gpm)

IMPORTANT: Once your application has been assigned a priority date and file number, the requested maximum rate of diversion and maximum requested annual quantity of water under that priority number can **NOT** be increased. Please be certain your requested maximum rate of diversion and maximum annual quantity of water are appropriate and reasonable for your proposed project.

4. The water is intended to be appropriated for the following use(s):

<input type="checkbox"/> Artificial Recharge*	<input checked="" type="checkbox"/> Irrigation*	<input type="checkbox"/> Recreational*	<input type="checkbox"/> Water Power*
<input type="checkbox"/> Industrial*	<input type="checkbox"/> Municipal*	<input type="checkbox"/> Stockwatering*	<input type="checkbox"/> Sediment Control
<input type="checkbox"/> Domestic	<input type="checkbox"/> Dewatering	<input type="checkbox"/> Hydraulic Dredging	<input type="checkbox"/> Fire Protection
<input type="checkbox"/> Thermal Exchange	<input type="checkbox"/> Contamination Remediation		

***IMPORTANT:** You **must** submit a supplemental form providing information to substantiate your request for the quantity of water listed in Item No. 3 for the intended use(s) referenced above.

FOR OFFICE USE ONLY															
FO	<u>1</u>	GMD	-	DUA	-	Use	<u>IRR</u>	Source	<u>SW</u>	County	<u>CK</u>	By	<u>KJN</u>	Date	<u>4/18/25</u>
Code	<u>BE2</u>	Fee \$	<u>300</u>	TR #		Receipt Date	<u>4-14-25</u>	Check #	<u>6724</u>						

5. The location(s) of the proposed diversion work(s) (well, pumpsite, etc.) are described below. Note that for the application to be accepted, the point of diversion location(s) **must** be described to at least a 10-acre tract, unless you specifically request a 60-day period of time in which to locate the site within a specifically described, minimal legal quarter section of land. You can specify a nickname for the point of diversion via the A.K.A. line to help you identify it.

If the source of supply is groundwater, a separate application shall be filed for each proposed well or battery of wells, except that a single application may include up to four wells within a circle with a quarter (1/4) mile radius in the same local source of supply which do not exceed a maximum diversion rate of 20 gallons per minute per well.

A battery of wells is defined as two or more wells connected to a common pump by a manifold; or not more than four wells in the same local source of supply within a 300-foot radius circle which are being operated by pumps not to exceed a total maximum diversion rate of 800gpm and which supply water to a common distribution system.

(A) One in the SW quarter of the SE quarter of the NW quarter of Section 11, more particularly described as being near a point 2650 feet North and 4146 feet West of the Southeast corner of said section, in Township 33 South, Range 25 E W, CHEROKEE County, KS. A.K.A: CK

(B) One in the SW quarter of the SE quarter of the SW quarter of Section 2, more particularly described as being near a point 77 feet North and 3918 feet West of the Southeast corner of said section, in Township 33 South, Range 25 E W, CHEROKEE County, KS. A.K.A: CK

(C) One in the _____ quarter of the _____ quarter of the _____ quarter of Section _____, more particularly described as being near a point _____ feet North and _____ feet West of the Southeast corner of said section, in Township _____ South, Range _____ E W, _____ County, KS. A.K.A: _____

(D) One in the _____ quarter of the _____ quarter of the _____ quarter of Section _____, more particularly described as being near a point _____ feet North and _____ feet West of the Southeast corner of said section, in Township _____ South, Range _____ E W, _____ County, KS. A.K.A: _____

(E) One in the _____ quarter of the _____ quarter of the _____ quarter of Section _____, more particularly described as being near a point _____ feet North and _____ feet West of the Southeast corner of said section, in Township _____ South, Range _____ E W, _____ County, KS. A.K.A: _____

6. The proposed project for diversion of water will consist of 2 PUMPSITES
(number of wells, pumps, dams, etc.)
and was/will be completed on or by the following date: 06/10/2005
(date each was or will be completed)

7. The first actual application of water for the proposed beneficial use was or is estimated to be UPON APPROVAL
(Date)

8. List any application, appropriation of water, water right, or vested right file number that covers the same point(s) of diversion or any of the same place of use described in this application. Also list any other recent modifications made to existing permits or water rights in conjunction with the filing of this application.

45883 - COMPLETE OVERLAP IN PD AND PU

THIS FILE LIMITED TO 178.3 AF WHEN COM/W FILE NO. 45883.

WATER RESOURCES
RECEIVED

APR 14 2025

9. Will pesticide, fertilizer, or other foreign substance be injected into the water pumped from the diversion works?

Yes No If **yes**, a check valve shall be required. All chemigation safety requirements must be met including a chemigation permit and reporting requirements.

10. If you are planning to impound water, please contact DWR prior to submitting this application. Please attach a reservoir area capacity table and inform us of the total acres of surface drainage area above the reservoir.

Have you made an application for a permit for construction of this dam and reservoir with DWR? Yes No

If yes, write the Water Structures permit number here: N/A

11. Furnish a detailed topographic or aerial map that depicts the following information:

The application **must** be supplemented by a topographic map, aerial photograph or a detailed plat showing the information described in A-D below.

(A) The center of the section, the section lines or the section corners, and labels showing the appropriate section, township and range numbers, as well as a north arrow and scale,

(B) The location of the proposed point(s) of diversion (wells, stream-bank installations, dams, or other diversion works) described in Item No. 5 of the application, showing the North-South distance and the East-West distance from a section line or southeast corner of section,

(C) The location of the proposed place of use identified by crosshatching,

(D) **For Groundwater Use**, the location of any existing water wells of any kind within 1/2 mile of the proposed well or wells and indicate for each well its type of use and the name and mailing address of the property owner or owners, (If there are no wells within 1/2 mile, please indicate that on the map.)

For Surface Water Use, the names and addresses of the landowner(s) 1/2 mile downstream and 1/2 mile upstream from your property lines, and

(E) The locations of proposed or existing dams, dikes, reservoirs, canals, pipelines, power houses, and any other structures for the purpose of storing, conveying, or using water.

12. For groundwater use, furnish copies of the driller's logs for all test holes or completed wells. Please ensure that the driller's logs provide depth to the static water level. If driller's logs cannot be obtained for an existing well, provide the following information:

Well location as shown in Item No. 5	(A)	(B)	(C)	(D)	(E)
Date drilled	_____	_____	_____	_____	_____
Total depth of well	_____	_____	_____	_____	_____
Depth to static water level	_____	_____	_____	_____	_____

13. The owner(s) of the point of diversion, if other than the applicant is:

JANICE SUE KANE, 413 NE KEYSTONE DR, LEE'S SUMMIT, MO 64086

(name, address, and phone)

LLOYD R HALE JR & JEANNETTE L GOETZ, 3544 FALLING BROOK DR, PACE, FL 32571

(name, address, and phone)

WATER RESOURCES
RECEIVED

APR 14 2025

KS Dept. of Agriculture

14. The owner(s) of the property where the water is used, if other than the applicant, is:

JANICE SUE KANE, 413 NE KEYSTONE DR, LEE'S SUMMIT, MO 64086

(name, address, and phone)

LLOYD R HALE JR & JEANNETTE L GOETZ, 3544 FALLING BROOK DR, PACE, FL 32571

(name, address, and phone)

15. The relationship of the applicant to the proposed place where the water will be used is that of:

Owner Agent Tenant Other: _____

16. A water use correspondent (WUC) must be designated. The WUC will be mailed the annual water use report, which must be filed with the Division by March 1 of each year. Failure to timely file an accurate water use report will subject the owner(s) to a civil fine of up to \$1,000 and potential suspension of the water appropriation or right. By signing this application, I verify that the owner(s) of the water right or permit have confirmed that the following person or agent should be designated as the WUC:

SAME AS APPLICANT

(name, address, and phone)

17. I understand that if this application is approved, there could be times, as determined by the Division of Water Resources, when I would not be allowed to divert water. This could affect the economics of my decision to appropriate water. Situations where this might occur may include times when minimum desirable streamflow (MDS) requirements are not met, when Assurance District or Water Marketing releases are made from storage in federal reservoirs, when a Water Reservation Right upstream of a federal reservoir is administered, or when water rights administration becomes necessary to prevent impairment.

I declare, under penalty of perjury, that I have legal access to or control of, the point(s) of diversion described in this application from the landowner or the landowner's authorized representative.

By signing below, I verify that the information set forth above is true to the best of my knowledge, I agree with all statements made above, and that this application is submitted in good faith.

(Applicant Signature)

4-9-25
(Date)

RICK JESSEE

(Applicant Name - please print)

(Applicant Title, if applicable - please print)

Assisted by SMD

TFO - PARSONS
(office/title)

Date: 4/2/25

APR 14 2025

FEE SCHEDULE

Make checks payable to the Kansas Department of Agriculture.

KS Dept. of Agriculture

1. The fee for an application for a permit to appropriate water for beneficial use, except for domestic, waterpower, dewatering, or sediment control use, shall be (see No. 2 below if requesting storage):

Million Gallons (mg)	Acre-Feet (AF)	Fee
≤ 32.585	≤ 100	\$200.00
32.586 - 104.272	100.1 - 320.0	\$300.00
> 104.272	> 320	\$300.00 plus \$20 for each additional 100AF (32.586mg) or any part thereof

2. The fee for an application in which **storage** of water is requested, except for domestic use, shall be:

Million Gallons (mg)	Acre-Feet (AF)	Fee
≤ 81.462	≤ 249.9	\$200.00
≥ 81.463	≥ 250	\$200.00 plus \$20 for each additional 100AF (32.586mg) or any part thereof

Note: If an application requests both direct use *and* storage, the fee charged shall be as determined under No. 1 or No. 2 above, whichever is greater, but not both fees.

3. The fee for an application for **waterpower** or **dewatering** use shall be \$100.00 plus \$200.00 for each 44,880 gallons per minute (100 c.f.s.), or part thereof, of the diversion rate requested.

IMPORTANT NOTICE

If this application is approved, the applicant shall notify the Chief Engineer when the diversion works (well, pump, reservoir, pit, etc.) has/have been completed via the *Notice of Completion of Diversion Works* form (DWR 1-203.11) and along with the statutorily required field inspection fee of:

- \$200.00 for sediment control use or groundwater pits for industrial use, or
- \$400.00 for all other uses made of water

Failure to complete the diversion works by the deadline specified in the *Approval of Application and Permit to Proceed* (or any subsequent extension of time of said deadline) and/or failure to submit the proper notice and field inspection fee will result in the dismissal of the appropriation and forfeiture of any priority associated with it.

For assistance with this application, please contact the Division of Water Resources (DWR).

Manhattan HQ
1320 Research Park Dr.
Manhattan, KS 66502
785-564-6638

Topeka Field Office
1131 SW Winding Rd, Ste 400
Topeka, KS 66615
785-296-5733

Stafford Field Office
300 S. Main St
Stafford, KS 67578
620-234-5311

Stockton Field Office
820 S. Walnut
Stockton, KS 67669
785-425-6787

Garden City Field Office
4532 W. Jones Ave, Ste B
Garden City, KS 67846
620-276-2901

Helpful Sources of Information

DWR Water Appropriation Program
DWR Water Appropriation Forms
KGS Water Well Completion Records
DWR Structures Program

<https://agriculture.ks.gov/divisions-programs/dwr/water-appropriation>
<https://agriculture.ks.gov/divisions-programs/dwr/water-appropriation/water-appropriation-forms>
<https://www.kgs.ku.edu/Magellan/WaterWell/index.html>
<https://agriculture.ks.gov/divisions-programs/dwr/dam-safety/permit-requirements>

APR 14 2025

KS Dept. of Agriculture

RICK JESSEE NEW APPLICATION

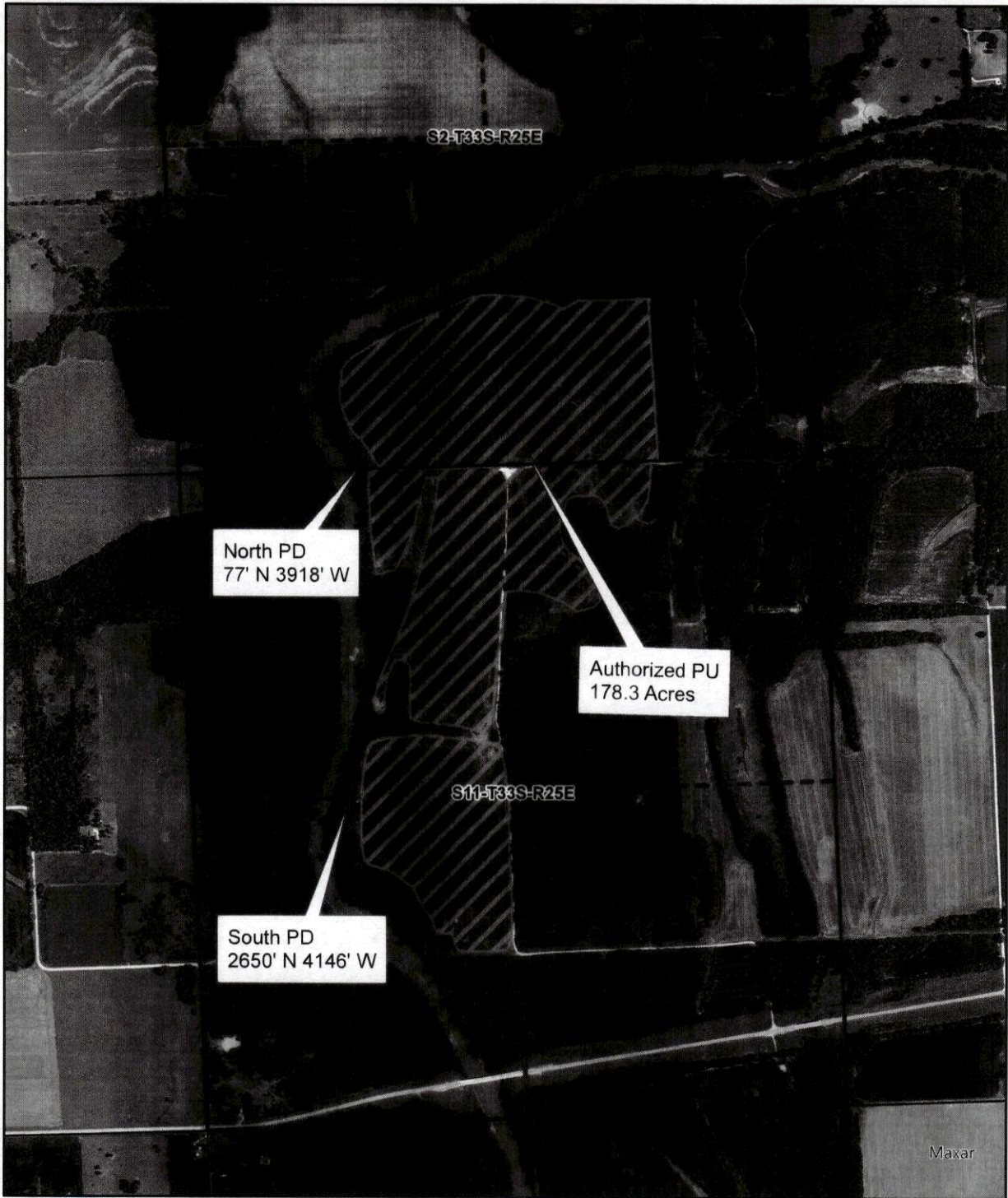

Scale: 1:15,000

Map prepared by: SMD 4/2/25

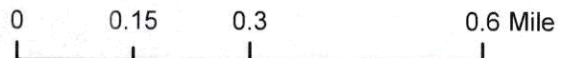

RICK JESSEE NEW APPLICATION

APR 14 2025

KS Dept. of Agriculture

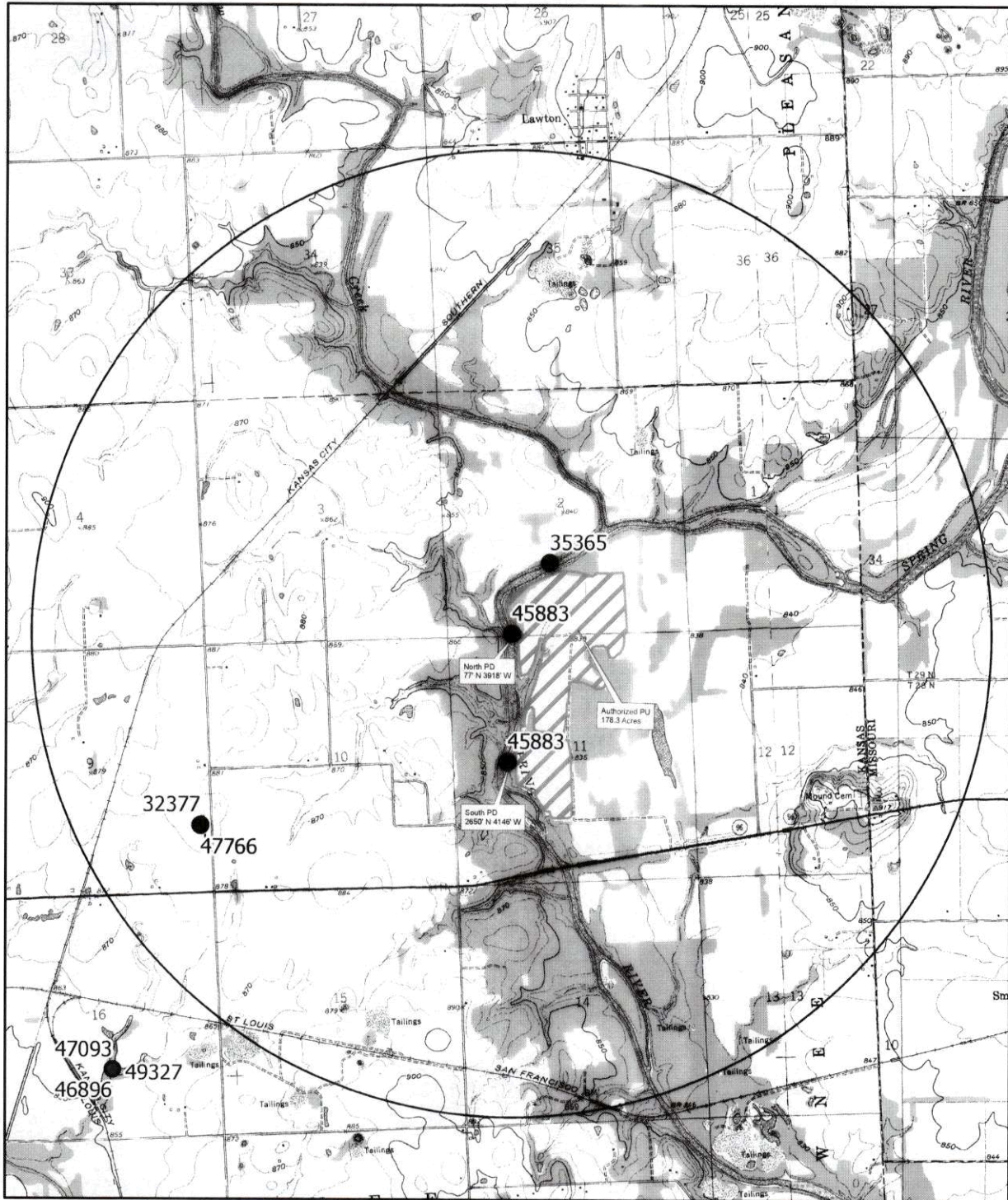

Scale: 1:40,000

Map prepared by: SMD



No known wells within 1/2 mile. Rick Jesse 4-9-25

WATER RESOURCES
RECEIVED

APR 14 2025

KS Dept. of Agriculture

New Application Landowners Upstream and Downstream

1. GARY G & LORNA N ALFORD
1419 NE 95TH ST
GALENA, KS 66739

2. CALVIN L & JUDY L BOWER TRUST DTD
1840 E AIRPORT DR
CARTHAGE, MO 64836

3. JACK R BOYES, DARRELL W BOYES
10621 SE BOSTON MILLS RD
GALENA, KS 66739

4. KANSAS WILDLIFE & PRK DEPT
512 SE 25TH AVE
PRATT, KS 67124

5. MARCIA ANN BEGGS
1153 NW 82ND TER
COLUMBUS, KS 66725

6. AUGUSTUS QUINN & SHERRY M CLARK LIVING TRUST
9746 SE MESSER RD
GALENA, KS 66739

7. JAMIE S & JESSICA D WILLIAMS
243 SE 100TH ST
GALENA, KS 66736

APR 14 2025

KS Dept. of Agriculture

**IRRIGATION USE
SUPPLEMENTAL SHEET**

File No. _____

Name of Applicant (Please Print): Jessee Grain, Rick Jessee

1. Please supply the name and address of each landowner, the legal description of the lands to be irrigated, and designate the actual number of acres to be irrigated in each forty acre tract or fractional portion thereof:

Landowner of Record NAME: LLOYD R HALE JR TRUST, Attn: JEANNETTE GOETZ

ADDRESS: 3344 GALLING BROOK DR, PACE, FL 32571

S	T	R	NE¼				NW¼				SW¼				SE¼				TOTAL
			NE	NW	SW	SE	NE	NW	SW	SE	NE	NW	SW	SE	NE	NW	SW	SE	
11	33S	25E		23.7			29.1			25	26.7								104.5

Landowner of Record NAME: JANICE SUE KANE

ADDRESS: 413 NE KEYSTONE DR, LEE'S SUMMIT, MO 64086

S	T	R	NE¼				NW¼				SW¼				SE¼				TOTAL
			NE	NW	SW	SE	NE	NW	SW	SE	NE	NW	SW	SE	NE	NW	SW	SE	
2	33S	25E											33.9				39.9		73.8

Landowner of Record NAME: _____

ADDRESS: _____

S	T	R	NE¼				NW¼				SW¼				SE¼				TOTAL
			NE	NW	SW	SE	NE	NW	SW	SE	NE	NW	SW	SE	NE	NW	SW	SE	

2. Please complete the following information for the description of the operation for the irrigation project. Attach supplemental sheets as needed.

a. Indicate the soils in the field(s) and their intake rates:

Soil Name	Percent of field (%)	Intake Rate (in/hr)	Irrigation Design Group
<u>Verdigris silt loam</u>	<u>50</u>	<u>0.6-2.0</u>	<u>5</u>
<u>Hepler silt loam</u>	<u>50</u>	<u>0.6-2.0</u>	<u>5</u>
_____	_____	_____	_____
_____	_____	_____	_____
Total: 100	100 %		

b. Estimate the average land slope in the field(s): 0.5 %

Estimate the maximum land slope in the field(s): 1.0 %

c. Type of irrigation system you propose to use (check one):

- Center pivot Center pivot - LEPA "Big gun" sprinkler
 Gravity system (furrows) Gravity system (borders) Sideroll sprinkler
 Other, please describe: _____

d. System design features:

i. Describe how you will control tailwater:

No tailwater due to good tillage practices, residue management and cultural practices

ii. For sprinkler systems:

(1) Estimate the operating pressure at the distribution system: 75 psi

(2) What is the sprinkler package design rate? 680 gpm

(3) What is the wetted diameter (twice the distance the sprinkler throws water) of a sprinkler on the outer 100 feet of the system? 770 feet Twice the lane width

(4) Please include a copy of the sprinkler package design information.

e. Crop(s) you intend to irrigate. Please note any planned crop rotations:

Corn and Soybeans

f. Please describe how you will determine when to irrigate and how much water to apply (particularly important if you do not plan a full irrigation).

Probe soil and use feel method to determine soil moisture.

WATER RESOURCES
RECEIVED
APR 14 2025
KS Dept. of Agriculture

You may attach any additional information you believe will assist in informing the Division of the need for your request.

1320 Research Park Drive
Manhattan, KS 66502
785-564-6700
www. agriculture.ks.gov



900 SW Jackson, Room 456
Topeka, KS 66612
785-296-3556

Mike Beam, Secretary

Laura Kelly, Governor

April 25, 2025

JESSEE GRAIN Attn: Rick Jessee
6878 SE HWY 160
COLUMBUS KS 66725

RE: Application, File No(s). **51472**

Dear Sir or Madam:

The Division of Water Resources (Division) has received your application(s) for a permit to appropriate water for beneficial use. Your application(s) has been assigned the file number(s) referenced above. Please be aware that the Division may have a large number of pending applications on hand at times and makes every attempt to process them in the order in which they are received. You will be contacted if additional information is required.

Please note, this letter only acknowledges receipt of your application(s) and does not guarantee approval. In accordance with the provisions of the Kansas Water Appropriation Act, the use of water as proposed prior to approval of the application(s) is unlawful.

Additional information about the process may be found on our website at agriculture.ks.gov/divisions-programs/dwr. If you have any other questions, please contact our office at 785-564-6640 or your local Topeka Field Office at 785-296-5733. If you call, please reference the file number so we can help you more efficiently.

Sincerely,

Kris Neuhauser
New Applications Lead
Water Appropriation Program