

APPLICATION FOR A PERMIT TO CONSTRUCT A WELL  
 IN THE LOWER REPUBLICAN NATURAL RESOURCES DISTRICT

*Voiced*

1. NAME: City of Cambridge  
 ADDRESS: PO Box 0  
Cambridge, NE. 69022  
 PHONE: (308) 697-3711

DNR & NRD USE ONLY  
 PERMIT NO.: LR05-151  
 REGISTRATION NO.: \_\_\_\_\_

2. PURPOSE OF WELL (Indicate One):  
 Irrigation     Livestock (>50 gpm)     Public Water Supply     Other  
 Industrial     Dewatering (over 90 days)     Aquaculture

3. IDENTIFY THE LOCATION OF THE PROPOSED WELL:  
Furnas County, Township 4 North,  
 Range, 25 West, Section 32

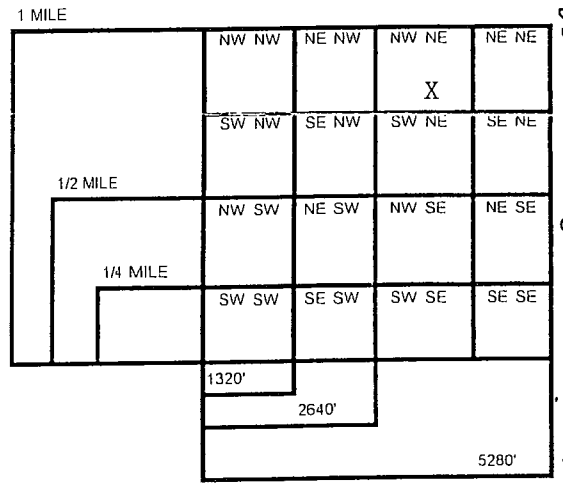

The box at the right represents one square mile, (section).  
 Indicate with an "X" the proposed location of the well.  
 Outline the proposed water use area, if water is to be used  
 outside the above written legal description, give legal  
 description of water use area.

Township 4 North, Range 25 West, Section 32

The well will be located 1000 feet from the North/South Section  
 Line, and will be 1400 feet from the East/West Section Line.

4. NEW IRRIGATION WELLS:  
 How many acres will be irrigated? N/A  
 Flow meter will be used on proposed well.  
 Type of irrigation system:  Center Pivot     Gravity     Other (specify) \_\_\_\_\_  
 Will system be  Electric     Fuel Powered?  
 Will the Well be used in a system with other wells?     YES     NO    If yes, how many? \_\_\_\_\_  
 Will fertilizer, chemicals or animal waste be applied through the system?     YES     NO

5. REPLACEMENT AND ABANDONMENT WELL INFORMATION:  
 A. Is this a replacement well?     YES     NO  
 B. Registration number of well to be replaced: \_\_\_\_\_  
 C. Well to be replaced was last operated \_\_\_\_\_, 20 \_\_\_\_\_  
 D. Replacement well is \_\_\_\_\_ feet from original well.  
 E. Completion of original well decommissioning on \_\_\_\_\_, 20 \_\_\_\_\_  
 F. New well will provide water only to land historically irrigated by the well being replaced, and shall not be used to irrigate any additional acres.

6. SPECIFICATIONS OF INTENDED WELL AND PUMP:  
 Approximate date when construction will begin: March/April, 20 05  
 Pump column diameter: 8"-10" inches. Estimated total well depth 51 feet.  
 Estimated pumping capacity: 500-600 gallons per minute. Well casing diameter: 16 inches.  
 Please attach test hole log, if available.  
 Name of Well Driller: Burton Well Drilling, Bartley, NE.

7. I certify that I am familiar with the information contained in the application and its' restrictions, rules and regulations, and that to the best of my knowledge and belief such information is true, complete and accurate. *pd 2/22/05 #19355 AP*

This form must be completed in full and be accompanied by a non-refundable \$50.00 fee (payable to the Lower Republican Natural Resources District, PO Box 618, Alma, NE 68920)

Date: 3-01-05  
 Date Approved: 3-10-05

Signature: David G. Hestling  
 NRD Representative: Michael Clement

SEE OTHER SIDE FOR IMPORTANT PERMIT RESTRICTIONS, RULES AND REGULATIONS

This form must be completed in full and be accompanied by a non-refundable \$50.00 filing fee (payable to the Lower Republican Natural Resources District). Forward this application and filing fee to:

LRNRDFMP-713(6-19-03)

**Lower Republican Natural Resources District**  
**PO Box 618**  
**Alma, NE 68920**  
**Phone: 308-928-2182 or 800-353-1297**

Please take the time and fill out the information correctly. An incomplete or defective application will be returned by the District, with 60 days being allowed for resubmission. All permits shall be issued by the District with conditions attached or denied not later than 30 days after receipt of a complete and properly prepared application.

### PERMIT RESTRICTIONS

1. Well permits are required prior to construction or a late fee of \$250.00 will be assessed.
2. Permits are not required for test holes, temporary dewatering wells (less than 90 days), or wells designed to pump 50 gallons per minute or less.
3. If the well is not constructed within a one year period from the date of approval, a new permit is needed.
4. The well authorized by this permit may not be constructed closer than 600 feet from an existing well having a capacity of 51 gallons per minute or more, unless both the new and existing wells are owned by the same individual.
5. According to State law 46-637, water wells may not be drilled within 50 feet of a stream bank without first getting a surface water right for the stream from the Department of Natural Resources.
6. Replacement wells do need a permit from the Lower Republican NRD. A replacement well is one which replaces an abandoned water well that has been operated within the last three years and is constructed to water the same acres of land as the abandoned water well. If the well is being replaced, it must be properly abandoned according to state guidelines. A copy of these guidelines is available from the the Lower Republican Natural Resources District.
7. All new or replacement water wells constructed in the District are required to be sampled for nitrates upon completion.
  - A. Municipalities which develop a new public water well shall submit a copy of the well's initial water quality test results to the District within 30 days of receipt of such results from the Department of Health.
  - B. The sample for all non-municipal wells shall be collected by the owner, operator, or farm manager no sooner than 30 days, nor later than 60 days, after activation of the well.
8. The Lower Republican Natural Resources District encourages that all new non-domestic water wells designed to pump 51 gallons per minute or more be constructed with adequate free space in the pump discharge to accommodate a flow measurement device.
9. Any person who commences or causes construction of such a well for which the required permit has not been obtained, or who knowingly furnishes false information regarding such permit, shall be guilty of a Class IV misdemeanor. {46-602-01}.
10. This permit does not register the well with the Department of Natural Resources. All wells are required to be registered with the Nebraska Department of Natural Resources within 30 days after the well is completed. If possible, mark with a flag the well site in the field.

**COMMENTS/RESTRICTIONS:** This well will be approximately 450' south of existing City Well.

---

---

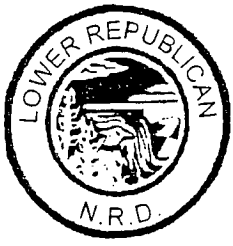

# Lower Republican Natural Resources District

---

City of Cambridge  
PO Box Q  
Cambridge, NE 69022

July 19, 2006

RE: Permit Number: LR-05-151

Dear City of Cambridge ,

Your application for a permit to construct a water well in the Lower Republican NRD has expired. According to our records no well has been registered. If the well was drilled the well driller has not registered the well for you. State rules require that a well be registered within 30 days after completion. Any well that has been completed and not registered can be considered an illegal well.

A new permit will be required for any new construction. These permits are only valid for a period of one year.

Please let me know the status of your well.

Sincerely,

Kristi Coe  
Water Resource Administrator

Enclosure: Copy of expired permit

*"This institution is an Equal Opportunity Provider."*

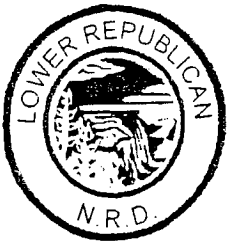

# Lower Republican Natural Resources District

---

August 8, 2006

City of Cambridge  
PO Box Q  
Cambridge, NE 69022

RE Permit Number: LR-05-151

Dear City of Cambridge ,

A few weeks ago you were sent a letter telling you that your permit to drill a well had expired. Since we have received no response from you on this matter we will assume this well has **NOT** been drilled and will **VOID** your permit to construct a water well in the Lower Republican NRD. A copy of your voided permit will also be sent to Lincoln to the Department of Natural Resources notifying them of this.

Sincerely,

Kristi Coe  
Water Resource Administrator

*"This institution is an Equal Opportunity Provider."* 