

RECEIVED FEB 13 2006

VOIDED

LRNRDFMP-713(6-10-03)



APPLICATION FOR A PERMIT TO CONSTRUCT A WELL IN THE LOWER REPUBLICAN NATURAL RESOURCES DISTRICT

DNR & NRD USE ONLY

PERMIT NO.: LR 06 170

REGISTRATION NO.: _____

1. NAME: Webster Co. Ethanol Coalition

ADDRESS: P.O. Box 385
Red Cloud, NE 68970

PHONE: (402) 746-2251

2. PURPOSE OF WELL (Indicate One): Irrigation Livestock (>50 gpm) Public Water Supply Other
 Industrial Dewatering (over 90 days) Aquaculture

3. IDENTIFY THE LOCATION OF THE PROPOSED WELL:

Webster County, Township 2 North,
Range, 10 West, Section 17

The box at the right represents one square mile, (section).
Indicate with an "X" the proposed location of the well.
Outline the proposed water use area, if water is to be used
outside the above written legal description, give legal
description of water use area.

Township 1 North, Range 10 West, Section NW-5

The well will be located 200 feet from the North/South Section
Line, and will be 2740 feet from the East/West, Section Line.

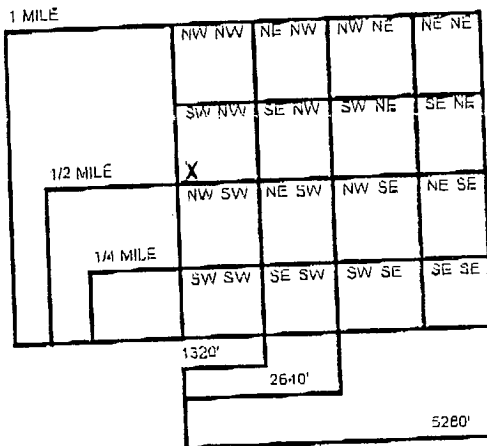

4. NEW IRRIGATION WELLS: N/A

How many acres will be irrigated? _____

Flow meter will be used on proposed well.

Type of irrigation system: Center Pivot Gravity Other (specify) _____

Will system be Electric Fuel Powered?

Will the Well be used in a system with other wells? YES NO If yes, how many? _____

Will fertilizer, chemicals or animal waste be applied through the system? YES NO

5. REPLACEMENT AND ABANDONMENT WELL INFORMATION:

A. Is this a replacement well? YES NO

B. Registration number of well to be replaced: _____, 20 _____

C. Well to be replaced was last operated _____, 20 _____

D. Replacement well is _____ feet from original well. _____, 20 _____

E. Completion of original well decommissioning on _____, 20 _____

F. New well will provide water only to land historically irrigated by the well being replaced, and shall not be used to irrigate any additional acres.

6. SPECIFICATIONS OF INTENDED WELL AND PUMP:

Approximate date when construction will begin: _____, 20 _____

Pump column diameter: _____ inches. Estimated total well depth _____ feet.

Estimated pumping capacity: _____ gallons per minute. Well casing diameter: _____ inches.

Please attach test hole log, if available.

Name of Well Driller: _____

7. I certify that I am familiar with the information contained in the application and its' restrictions, rules and regulations, and that to the best of my knowledge and belief such information is true, complete and accurate.

This form must be completed in full and be accompanied by a non-refundable \$50.00 fee (payable to the Lower Republican Natural Resources District, PO Box 618, Alma, NE 68920)

Date: 2-10-06

Date Approved: 2-14-06

Signature: Gary Meyer by [Signature]
NRD Representative: Michael Clements

pd 2/8/06
v# City
Warrent
4574
4p

SEE OTHER SIDE FOR IMPORTANT PERMIT RESTRICTIONS, RULES AND REGULATIONS

This form must be completed in full and be accompanied by a non-refundable \$50.00 filing fee (payable to the Lower Republican Natural Resources District). Forward this application and filing fee to:

LRNRDFMP-713(6-19-03)

Lower Republican Natural Resources District
PO Box 618
Alma, NE 68920
Phone: 308-928-2182 or 800-353-1297

Please take the time and fill out the information correctly. An incomplete or defective application will be returned by the District, with 60 days being allowed for resubmission. All permits shall be issued by the District with conditions attached or denied not later than 30 days after receipt of a complete and properly prepared application.

PERMIT RESTRICTIONS

1. Well permits are required prior to construction or a late fee of \$250.00 will be assessed.
2. Permits are not required for test holes, temporary dewatering wells (less than 90 days), or wells designed to pump 50 gallons per minute or less.
3. If the well is not constructed within a one year period from the date of approval, a new permit is needed.
4. The well authorized by this permit may not be constructed closer than 600 feet from an existing well having a capacity of 51 gallons per minute or more, unless both the new and existing wells are owned by the same individual.
5. According to State law 46-637, water wells may not be drilled within 50 feet of a stream bank without first getting a surface water right for the stream from the Department of Natural Resources.
6. Replacement wells do need a permit from the Lower Republican NRD. A replacement well is one which replaces an abandoned water well that has been operated within the last three years and is constructed to water the same acres of land as the abandoned water well. If the well is being replaced, it must be properly abandoned according to state guidelines. A copy of these guidelines is available from the Lower Republican Natural Resources District.
7. All new or replacement water wells constructed in the District are required to be sampled for nitrates upon completion.
 - A. Municipalities which develop a new public water well shall submit a copy of the well's initial water quality test results to the District within 30 days of receipt of such results from the Department of Health.
 - B. The sample for all non-municipal wells shall be collected by the owner, operator, or farm manager no sooner than 30 days, nor later than 60 days, after activation of the well.
8. The Lower Republican Natural Resources District encourages that all new non-domestic water wells designed to pump 51 gallons per minute or more be constructed with adequate free space in the pump discharge to accommodate a flow measurement device.
9. Any person who commences or causes construction of such a well for which the required permit has not been obtained, or who knowingly furnishes false information regarding such permit, shall be guilty of a Class IV misdemeanor. {46-602-01}.
10. This permit does not register the well with the Department of Natural Resources. All wells are required to be registered with the Nebraska Department of Natural Resources within 30 days after the well is completed. If possible, mark with a flag the well site in the field.

COMMENTS/RESTRICTIONS:

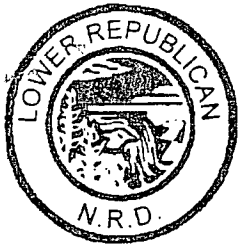

Lower Republican Natural Resources District

June 1, 2007

RECEIVED JUN - 8 2007

Webster Co. Coalition
% Gary Meyer
PO Box 385
Red Cloud, NE 68970

Dear Mr. Meyer,

We have information on file that you obtained a permit from the Lower Republican Natural Resources District to drill a water well in the SW1/4NW1/4 of Section 17, Township 2 North, Range 10 West, in Webster County. The permit was listed as LR-06-170 and was approved on 2/14/2006. At this time we do not show this water well as being drilled and/or registered. If this well has not been drilled we will VOID this permit. We would appreciate your assistance in verifying the status of this permit. Please complete the following and return this letter to our office.

The water well described in permit LR-06-170 was drilled
_____ (date) by _____ (contractor).

The water well described in permit LR-06-170 was never drilled.

This well was not drilled and a replacement permit #LR07185
was issued 3/8/07

Again we appreciate your assistance with regards to your permit. If you have any questions or concerns, please do not hesitate to contact us.

Sincerely,

Kristi Coe
Water Resource Administrator

"This institution is an Equal Opportunity Provider."