

THE STATE OF KANSAS



KANSAS DEPARTMENT OF AGRICULTURE
Dale A. Rodman, Secretary of Agriculture

DIVISION OF WATER RESOURCES
David W. Barfield, Chief Engineer

File Number 48704
This item to be completed by the Division of Water Resources.

APPLICATION FOR PERMIT TO APPROPRIATE WATER FOR BENEFICIAL USE
Filing Fee Must Accompany the Application
(Please refer to Fee Schedule attached to this application form.)

WATER RESOURCES RECEIVED
JUL 23 2013 12:42 PM
KS DEPT OF AGRICULTURE
UNACCEPTED

To the Chief Engineer of the Division of Water Resources, Kansas Department of Agriculture,
109 SW 9th Street, Second Floor, Topeka, KS 66612-1283:

1. Name of Applicant (Please Print): City of Wichita, Public Works & Utilities
Address: 455 N. Main
City: Wichita State KS Zip Code 67202
Telephone Number: (316) 269-4760

2. The source of water is: [] surface water in Little (stream)
OR [x] groundwater in Arkansas River, ASR Project (drainage basin)

Certain streams in Kansas have minimum target flows established by law or may be subject to administration when water is released from storage for use by water assurance district members. If your application is subject to these regulations on the date we receive your application, you will be sent the appropriate form to complete and return to the Division of Water Resources.

3. The maximum quantity of water desired is 500 acre-feet OR 162.93 million gallons per calendar year, to be diverted at a maximum rate of 1,500 gallons per minute OR cubic feet per second.

Once your application has been assigned a priority, the requested maximum rate of diversion and maximum requested quantity of water under that priority number can NOT be increased. Please be certain your requested maximum rate of diversion and maximum quantity of water are appropriate and reasonable for your proposed project and are in agreement with the Division of Water Resources' requirements.

4. The water is intended to be appropriated for (Check use intended):
(a) [] Artificial Recharge (b) [] Irrigation (c) [] Recreational (d) [] Water Power
(e) [] Industrial (f) [x] Municipal (g) [] Stockwatering (h) [] Sediment Control
(i) [] Domestic (j) [] Dewatering (k) [] Hydraulic Dredging (l) [] Fire Protection
(m) [] Thermal Exchange (n) [] Contamination Remediation

YOU MUST COMPLETE AND ATTACH ADDITIONAL DIVISION OF WATER RESOURCES FORM(S) PROVIDING INFORMATION TO SUBSTANTIATE YOUR REQUEST FOR THE AMOUNT OF WATER FOR THE INTENDED USE REFERENCED ABOVE.

For Office Use Only:
F.O. 2 GMD 2 Meets K.A.R. 5-3-1 (YES/NO) Use MUN Source G S County HV By RAR Date 7-24-13
Code BFO Fee \$ 340 TR # Receipt Date 7-23-13 Check # 583891

14003589

7-25-13
BDD

pdio # 44679

5. The location of the proposed wells, pump sites or other works for diversion of water is:

Note: For the application to be accepted, the point of diversion location must be described to at least a 10 acre tract, unless you specifically request a 60 day period of time in which to locate the site within a specifically described, minimal legal quarter section of land.

- (A) One in the NW quarter of the NW quarter of the NW quarter of Section 29, more particularly described as being near a point 5060 feet North and 5100 feet West of the Southeast corner of said section, in Township 23 South, Range 2 West, Harvey County, Kansas.
- (B) One in the _____ quarter of the _____ quarter of the _____ quarter of Section _____, more particularly described as being near a point _____ feet North and _____ feet West of the Southeast corner of said section, in Township _____ South, Range _____ East/West (circle one), _____ County, Kansas.
- (C) One in the _____ quarter of the _____ quarter of the _____ quarter of Section _____, more particularly described as being near a point _____ feet North and _____ feet West of the Southeast corner of said section, in Township _____ South, Range _____ East/West (circle one), _____ County, Kansas.
- (D) One in the _____ quarter of the _____ quarter of the _____ quarter of Section _____, more particularly described as being near a point _____ feet North and _____ feet West of the Southeast corner of said section, in Township _____ South, Range _____ East/West (circle one), _____ County, Kansas.

If the source of supply is groundwater, a separate application shall be filed for each proposed well or battery of wells, except that a single application may include up to four wells within a circle with a quarter (1/4) mile radius in the same local source of supply which do not exceed a maximum diversion rate of 20 gallons per minute per well.

A battery of wells is defined as two or more wells connected to a common pump by a manifold; or not more than four wells in the same local source of supply within a 300 foot radius circle which are being operated by pumps not to exceed a total maximum diversion rate of 800 gallons per minute and which supply water to a common distribution system.

6. The owner of the point of diversion, if other than the applicant is (please print):

(name, address and telephone number)

(name, address and telephone number)

You must provide evidence of legal access to, or control of, the point of diversion from the landowner or the landowner's authorized representative. Provide a copy of a recorded deed, lease, easement or other document with this application. In lieu thereof, you may sign the following sworn statement:

I have legal access to, or control of, the point of diversion described in this application from the landowner or the landowner's authorized representative. I declare under penalty of perjury that the foregoing is true and correct.

Executed on _____, 20____. _____
Applicant's Signature

see deed

7. The proposed project for diversion of water will consist of one well and pump
(number of wells, pumps or dams, etc.)

and (was completed (by) 06-05-1991
(Month/Day/Year - each was or will be completed)

8. The first actual application of water for the proposed beneficial use was or is estimated to be 01-01-14
(Month/Day/Year)

WATER RESOURCES RECEIVED
 WATER RESOURCES RECEIVED
 JUL 23 2013
 ACCEPTABLE FOR PRIORITY
 JUL 22 2013
 KS DEPT OF AGRICULTURE
 KS DEPT OF AGRICULTURE

9. Will pesticide, fertilizer, or other foreign substance be injected into the water pumped from the diversion works?
 Yes No If "yes", a check valve shall be required.

All chemigation safety requirements must be met including a chemigation permit and reporting requirements.

10. If you are planning to impound water, please contact the Division of Water Resources for assistance, prior to submitting the application. Please attach a reservoir area capacity table and inform us of the total acres of surface drainage area above the reservoir.

Have you also made an application for a permit for construction of this dam and reservoir with the Division of Water Resources? Yes No

- If yes, show the Water Structures permit number here _____
- If no, explain here why a Water Structures permit is not required _____

11. The application must be supplemented by a U.S.G.S. topographic map, aerial photograph or a detailed plat showing the following information. On the topographic map, aerial photograph, or plat, identify the center of the section, the section lines or the section corners and show the appropriate section, township and range numbers. Also, please show the following information:

- (a) The location of the proposed point(s) of diversion (wells, stream-bank installations, dams, or other diversion works) should be plotted as described in Paragraph No. 5 of the application, showing the North-South distance and the East-West distance from a section line or southeast corner of section.
- (b) If the application is for groundwater, please show the location of any existing water wells of any kind within 1/2 mile of the proposed well or wells. Identify each existing well as to its use and furnish the name and mailing address of the property owner or owners. If there are no wells within 1/2 mile, please advise us.
- (c) If the application is for surface water, the names and addresses of the landowner(s) 1/2 mile downstream and 1/2 mile upstream from your property lines must be shown.
- (d) The location of the proposed place of use should be shown by crosshatching on the topographic map, aerial photograph or plat.
- (e) Show the location of the pipelines, canals, reservoirs or other facilities for conveying water from the point of diversion to the place of use.

A 7.5 minute U.S.G.S. topographic map may be obtained by providing the section, township and range numbers to: Kansas Geological Survey, 1930 Constant, Campus West, University of Kansas, Lawrence, Kansas 66047.

12. List any application, appropriation of water, water right, or vested right file number that covers the same diversion points or any of the same place of use described in this application. Also list any other recent modifications made to existing permits or water rights in conjunction with the filing of this application.

Well for M-01 is also covered by HV006. The requested water right is to recover available recharge
credits stored as part of the City of Wichita ASR project

SCANNED

WATER RESOURCES RECEIVED

WATER RESOURCES RECEIVED

JUL 23 2013

JUL 22 2013

KS DEPT OF AGRICULTURE

UNACCEPTABLE FOR PRIORITY

13. Furnish the following well information if the proposed appropriation is for the use of groundwater. If the well has not been completed, give information obtained from test holes, if available.

Information below is from: Test holes Well as completed Drillers log attached

Well location as shown in paragraph No.	(A)	(B)	(C)	(D)
Date Drilled	<u>06-05-91</u>	_____	_____	_____
Total depth of well	<u>237</u>	_____	_____	_____
Depth to water bearing formation	<u>16</u>	_____	_____	_____
Depth to static water level	<u>63</u>	_____	_____	_____
Depth to bottom of pump intake pipe	<u>210</u>	_____	_____	_____

14. The relationship of the applicant to the proposed place where the water will be used is that of agent
(owner, tenant, agent or otherwise)

15. The owner(s) of the property where the water is used, if other than the applicant, is (please print):

(name, address and telephone number)

(name, address and telephone number)

16. The undersigned states that the information set forth above is true to the best of his/her knowledge and that this application is submitted in good faith.

Dated at Wichita, Kansas, this 5th day of June, 2013.
(month) (year)

(Applicant Signature)

APPLICANT(S) SOCIAL SECURITY IDENTIFICATION NUMBER(S)

By Debra Arz
(Agent or Officer Signature)

48-6000653
and/or
APPLICANT(S) TAXPAYER I.D. NO.(S)

Debra Arz
(Agent or Officer - Please Print)

Assisted by _____

Date: _____

(office title)
WATER RESOURCES RECEIVED

JUL 23 2013

KS DEPT OF AGRICULTURE

SCANNED

WATER RESOURCES RECEIVED

JUL 22 2013

KS DEPT OF AGRICULTURE

UNACCEPTABLE FOR PRIORITY

M-01 Nearby Wells

D1 –Mueller, Charles and Ruth
15126 W US HWY 50 Halstead, KS 67056

MR02- City of Wichita
455 N. Main, Wichita, KS 67202

D2- Bergkamp, Joseph H. and Joann
2004 S. Willow Lake Rd, Halstead, KS 67056

D3 –Berger, Edward E, Rodney D.
1729 S Golden Prairie Rd, Halstead, KS 67056

13639-KLA, LLC
5517 S. Springlake Rd, Halstead, KS 67056

15673- Bergkamp, Joseph and Joann
2004 S. Willow Lake Rd, Halstead, KS

WATER RESOURCES
RECEIVED

JUL 23 2013

KANSAS WATER RESOURCES

SCANNED

DLED AND CON YANGE

D-4200

6
V6177460

M-1

THIS INDENTURE Made on this 9th day of March, 1939, by and between J. F. Remick, a single man,

4300 #16

of the County of Sedgwick, State of Kansas, hereinafter called the Part Y of the First Part, and

THE CITY OF WICHITA, a municipal corporation, located in Sedgwick County in the State of Kansas, hereinafter called the Party of the Second Part,

WITNESSETH: That the Part Y of the First Part, in consideration of One Thousand and no/100 Dollars, the receipt of which is hereby acknowledged, do hereby by these presents, give, grant, bargain, sell and convey unto said Party of the Second Part, its successors and assigns all of the following described real estate, situated in the County of Harvey and the State of Kansas, to-wit:

- 1. All of the water bearing sands and water rights now, or at any time, and at all times hereafter in or under said real estate hereinafter described.
- 2. The right to use in the proper enjoyment of such water and water rights as much of the surface of said real estate as may be necessary or desirable on the part of the Party of the Second Part to carry out the terms of this grant.
- 3. The right in perpetuity to drill for, produce, and transport sub-surface water therefrom.

The real estate covered by this conveyance is more particularly described as follows: Five (5) acres in square form in the Northwest corner of the Northwest Quarter of Section Twenty Nine, Township Twenty three (23) South, Range Two (2), west;

- IT IS UNDERSTOOD AND AGREED BY AND BETWEEN THE PARTIES that this conveyance carries with it:
- (a) The right to go upon the surface of said lands above described to explore and drill for, procure and extract any and all sub-surface water, either for experimental purposes or for a permanent supply, and to remove and transport the same for such use and uses in The City of Wichita and its environs, as the Party of the Second Part may from time to time elect to make of it, including all of the sub-surface water,
 - (1) Which may at any time and at all times during the continuance hereof be stationary in and under said land or any part thereof, and
 - (2) Which may flow or percolate thereto from other lands, including the right of ingress and egress by the officers, agents and employees of the Party of the Second Part, and by any other party authorized by it to enter upon said premises for any purposes whatsoever.
 - (b) The right to lay and maintain such pipe lines and power lines, and construct and maintain such tanks and pump houses as may be deemed necessary or desirable by the Party of the Second Part for the economic production, handling and transportation of such water.
 - (c) The right to construct, operate and maintain measuring wells for the purpose of ascertaining the changes, if any, in the quantity and quality of sub-surface water on the above described premises.
 - (d) The right to, at any and all times, remove from said land any and all tanks, machinery, fixtures and improvements placed thereon by the grantee, including the right to draw and remove pipe and casing.

IT IS UNDERSTOOD AND AGREED BY AND BETWEEN THE PARTIES that this conveyance does not carry with it any oil and gas in place and the right to explore for or extract the same.

TO HAVE AND TO HOLD THE SAME, Together with all and singular the tenements, hereditaments and appurtenances hereunto belonging or in anywise appertaining forever.

Said grantor for himself and his heirs, executors, or administrators do hereby covenant, promise and agree to and with said Party of the Second Part, that at the delivery of these presents he is lawfully seized in his own right of an absolute and indefeasible estate of inheritance, in fee simple, of and in all and singular the above granted and described premises with the appurtenances; that the same are free, clear, discharged and unincumbered of and from all former and other grants, titles, charges, estates, judgments, taxes, assessments, and incumbrances of what nature and kind soever:

and that he will warrant and forever defend the same unto said Party of the Second Part, its successors or assigns, against said part Y of the First Part, his heirs, and all and every person or persons whomsoever, claiming or to claim the same.

IN WITNESS WHEREOF, the said Part Y of the First Part have hereunto set his hand the day and year first above written.



J. F. Remick

WATER RESOURCES RECEIVED

MAR 23 2013 SCANNED

Place of Use
July 18, 2006

Within the City of Wichita and immediate vicinity; within the City of Andover and immediate vicinity, within the City of Bel Aire and immediate vicinity, within the City of Benton and immediate vicinity, within the City of Derby and immediate vicinity; within the City of Kechi and immediate vicinity; within the City of Park City and immediate vicinity; within the City of Rose Hill and immediate vicinity; within the City of Valley Center and immediate vicinity; within the City of Bentley; within the boundaries of Rural Water District No. 1, Sedgwick County; within the boundaries of Rural Water District No. 2, Sedgwick County; within the boundaries of Rural Water District No. 3, Sedgwick County; and within the boundaries of Rural Water District No. 8, Butler County; within a tract of land in Sedgwick and Butler Counties, Kansas, beginning at the Southeast Corner of Section 25, Township 28 South, Range 2 East, then West a distance of 22 miles to the Southwest Corner of Section 28, Township 28 South, Range 2 West, then North a distance of 16 miles to the Northwest Corner of Section 9, Township 26 South, Range 2 West, then East a distance of 22 miles to the Northeast corner of Section 12, Township 26 South, Range 2 East, then South a distance of 16 miles to the point of beginning.

WATER RESOURCES
RECEIVED

JUL 23 2013

KS DEPT OF AGRICULTURE

SCANNED

WATER RESOURCES
RECEIVED

JUL 23 2013

KS DEPT OF AGRICULTURE

UNACCEPTABLE FOR PRIORITY



Department of Public Works & Utilities

June 25, 2013

Division of Water Resources
 David Barfield, P.E.
 Chief Engineer
 Kansas Department of Agriculture
 109 SW 9th St.
 Topeka, KS 66612

Dear Mr. Barfield,

RE: Permit Applications for Equus Beds ASR Project

Dear Mr. Barfield,

The City of Wichita has completed construction of Phase II of the Equus Beds Aquifer Storage and Recovery (ASR) project. Phase II has the capacity to capture and recharge up to 30 million gallons per day of surface water from the Little Arkansas River. The water from the river will be treated to meet KDHE water quality standards prior to being injected into recharge wells. When the Phase II project was permitted, the City applied for recharge water rights for both new recharge and recover wells as well as municipal supply wells that were being with recharge capabilities. The enclosed applications are requesting recharge water withdrawal rights for the remaining municipal wells.

The Chief Engineer approved the City's ASR project as part of the Findings and Orders issued on August 5, 2005. Those Findings and Orders established the accounting method for tracking recharge credits. At that time 38 Index Cells were established. Attachment No. 1 is a map that shows the locations of the municipal wells that the City is requesting recharge water rights when credits are available within their respective Index Cells.

Each application includes a map depicting the locations of other groundwater diversions located within one-half mile of each municipal well. Those diversions include a number of domestic

Engineering Division

City Hall • Seventh Floor • 455 North Main • Wichita, Kansas 67202-1606

T 316.268.4501 **F** 316.268.4114

www.wichitagov.org

WATER RESOURCES
RECEIVED

JUL 23 2013

KS DEPT OF AGRICULTURE

SCANNED

WATER RESOURCES
RECEIVED

JUL 22 2013

UNACCEPTABLE FOR PRIORITY
KS DEPT OF AGRICULTURE

CITY OF WICHITA - 2

wells located within a few hundred feet of the existing M-wells. The proposed use of recharge water rights will be only when recharge credits are available, which means that the water being withdrawn would not be there except for the recharge activities. The applications request a maximum rate of withdrawal of 1,500 gpm to support back flushing activities when the well is potentially redrilled with recharge capabilities in the future and will not be the rate used under normal pumping conditions. Therefore, because the maximum rate of diversion will occur only for brief periods and the additional water used by these wells is for water that is not currently available, these applications will not impair other nearby water users when the wells are operated under the conditions established for ASR wells.

Enclosed is a check for \$10,200 to cover the application fees. We appreciate your consideration in reviewing these applications. The City is willing to provide any additional information you might find helpful. If you have any questions, please do not hesitate to contact either myself at 316-268-4235, mjacobs@wichita.gov, or Debra Ary at 316-268-4614, dary@wichita.gov.

Sincerely,



Michael G. Jacobs, P.E.
Interim Manager, Water Planning and Production

Withdrawal at nonrecharge wells 2013-06-25.docx

WATER RESOURCES
RECEIVED

JUL 23 2013

KS DEPT OF AGRICULTURE

WATER RESOURCES
RECEIVED

JUL 22 2013

KS DEPT OF AGRICULTURE

UNACCEPTABLE FOR PRIORITY

SCANNED

ATTACHMENT 1

GMD2
Boundary

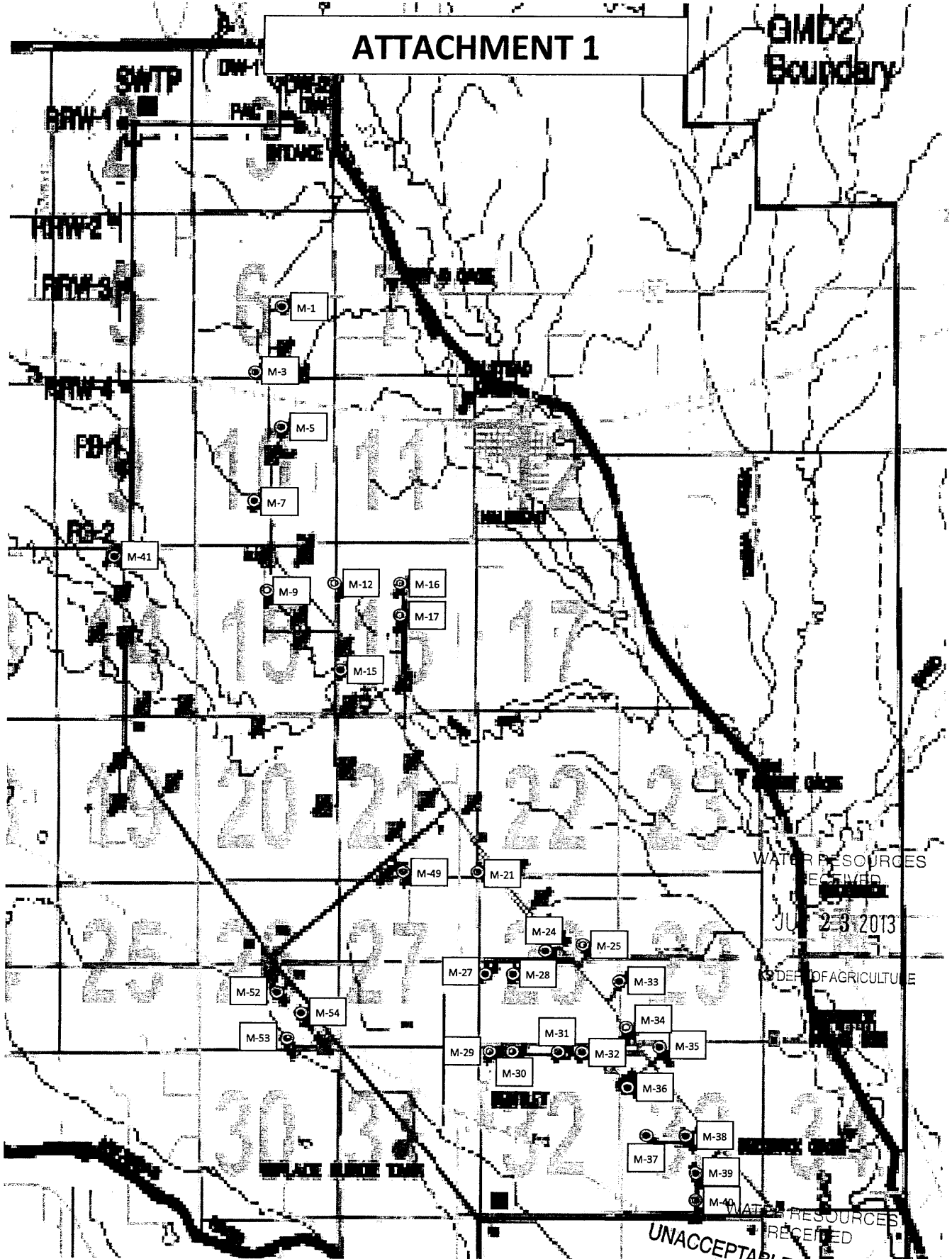

WATER RESOURCES
RECEIVED
JUL 23 2013
DEPT OF AGRICULTURE

UNACCEPTABLE FOR PRIORITY
SCANNED
JUL 23 2013

Schemm, Doug

From: Jacobs, Michael <MJacobs@wichita.gov>
Sent: Friday, February 05, 2016 8:00 AM
To: Schemm, Doug
Cc: Brian J. Meier (bmeier@burnsmcd.com); Watkins, Catherine; Daniel Clement (dwclement@burnsmcd.com)
Subject: Convert M Wells to MR Wells - Publication Notices
Attachments: Affidavit of publication - Wichita Eagle 2016-01-23.pdf; Affidavit of publication - Halstead 2016-01-28.pdf

Doug,

Attached are the Affidavit of Publication from the Harvey County Independent and the Wichita Eagle.

Michael G. Jacobs, P.E.
Water Planning & Production Manager
Department of Public Works & Utilities
City of Wichita
1815 W. Pine
Wichita, KS 67203

(316) 269-4760

For Emergency: (316) 268-4968 (Control Room)

PROOF OF PUBLICATION

STATE OF KANSAS, COUNTY OF HARVEY,

Robb Reeves

Being first duly sworn, deposes and says: That he is Publisher of

THE HARVEY COUNTY INDEPENDENT

a paid periodical newspaper printed in the State of Kansas, and published in and general circulation in Harvey County, Kansas, and that said newspaper is not a trade, religious or fraternal publication.

Said newspaper is a weekly published at least 50 times a year; has been so published continuously and uninterruptedly in said county and state for a period of 1 year prior to the first publication of said notice; and has been admitted at the post office of Halstead, Kansas in said County as second class matter.

That the attached notice is a true copy thereof and was published in the regular and entire issue of said newspaper for 1 consecutive weeks,

the first publication thereof being JANUARY made on the 28 day of 2016 with subsequent publications being made on the following dates _____

Form prepared by:

Wayne Belknap

Subscribed and sworn to before me this January day of 28th of 2016

Martha A. Reeves

Notary Public

My commission expires: 08/24/2019

Publication Costs: 96.00

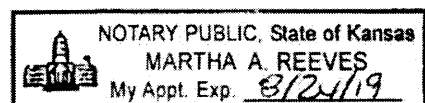

NOTICE
Published in The Harvey County Independent January 28, 2016
The City of Wichita has filed Applications, File Nos. 48,704; 48,705; 48,706; 48,707; 48,708; 48,709; 48,710; 48,711; 48,712; 48,713; 48,714; 48,715; 48,716; 48,717; 48,718; 48,719; 48,720; 48,721; 48,722; 48,723; 48,724; 48,725; 48,726; 48,727; 48,728; 48,729; 48,730; 48,731; 48,732; and 48,733, for permits to appropriate water for beneficial use, with the Division of Water Resources, Kansas Department of Agriculture. These applications are part of the on-going Equus Beds Aquifer Storage and Recovery (ASR) project. In all instances, the new applications are proposing to divert available ASR credits from existing municipal wells.
These existing municipal supply wells are located within Townships 23, 24 and 25 South, Ranges 1, 2 and 3 West, in Harvey and Sedgwick Counties, Kansas. The municipal wells are currently authorized under File Nos. HV-006, 388 and 1,006.
Anyone with existing wells in the immediate vicinity of these proposed points of diversion is invited to submit written comments regarding Applications, File Nos. 48,704 through 48,733. Persons submitting comments should specifically indicate their interest in the proposed appropriations of water. Comments regarding these applications will be accepted through February 29, 2016.
Written comments or questions regarding the applications may be directed to the Office of the Chief Engineer, Division of Water Resources, Kansas Department of Agriculture, 1320 Research Park Drive, Manhattan, Kansas 66502. If you wish more information concerning these applications, you may also contact Douglas Schemm, Environmental Scientist, in the Permits Unit of the Water Appropriation Program at (785) 298-3495.

RECEIVED
JAN 29 2016
PWU/Production and Pumping

AFFIDAVIT

STATE OF KANSAS \
 - SS.
County of Sedgwick /

Mark Fletchall, of lawful age, being first duly sworn, deposeth and saith: That he is Record Clerk of The Wichita Eagle, a daily newspaper published in the City of Wichita, County of Sedgwick, State of Kansas, and having a general paid circulation on a daily basis in said County, which said newspaper has been continuously and uninterruptedly published in said County for more than one year prior to the first publication of the notice hereinafter mentioned, and which said newspaper has been entered as second class mail matter at the United States Post Office in Wichita, Kansas, and which said newspaper is not a trade, religious or fraternal publication and that a notice of a true copy is hereto attached was published in the regular and entire Morning issue of said The Wichita Eagle for 1 issues, that the first publication of said notice was

made as aforesaid on the 23rd of January A.D. 2016, with

subsequent publications being made on the following dates:

And affiant further says that he has personal knowledge of the statements above set forth and that they are true.

Mark Fletchall

Subscribed and sworn to before me this 3rd day of February, 2016



Rachel M. Wilson
Notary Public Sedgwick County, Kansas

Public Notice
File Nos 48,704 through 48,733

The City of Wichita has filed Applications, File Nos. 48,704; 48,705; 48,706; 48,707; 48,708; 48,709; 48,710; 48,711; 48,712; 48,713; 48,714; 48,715; 48,716; 48,717; 48,718; 48,719; 48,720; 48,721; 48,722; 48,723; 48,724; 48,725; 48,726; 48,727; 48,728; 48,729; 48,730; 48,731; 48,732; and 48,733, for permits to appropriate water for beneficial use, with the Division of Water Resources, Kansas Department of Agriculture. These applications are part of the on-going Equus Beds Aquifer Storage and Recovery (ASR) project. In all instances, the new applications are proposing to divert available ASR credits from existing municipal wells.

These existing municipal supply wells are located within Townships 23, 24 and 25 South, Ranges 1, 2 and 3 West, in Harvey and Sedgwick Counties, Kansas. The municipal wells are currently authorized under File Nos. HV-006, 388 and 1,006.

Anyone with Existing wells in the immediate vicinity of these proposed points of diversion is invited to submit written comments regarding Applications, File Nos. 48,704 through 48,733. Persons submitting comments should specially indicate their interest in the proposed appropriations of water. Comments regarding these applications will be accepted through February 29th, 2016.

Written comments or questions regarding the applications may be directed to the office of the Chief Engineer, Division of Water Resources, Kansas Department of Agriculture, 1320 Research Park Drive, Manhattan, Kansas 66502. If you wish more information concerning these applications, you may also contact Douglas Schemm, Environmental Scientist, in the Permits Unit of the Water Appropriation Program at (785) 296-3495.

Rockel, Richard A.

From: Ary, Debra <DAry@wichita.gov>
Sent: Tuesday, July 23, 2013 4:42 PM
To: Rockel, Richard A.
Subject: RE: Proof of Access Statement
Attachments: MWell 1.pdf; MWell 3.pdf; MWell 5_MWell6.pdf; MWell 7.pdf; MWell 8_MWell 9_MWell 10.pdf; MWell 12_MWell 14_MWell 17_MWell 18.pdf; MWell 15.pdf; MWell 16.pdf; MWell 20_MWell21.pdf; MWell 24.pdf; MWell 25.pdf; MWell 27_MWell 28.pdf; MWell 29_MWell 30.pdf; MWell 31_MWell 32.pdf; MWell 33.pdf; MWell 34.pdf; MWell 35.pdf; MWell 36.pdf; MWell 37_MWell 38.pdf; MWell 39_MWell 40.pdf; MWell 41_MWell 42_MWell 43_MWell 44.pdf; MWell 48_MWell 49_MWell 50.pdf; MWell 51_MWell 52.pdf; MWell 53_MWell 54_MWell 55.pdf; Warranty Deed Well 54.pdf

Mr. Rockel,

Please find attached the deeds for the well easements associated with the ASR Recharge Water Right Applications. Please let me know if you need additional documentation.

Kindest regards,

Deb

From: Rockel, Richard A. [<mailto:Richard.Rockel@KDA.KS.GOV>]
Sent: Tuesday, July 23, 2013 11:05 AM
To: Ary, Debra
Subject: RE: Proof of Access Statement

Yes you can send electronic copies of the easements.

Richard Rockel

WATER RESOURCES
RECEIVED

From: Ary, Debra [<mailto:DAry@wichita.gov>]
Sent: Tuesday, July 23, 2013 11:04 AM
To: Rockel, Richard A.
Subject: RE: Proof of Access Statement

JUL 23 2013

KS DEPT OF AGRICULTURE

Can I send a copy of the easements electronically? These are actually pretty easy to access for me.

From: Rockel, Richard A. [<mailto:Richard.Rockel@KDA.KS.GOV>]
Sent: Tuesday, July 23, 2013 11:00 AM
To: Ary, Debra
Subject: RE: Proof of Access Statement

Correct, we will either need 30 copies of the form OR an easement for each well, we do not need both.

Richard Rockel

SCANNED

From: Ary, Debra [<mailto:DAry@wichita.gov>]
Sent: Tuesday, July 23, 2013 10:41 AM
To: Rockel, Richard A.
Subject: RE: Proof of Access Statement

Thank you Richard,

Just to be clear, I can sign this page 30 times, or provide copies of the individual easements for each tract?

Thank you again,

Deb

From: Rockel, Richard A. [<mailto:Richard.Rockel@KDA.KS.GOV>]
Sent: Tuesday, July 23, 2013 10:35 AM
To: Ary, Debra
Subject: Proof of Access Statement

Deb,

Per our telephone discussion, attached is our proof of access form which will need to be completed for each of the applications (30) submitted by the City of Wichita before they can be accepted for processing.

Effective July 1, 2009, K.S.A. 82a-709 requires all applicants for new appropriation rights for the beneficial use of water in the State of Kansas to provide evidence of legal access to or control of the point of diversion from the landowner or the landowner's authorized representative. Applicants may provide a copy of a recorded deed, lease, easement or other document with the application. Or, in lieu of providing this documentary evidence, you may sign the attached form, which constitutes a sworn statement.

Let me know if you have any questions,

Richard Rockel, Environmental Scientist
Kansas Department of Agriculture
Division of Water Resources
(785) 296-6084
Richard.Rockel@KDA.KS.GOV
www.ksda.gov/dwr



109 SW 9th Street, 2nd Floor
Topeka, Kansas 66612-1283

phone: (785) 296-3717
fax: (785) 296-1176
www.ksda.gov/dwr

Dale A. Rodman, Secretary
David W. Barfield, Chief Engineer

Sam Brownback, Governor

July 25, 2013

CITY OF WICHITA
PUBLIC WORKS & UTILITIES
455 N MAIN
WICHITA KS 67202

RE: Application
File No. 48,704

Dear Sir or Madam:

Your application for permit to appropriate water in 29-23S-2W, in Harvey County, was received and has been assigned the file number noted above.

As a matter of record, the Division of Water Resources has on hand a large number of applications awaiting processing. Therefore to be fair to all concerned, and so that we can process those applications on hand in the order they were received, we intend to concentrate on the backlog of applications until the issue is resolved. Once review of your application has begun, we will contact you, if additional information is required.

In accordance with the provisions of the Kansas Water Appropriation Act, a portion of which is included below, the use of water as proposed prior to approval of the application is unlawful. Once approved, compliance with the terms, conditions and limitations of the permit is necessary. Conservation of the water resources of Kansas is required.

Section 82a-728 of the Kansas Water Appropriation Act, provides (a) except for the appropriation of water for the purpose of domestic use, . . . it shall be unlawful for any person to appropriate or threaten to appropriate water from any source without first applying for and obtaining a permit to appropriate water in accordance with the provisions of the Water Appropriation Act or for any person to violate any condition of a vested right, appropriation right or an approved application for a permit to appropriate water for beneficial use.

(b) (1) The violation of any provision of this section by any person is a class C misdemeanor . . .

A class C misdemeanor is punishable by a fine not to exceed \$500 and/or a term of confinement not to exceed one month in the county jail. Each day that the violation occurs constitutes a separate offense.

If you have any questions, please contact our office. If you wish to discuss a specific file, please have the file number ready so that we may help you more efficiently.

Sincerely,

Douglas W. Schemm
New Application Unit Supervisor
Water Appropriation Program

DWS
pc: Stafford Field Office
GMD 2

SCANNED

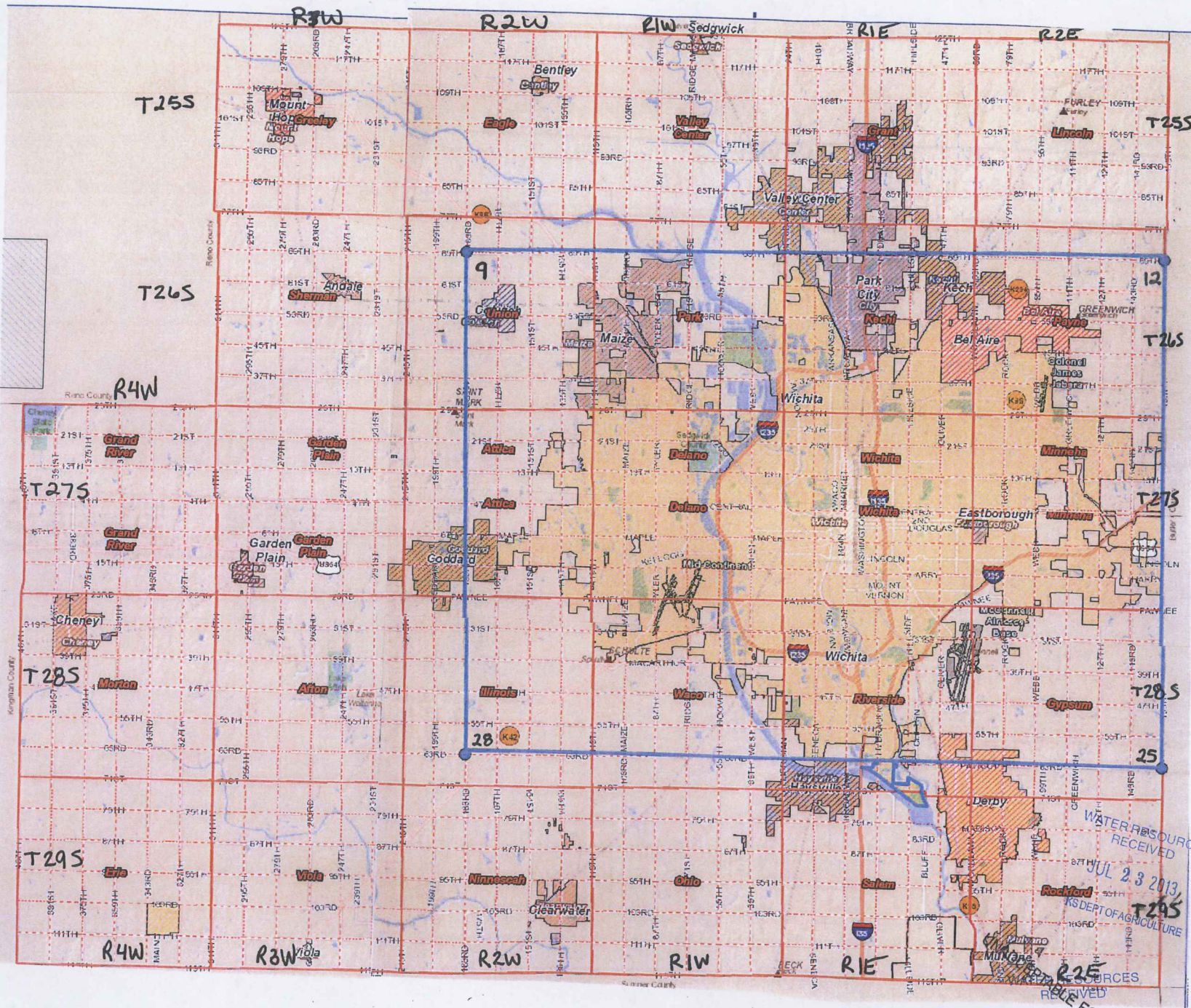

WATER RESOURCES RECEIVED
 JUL 23 2013
 T25S
 KS DEPT OF AGRICULTURE
 RESOURCES RECEIVED
 JUL 22 2013
 KS DEPT OF AGRICULTURE

M-01

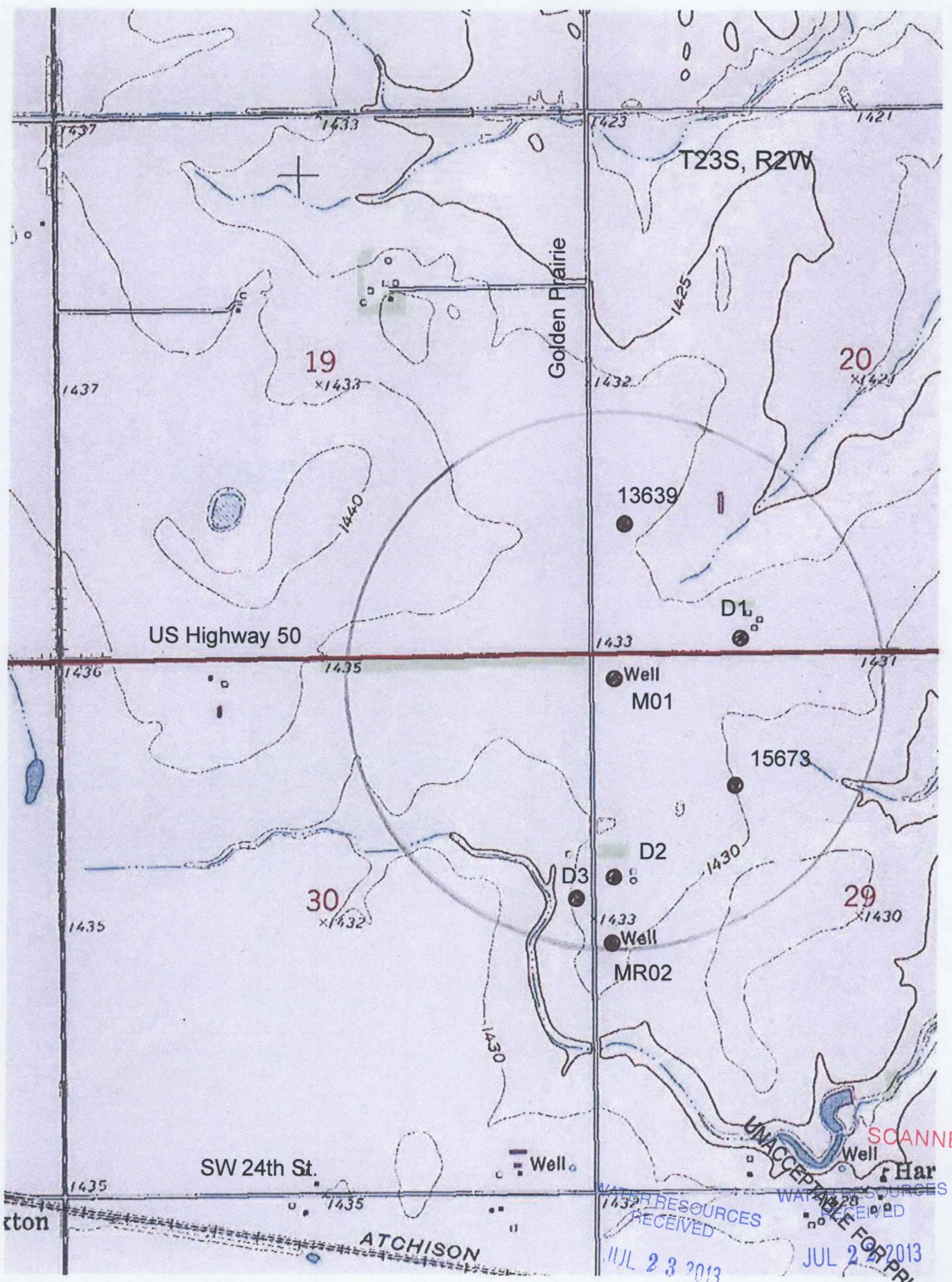

UNACCEPTABLE
 WATER RESOURCES RECEIVED
 JUL 23 2013
 WATER RESOURCES RECEIVED
 JUL 25 2013
 KS DEPT OF AGRICULTURE

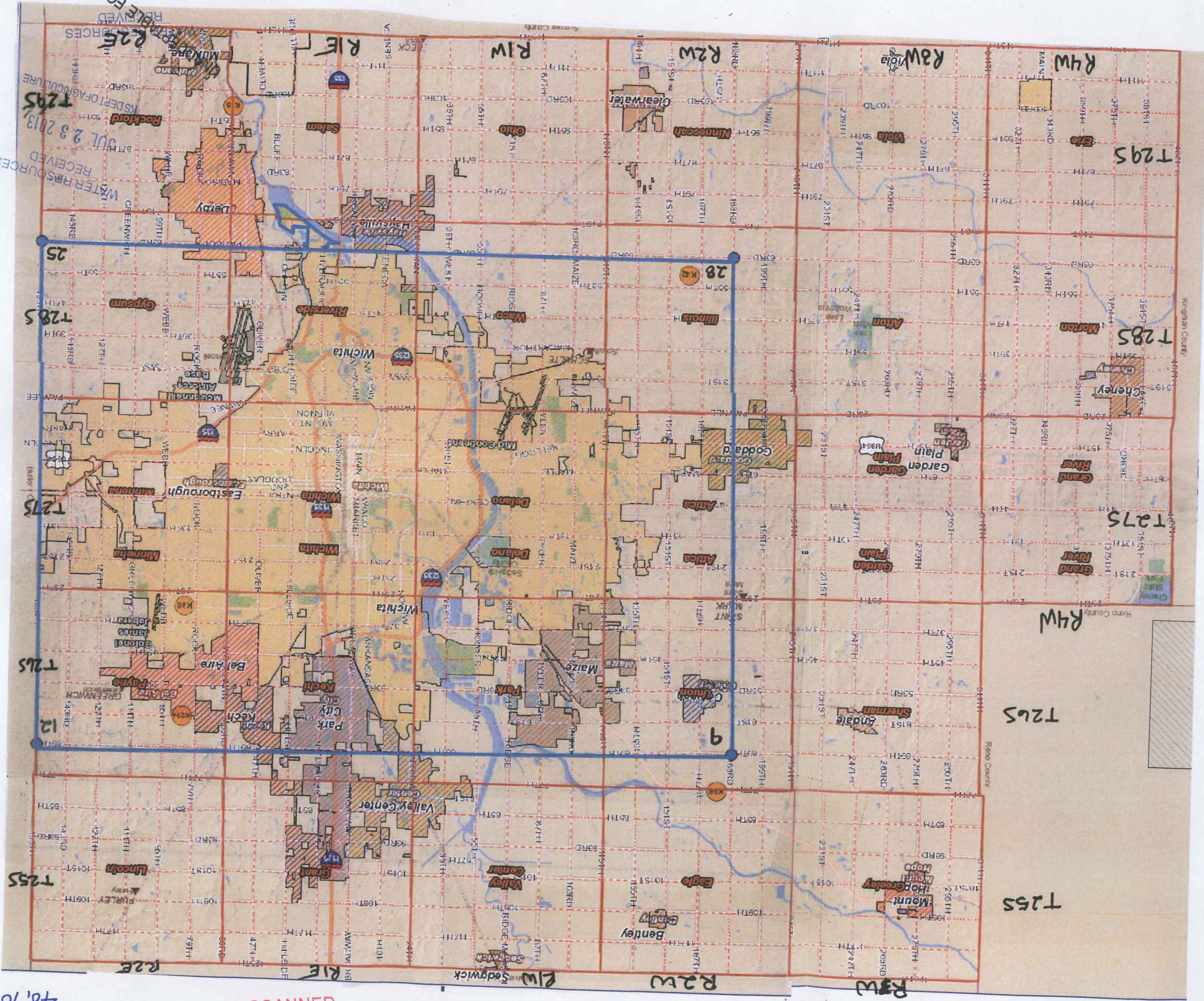

RECEIVED FOR PRIORITY
 JUL 2 2013
 KS DEPT OF AGRICULTURE
 WATER RESOURCES
 JUL 2 3 2013
 KS DEPT OF AGRICULTURE

Reno County
 Reno County
 Reno County